

FOXCHASE NO. 6

CITY OF ROCKWALL, ROCKWALL COUNTY, TEXAS

INDEX	
ITEM	SHEET
PLAT.....	1-2
PAVING.....	3-7
DRAINAGE.....	8-10
UTILITIES.....	11
LOT GRADING.....	12-13
EROSION CONTROL.....	14

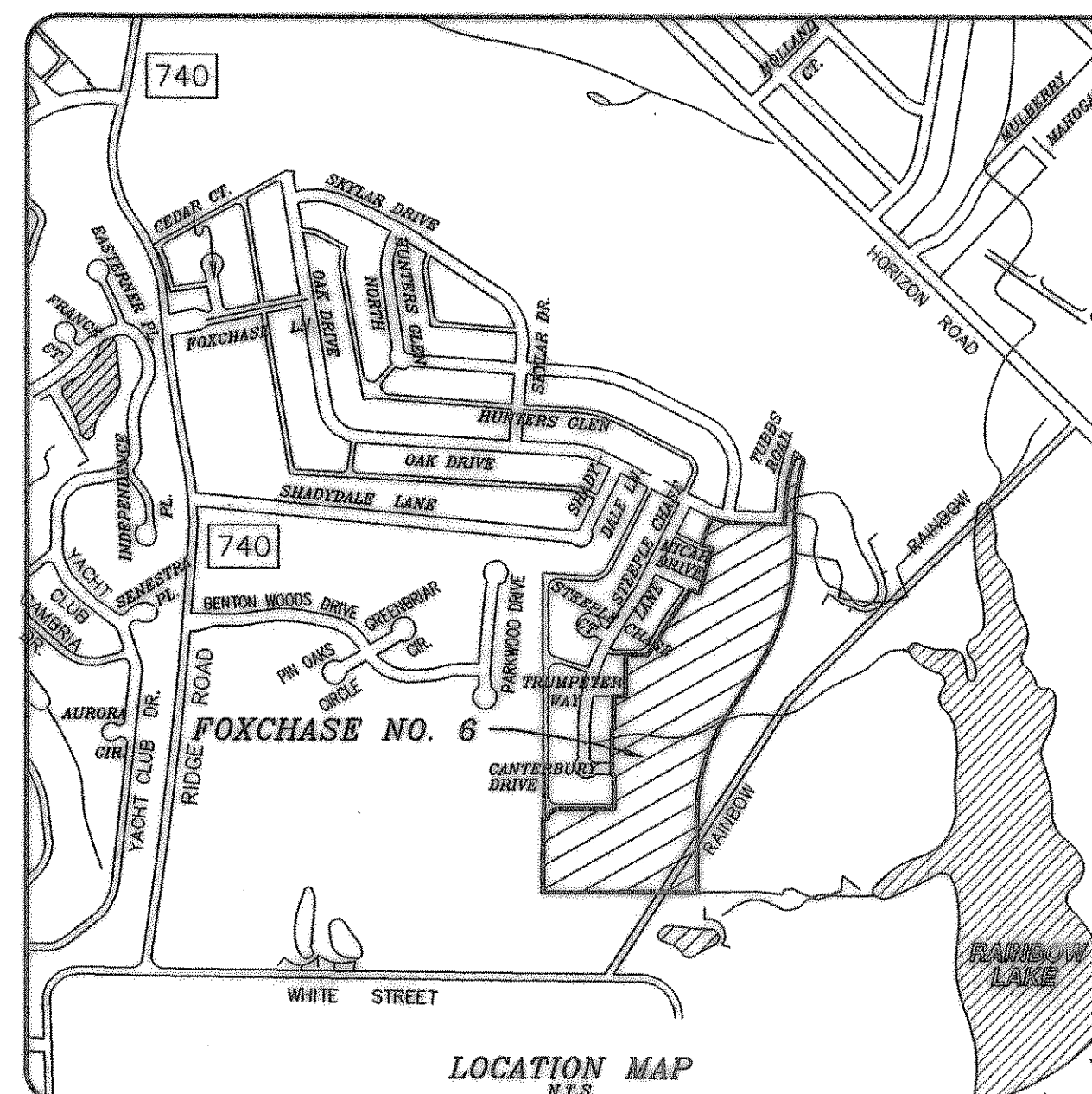
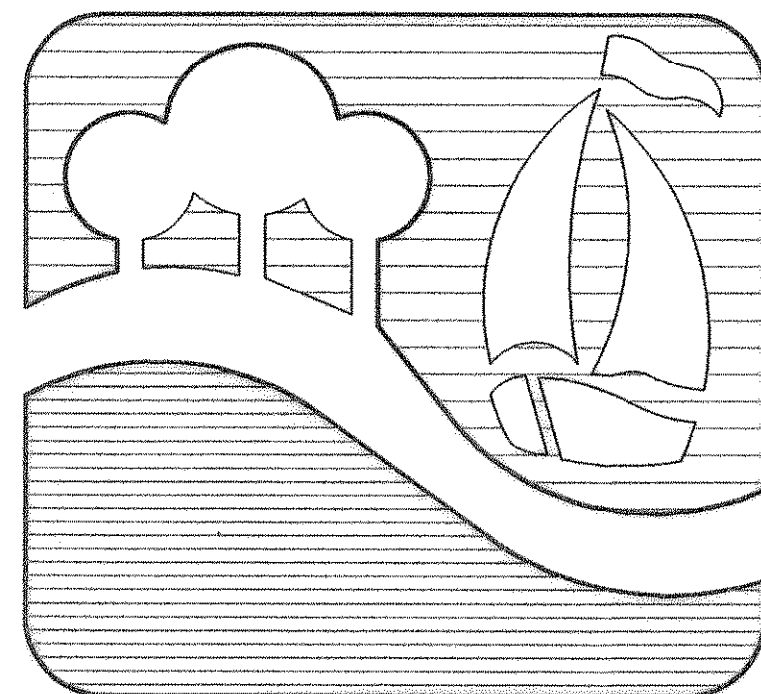

GENERAL NOTES

- EXCAVATED MATERIAL SHALL BE PLACED AS DIRECTED BY THE OWNER.
- ALL FILL AREAS IN STREET RIGHT - OF - WAYS TO BE DENSITY CONTROLLED AND COMPACTED TO 95% DENSITY AT OPTIMUM MOISTURE CONTENT.
- NO TREES SHALL BE CUT EXCEPT ON THE SPECIFIC AUTHORITY OF THE ENGINEER.
- CONSTRUCTION SHALL MEET THE REQUIREMENTS OF THE LATEST REVISION OF THE "STANDARD SPECIFICATIONS FOR CONSTRUCTION", CITY OF ROCKWALL.
- PAVEMENT THICKNESS SHALL BE AS FOLLOWS:

RESIDENTIAL STREETS	= 6" THICK, 3500 P.S.I. CONCRETE
MINOR COLLECTOR STREET	= 6" THICK, 3500 P.S.I. CONCRETE
MAJOR COLLECTOR & ARTERIAL STREETS	= 8" THICK, 3500 P.S.I. CONCRETE (TUBBS ROAD)
- IT SHALL BE THE RESPONSIBILITY OF THE CONTRACTOR TO LOCATE AND VERIFY ALL EXISTING UTILITIES PRIOR TO THE BEGINNING OF CONSTRUCTION TO INSURE NO CONFLICT BETWEEN ALL UTILITY LINES.
- WHERE WATER PIPELINES EITHER CROSS OR OTHERWISE COME WITHIN 9 FEET OF A SANITARY SEWER PIPELINE THE SEWER PIPELINE SHALL BE EITHER CAST IRON OR PVC PIPE WITH A MINIMUM WORKING PRESSURE CLASS OF 150 PSI.
- ALL WATER SERVICES TO BE 1" INSTALLED TO THE CENTER OF EACH LOT WITH SEWER LATERALS 10' DOWNSTREAM. WATER SERVICES SHALL BE PE 200 PSI SDR 9 WITH METAL INSERTS.
- CONDUITS FOR S. W. BELL AND NORTH TEXAS CABLE COMM T.V. SHALL HAVE 30" OF COVER AND SHALL EXTEND 2 FEET BEYOND FUTURE PAVING.
- ALL FITTINGS SHALL BE BRASS COMPRESSION.
- RESILIENT SEATED GATE VALVES ONLY WILL BE ALLOWED.
- BLUE MARKER E. M. S. #1252 SHALL BE PLACED UNDER EACH CORPORATION STOP
- GREEN MARKER E. M. S. #1253 SHALL BE PLACED UNDER EACH SEWER SERVICE AND AT EACH MANHOLE AT A DEPTH NOT TO EXCEED 5 FEET.
- WATER LINES TO BE CLASS 200 PVC - C900
- EROSION CONTROL SHALL BE PLACED AND INSPECTED PRIOR TO ANY WORK BEING PERFORMED.

T.U. ELECTRIC COMPANY GENERAL NOTES

- CONTRACTOR TO INSTALL ALL CONDUIT AS SHOWN ON PRINT.
- T.U. ELECTRIC COMPANY TO FURNISH CONDUIT AND CABLE MARKERS.
- DEVELOPER TO INSTALL 1 (ONE) CABLE MARKER AT EACH END OF CONDUIT.
- EACH CONDUIT MUST BE BURIED A MINIMUM OF 40" DEEP (AFTER LAND IS BROUGHT TO FINAL GRADE AND EXTEND 2 FEET BEYOND FUTURE PAVING) .
- EACH CONDUIT MUST BE INSPECTED BY THE DISTRIBUTION DEPARTMENT BEFORE BACKFILLING IN TRENCH. ROBERT GAYLOR 487-2351.
- EACH CONDUIT MUST HAVE A PULL WIRE INSTALLED AND BE CAPPED AT BOTH ENDS.
- TRENCHES WITHIN CITY STREETS SHALL BE COMPACTED TO 95% DENSITY.

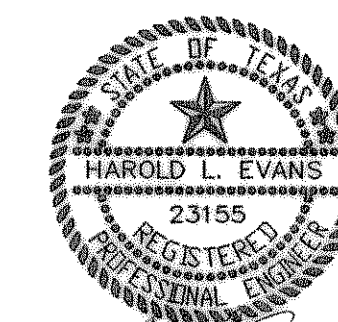

[Signature]
2-2000

AS BUILT

OWNER :

FOXCHASE DEVELOPMENT CORPORATION

P.O. BOX 369

ROCKWALL, TEXAS 75087

(972) 771-5253

HAROLD L. EVANS, CONSULTING ENGINEER

P.O. BOX 28355

DALLAS, TEXAS 75228

(214) 328-8133