

CURVE	RADIUS	LENGTH	TANGENT	CHORD	BEARING	DELTA
C1	855.00'	92.09'	46.09'	92.05'	S59°39'53"E	06°10'17"

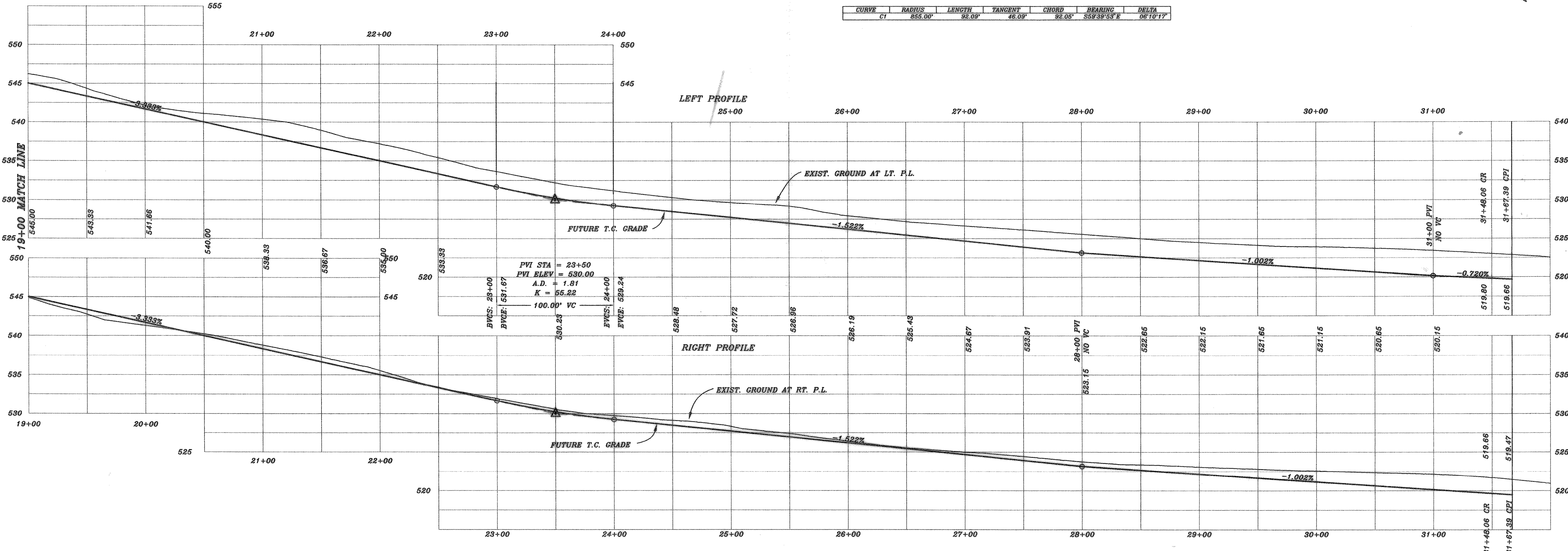

B.M.
CITY OF ROCKWALL BRASS DISK ON
N.E. CORNER OF 20' INLET ON WEST
SIDE STEEPLE CHASE LANE, 1.04' +/-
SOUTH OF THE INTERSECTION OF STEEPLE
CHASE LANE AND OAK DRIVE.
ELEV.: 540.50

B.M.
CITY OF ROCKWALL BRASS DISK ON
N.W. CORNER OF 20' INLET ON WEST
SIDE SKYLAR DRIVE, 75' +/- NORTH OF
THE INTERSECTION OF SKYLAR DRIVE
AND HUNTERS GLEN.
ELEV.: 532.63

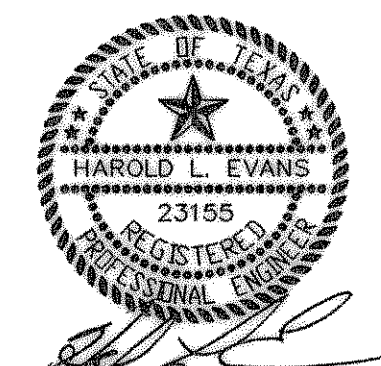

AS BUILT

HAROLD L. EVANS CONSULTING ENGINEER P.O. BOX 28355 2331 GUS THOMASSON ROAD, SUITE 102 DALLAS, TEXAS 75228, (214) 328-8133		PAVING PLAN SUMMER LEE DRIVE FOXCHASE PHASE 5/6 CITY OF ROCKWALL		SHEET NO. 8 17 JOB NO. 9781	
REV. PER 4th. CITY REVIEW REV. PER 4th. CITY REVIEW REV. PER 2nd. CITY REVIEW REV. PER CITY REVIEW	12/6/99 6/24/98 12/24/97 12/24/97	DATE 10/10/97	SCALE 1" = 40' 1" = 6'	DESIGN H.L.E.	DRAWN