

CURVE	RADIUS	LENGTH	TANGENT	CHORD	BEARING	DELTA
C1	271.50'	206.65'	108.62'	201.70'	N34°46'26" W	43°36'39"
C2	150.00'	35.73'	18.46'	36.63'	N49°33'51" W	14°01'49"
C3	150.00'	35.77'	17.97'	35.63'	N49°33'52" W	13°39'57"
C4	2619.77'	458.60'	229.89'	458.01'	N67°13'41" W	10°01'47"
C5	330.50'	130.38'	66.04'	129.52'	N77°30'53" W	22°35'59"

NOTE:  
LOTS 15-31, BLOCK E AND  
LOTS 10-22, BLOCK E ARE TO  
HAVE SEWER LATERALS CONNECTED  
TO EXIST. 6" SEWER

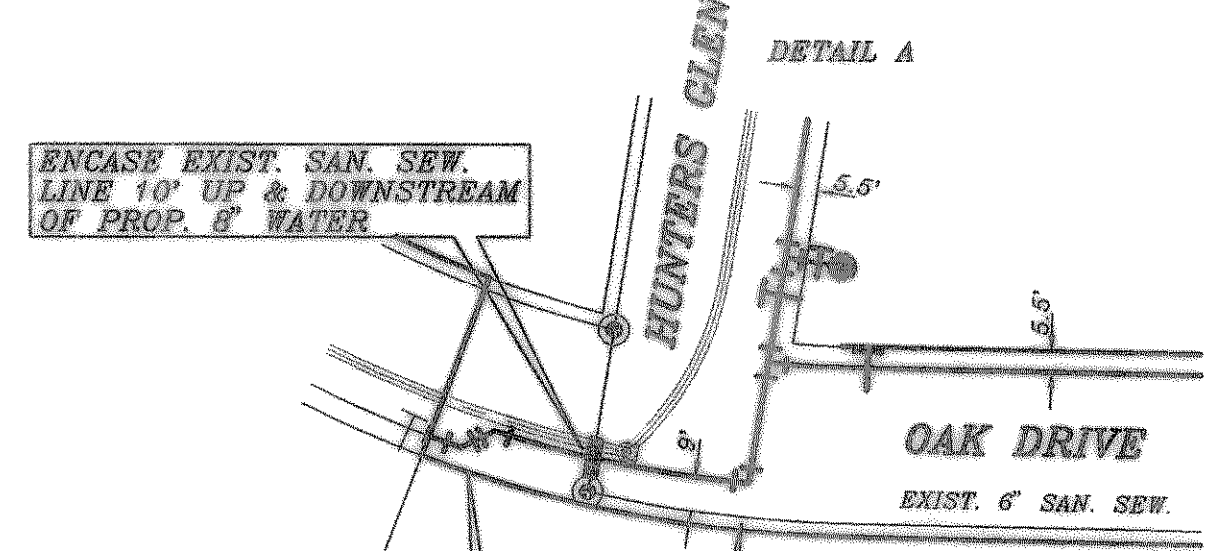

REMOVE EXIST. 8"  
BLIND FLANGE  
CONN. TO EXIST.  
6" WATER  
INSTALL:  
2-8" 45° BENDS  
1-8" 90° BEND  
1-8" X8" TEE  
2-8" VALVES  
1-PH COMPLETE  
W/TEE, VALVE,  
PIPING, AND BLOCKING

B.M.  
CITY OF ROCKWALL BRASS DISK ON  
N.E. CORNER OF 20' INLET ON WEST  
SIDE STEEPLE CHASE LANE, 1.040' +/-  
SOUTH OF THE INTERSECTION OF STEEPLE  
CHASE LANE AND OAK DRIVE.  
ELEV.: 540.50

B.M.  
CITY OF ROCKWALL BRASS DISK ON  
N.W. CORNER OF 20' INLET ON WEST  
SIDE SKYLAR DRIVE, 75' +/- NORTH OF  
THE INTERSECTION OF SKYLAR DRIVE  
AND HUNTERS GLEN.  
ELEV.: 532.63

HAROLD L. EVANS CONSULTING ENGINEER P.O. BOX 28355 2831 GUS THOMASSON ROAD, SUITE 102 DALLAS, TEXAS 75228, (214) 328-8193		<b>PROPOSED UTILITIES PLAN</b>		SHEET NO. 14
REV. PER 1st CITY REVIEW REV. PER 2nd CITY REVIEW REV. PER CITY REVIEW	6/24/98 3/24/98 1/14/98	<b>FOXCHASE PHASE 5</b> <b>CITY OF ROCKWALL</b>		JOB NO. 9781
REVISION DESCRIPTION DATE 11/10/97		SCALE 1" = 100' 1" = 6'	DESIGN H.L.E.	DRAWN

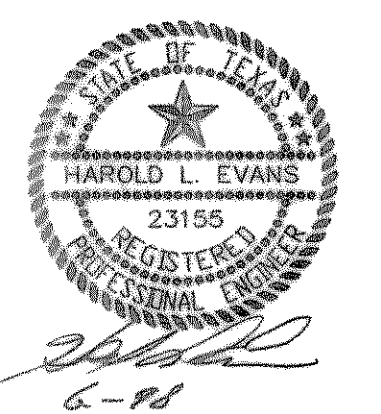

AS SHOWN