

- Notes:
- 6"-3800 PSI Class "C" concrete pavement with No. 3 bars 24" on centers both ways. Min. 6 Sack For Machine Placed Min. 6 1/2 Sack For Hand Placed
 - Where the Plasticity Index of the natural soil is equal to or exceeds 15, lime stabilization shall be required. A minimum of 6% by weight of lime to a depth of 6" shall be required.
 - Subgrade shall be 6" thick and compacted to a density not less than 95% at 0% - 4% of optimum moisture content.
1. All construction joints & rebar to be in conformance with the City of Rockwall Specifications and Standards.

C.L. CURVE TABLE

CURVE	RADIUS	DELTA	TANGENT	CHORD	BEARING
C-1	200.00'	40°41'37"	74.17'	142.04'	S 69°56'27" W
C-2	200.00'	40°58'20"	74.72'	143.02'	N 70°04'48" E
C-3	275.00'	29°04'25"	61.15'	128.34'	S 76°53'48" E
C-4	275.00'	15°36'38"	37.86'	74.92'	S 53°47'41" E
C-5	425.00'	08°42'42"	29.57'	84.81'	N 53°55'22" E
C-6	381.77'	10°04'08"	34.51'	88.85'	N 53°41'47" W
C-7	375.00'	10°37'43"	34.88'	88.56'	S 52°57'51" E
C-8	375.00'	10°37'43"	34.88'	88.56'	S 42°20'09" E
C-9	425.00'	14°31'03"	54.13'	107.68'	N 44°16'46" E
C-10	450.00'	28°07'38"	112.24'	218.99'	N 28°20'40" E
C-11	100.00'	78°28'48"	81.67'	138.97'	N 81°55'12" E
C-12	200.00'	30°14'48"	54.05'	105.58'	N 74°13'35" E
C-13	80.00'	90°00'00"	80.00'	125.69'	S 44°25'00" E
C-14	655.00'	03°49'18"	21.85'	43.69'	N 88°36'21" E
C-15	645.00'	11°28'28"	64.80'	128.17'	N 87°34'04" W
C-16	600.00'	11°22'47"	60.41'	120.02'	N 87°34'15" E
C-17	500.00'	13°50'17"	89.67'	178.78'	N 87°25'12" E
C-18	600.00'	03°31'41"	20.23'	40.44'	N 87°37'00" W
C-19	600.00'	07°36'34"	39.90'	79.83'	S 82°25'36" E
C-20	900.00'	05°44'53"	19.55'	39.25'	S 88°38'33" W
C-21	375.00'	12°43'02"	47.29'	83.24'	N 83°07'28" W
C-22	425.00'	27°24'43"	103.65'	203.33'	N 83°07'41" E
C-23	175.00'	14°41'41"	22.57'	44.88'	N 63°10'08" E
C-24	200.00'	31°02'11"	55.53'	108.34'	N 73°57'55" W
C-25	200.00'	30°31'35"	54.50'	108.58'	S 73°42'37" E
C-26	200.00'	23°00'43"	40.71'	80.37'	N 1°30'21" E
C-27	275.00'	40°08'28"	80.38'	156.12'	S 23°44'44" E
C-28	200.00'	43°13'54"	79.25'	159.80'	N 21°01'57" E
C-29	300.00'	40°58'22"	112.15'	214.62'	S 19°54'41" E
C-30	175.00'	18°17'42"	28.02'	55.57'	N 51°26'51" E
C-31	225.00'	18°11'42"	38.03'	71.45'	S 51°26'51" W
C-32	100.00'	53°32'57"	50.46'	93.46'	N 62°42'32" E
C-33	140.00'	80°00'00"	140.00'	218.91'	S 44°28'00" E

- LEGEND
- PROP. PAVEMENT
 - SETBACK (BLDG) LINE
 - EXTERIOR BOUNDARY LINE
 - LOT LINE
 - RIGHT OF WAY
 - DRAINAGE DIRECTION

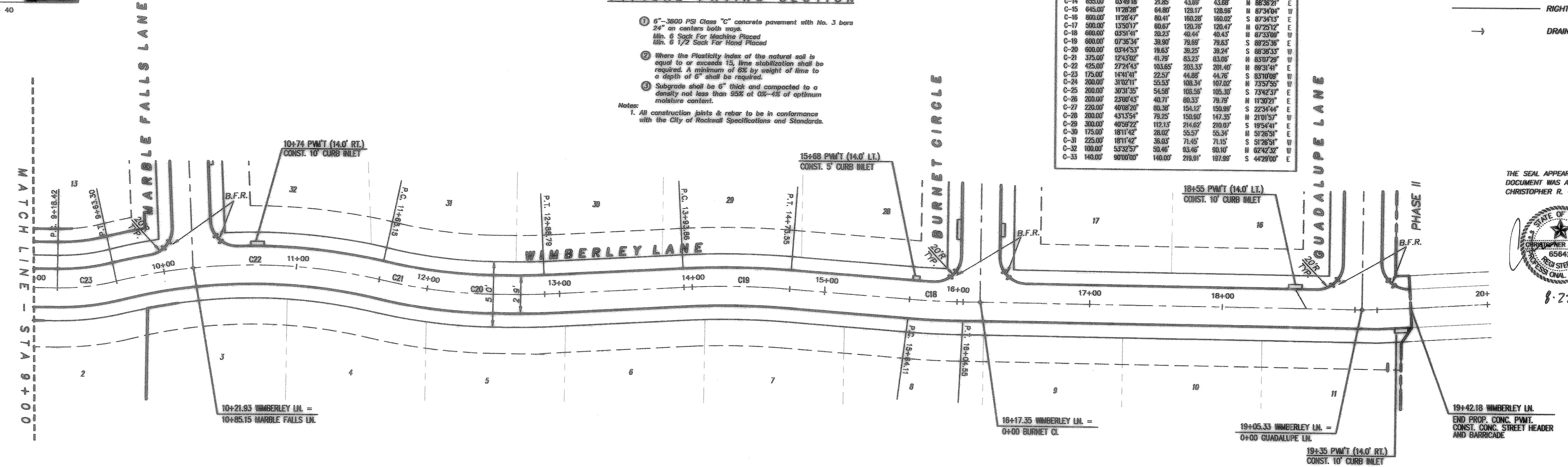

THE SEAL APPEARING ON THIS DOCUMENT WAS AUTHORIZED BY CHRISTOPHER R. CUNY, P.E. 65642

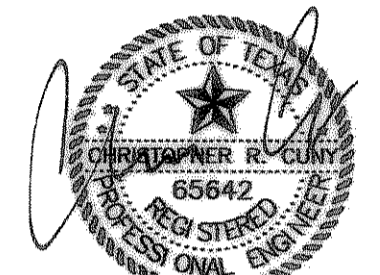

8-22-2007

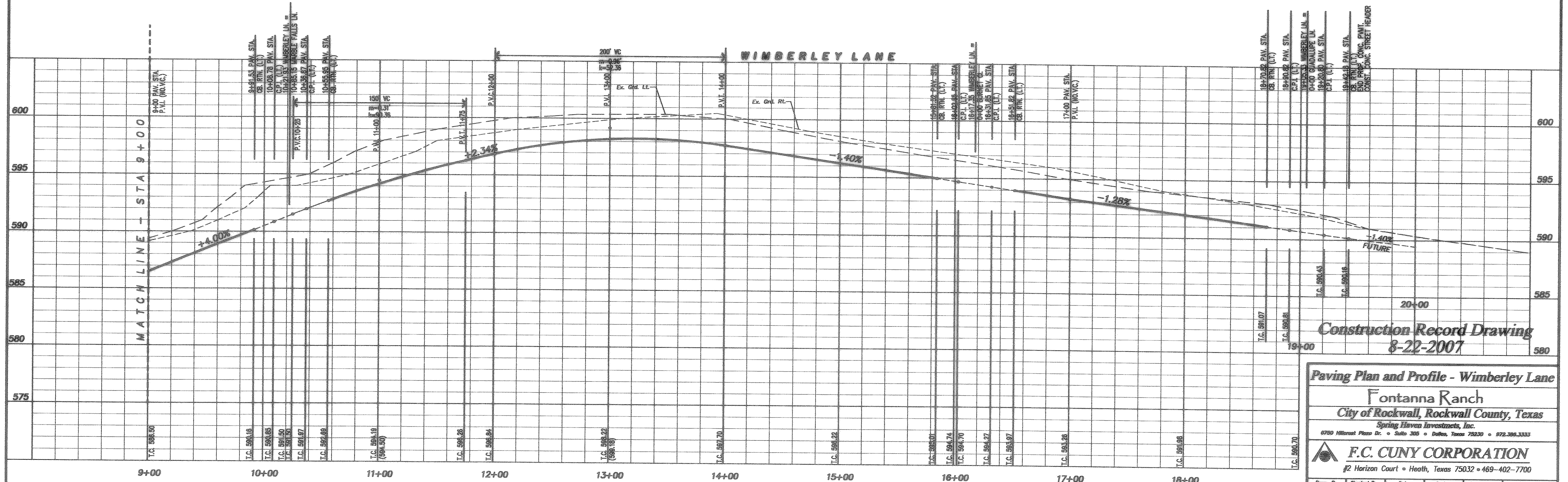

Construction Record Drawing
8-22-2007

Paving Plan and Profile - Wimberley Lane

Fontanna Ranch
City of Rockwall, Rockwall County, Texas

Spring Haven Investments, Inc.
6780 Hillcrest Plaza Dr. • Suite 305 • Dallas, Texas 75230 • 972.395.3333

F.C. CUNY CORPORATION
#2 Horizon Court • Heath, Texas 75032 • 469-402-7700

Drawn By:	Checked By:	Date:	Scale:	Project No.:	Sheet No.:
MSC	DW	10/10/06	H:1"=40' V:1"=4'	05-013	7 of 45