

LEGEND

- PROP. PAVEMENT
- - - SETBACK (BLDG) LINE
- - - EXTERIOR BOUNDARY LINE
- LOT LINE
- RIGHT OF WAY
- DRAINAGE DIRECTION

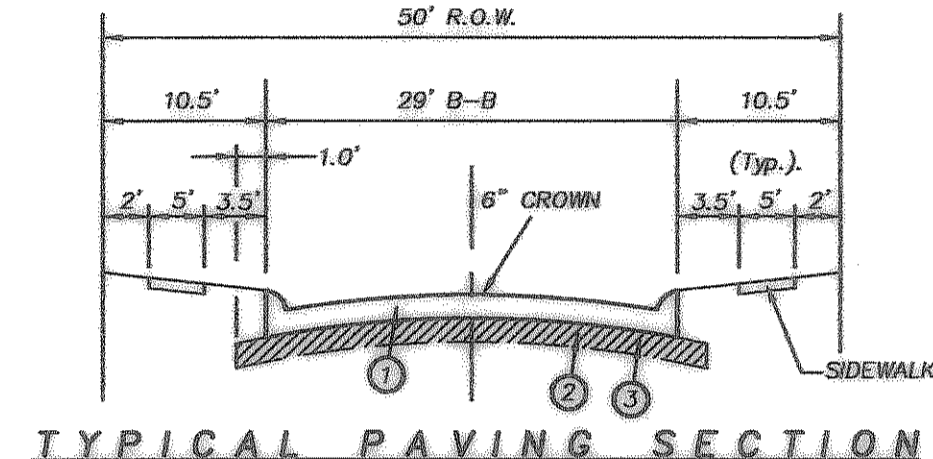

- Notes:**
- 6"-3600 PSI Class "C" concrete pavement with No. 3 bars 24" on centers both ways.
Min. 6 Sack For Machine Placed
Min. 6 1/2 Sack For Hand Placed
 - Where the Plasticity Index of the natural soil is equal to or exceeds 15, lime stabilization shall be required. A minimum of 6% by weight of lime to a depth of 6" shall be required.
 - Subgrade shall be 6" thick and compacted to a density not less than 95% at 0%-4% optimum moisture content.
- Note:**
1. All construction joints & rebar to be in conformance with the City of Rockwall Specifications and Standards.
- Note:**
Construct Barrier Free Ramp (B.F.R.) per City of Rockwall Stds.

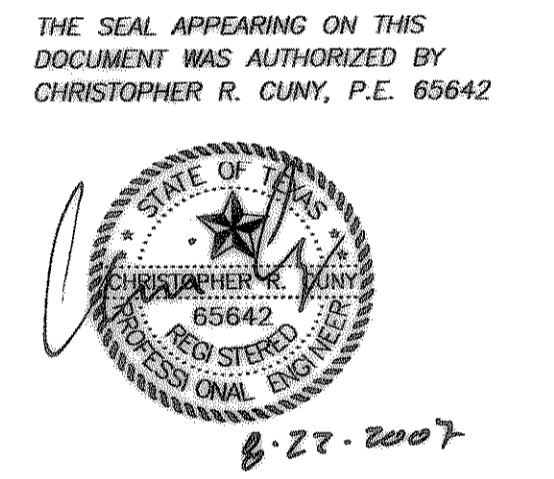

SAN SABA COURT

LUCHENBACH TRAIL

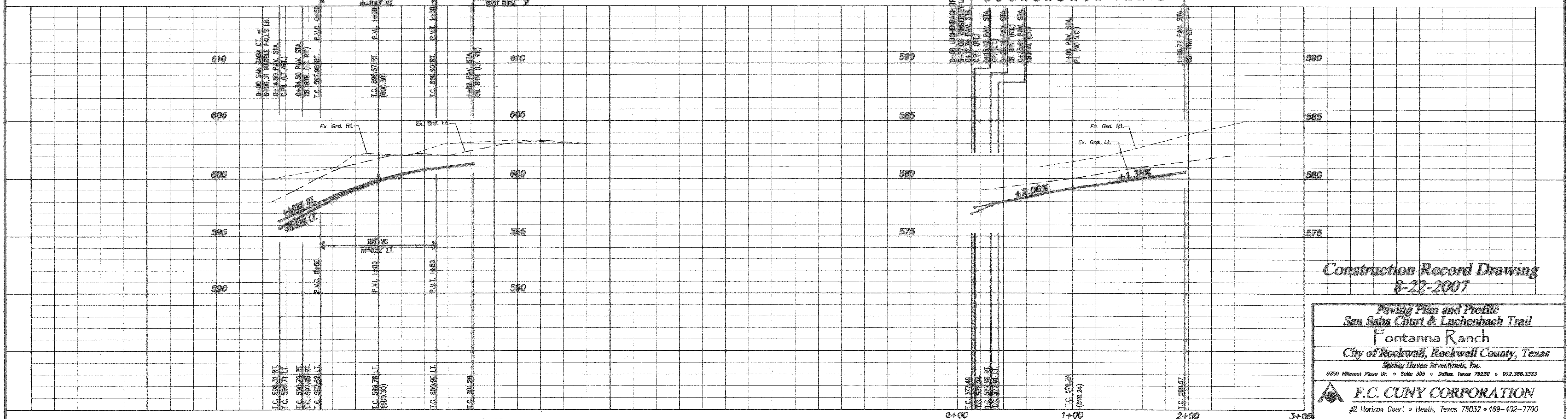

Construction Record Drawing
8-22-2007

Paving Plan and Profile
San Saba Court & Luchenbach Trail
Fontanna Ranch
City of Rockwall, Rockwall County, Texas
Spring Haven Investments, Inc.
6750 Hillcrest Plaza Dr. • Suite 305 • Dallas, Texas 75230 • 972.386.3333

F.C. CUNY CORPORATION
#2 Horizon Court • Heath, Texas 75032 • 469-402-7700

Drawn By:	Checked By:	Date:	Scale:	Project No.:	Sheet No.:
MSC	DWJ	10/18/06	H:1"=40' V:1"=4'	05-013	13 of 45

Z:\Projects\5-Residential\Fontanna\Record Drawings\Fonc-dwg08.dwg Mon Aug 20 15:48:30 2007