

C.L. CURVE TABLE

CURVE	RADIUS	DELTA	TANGENT	LENGTH	CHORD	BEARING
C-1	200.00'	40°41'37"	74.17'	142.04'	136.08'	S 69°56'27" W
C-2	200.00'	40°58'20"	74.72'	143.02'	136.99'	N 70°04'46" E
C-3	275.00'	25°04'25"	61.15'	120.34'	119.38'	S 76°53'49" E
C-4	275.00'	15°36'39"	37.69'	74.92'	74.69'	S 53°47'41" E
C-5	425.00'	08°42'42"	32.37'	64.61'	64.35'	N 53°55'22" E
C-6	391.77'	10°04'08"	34.51'	68.85'	68.76'	N 53°41'47" W
C-7	375.00'	10°37'43"	34.88'	69.56'	69.46'	S 42°20'08" E
C-8	375.00'	10°37'43"	34.88'	69.56'	69.46'	S 42°20'08" E
C-9	425.00'	14°31'03"	54.13'	107.66'	107.40'	N 44°16'40" W
C-10	450.00'	28°00'38"	112.24'	219.99'	217.01'	N 28°20'40" E
C-11	100.00'	78°20'46"	61.67'	136.97'	126.51'	N 81°35'25" E
C-12	200.00'	30°14'40"	54.65'	105.50'	104.36'	N 74°17'35" W
C-13	80.00'	90°00'00"	80.00'	125.66'	113.14'	S 44°35'00" E
C-14	655.00'	0°48'18"	21.85'	43.69'	43.68'	N 88°36'21" E
C-15	645.00'	11°28'28"	64.80'	129.17'	128.96'	N 87°34'04" E
C-16	900.00'	11°28'47"	80.41'	160.28'	160.02'	S 87°34'13" E
C-17	500.00'	13°50'17"	60.67'	120.76'	120.47'	N 87°25'12" E
C-18	600.00'	03°51'41"	20.23'	40.44'	40.43'	N 87°33'08" W
C-19	600.00'	07°36'34"	39.90'	79.69'	79.63'	S 88°38'33" W
C-20	600.00'	03°44'53"	19.63'	39.25'	39.24'	S 88°38'33" W
C-21	375.00'	12°43'02"	41.79'	83.23'	83.06'	N 83°07'28" W
C-22	425.00'	27°24'43"	103.65'	203.33'	201.40'	N 89°31'41" E
C-23	175.00'	14°41'19"	22.57'	44.89'	44.76'	S 83°10'09" W
C-24	200.00'	31°02'11"	55.53'	108.34'	107.02'	N 73°57'55" W
C-25	200.00'	30°31'35"	54.58'	106.56'	105.30'	S 73°42'37" E
C-26	200.00'	23°00'43"	40.71'	80.33'	79.78'	N 11°30'21" E
C-27	220.00'	40°08'20"	60.38'	154.12'	150.99'	S 22°34'44" E
C-28	200.00'	43°15'54"	79.25'	150.90'	147.35'	N 21°01'57" E
C-29	300.00'	40°59'22"	112.13'	214.62'	210.07'	S 19°54'44" W
C-30	175.00'	18°11'42"	28.02'	55.57'	55.34'	N 97°28'51" W
C-31	225.00'	18°11'42"	36.03'	71.45'	71.15'	S 51°26'51" W
C-32	100.00'	53°32'57"	50.46'	93.46'	90.10'	N 62°42'32" E
C-33	140.00'	90°00'00"	140.00'	219.91'	197.99'	S 44°29'00" E

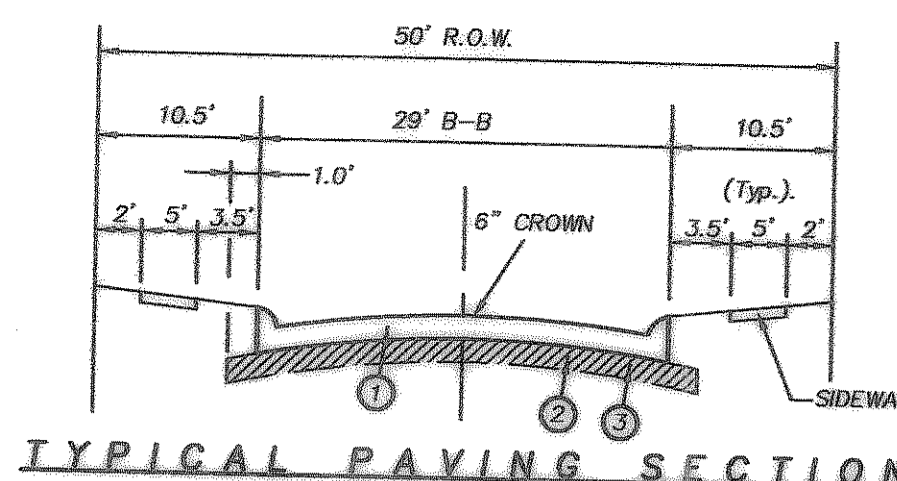

- Notes:**
- 6"-3600 PSI Glass "C" concrete pavement with No. 3 bars 24" on centers both ways.
Min. 6 Sack For Machine Placed
Min. 6 1/2 Sack For Hand Placed
 - Where the Plasticity Index of the natural soil is equal to or exceeds 15, lime stabilization shall be required. A minimum of 6% by weight of lime to a depth of 6" shall be required.
 - Subgrade shall be 6" thick and compacted to a density not less than 95% of 0%-4% of optimum moisture content.
1. All construction joints & rebar to be in conformance with the City of Rockwall Specifications and Standards.

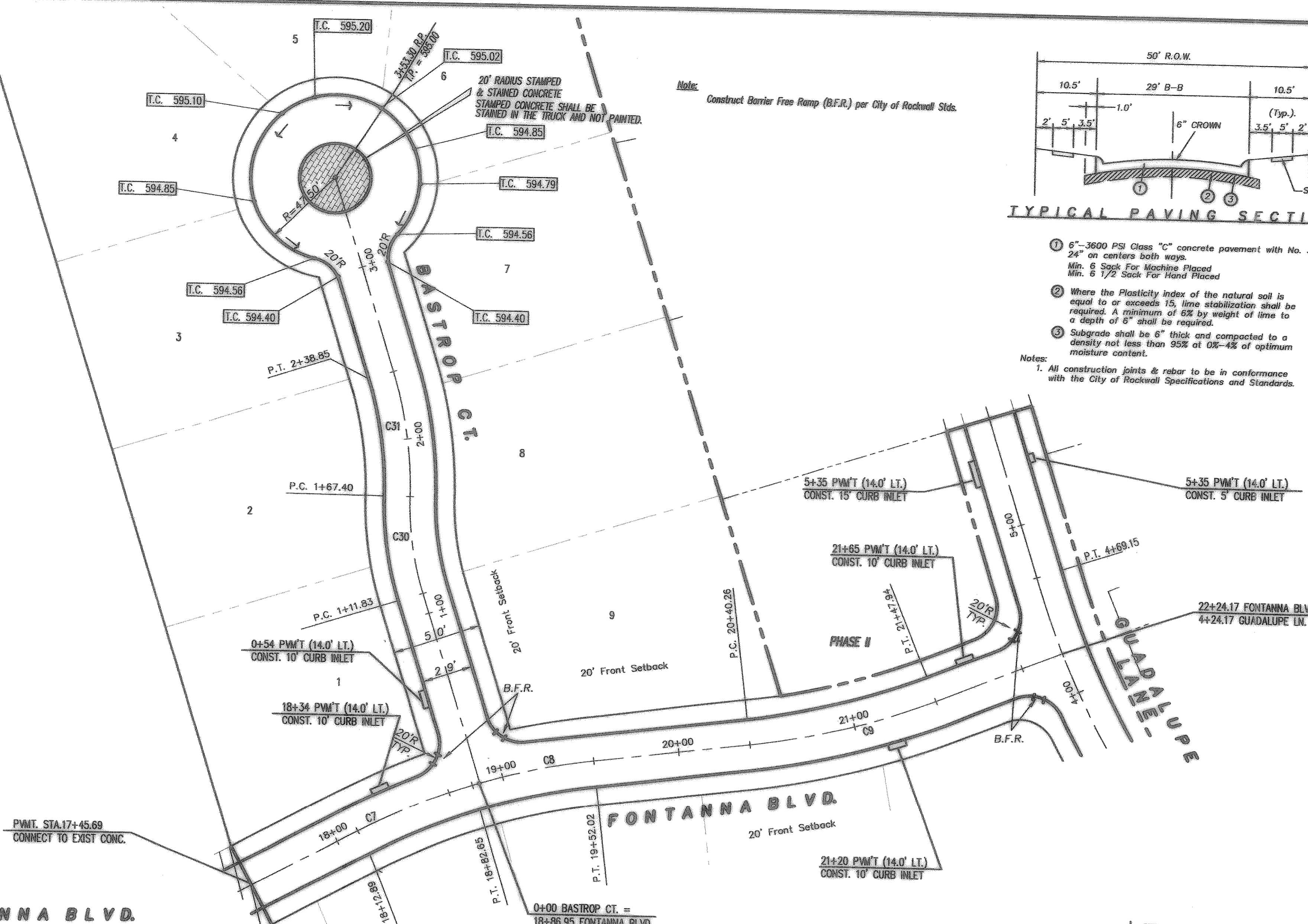
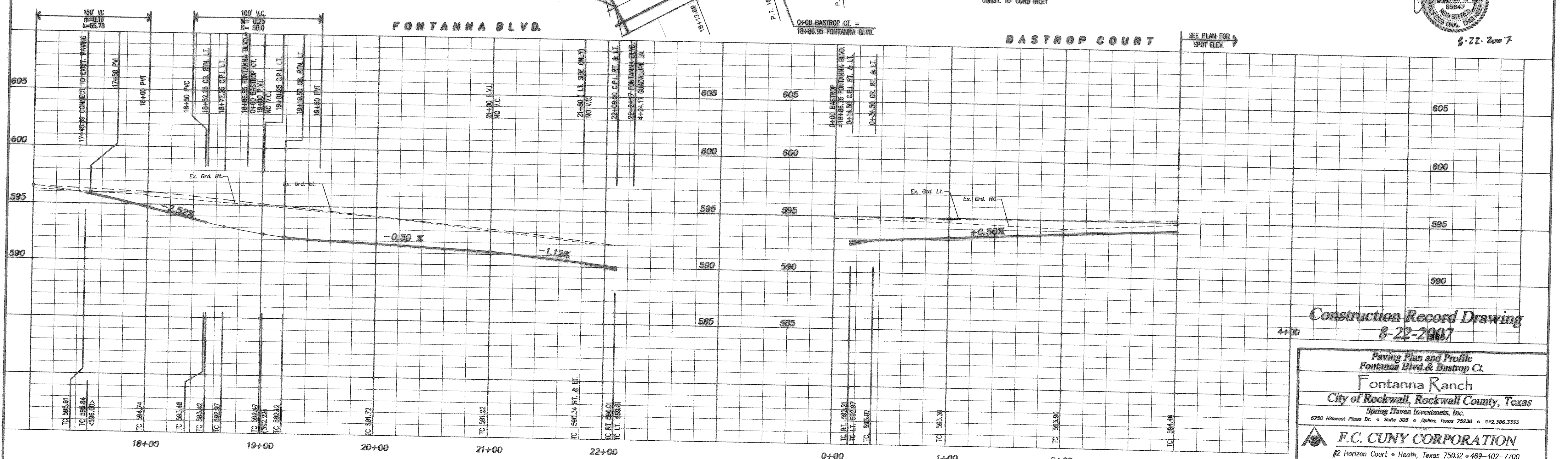
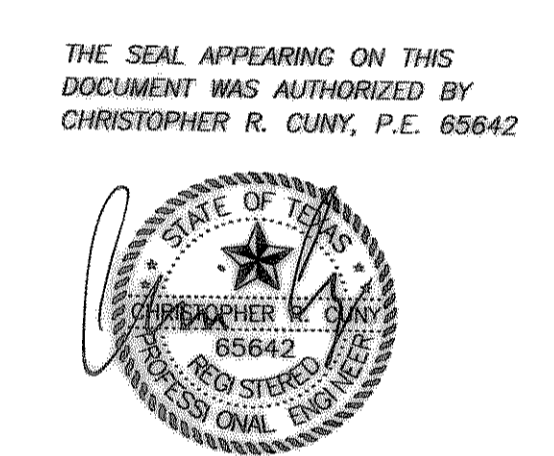
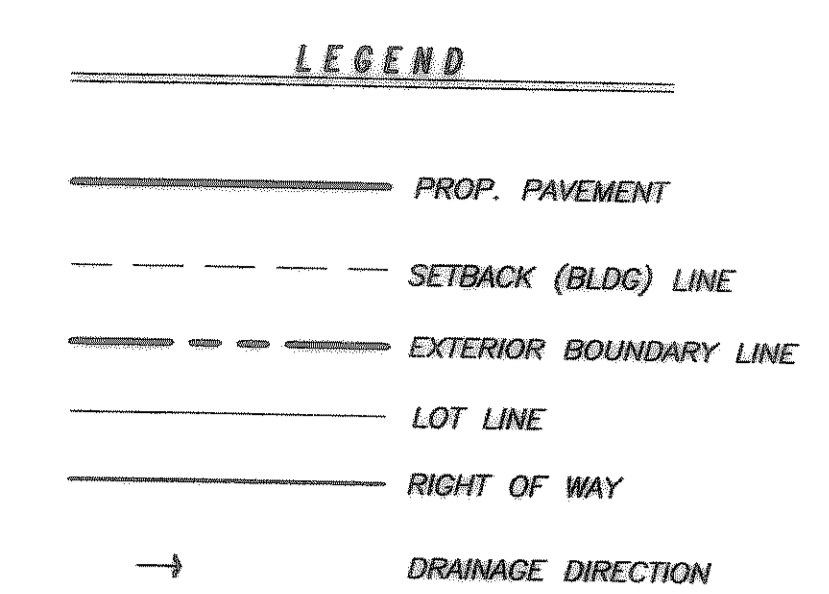

Construction Record Drawing
 8-22-2007

**Paving Plan and Profile
 Fontanna Blvd. & Bastrop Ct.**

Fontanna Ranch
 City of Rockwall, Rockwall County, Texas
 Spring Haven Investments, Inc.
 6750 Hillcrest Plaza Dr. • Suite 305 • Dallas, Texas 75230 • 972.386.3333

F.C. CUNY CORPORATION
 #2 Horizon Court • Heath, Texas 75032 • 469-402-7700

Drawn By	Checked By	Date	Scale	Project No.	Sheet No.
MSC	DJW	10/16/06	1/4" = 1'-0" 1/8" = 1'-0"	05-013	10 of 45

Z:\Projects\15-Residential\Fontanna\Record Drawings\Font-PAV.dwg Mon Aug 20 15:00:34 2007