

RW1/1 MASONRY WALL W/ 6V:1H BATTER
SCALE: N.T.S.

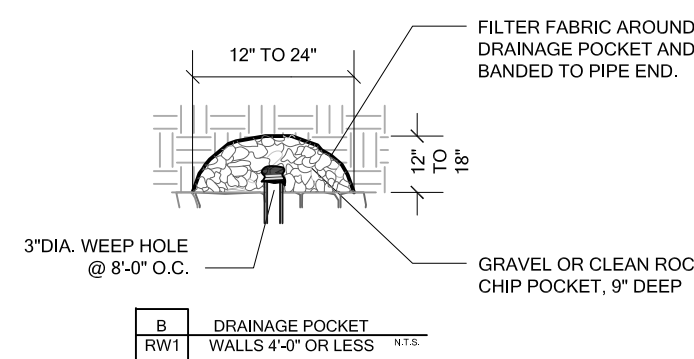

RW1/2 WALL SECTION W/ FENCE POST
SCALE: N.T.S.

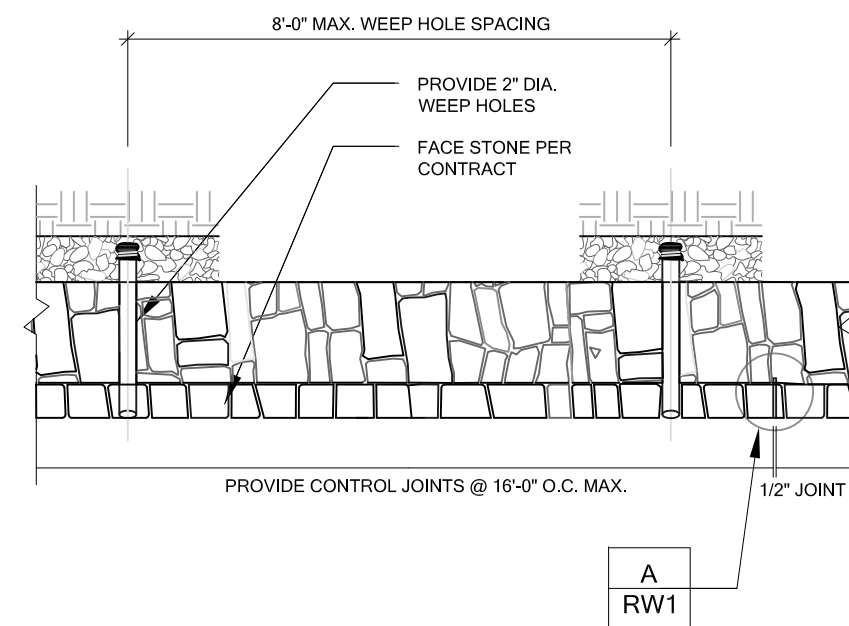

RW1/3 TYPICAL PLAN VIEW AT CORNER
SCALE: N.T.S.

RW1/4 TYPICAL PLAN VIEW AT BASE
SCALE: N.T.S.

1. Design Building Code
International Building Code, 2009 Edition

2. Geotechnical Report
Firm: ALPHA TESTING, INC.
Report No: G152466-1
Dated: June 17, 2016

3. Geotechnical Criteria
Bearing on Stiff Natural Undisturbed Clayey Sandy Soils or Compacted and Tested Soils
Allowable Bearing: 1500 psf minimum bearing on undisturbed or properly placed and compacted fills

Backfill Soil Parameters:
Backfill Soil - Natural Sandy Clays or Fill Soils
Backfill Angle of Internal Friction $\phi = 26$ degrees

Base Soil Parameters:
Soil at Toe - natural, Undisturbed or Fill Soils
Coefficient of friction = 0.30

The backfill soil angle of internal friction referred to above is a composite angle of internal friction and includes both cohesion and angle of internal friction of the soils.

The use of very wet or very dry backfill soil should be avoided. The use of heavy equipment within 3'-0" of the wall could damage the wall and should be avoided.

Locate base of walls on undisturbed or properly compacted soil.

4. Materials
Average density of masonry stone wall varies from 135 pcf to 145 pcf. Size of stone within wall varies from 4" to 18". Crushed concrete with or without rebar is acceptable to be used in the wall construction.

Drainage zone materials may be composed of clean gravel or stone ranging from 1" to 5". Crushed concrete is acceptable provided it is clean and generally free of dust or other deleterious materials.

Type 'S' cement mortar used for construction of the masonry stone retaining walls shall be mixed onsite with a minimum 28 day compressive strength of about $f_c = 2000$ psi.

5. Construction Reviews
DirtSavers, LLC. shall be called for construction review of masonry wall.

6. Retaining Wall Design Constraints
No surcharge load anticipated for structures located greater than 1.5 times wall height.

Maximum 4:1 top and toe slopes for all sections of wall.

Install weep holes for all walls 2' tall and over.

Contractor to provide fence sleeves as requested by owner.

Face stones to be per contract.

Minimum 5,000 psi face stones and type S Mortar Required.

Control joints shall be spaced at 25' maximum.

Drain cap to consist of compacted native clay soils with intent to limit absorption of surface runoff.

Walls constructed on fill areas shall be compacted per the geotech.

Due to highly expansive clay soils in this area it is recommended that lot owners maintain good watering practices to limit soil movements and excessive pressures on wall.

Minor variations in the construction of the retaining walls from these documents may be accepted at the discretion of the design engineer.

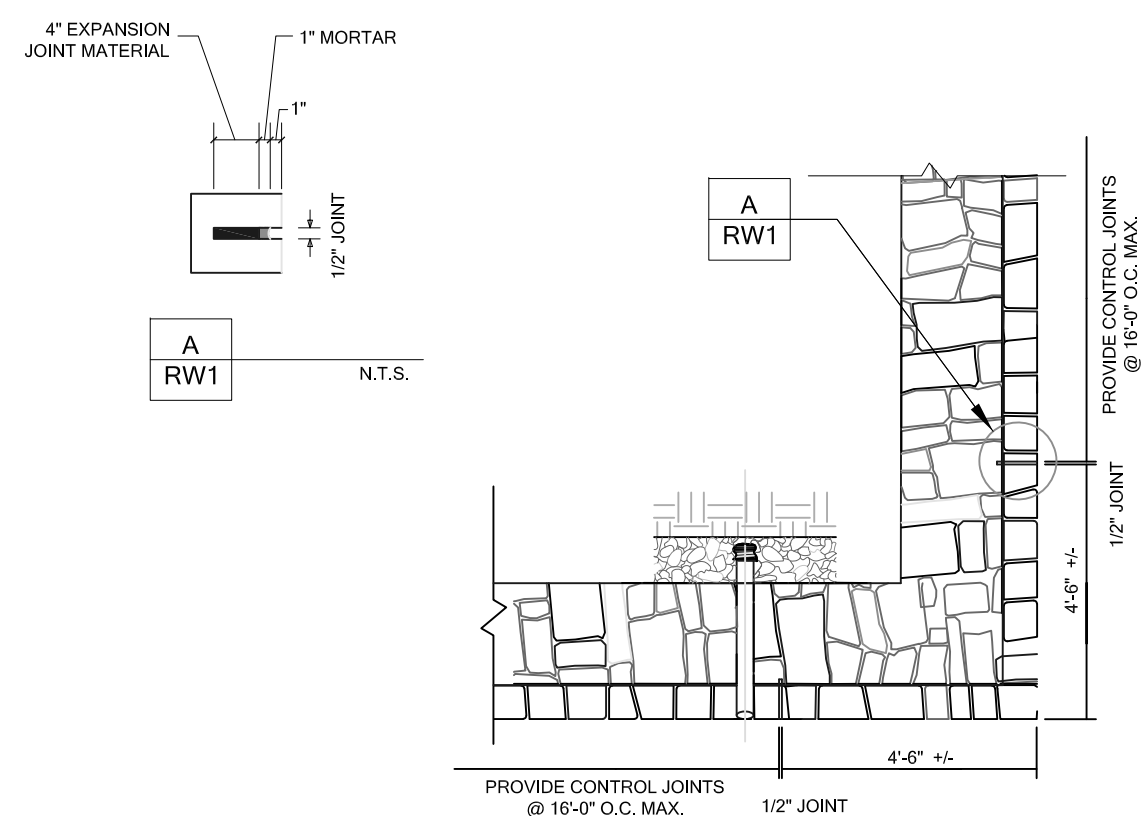

RW1/5 RETAINING WALL SCHEDULE

AS-BUILT

THIS DRAWING REFLECT CONSTRUCTION CHANGES IF ANY, NOTED BY THE CONTRACTOR OR OWNER AND PROVIDED TO DIRTSAVERS, LLC.

BY: *Michael Marshall*

DATE: 10.02.2018

MICHAEL MARSHALL, P.E.

DIRTSAVERS
PO BOX 566
ALEDO, TX 76008
PH: 469.834.7446
F: 14138

FONTANNA RANCH PH 3
MASONRY RETAINING WALLS
ROCKWALL, TEXAS

| No. | Date | Item |
|-----------|-----------|---------------|
| 1 | 8.24.2018 | PL SHOW RW1/1 |
| REVISIONS | | |
| DB: MAM | CHKD: MAM | APPD: MAM |

MICHAEL MARSHALL, P.E.
 08.24.2018

RETAINING WALL
DETAILS AND NOTES

Project No. RW073118-1
Date 07.31.2018
Last Revision 08.24.2018

RW1