

CAUTION EXISTING UTILITIES !!!

EXISTING UTILITIES AND UNDERGROUND FACILITIES INDICATED ON THESE PLANS HAVE BEEN LOCATED FROM REFERENCE INFORMATION. IT SHALL BE THE RESPONSIBILITY OF THE CONTRACTOR TO VERIFY BOTH HORIZONTALLY AND VERTICALLY THE LOCATION OF ALL EXISTING UTILITIES AND UNDERGROUND FACILITIES PRIOR TO CONSTRUCTION, TO TAKE THE NECESSARY PRECAUTIONS IN ORDER TO PROTECT ALL FACILITIES ENCOUNTERED. THE CONTRACTOR SHALL PRESERVE AND PROTECT ALL EXISTING UTILITIES FROM DAMAGE DURING CONSTRUCTION.

BENCHMARK:
 "X" ON TOP OF CURB WEST NOSE OF MEDIAN AT ENTRANCE TO FONTANNA RANCH WIMBERLEY LN.
 ELEV. 570.06

System ID	Collection Point Station			# of Barrels	Selected Pipe Size (in)	Conduit Properties				Incremental Drainage Area										HGL										Headloss Calculations								
	Upstream Station	Downstream Station	Distance Between Points			Conduit Area (ft ²)	Wetted Perimeter (ft)	Hydraulic Radius (ft)	Manning's n	Flowline Elevation Upstream	Flowline Elevation Downstream	Pipe Slope S (ft/ft)	Inlet ID	Drainage Area "A" (Acres)	Coefficient "C"	Run-off "CA"	Incremental "CA"	Accumulated "CA"	Upstream Tc (years)	Design Storm Frequency (years)	Intensity "I" (in/hr)	Storm Water Runoff Q (cfs)	Pipe Capacity Q (cap) (cfs)	Partial Flow (YES/NO)	Velocity In Sewer (fps)	Time in Conduit (min)	Friction Slope Sf (ft/ft)	Friction Head Loss (ft)	Elevation Upstream	Elevation Downstream	V1^2/2g	V2^2/2g	Junction Type	Coefficient Kj	Headloss HL	Design HGL Elevation	Top of Curb Elevation	Pipe Cover Upstream
Line 'C'	0+40.00	0+00.00	40.00	1	33	5.94	8.64	0.688	0.013	569.16	568.76	0.0100	0	0.5	0.00	3.60	10.70	100	9.80	35.23	53.03	YES	5.93	0.11	0.00441	0.177	571.93	571.75	1.22	0.55	Pipe Size Change	0.25	0.14	572.06	576.00	4.09	3.94	
Line 'C'	0+80.00	0+40.00	40.00	1	27	3.98	7.07	0.563	0.013	571.34	569.66	0.0420	0	0.5	0.00	3.60	10.24	100	9.80	35.23	63.64	YES	8.86	0.08	0.01287	0.515	572.58	572.06	0.52	1.22	Slope Change	0.25	0.30	572.88	577.00	3.41	4.12	
Line 'C'	1+22.92	0+80.00	42.92	1	27	3.98	7.07	0.563	0.013	572.31	571.34	0.0226	0	0.5	0.00	3.60	10.51	100	9.80	35.23	46.68	YES	8.86	0.08	0.01287	0.552	573.44	572.88	0.46	1.22	60 deg. Wye	0.35	1.06	574.49	580.00	5.44	5.51	
Lat 'C-1'	0+58.16	0+00.00	58.16	1	24	3.14	6.28	0.500	0.013	575.00	572.33	0.0459	INLET 5	3.7	0.50	1.85	10.00	100	9.80	18.13	48.60	YES	5.77	0.17	0.00639	0.372	574.86	574.49	N/A	0.52	Y Inlet	1.25	0.65	575.51	579.00	2.00	3.49	
Line 'C'	1+63.06	1+22.92	40.14	1	24	3.14	6.28	0.500	0.013	573.46	572.55	0.0227	INLET 6	0.32	0.5	0.16	10.00	100	9.80	17.10	34.15	YES	5.44	0.12	0.00568	0.228	574.72	574.49	0.38	0.46	45 deg. Wye	0.5	0.27	574.99	578.50	3.04	3.51	
Lat 'C-2'	0+21.76	0+00.00	21.76	1	18	1.77	4.71	0.375	0.013	574.26	573.76	0.0230	INLET 6	0.32	0.5	0.16	10.00	100	9.80	1.57	15.97	YES	0.89	0.41	0.00022	0.005	575.00	574.99	N/A	0.01	Curb Inlet	1.25	0.02	575.01	578.20	2.44	3.19	
Line 'C'	1+70.03	1+63.06	6.97	1	24	3.14	6.28	0.500	0.013	573.62	573.46	0.0230	INLET 7	0	0.5	0.00	1.59	10.36	100	9.80	15.53	34.37	YES	4.94	0.02	0.00469	0.033	575.02	574.99	0.98	0.38	45 deg. Wye	0.5	0.05	575.06	578.20	2.58	3.14
Lat 'C-3'	0+16.66	0+00.00	16.66	1	18	1.77	4.71	0.375	0.013	574.26	573.97	0.0174	INLET 7	0.31	0.5	0.16	10.00	100	9.80	1.52	13.90	YES	0.86	0.32	0.00021	0.003	575.06	575.06	N/A	0.01	Curb Inlet	1.25	0.01	575.08	578.20	2.44	3.12	
Line 'C'	2+96.71	1+70.03	126.68	1	18	1.77	4.71	0.375	0.013	575.42	574.12	0.0103	INLET 8	0	0.5	0.00	1.43	10.10	100	9.80	10.67	10.67	NO	7.93	0.27	0.01770	2.243	577.30	575.06	0.14	0.98	Slope Change	0.25	0.03	577.34	579.95	3.03	2.61
Line 'C'	3+23.53	2+96.71	25.82	1	18	1.77	4.71	0.375	0.013	576.40	575.42	0.0366	INLET 8	0	0.5	0.00	1.43	0.00	100	9.80	14.01	20.15	YES	7.93	0.05	0.01770	0.457	577.79	577.34	0.00	0.98	60 deg. Wye	0.35	0.00	577.79	579.95	2.05	2.16
Lat 'C-4'	0+32.87	0+00.00	32.87	1	18	1.77	4.71	0.375	0.013	575.00	576.40	0.0183	INLET 11	1.79	0.5	0.90	10.00	100	9.80	8.77	14.23	YES	4.96	0.11	0.00693	0.228	578.02	577.79	N/A	0.38	Slope Change	1.25	0.48	578.50	581.00	2.50	2.50	
Line 'C'	3+39.87	3+23.53	17.34	1	18	1.77	4.71	0.375	0.013	577.00	576.40	0.0366	INLET 8	1.07	0.5	0.54	0.54	10.00	100	9.80	5.24	20.15	YES	2.97	0.10	0.00248	0.043	577.84	577.79	N/A	0.14	Curb Inlet	1.25	0.17	578.01	581.00	2.50	2.99

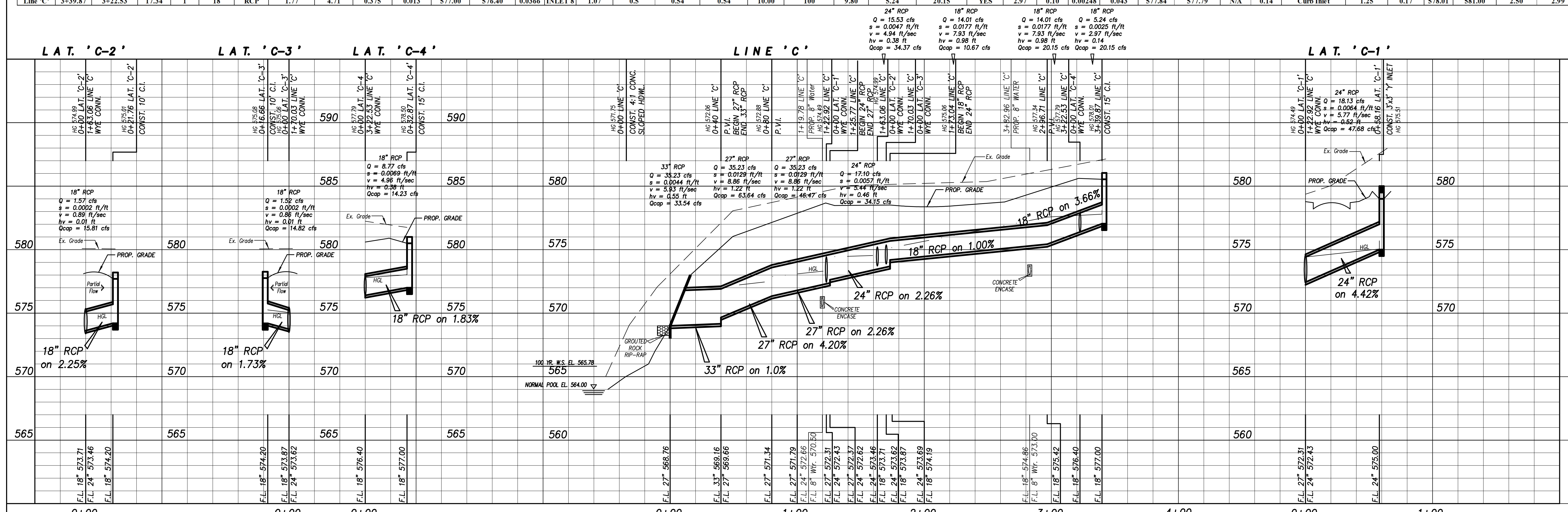

Revision	Date	Description

FONTANNA RANCH, LTD.
 6750 HILLCREST PLAZA DR., S. 325 • DALLAS, TX 75230 • 972-386-3333

Fontanna Ranch Ph. 3

F.C. CUNY CORPORATION
 #2 Horizon Court • Ste. 500 • Heath, Texas 75032
 Phone: 469-402-7700
 Fax: 469-402-0700
 Texas Registered Engineering Firm F-7449

THE SEAL APPEARING ON THIS DOCUMENT WAS AUTHORIZED BY CHRISTOPHER R. CUNY, P.E. 65642

9-11-2018
 F.C. CUNY CORPORATION
 F-7449

Drawn By: FC CUNY
 Checked By: FC CUNY
 Date: 4-1
 Project No.:
 Sheet Title: **Line C Storm Sewer Plan & Profile**
 Scale: h: 1" = 40'
 v: 1" = 4'
 Sheet No.: 13 of 18

Fontanna Ranch Ph. 3