

CAUTION EXISTING UTILITIES !!!

EXISTING UTILITIES AND UNDERGROUND FACILITIES INDICATED ON THESE PLANS HAVE BEEN LOCATED FROM REFERENCE INFORMATION. IT SHALL BE THE RESPONSIBILITY OF THE CONTRACTOR TO VERIFY BOTH HORIZONTALLY AND VERTICALLY THE LOCATION OF ALL EXISTING UTILITIES AND UNDERGROUND FACILITIES PRIOR TO CONSTRUCTION, TO TAKE THE NECESSARY PRECAUTIONS IN ORDER TO PROTECT ALL FACILITIES ENCOUNTERED. THE CONTRACTOR SHALL PRESERVE AND PROTECT ALL EXISTING UTILITIES FROM DAMAGE DURING CONSTRUCTION.

BENCHMARK:
 * ON TOP OF CURB WEST NOSE OF MEDIAN AT ENTRANCE TO FONTANNA RANCH WIMBERLEY LN.
 ELEV. 570.06

System ID	Conduit Properties										Incremental Drainage Area										Headless Calculations																		
	Upstream Station	Downstream Station	Between Points	# of Barrels	Selected	Conduit Material	Conduit	Wetted	Hydraulic	Manning's	Flowline	Flowline	Pipe	Inlet	Drainage	Run-off	Incremental	Accumulated	Upstream	Design Storm	Intensity	Storm Water	Pipe Capacity	Partial	Velocity	Time in	Friction	Friction	HGL	Headless Calculations									
	Station	Station	Points		Pipe Size (in)	Type	Area of Flow (ft ²)	Perimeter (ft)	Radius	n value	Elevation Upstream	Elevation Downstream	Slope S (ft/ft)	ID	Area "A" (Acres)	Coefficient "C"	"CA"	"CA"	Tc	Frequency (years)	"I" (in/hr)	Runoff Q (cfs)	Q(cap) cfs	Flow (YES/NO)	In Sewer (ft/s)	Conduit (min)	Slope Sf (ft/ft)	Head Loss (ft)	Elevation Upstream	Elevation Downstream	V1^2/2g	V2^2/2g	Junction Type	Coefficient	HeadLoss HL	Design HGL	Top of Curb Elevation	Pipe Cover Upstream	HGL Depth Below T.C.
Line 'A'	1+58.50	0+00.00	158.50	1	24	RCP	3.14	6.28	0.500	0.013	581.79	581.07	0.0045	INLET 1	1.19	0.50	0.60	1.39	10.76	100	9.80	13.62	15.29	YES	4.34	0.61	0.00361	0.572	583.18	582.61	0.16	0.29	Curb Inlet (wye)	1.00	0.13	583.31	585.40	1.61	2.09
Line 'A'	1+87.50	1+58.50	29.00	1	21	RCP	2.41	5.50	0.438	0.013	582.19	582.04	0.0045	INLET 2	1.59	0.50	0.80	1.80	10.00	100	9.80	7.79	11.43	YES	3.24	0.15	0.00240	0.070	583.38	583.31	N/A	0.16	Curb Inlet	1.25	0.20	583.58	585.40	1.46	1.82
Line 'B'	1+77.28	0+00.00	177.28	1	24	RCP	3.14	6.28	0.500	0.013	582.06	581.34	0.0041		0	0.5	1.51	1.49	12.28	100	9.80	14.60	14.46	NO	4.65	0.64	0.00414	0.735	583.34	582.61	0.34	0.34	60 deg. Bend	0.43	0.14	583.49	586.60	2.54	3.11
Line 'B'	1+91.84	1+77.28	14.56	1	24	RCP	3.14	6.28	0.500	0.013	582.15	582.06	0.0060		0	0.5	0.66	1.49	11.59	100	9.80	14.60	17.63	YES	4.65	0.05	0.00414	0.060	583.55	583.49	0.18	0.34	45 deg. Wye	0.5	0.25	583.79	586.67	2.52	2.88
Lat 'B-1'	0+23.11	0+00.00	23.11	1	21	RCP	2.41	5.50	0.438	0.013	583.67	582.26	0.0610	INLET 3	1.31	0.5	0.66	0.67	10.00	100	9.80	6.57	39.24	YES	2.73	0.14	0.00171	0.039	583.83	583.79	0.00	0.12	Inlet	1.25	0.14	583.98	586.67	1.25	2.69
Line 'B'	3+00.00	1+91.84	108.16	1	21	RCP	2.41	5.50	0.438	0.013	583.43	582.40	0.0095		1.67	0.5	0.84	0.84	11.06	100	9.80	8.18	15.50	YES	3.40	0.53	0.00265	0.287	584.08	583.79	0.18	0.18	Slope Change	0.25	0.04	584.13	587.73	2.55	3.60
Line 'B'	5+17.25	3+00.00	217.25	1	21	RCP	2.41	5.50	0.438	0.013	587.32	583.43	0.0179	INLET 4	1.67	0.5	0.84	0.84	10.00	100	9.80	8.18	21.26	YES	3.40	1.06	0.00265	0.576	584.70	584.13	N/A	0.18	Curb Inlet	1.25	0.22	588.29	591.32	2.25	3.03

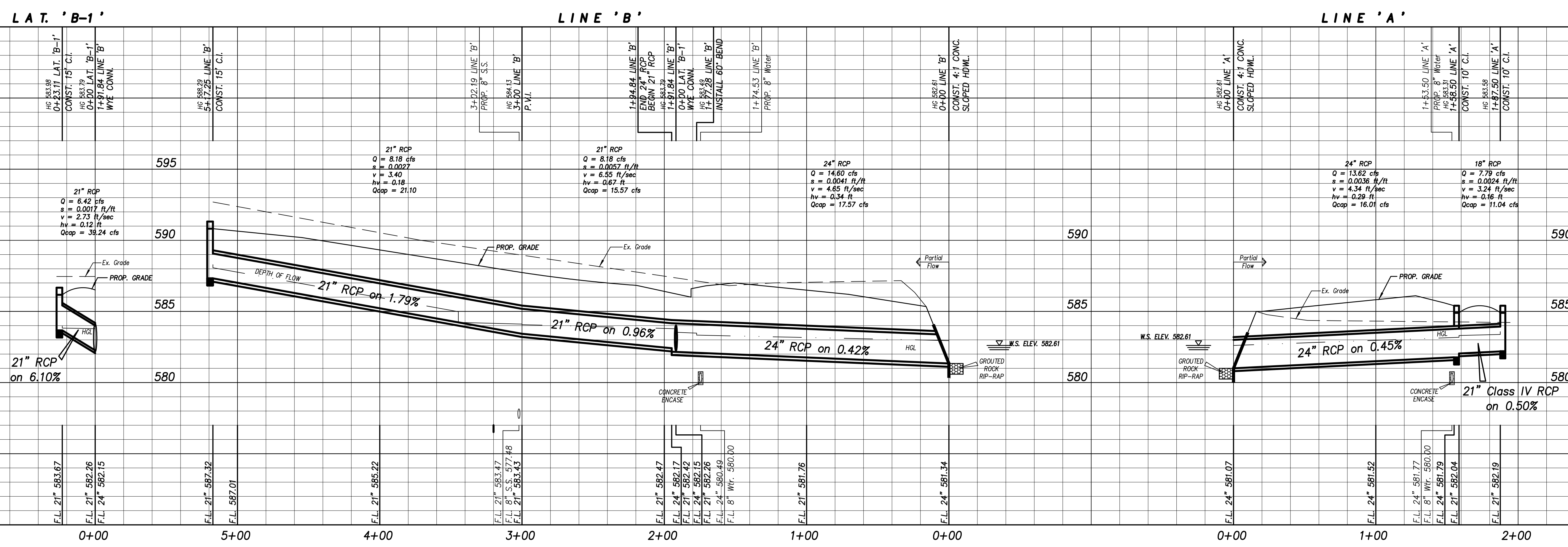

Revision	Date	Description

Fontanna Ranch Ph. 3

FONTANNA RANCH, LTD.
 6750 HILLCREST PLAZA DR., S. 325 • DALLAS, TX 75230 • 972-386-3333

Fontanna Ranch Ph. 3

F.C. CUNY CORPORATION
 #2 Horizon Court • Ste. 300 • Heath, Texas 75032
 Phone: 469-402-7700
 Fax: 469-402-0700
 Texas Registered Engineering Firm F-7449

THE SEAL APPEARING ON THIS DOCUMENT WAS AUTHORIZED BY CHRISTOPHER R. CUNY, P.E. 65642

F.C. CUNY, CORPORATION
 F-7449

Drawn By: FC CUNY Checked By: FC CUNY
 Date: 4-1 Project No.:
 Sheet Title: **Lines A & B Storm Sewer Plan & Profile**
 Scale: h: 1" = 40' Sheet No.: 12 of 18
 v: 1" = 4'