

PARK SPACE DEDICATED TO THE CITY OF ROCKWALL TO BE MAINTAINED BY H.O.A.

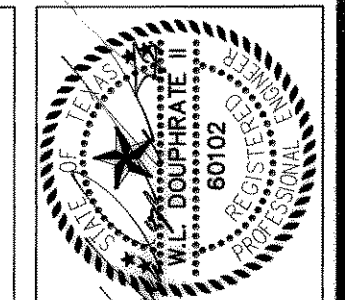

THE SEAL APPEARING ON THIS DOCUMENT WAS AUTHORIZED BY W.L. DOUPHRAE II TEXAS P.E. NO. 60102 ON 11/17/04

DOUPHRAE & ASSOCIATES, INC.
 ENGINEERING - PROJECT MANAGEMENT - SURVEYING
 2235 RIDGE RD., # 200 ROCKWALL, TEXAS 75087
 PHONE: (972)771-8004 FAX: (972)771-8005

STORM SEWER (LINE C & C-2)
 FLAGSTONE ESTATES
 CITY OF ROCKWALL
 ROCKWALL COUNTY, TEXAS

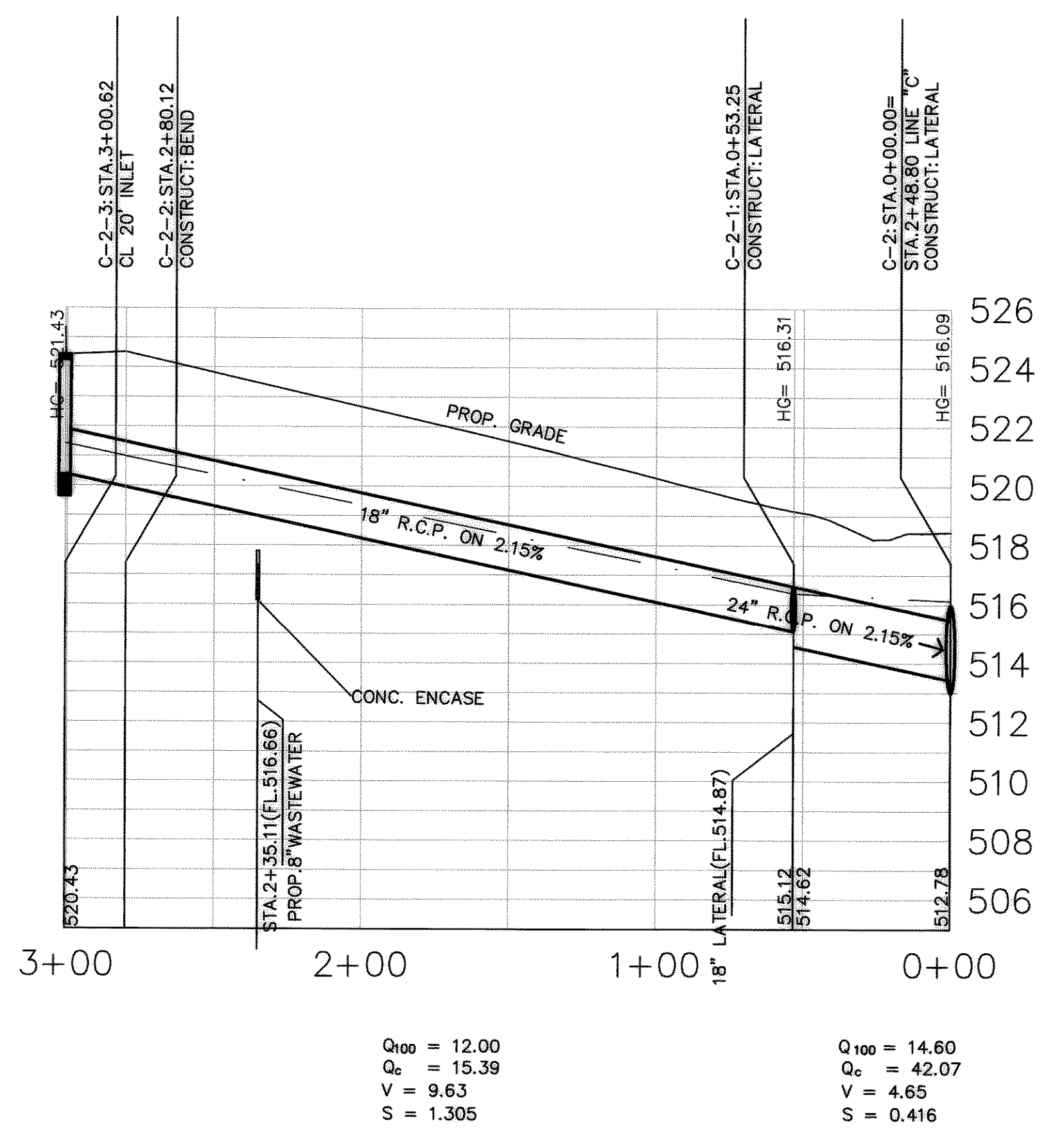

$Q_{100} = 12.00$
 $Q_c = 15.39$
 $V = 9.63$
 $S = 1.305$

$Q_{100} = 14.60$
 $Q_c = 42.07$
 $V = 4.65$
 $S = 0.416$

LINE: "C-2"

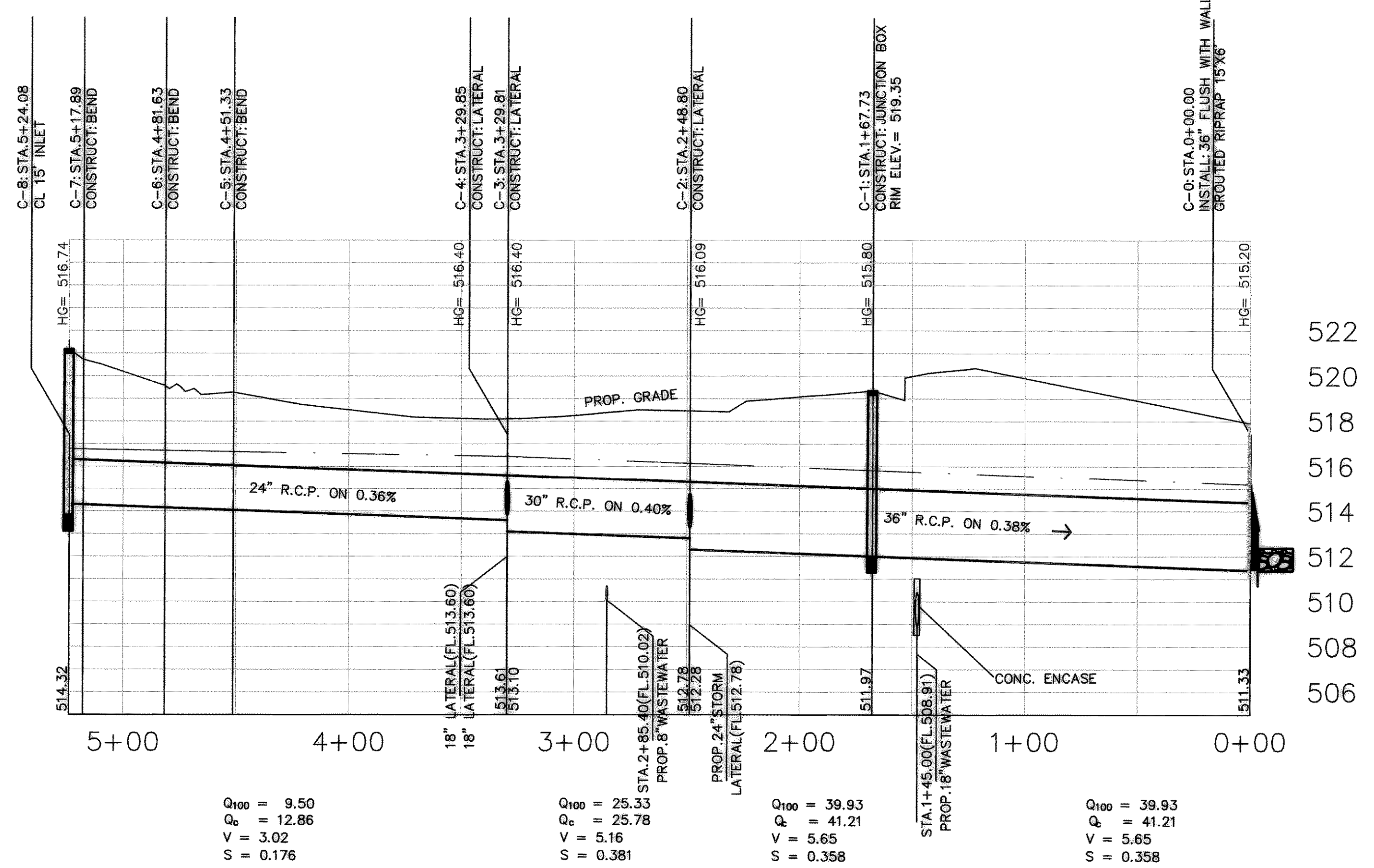

$Q_{100} = 9.50$
 $Q_c = 12.86$
 $V = 3.02$
 $S = 0.176$

$Q_{100} = 25.33$
 $Q_c = 25.78$
 $V = 5.16$
 $S = 0.381$

$Q_{100} = 39.93$
 $Q_c = 41.21$
 $V = 5.65$
 $S = 0.358$

$Q_{100} = 39.93$
 $Q_c = 41.21$
 $V = 5.65$
 $S = 0.358$

LINE: "C"

REVISED TO CONFORM TO CONSTRUCTION RECORDS.
 DATE: 10/27/04

REVISION
CHECKED: K.E.B.
DRAWN: D.L.B.
DATE: 9/04
PROJECT: