

EXISTING

PROPOSED

CONN. TO EXIST. 8" W/ALL APPURTENANCES  
INSTALL:  
1-8" TEE  
1-8" GATE VALVE

PRS REALTY VOL. 961, PG. D.R.R.C.T.

8.44 AC VOL. 1406, PG. D.R.R.C.T.

STATE OF TEXAS VOL. 65, PG. 591 D.R.R.C.T.

PAV. STA: 3+76.33  
1-6" F.H. W/ALL APPURTENANCES

PAV. STA: 8+31.99  
1-90° BEND  
1-8" GATE VALVE  
1-6" F.H. W/ALL APPURTENANCES

PAV. STA: 17+93.42  
CONN. TO EXIST. 8"  
INSTALL:  
1-90° BEND  
2-8" GATE VALVE

INSTALL:  
3-8" GATE VALVES  
2-8" TEES

INSTALL:  
2-8" GATE VALVES  
1-8" TEES

INSTALL:  
2-8" GATE VALVES  
1-8" TEES

INSTALL:  
1-8"x8" TEE  
1-8" VALVE  
1-45° BEND

INSTALL:  
1-8"x8" TEE  
1-8" VALVE  
1-45° BEND

INSTALL:  
1-6" F.H. W/ALL APPURTENANCES  
1-8"x8" TEE  
2-8" GATE VALVES

INSTALL:  
1-6" F.H. W/ALL APPURTENANCES  
1-8"x8" TEE  
2-8" GATE VALVES

INSTALL:  
1-6" F.H. W/ALL APPURTENANCES  
1-8"x8" TEE  
2-8" GATE VALVES

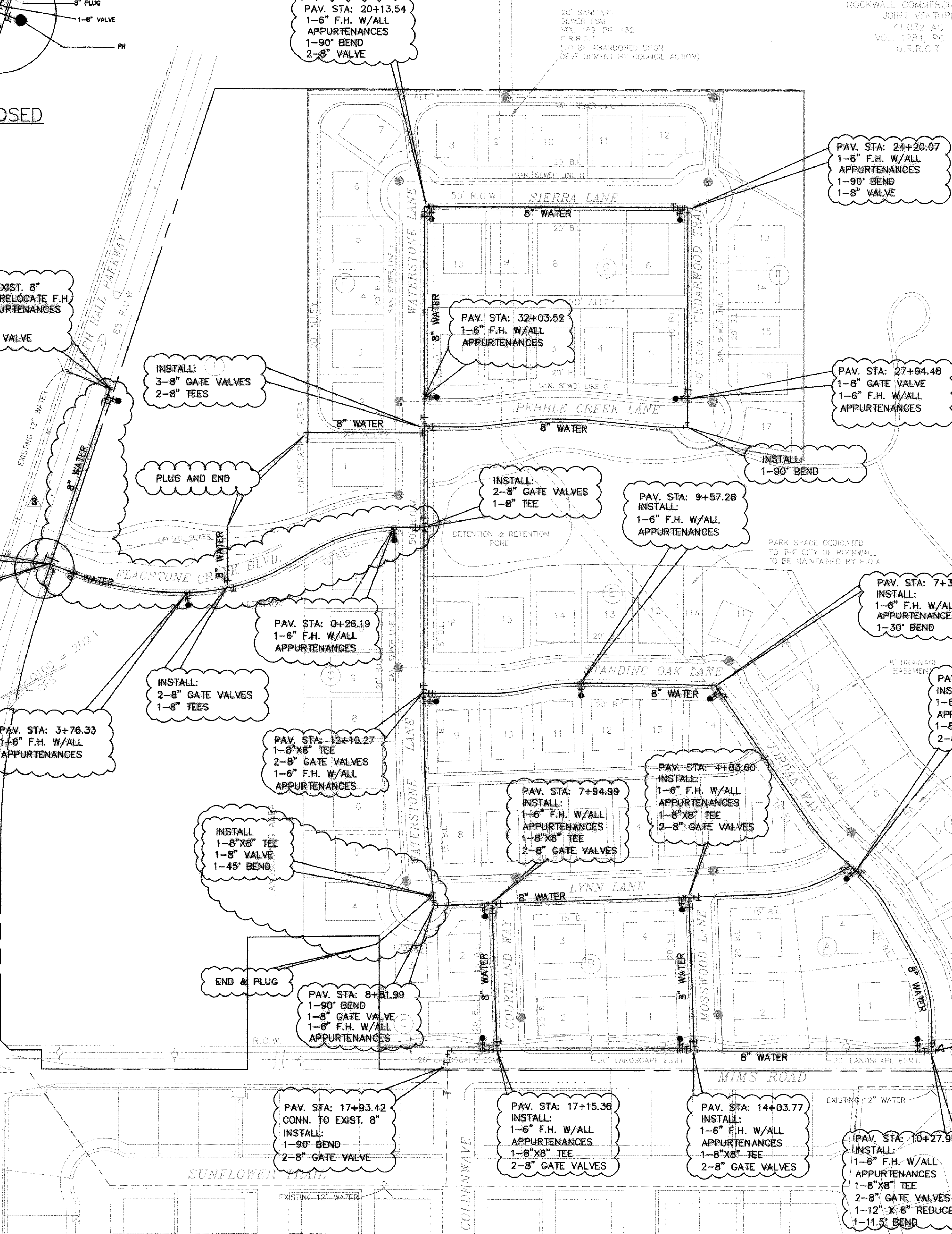

LOT 1, BLOCK B  
ROCKWALL, COMMERCIAL PARK  
JOINT VENTURE  
41.032 AC.  
VOL. 1294, PG. 19  
D.R.R.C.T.

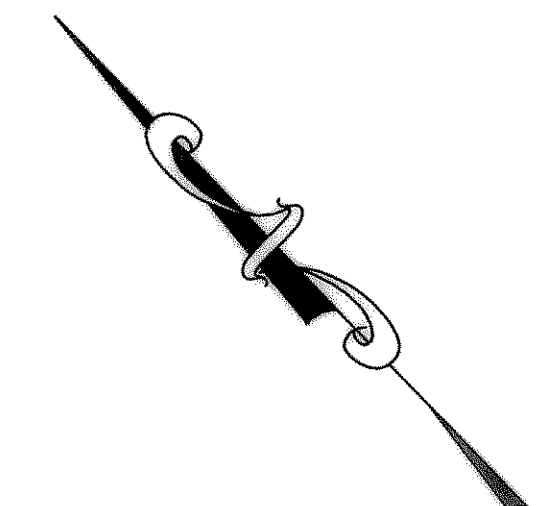
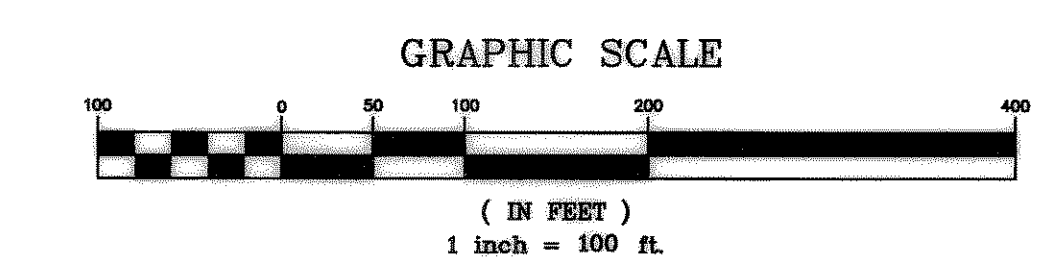

REVISED TO CONFORM TO CONSTRUCTION RECORDS.  
DATE: 10/27/66

**GENERAL NOTES**

1. ALL WATER LINES TO BE CLASS 200
2. BLUE EMS DISK TO BE INSTALLED AT EVERY CHANGE IN DIRECTION, SERVICE, AND VALVE.
3. ALL WTR SERVICES TO BE A MIN. OF 10' FROM SAN SERVICE

**BENCHMARKS:**

B.M. = SQUARE CUT TOP OF CURB CENTER OF CURB INLET N. SIDE OF RALPH HALL PKWY. & 325'± EAST OF MIMS ROAD (45'± W. OF W. PROPERTY LINE) ELEV = 549.34

B.M. = SQUARE CUT TOP OF CURB CENTER OF CURB INLET N. SIDE OF RALPH HALL PKWY. & 1530'± EAST OF MIMS ROAD (65'± W. OF E. PROPERTY LINE) ELEV = 540.41

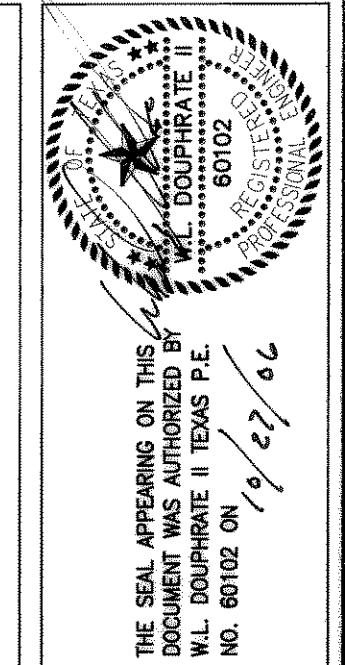

**DOUPHRADE & ASSOCIATES, INC.**  
ENGINEERING - PROJECT MANAGEMENT - SURVEYING  
2235 RIDGE RD., # 200 ROCKWALL, TEXAS 75087  
PHONE: (972)771-9004 FAX: (972)771-9005

**WATER PLAN**  
**FLAGSTONE ESTATES**  
**CITY OF ROCKWALL**  
**ROCKWALL COUNTY, TEXAS**

REVISION	01-18-06
CHECKED	SAH
DRAWN	DLB
DATE	9/04
PROJECT	0114WAT
	24 OF