

HIGH POINT ELEV = 530.61  
HIGH POINT STA = 0+08.89  
PVI STA = 0+18.04  
PVI ELEV = 530.70  
A.D. = -6.20  
K = 4.04

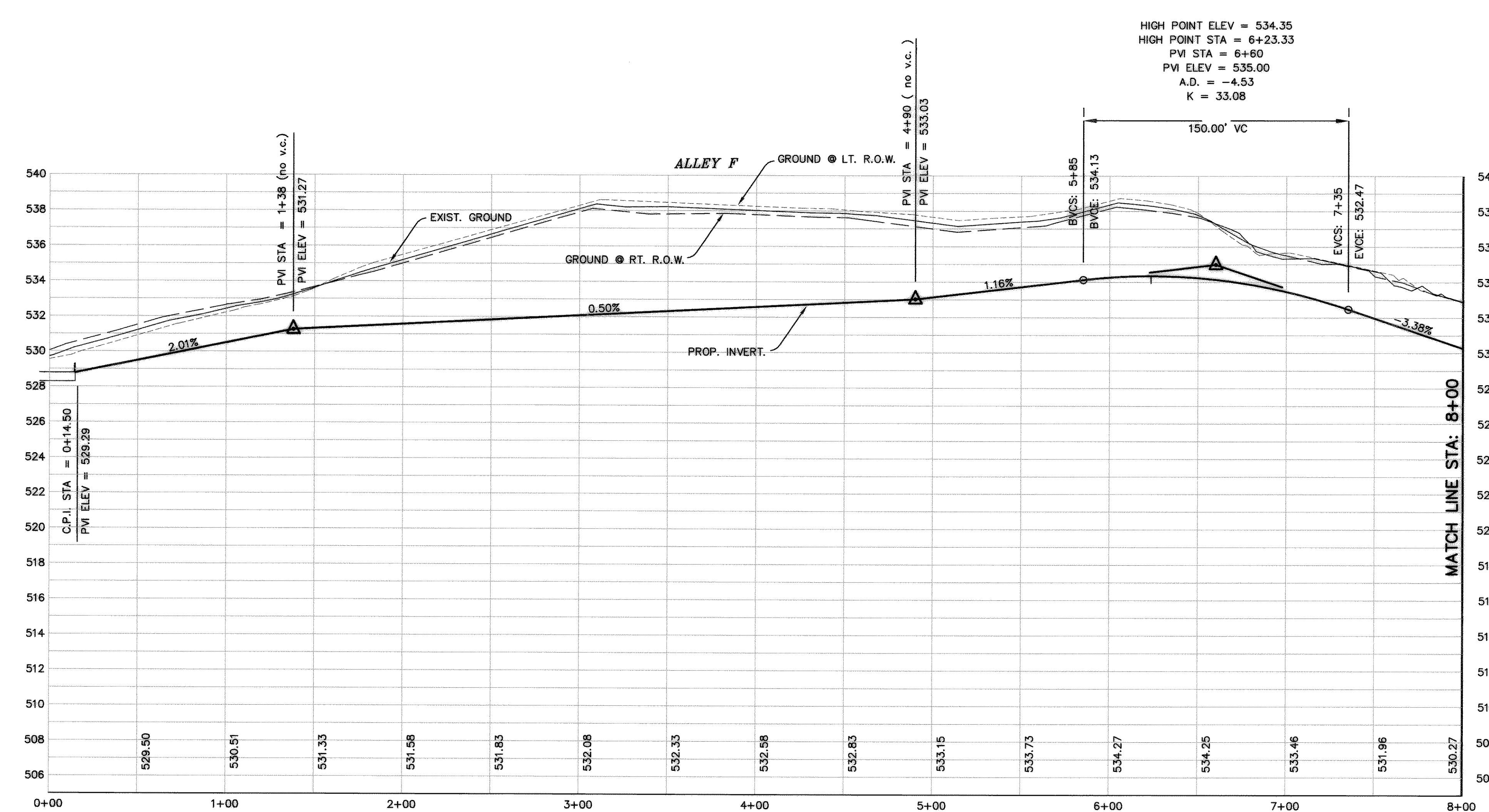

REVISED TO CONFORM TO CONSTRUCTION RECORDS.  
DATE: 10/27/04

**BENCHMARKS:**  
B.M. = SQUARE CUT TOP OF CURB CENTER OF CURB INLET N. SIDE OF RALPH HALL PKWY. & 325' EAST OF MIMS ROAD (45' W. OF W. PROPERTY LINE) ELEV = 549.34  
B.M. = SQUARE CUT TOP OF CURB CENTER OF CURB INLET N. SIDE OF RALPH HALL PKWY. & 155' EAST OF MIMS ROAD (65' W. OF E. PROPERTY LINE) ELEV = 540.41

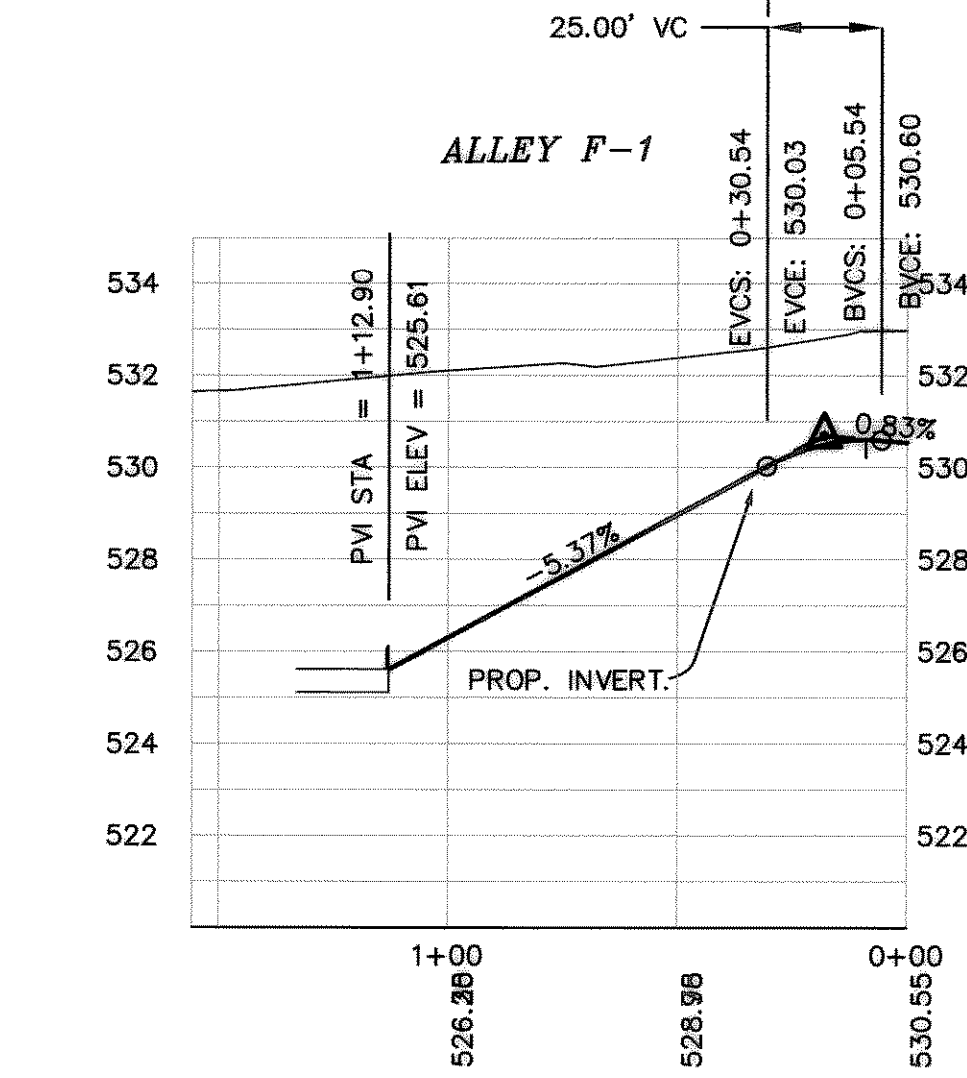
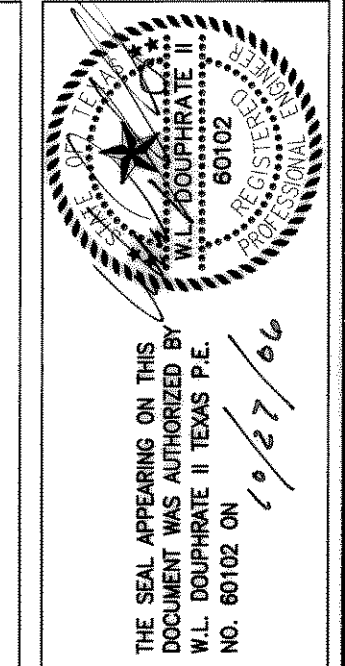

**DOUPHRADE & ASSOCIATES, INC.**  
ENGINEERING - PROJECT MANAGEMENT - SURVEYING  
2235 RIDGE RD., # 200 ROCKWALL, TEXAS 75087  
PHONE: (972)771-0004 FAX: (972)771-0005

**PAVING PLAN & PROFILE**  
ALLEY "F" STA: 0+00 TO 8+00 & ALLEY F-1  
FLAGSTONE ESTATES  
CITY OF ROCKWALL, ROCKWALL COUNTY, TEXAS

REVISION	
CHECKED	KEB
DRAWN	DLB
DATE	07/04
PROJECT	0144PV-13
	20