

THE SEAL APPEARING ON THIS DOCUMENT WAS AUTHORIZED BY W.L. DOUPHRATE, TEXAS P.E. NO. 60102 ON 10/21/04

DOUPHRATE & ASSOCIATES, INC.
 ENGINEERING - PROJECT MANAGEMENT - SURVEYING
 2235 RIDGE RD., # 200 ROCKWALL, TEXAS 75087
 PHONE: (972)771-9004 FAX: (972)771-9005

PAVING PLAN & PROFILE
ALLEY "G"
 FLAGSTONE ESTATES
 CITY OF ROCKWALL, ROCKWALL COUNTY, TEXAS

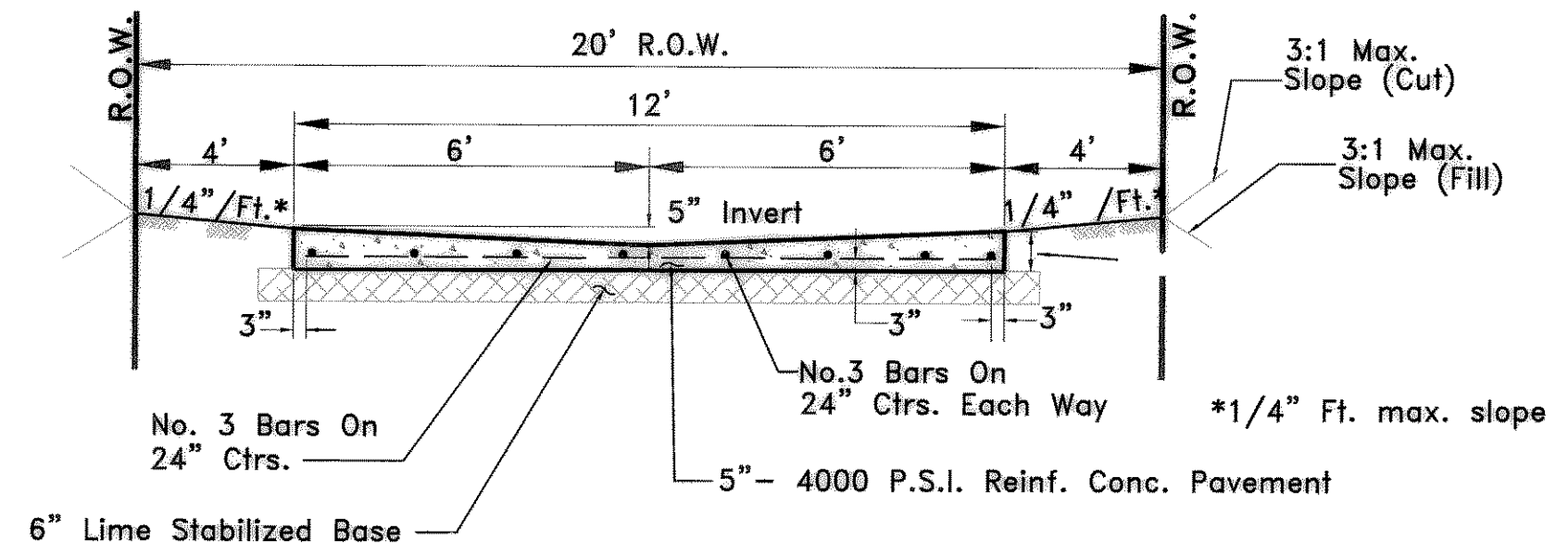
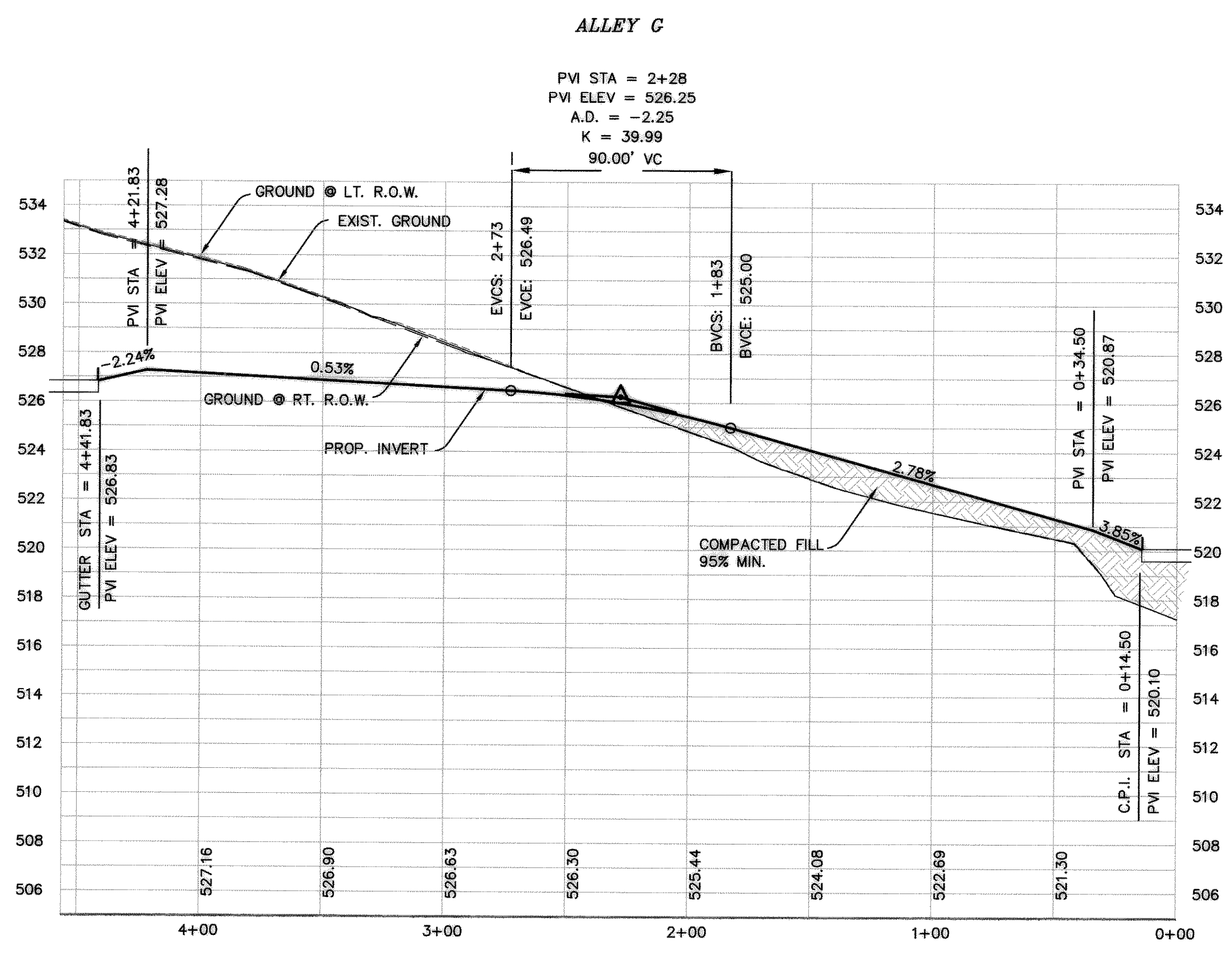
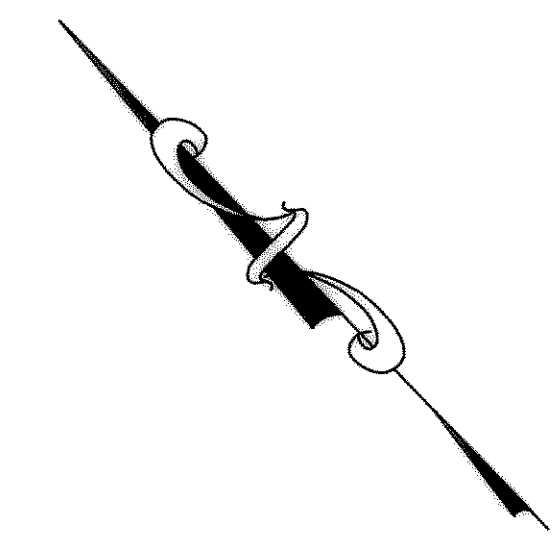
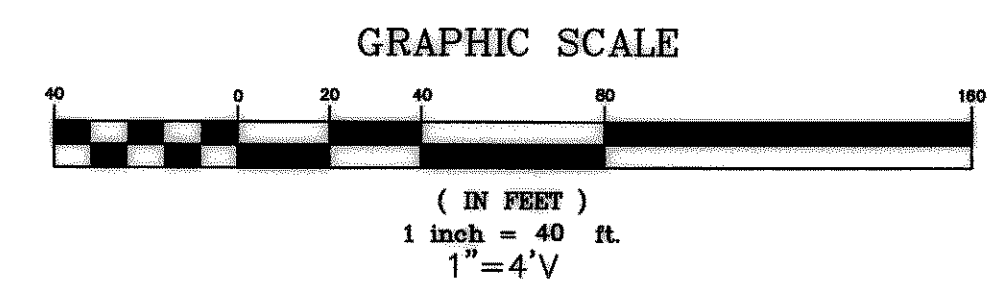
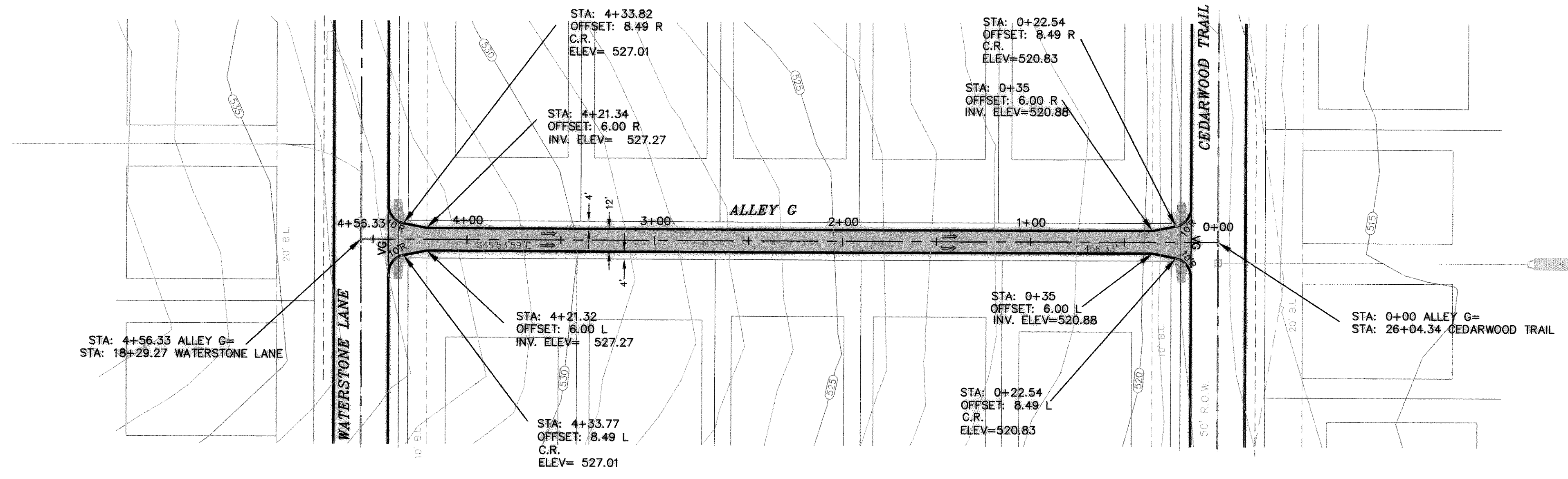

REVISED TO CONFORM TO CONSTRUCTION RECORDS.
W. Douphrate DATE: 10/22/04

BENCHMARKS:
 B.M. = SQUARE CUT TOP OF CURB CENTER OF CURB INLET N. SIDE OF RALPH HALL PKWY. & 325' EAST OF MIMS ROAD (65' W. OF W. PROPERTY LINE) ELEV = 549.34
 B.M. = SQUARE CUT TOP OF CURB CENTER OF CURB INLET N. SIDE OF RALPH HALL PKWY. & 1530' EAST OF MIMS ROAD (65' W. OF E. PROPERTY LINE) ELEV = 540.41

REVISION
KEB
DLB
07/04
0114PV-12