

GRADPAVE
Xref:
Bldg
Border40
Culvert
Curb1
ExCont1
Pond
SanSew
Sidewalk
Topo2
WS-pipes
Street
PropCont
Legend1
Sleeves

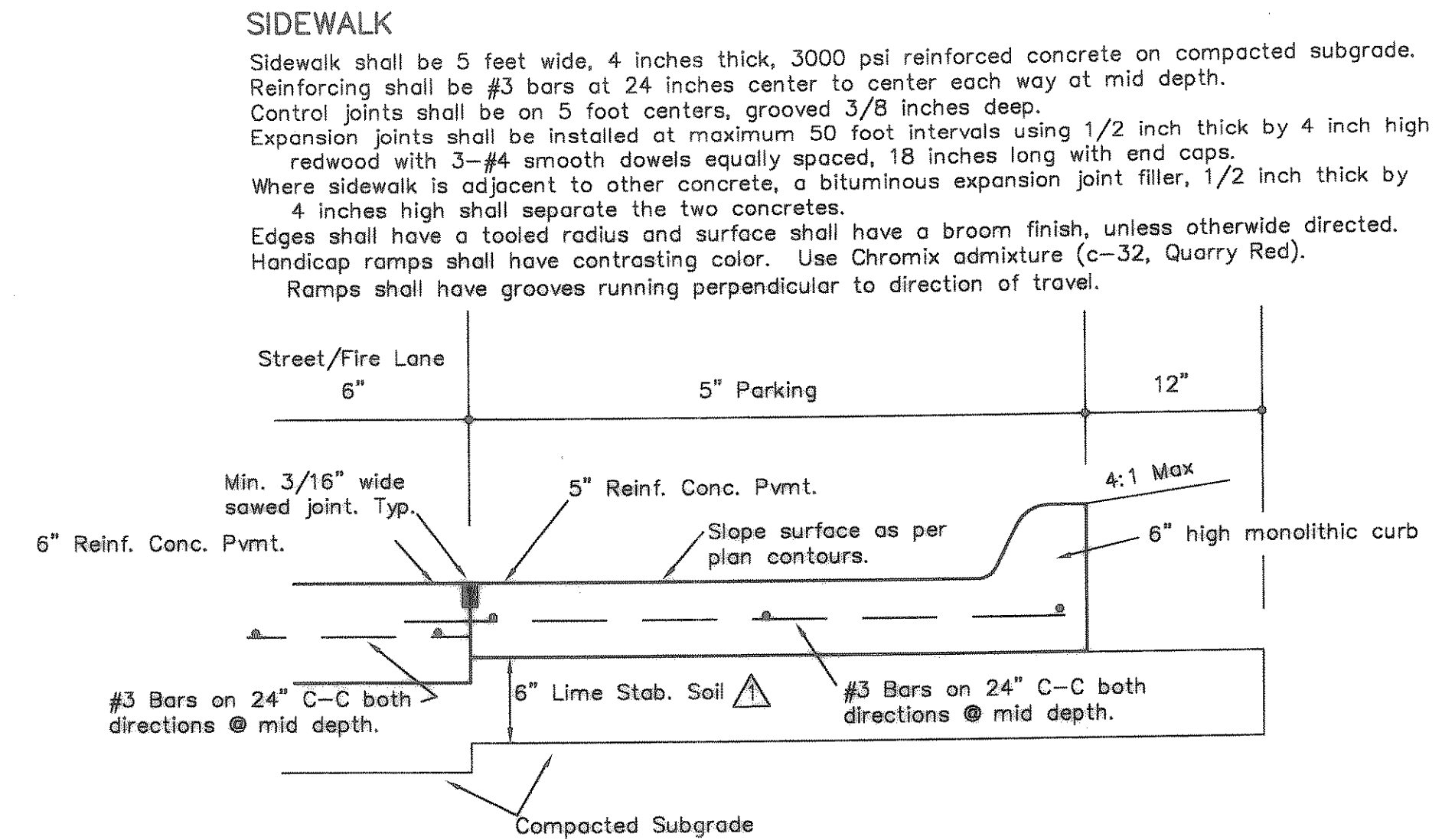
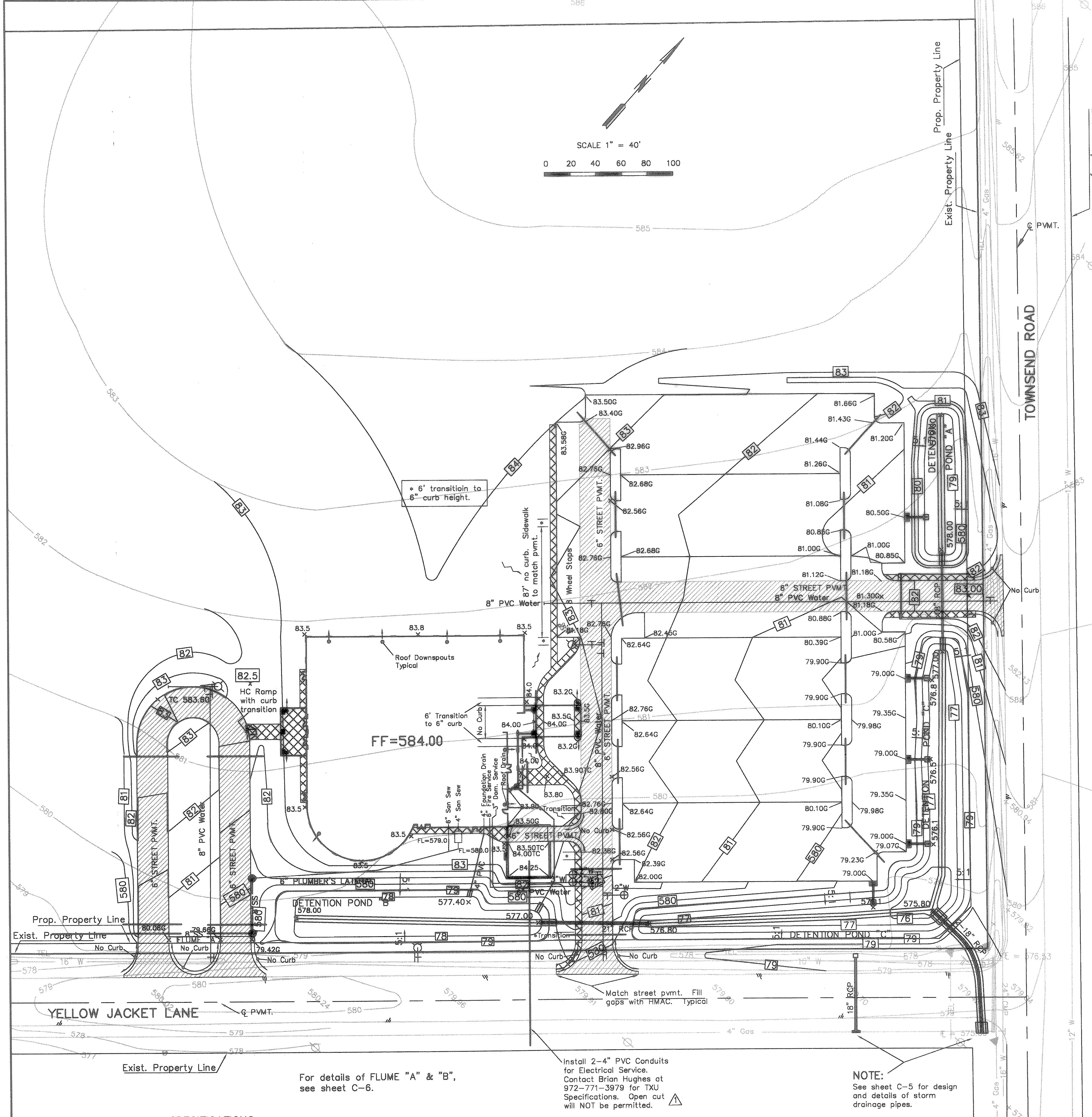
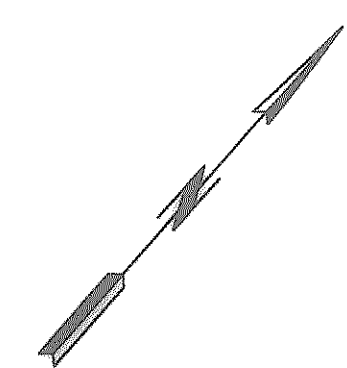
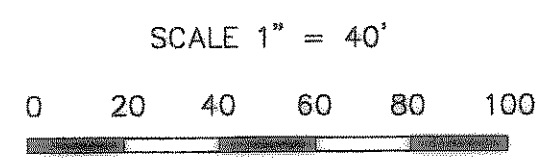

TYPICAL PAVEMENT SECTION

All joints shall be sawed. Sawing shall commence as soon as pavement can support sawing equipment. Joints in 5" thick pavement shall be a minimum of 1.0 inches deep. Joints in 6" thick pavement shall be a minimum of 1.25 inches deep. Joints shall be cleaned and filled with joint sealer as specified by Architect. Maximum joint spacing shall be 15 feet in both longitudinal and transverse directions. Construction joints shall not have a keyway. Sawing along the joint line will be required. Reinf. steel shall continue through construction joints.

No expansion joints will be required.

CONCRETE SPECIFICATIONS

Min. Compressive Strength at 28 days: 3,600 psi
Min. Cement content (no fly ash): 6 sacks/CY for machine finish.
Min. Cement content (no fly ash): 6.5 sacks/CY for hand finish.
Air Content: 4-6%
Max Slump: 3"

NOTES

- See Dimensional Control sheet for layout details.
- Contractor shall be responsible for all damages he causes utilities and other property as a result of his construction operations.
- All trees, stumps, vegetation, concrete, wood, or metal debris shall be removed from the construction site and deposited at a city land fill.
- All excess material from construction of this project will be spread and compacted on the property at a location selected by the Engineer.
- Any off site soil material used as borrow shall not contain particles larger than 2" in diameter and shall have a PI less than 30.
- Top soil shall be stockpiled in sufficient quantity to be spread 6" deep over areas not paved.
- All earth slopes shall be 4:1 unless otherwise noted.
- Degree of compaction and optimum moisture shall be determined from Standard Proctor density tests. Soils under paved areas and utility ditches shall have a density of not less than 95% of above test. All other areas shall have a density of not less than 90% of above test. Soils shall be compacted at optimum moisture or not greater than 2% above optimum.
- See Architectural plan for point striping of parking lot and street.
- Lime stabilized/compacted subgrade shall extend a minimum of 12" from back of curb.
- See sheet C-10 for erosion control plan.
- All fill will be compacted with a sheepfoot roller.
- No vertical construction above slab will be allowed until fire hydrants and fire lanes are tested and accepted by the City.
- Grass must be established prior to City acceptance of project.

5-20-03
AS BUILT

LEGEND

- UTILITY POLE
- FIRE HYDRANT
- STREET LIGHT
- "METER" BOX
- SANITARY MANHOLE VALVE
- PHONE MARKER
- 6" Thick Street Pmnt.
- 4" Thick Sidewalk
- Irrigation Sleeves
- CURB
- SPOT ELEVATION *
- IRON ROD FOUND
- CAPPED IRON ROD SET
- PROPERTY LINE
- EXIST. CONTOUR
- PROP. CONTOUR
- BM OR CONTROL POINT
- E
- G
- TEL
- 10" W
- 8" SS
- 15" SD
- ELECTRIC
- GAS-STEAM
- PHONE-TV
- WATER
- SANITARY SEWER
- STORM SEWER

SPECIFICATIONS

Specifications shall be current NCTCOG Standard Specifications for Public Works Construction.

For details of FLUME "A" & "B", see sheet C-6.

Install 2-4" PVC Conduits for Electrical Service. Contact Brian Hughes at 972-771-3979 for TXU Specifications. Open cut will NOT be permitted.

NOTE:
See sheet C-5 for design and details of storm drainage pipes.

ADDENDUM # 1 12-06-01
Revise notes and add 6" lime stab under pavement.

575.10 " " cut on northwest corner of headwall at east entrance to Ridge Point Athletic Club on south side of Yellow Jacket Lane.

579.03 " " cut on nose of median, east side of Townsend Road at entrance to high school stadium, aligned with center line of Yellow Jacket Lane.

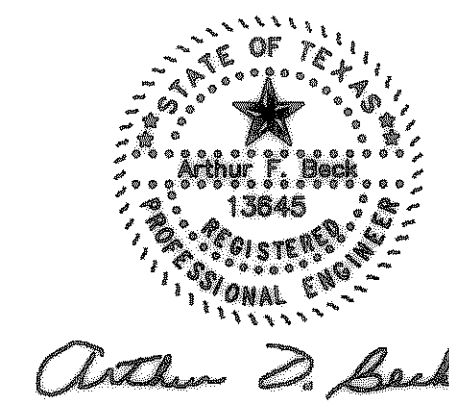

November 19, 2001

GRADING/PAVING PLAN

FIRST UNITED METHODIST CHURCH, ROCKWALL

CITY OF ROCKWALL, TEXAS

F&S PARTNERS and BSM ENGINEERS

DESIGN	DRAWN	DATE	SCALE	NOTES	FILE	NO
F&S	BSM	11-01		BSM		103