

NOTE: MAINTENANCE OF DETENTION POND SHALL BE THE RESPONSIBILITY OF THE WILLIS SEALOCK ADDITION PROPERTY OWNER'S ASSOCIATION.

0+74.93 LINE "A"  
CONST. 10" CURB INLET  
T.C. 545.20  
F.L. 541.20

0+36.80 LINE "A"  
CONST. 45' ELBOW

0+00 LINE "A"  
CONST. TYPE "B" HDWL  
BEGIN 18" R.C.P.

0+00  
CONN. TO EX. INLET  
BEGIN 15" R.C.P.  
F.L. 15" 513.00

0+15.30  
CONN. 15" R.C.P. TO POND WALL  
W/RESTRICTOR PLATE  
OPENING IN WALL  
F.L. 15" 520.48

DETECTION POND  
SLOPE DETENTION POND BOTTOM  
TO DRAIN TO OUTER PIPE  
(REFER TO SHIT-5 OR 10 FOR CALCULATION(S))

(C)  
0.76

(D)  
0.67

NOTE: SITE PLAN FOR LOT 3  
NOT APPROVED AT  
THIS TIME.

(A)  
9.79

(B)  
3.00

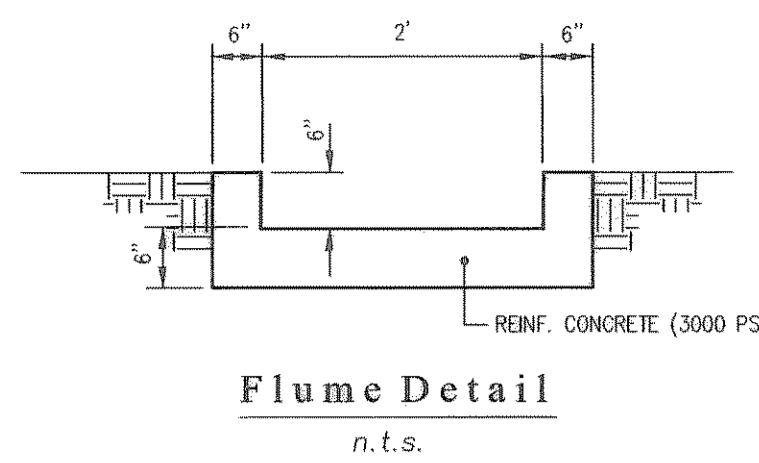

- LEGEND**
- 04  
3.6 PROP. DRAINAGE AREA ID
  - $Q$  PROP. RUNOFF, Q CFS
  - $\rightarrow$  FLOW DIRECTION
  - PROP. STORM SEWER W/ INLET
  - EX. CONTOURS
  - DRAINAGE DIVIDE

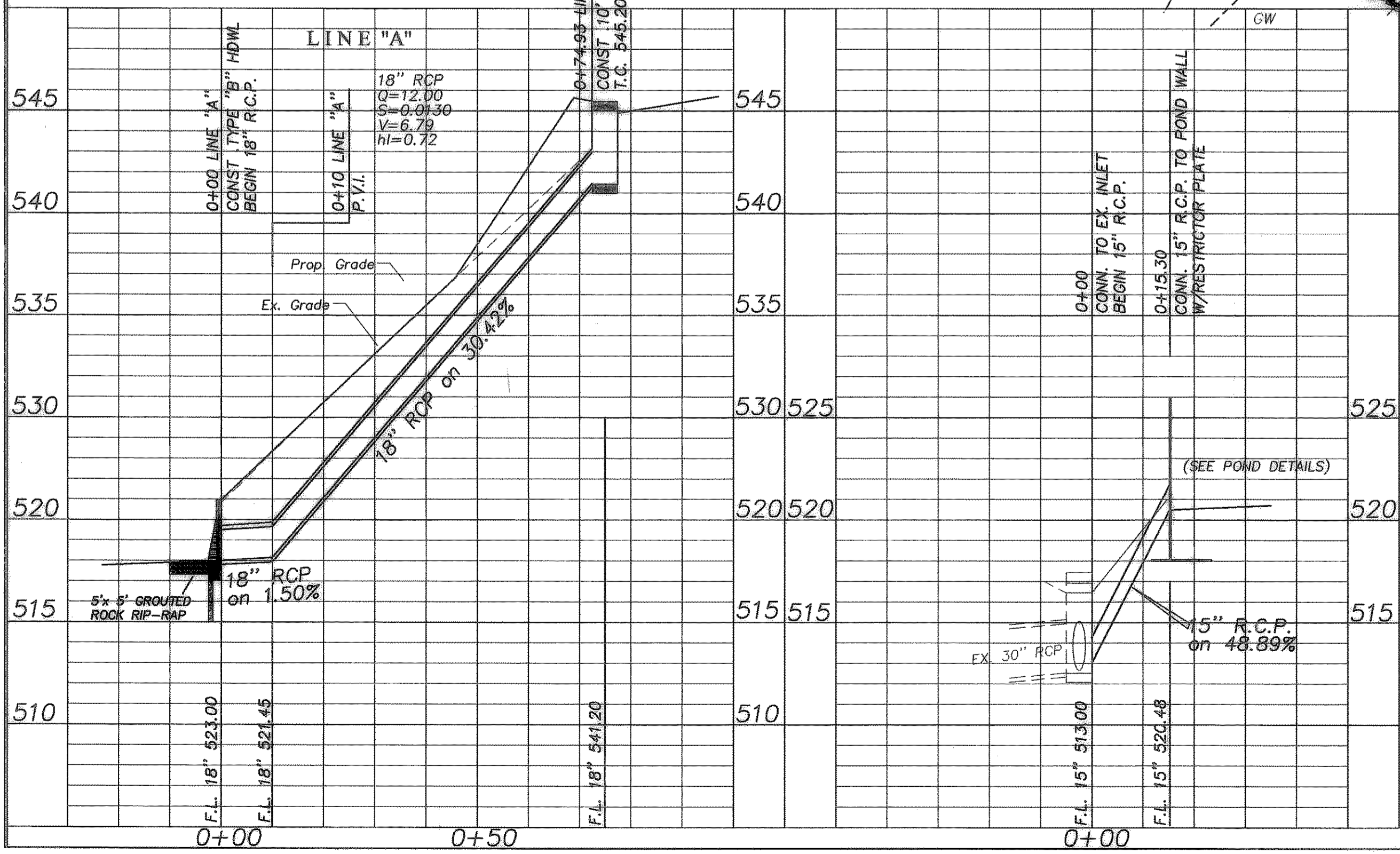

NOTE: DRAINAGE AREAS "C" & "D" WERE DESIGNED TO REMAIN AS UNDEVELOPED AREAS. PROPERTY OWNER AGREES THAT NO DEVELOPMENT IN THIS AREA IS TO BE DONE WITHOUT MODIFICATIONS TO OR ADDITION OF DETENTION FACILITIES.

**PROP. DRAINAGE AREA CALCULATIONS**

Area ID	Acres	Intensity	INTENSITY <sub>DEV</sub>	C <sub>EX</sub>	C <sub>DEV</sub>	Q <sub>100 EX.</sub>	Q <sub>100 DEV.</sub>
A	1.11	8.30	9.80	0.35	0.90	3.22	4.79
B	0.34	9.80	9.80	0.90	0.90	3.00	3.00
C	0.26	8.30	8.30	0.35	0.35	0.76	0.76
D	0.23	8.30	8.30	0.35	0.35	0.67	0.67

BENCHMARK:  
RAILROAD SPIKE EMBEDDED IN THE EAST SIDE  
OF POWER POLE LOCATED AT THE NORTHWEST CORNER  
OF CEMETERY ROAD AND F.M. 740 (RIDGE ROAD)

THE SEAL APPEARING ON THIS DOCUMENT WAS AUTHORIZED BY CHRISTOPHER R. CUNY, P.E. 65642

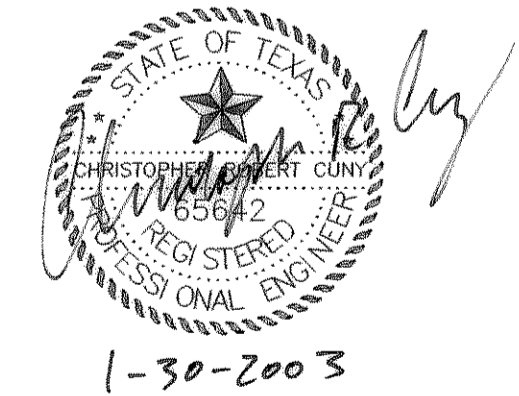

**CONSTRUCTION RECORD DRAWING**

REVISIONS		REVISED CUL-DE-SAC 8-22-02	
<b>DRAINAGE PLAN</b>			
<b>WILLIS SEALOCK ADDITION</b>			
CITY OF ROCKWALL, ROCKWALL COUNTY, TEXAS			
Michael Willis			
2235 Ridge Road • Rockwall, Texas 75087 • (972) 722-1846			
<b>F.C. CUNY CORPORATION</b>			
4222 Rosehill Rd, Suite 7 • Garland, Texas 75043 • (972) 240-7700			
Drawn By:	Checked By:	Date:	Scale:
DM	C.C.	01/03	H: 1"=20' V: 1"=5'
Project No.:	Sheet No.:		
01-000	5 of 10		