

CONSTRUCT 4" HDPE
(C906-DR11/DIPS) SS FORCE MAIN

ROCKWALL INDEPENDENT SCHOOL DISTRICT
VOLUME 67, PAGE 436
D.R.R.C.T.

TOWNSEND BLVD
(85' R.O.W.)

MATCHLINE STA 29+50

MATCHLINE STA 34+50

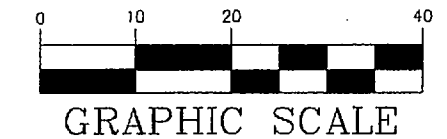
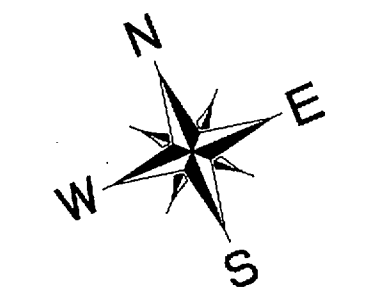

SYM.	DESCRIPTION
— W —	EXISTING WATER LINE
— SS —	EXISTING SS LINE
- - -	R.O.W. LINE
- GAS -	EXISTING UNDERGROUND GAS
- UGT -	EXISTING UNDERGROUND TELEPHONE
=====	EXISTING STORM SEWER
- - - - -	PROPOSED EASEMENT
	ABANDONED WATER LINE
- - - - -	SIDEWALK

SS @ CURVE DATA
D=18"34'40"
R=907.21
L=294.16
T=148.38

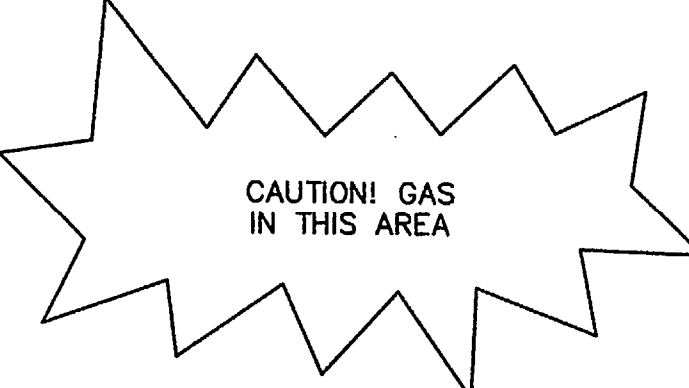

NOTES:
1. MINIMUM 3' COVER ON SS LINES

ROCKWALL COUNTY, TEXAS
VOLUME 3522, PAGE 158
D.R.R.C.T.



STOP!
CALL BEFORE YOU DIG
DIG TESS
1-800-DIG-TESS
(@ least 72 hours prior to digging)

BENCHMARKS:
"□" CUT IN THE EAST END OF HEAD-WALL LOCATED ON THE NORTHWEST CORNER OF THE INTERSECTION OF BOYDSTUN STREET AND CLARK STREET. ELEVATION 534.21
"□" CUT IN THE SOUTHWEST CORNER OF THE HEADWALL LOCATED ON THE WEST SIDE OF INDUSTRIAL BLVD, APPROXIMATELY 250± FEET NORTH OF THE INTERSECTION OF INDUSTRIAL AND THE I-30 ACCESS ROAD. ELEVATION 544.77

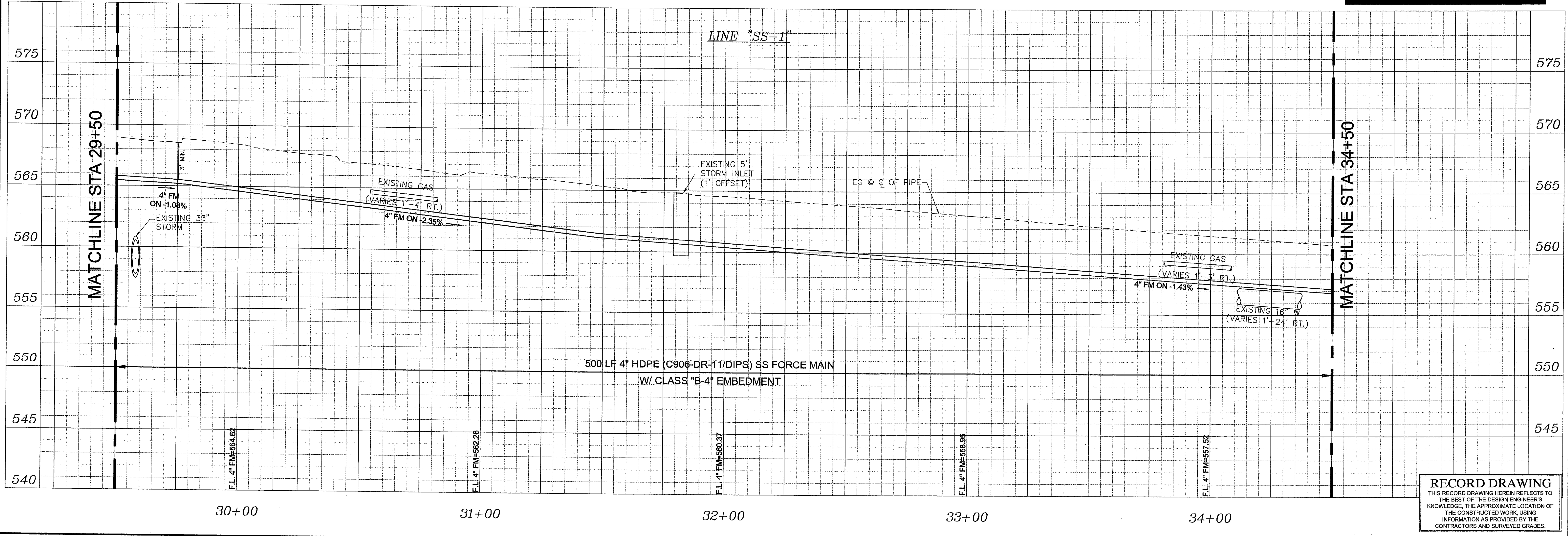

Kimley-Horn and Associates, Inc.
Tel. No. (972) 719-3300
Fax No. (972) 238-9820
12700 Park Central Drive, Suite 1800
Dallas, Texas 75251



EVERGREEN AT ROCKWALL

OFFSITE FORCE MAIN PLAN & PROFILE

Scale:	AS SHOWN
Designed by:	KHA
Drawn by:	KHA
Checked by:	KHA
Date:	MAY 2008
Project No.:	063890013

RECORD DRAWING
THIS RECORD DRAWING HEREIN REFLECTS TO THE BEST OF THE DESIGN ENGINEER'S KNOWLEDGE, THE APPROXIMATE LOCATION OF THE CONSTRUCTED WORK, USING INFORMATION AS PROVIDED BY THE CONTRACTORS AND SURVEYED GRADES.

SHEET
C-38

Small vertical text at the bottom right corner containing project details and dates.