

CIVIL SITE DEVELOPMENT PLANS

FOR

EVERGREEN AT ROCKWALL

LOT 2, BLOCK A, B.J.T. LEWIS SURVEY ABSTRACT NO. 225
CITY OF ROCKWALL, ROCKWALL COUNTY, TEXAS

DECEMBER, 2006

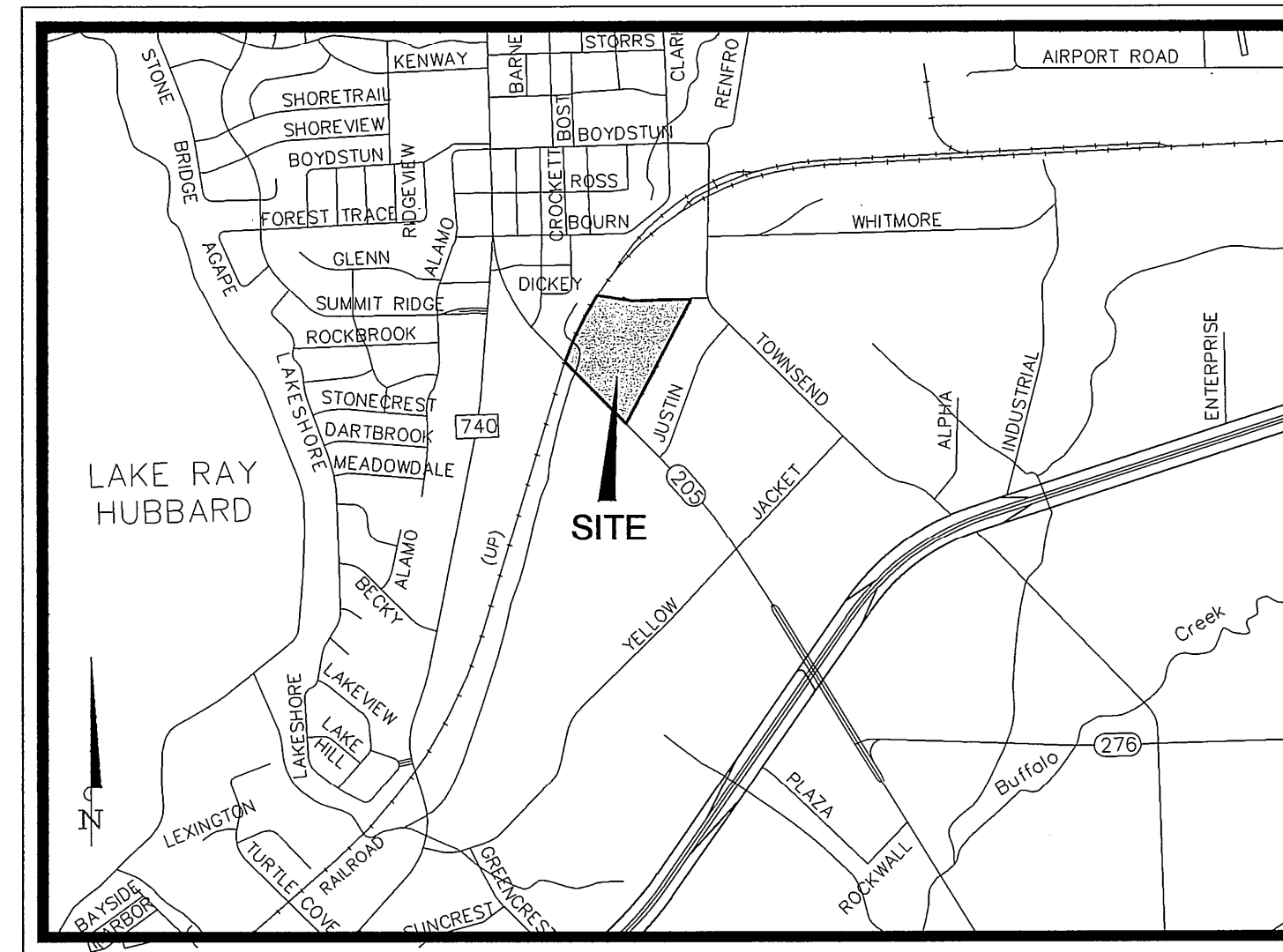

VICINITY MAP
N.T.S.

LOCATED ON STATE HIGHWAY 205 AND
WEST OF JUSTIN ROAD
IN
THE CITY OF ROCKWALL, ROCKWALL
COUNTY, TEXAS

INDEX OF SHEETS

SHEET NO.	DESCRIPTION	REV.
C-1	COVER SHEET	
C-2	PRELIMINARY PLAT-1	
C-3	PRELIMINARY PLAT-2	
C-4	MASTER PLAT-1	
C-5	MASTER PLAT-2	
C-6	GENERAL NOTES	
C-7	SITE PLAN	
C-8	DIMENSIONAL CONTROL PLAN-1	
C-9	DIMENSIONAL CONTROL PLAN-2	
C-10	GRADING PLAN-1	
C-11	GRADING PLAN-2	
C-12	DRAINAGE AREA MAP	
C-13	EROSION CONTROL PLAN	
C-14	EROSION CONTROL DETAILS	
C-15	STORM SEWER PLAN	
C-16	DETENTION POND/DRAINAGE CHANNEL PLAN	
C-17	STORM SEWER PROFILE-1	
C-18	STORM SEWER PROFILE-2	
C-19	WATER AND SANITARY SEWER PLAN-1	
C-20	WATER AND SANITARY SEWER PLAN-2	
C-21	WATER PROFILE-1	
C-22	WATER PROFILE-2	
C-23	SANITARY SEWER PROFILE	
C-24	PAVING PLAN-1	
C-25	PAVING PLAN-2	
C-26	DECELERATION LANE PLAN	
C-27	MISC. CONSTRUCTION DETAILS	
C-28	OFFSITE GENERAL NOTES	
C-29	SITE PLAN AND GRADING	
C-30	SANITARY SEWER DRAINAGE AREA & CALCULATIONS	
C-31	LIFT STATION DETAILS	
C-32	OFFSITE FORCE MAIN AND GRAVITY PLAN AND PROFILE-1	
C-33	OFFSITE FORCE MAIN AND GRAVITY PLAN AND PROFILE-2	
C-34	OFFSITE FORCE MAIN AND GRAVITY PLAN AND PROFILE-3	
C-35	OFFSITE FORCE MAIN AND GRAVITY PLAN AND PROFILE-4	
C-36	OFFSITE FORCE MAIN AND GRAVITY PLAN AND PROFILE-5	
C-37	OFFSITE FORCE MAIN AND GRAVITY PLAN AND PROFILE-6	
C-38	OFFSITE FORCE MAIN AND GRAVITY PLAN AND PROFILE-7	
C-39	OFFSITE FORCE MAIN AND GRAVITY PLAN AND PROFILE-8	
C-40	CONSTRUCTION DETAILS	
C-41	STRUCTURAL DETAIL	
C-42	ELECTRICAL PLAN	
C-43	ELECTRICAL PLAN	

DEVELOPER:

CHURCHILL RESIDENTIAL, INC.

5605 North MacArthur Boulevard, Suite 580
Irving, Texas 75038

Contact : Brad Forslund Ph. (972) 550-7038

PREPARED BY:



**Kimley-Horn
and Associates, Inc.**

12700 Park Central Drive, Suite 1800
Dallas, Texas 75251

Tel. No. (972) 770-1300
Fax No. (972) 239-3820

Contact : Jennifer Haynes, P.E.

Ph. (972) 770-1300

RECORD DRAWING
THIS RECORD DRAWING HEREIN REFLECTS TO
THE BEST OF THE DESIGN ENGINEER'S
KNOWLEDGE, THE APPROXIMATE LOCATION OF
THE CONSTRUCTED WORK, USING
INFORMATION AS PROVIDED BY THE
CONTRACTORS AND SURVEYED GRADES.