

**TRENCH SAFETY**

**General Notes:**

1. Contractor may utilize the DETAIL shown or
2. Contractor may furnish a design that will satisfy the requirements of House Bill 662 and 665 as passed by the State Legislature in 1987.
3. Bid item "Trench Safety" will include all cost associated with design and or construction.

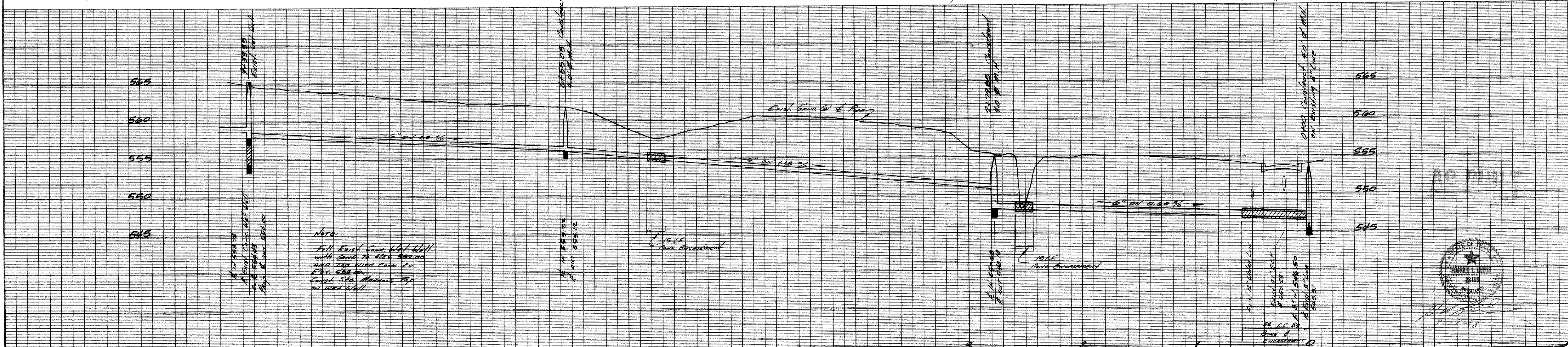

**NOTE:**  
 Fill Exist. Conc. Wet Well with sand to elev. 562.00 and top with conc. for 2' depth. Const. Sta. Manhole Top on wet well.

<b>REVISION DESCRIPTION</b> Revised Grades 8-11-88 Revised Const. @ Wet Well 8-10-88 Revised Grades 8-9-88 Const. P.I. @ Sta. 9130 7-18-88		<b>DATE</b> 6-27-88	<b>SCALE</b> 1" = 40' H. 1" = 6' V.	<b>DESIGN</b> G.C.W.	<b>DRAWN</b> L.P.	<b>HAROLD L. EVANS &amp; ASSOCIATES</b> Consulting Engineers P. O. Box 28355 2331 Gus Thomasson Road, Suite 102 Dallas, Texas 75228 (214) 328-8133	<b>SANITARY SEWER PLANS</b> From Lift Station @ High School to Ellis Centre City of Rockwall Rockwall County, Texas	<b>SHEET NO.</b>  <b>JOB NO.</b> 8877
--	--	------------------------	---	-------------------------	----------------------	--	--	--

