

NOTE FROM FALKOFSKE: This plan was developed directly from DCG Engineering Grading Plan dated Oct. 17, 2022, sheet C5. This plan is for the sole purpose of showing what retaining wall sections to use where and to comment on the site as necessary with regards to the retaining walls. Contractor shall review final Civil Plans for other notes with regard to the site prior to constructing Masonry Stone Retaining Walls.

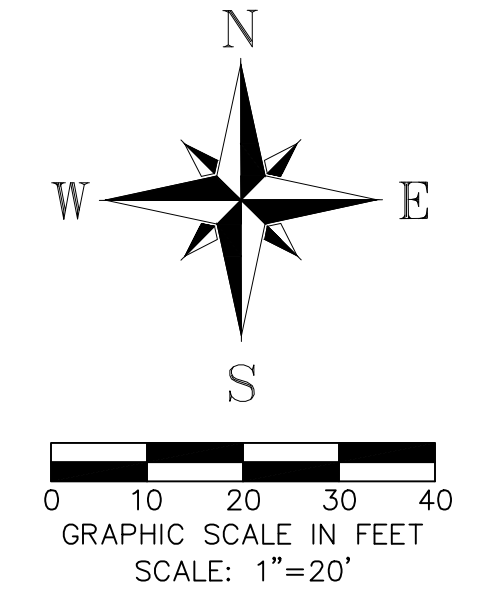

DATE	BY	NO.	DATE	REVISION
02-07-24	EG	1	04-02-24	UPDATED CIV. GRADING PLAN
02-07-24	EG			
02-07-24	JAI			
02-07-24				

Falkofske Engineering, Inc.
 Structural Engineering Consultants
 Texas Registration F-4038
 722 North Fielder Road
 Arlington, Texas 76012
 (817) 261-8300

The use of these plans and specifications shall be restricted to the original site for which they were prepared. Any other reproduction, distribution or use, in whole or in part, is prohibited. These drawings and specifications contain information in CONFIDENTIAL ENGINEERING.

MASONRY RETAINING WALLS - SITE PLAN
 EINSTEIN BROTHERS BAGELS
 RIDGE ROAD & YELLOW JACKET LANE
 ROCKWALL, TEXAS

WALCO RETAINING WALLS, INC.
 4800 S.E. LOOP 820
 FORT WORTH, TEXAS 76140



JOB NO. 1012.23
SP1

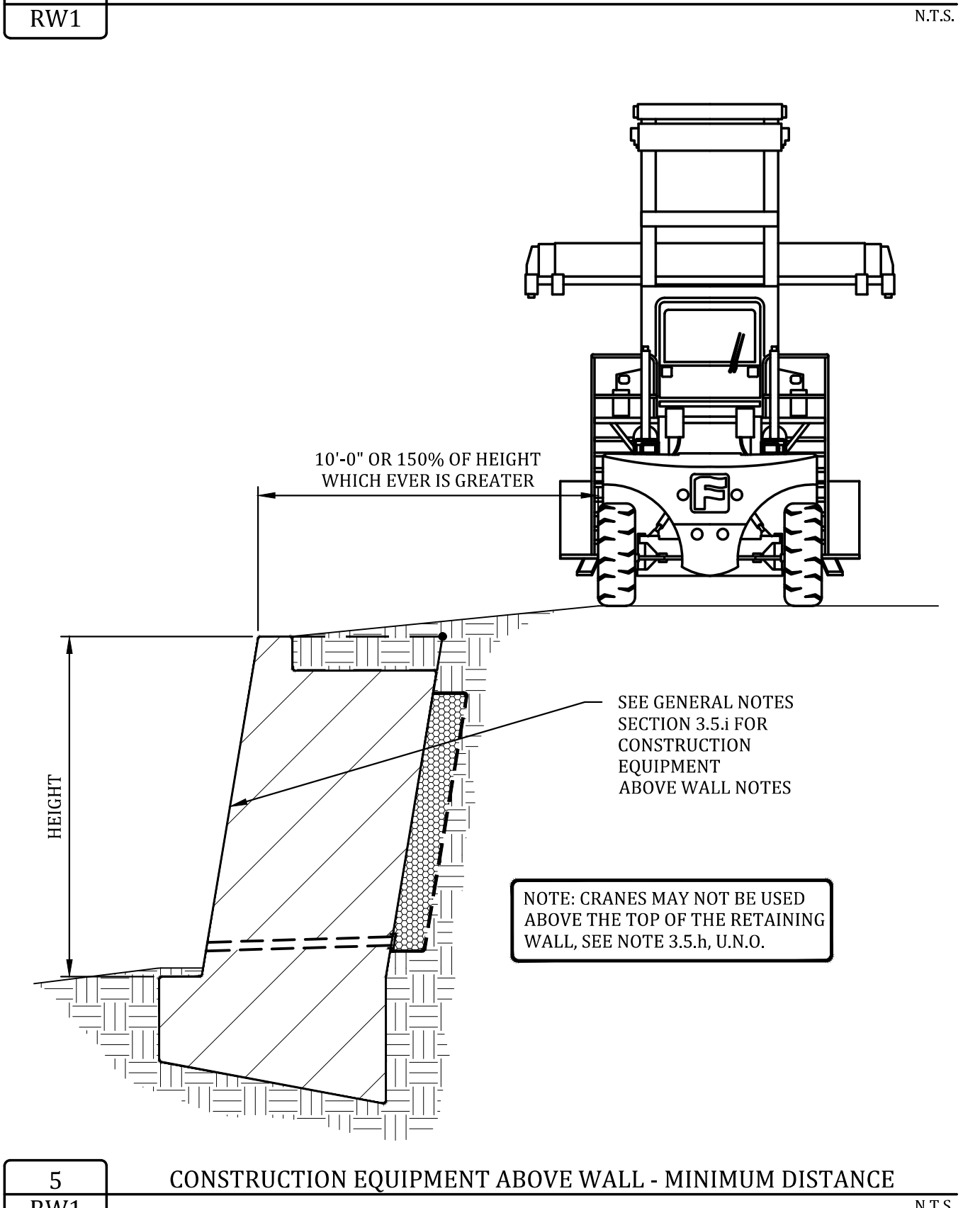
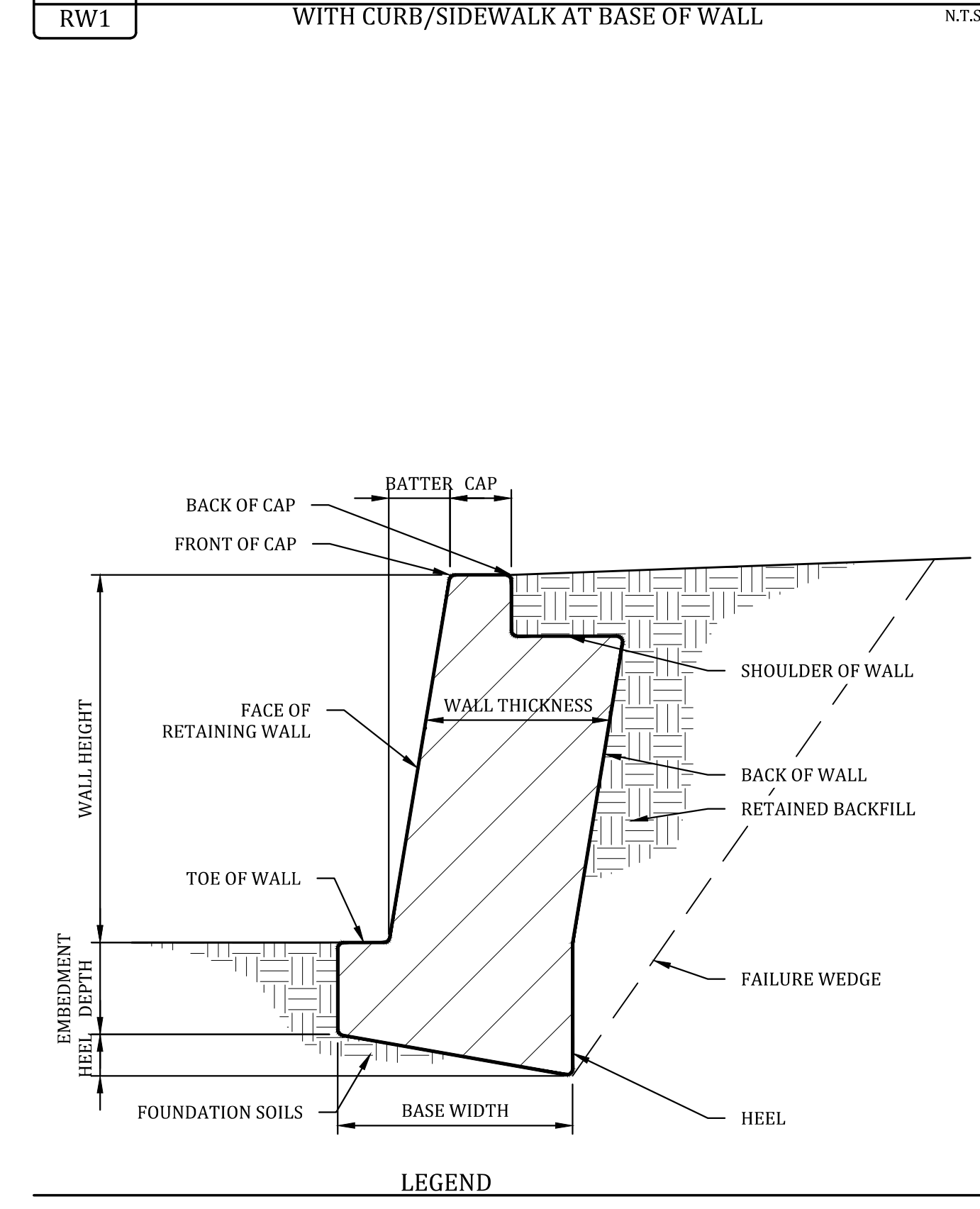
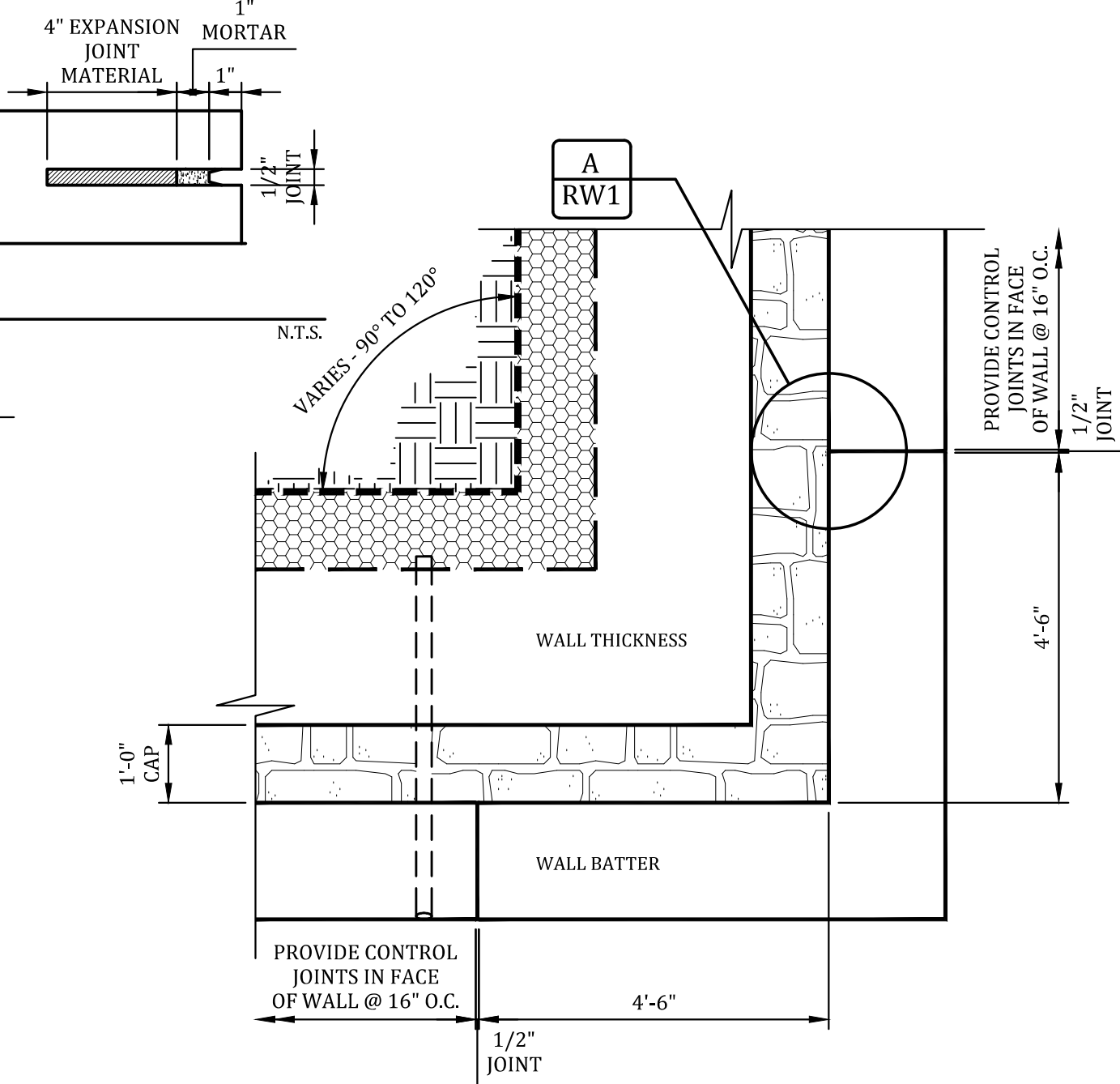
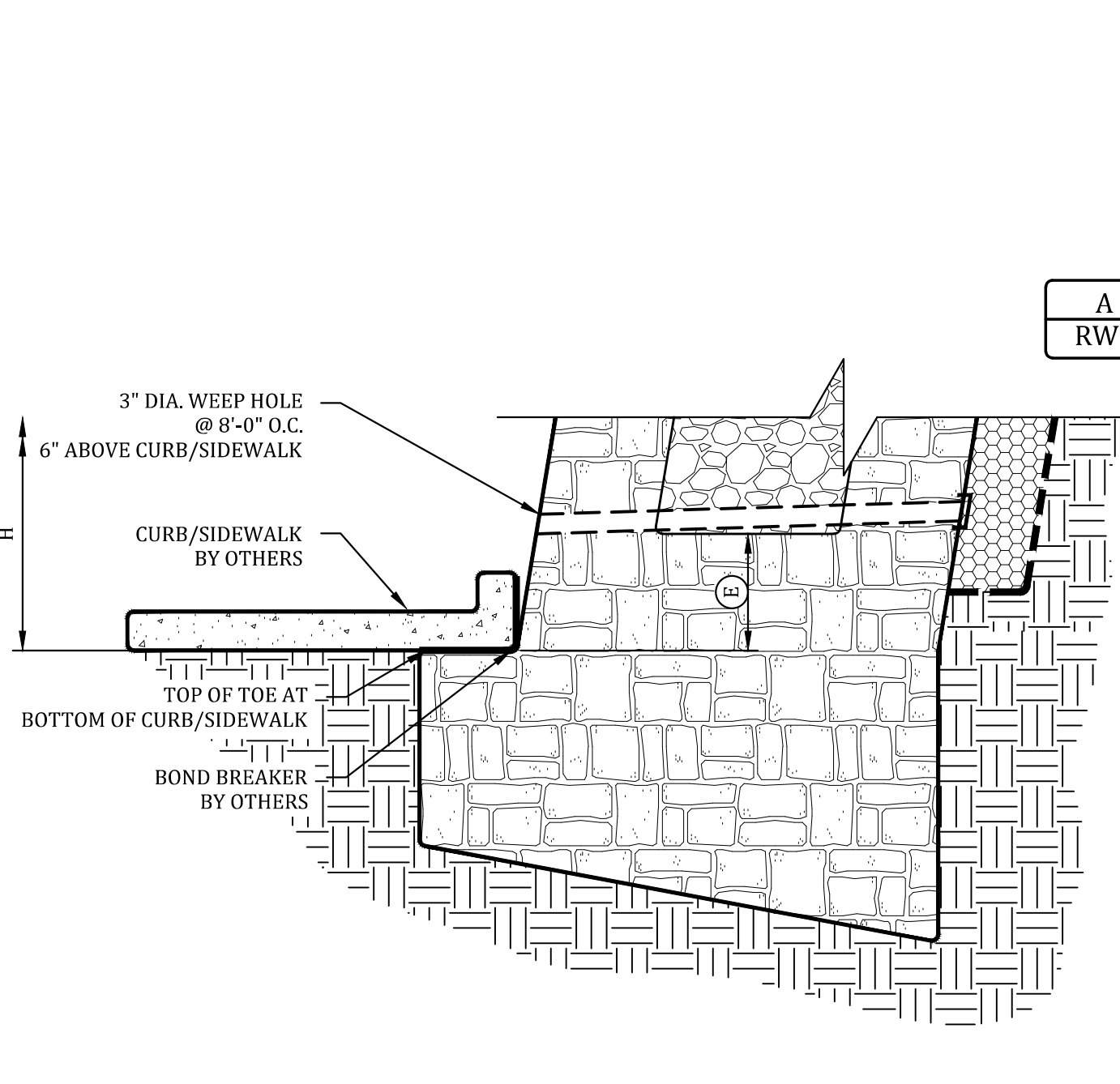
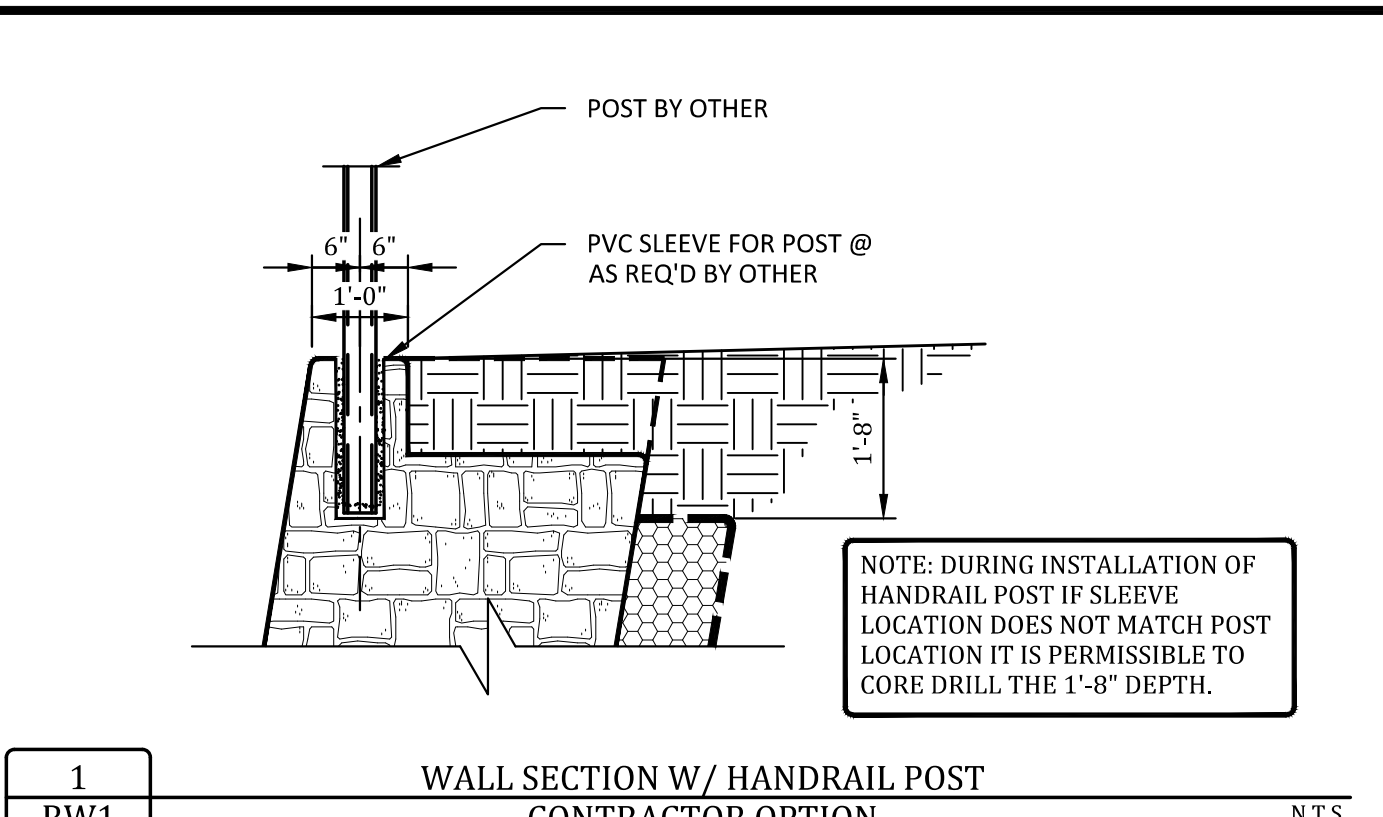
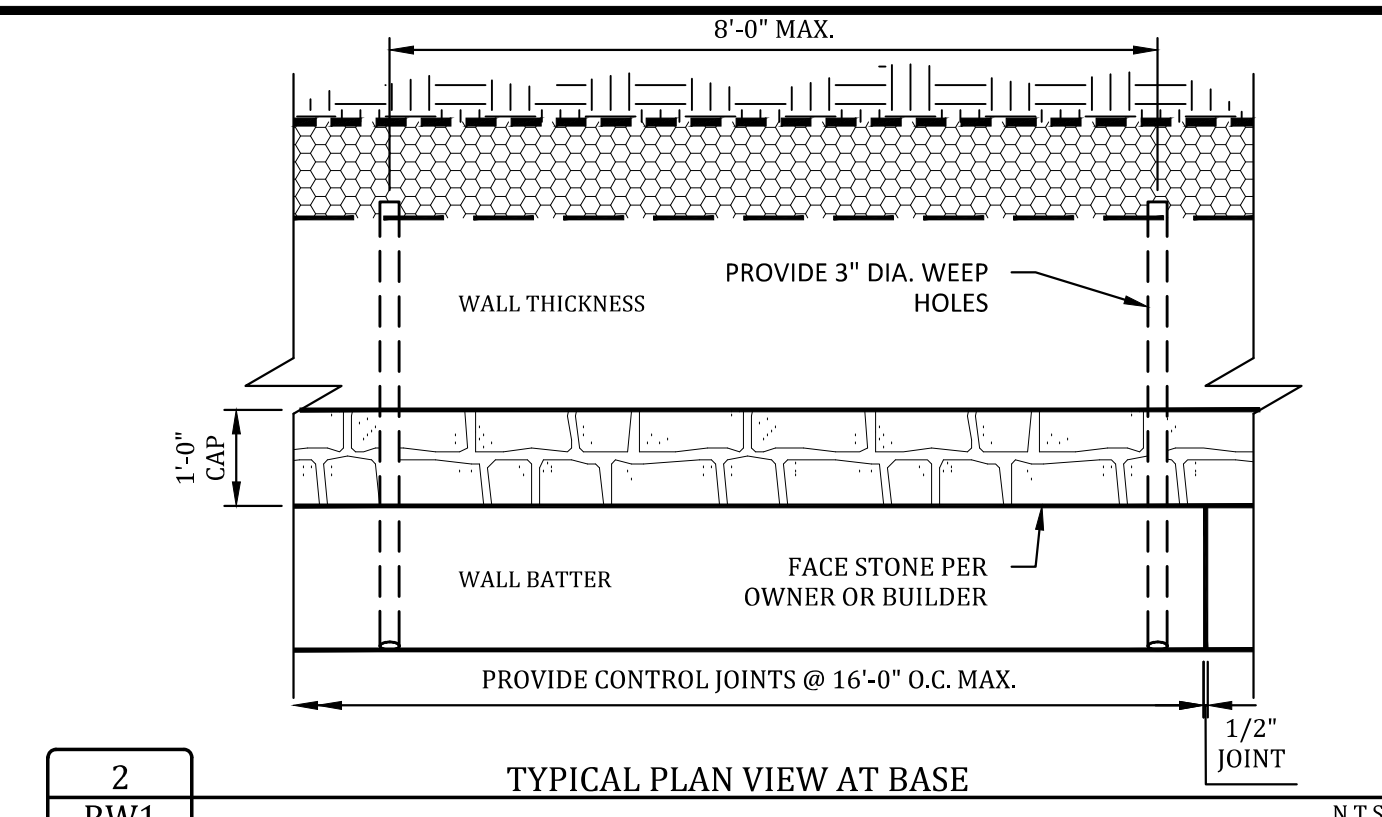

GENERAL NOTES

1. Design

1.1. Design Codes

International Building Code, 2021 Edition

1.2. Geotechnical Report

Firm: Ellerbe-Walczak, Inc.
 Report No. DEZ16441 Dated: January 7, 2022
 Allowable Bearing Capacity 1500 psf

1.3. Design Parameters

Soil Parameters:	Friction Angle	Cohesion (psf)	Unit Weight (pcf)
Soil Type*			
Retained Backfill (On site clay)	26 deg	0 psf	120 pcf
Foundation Soils (1500 psf)	26 deg	0 psf	120 pcf

*See materials below for a description of each Soil Type.

Factors of Safety:

External Stability	
a. Minimum Factor of Safety Against Base Sliding (Static Condition)	1.5
b. Minimum Factor of Safety Against Overturning	2.0
c. Minimum Factor of Safety Against Global Stability	1.5
d. Minimum Factor of Safety for Bearing Capacity	3.0

Design Loading:

Lateral earth pressures are calculated using Coulombs Lateral Earth Pressure Theory. Designs have been performed to accept loading per the proposed loading conditions based on the Civil Grading Plans. A live loading of 250 psf has been used for all walls supporting areas subject to firelane loading.

Retaining walls should not have solid fence (such as wood fence) placed on top of wall other than that shown on these plans. Retaining walls shall not have slope at base or top of wall that exceed that which is shown on these plans. The retaining walls noted above require special design.

2. Materials

2.1. Soil Types

- 2.1.a. Retained Backfill
 - 2.1.a.a. On site clayey soils
 - 2.1.a.b. Properly compacted on-site fill soils, verification by others.
- 2.1.b. Foundation Soils (Allowable Bearing = 1500 psf min.)
 - 2.1.b.a. Bearing on Stiff Natural Undisturbed Clayey or Sandy Soils or Compacted and Tested Fill Soils.
 - 2.1.b.b. Friction Angle between Base of Wall and Soil - 17°
 - 2.1.b.c. Bearing in fill soils. Fill soils supporting the retaining walls have to be placed in accordance with the recommendations for the fill placement per the geotechnical report.

2.1.c. Drainage Material

- 2.1.c.a. Free draining granular backfill, clean, non-plastic, relatively well-graded.

2.2. Dimension Stone

- 2.2.a. Average Density of masonry wall varies from 135 pcf to 145 pcf.
- 2.2.b. Stone size varies from 4" to 18".
- 2.2.c. Face stone shall be coordinated between contractor and owner/developer.
- 2.2.d. Recycled concrete 4" to 18" may be used in place of dimension stone, contractor's option. The recycled concrete shall be free of dirt and concrete dust such that mortar can bond the material together. It shall also be mostly free of rebar. Some rebar is acceptable as long as it does not prevent the material from being placed tightly together.

2.3. Rebar/Welded Wire Fabric (If Required)

- 2.3.a. All steel reinforcement shall be new billet steel conforming to ASTM a-615, Grade 60 with $f_y = 60$ ksi.
- 2.3.b. All reinforcement shall not have deleterious material on it.
- 2.3.c. All welded wire fabric shall have a minimum of $f_y = 65$ ksi and be hot dip galvanized.

2.4. Drainage Materials

- 2.4.a. Weep pipes shall be PVC or corrugated HDPE pipe.
- 2.4.b. Drainage zone shall be separated from retained backfill by mirafi 140N filter fabric or approved equal.

2.5. Portland Cement Mortar for Retaining Wall Construction

The Portland cement used for construction of the masonry stone retaining walls shall be provided with the following proportions per cubic yard of concrete. The Portland Cement mortar supplier shall provide "batch tickets" clearly indicating the appropriate amount of materials are provided in each truck load. The batch tickets shall clearly indicate the amount batched, the date, the project name and shall be provided to Falkofske Engineering, Inc. for review, documentation, and file.

Contents	Amount per cubic yard	Specific Gravity	Volume (ft ³)
Type 1 Portland Cement:	451 lbs	3.15	2.29
Type F Fly Ash:	113 lbs	2.93	0.62
Fine Aggregate (sand):	2746 lbs	2.59	16.99
Potable Water:	367 lbs	44 Gallons	5.88
Sika Air (or equivalent):	(AS REQ'D) oz	4.5%	1.22
			27.0 Total

3. Construction

3.1. Preparation Work

- 3.1.a. Prior to grading or excavation of the site, confirm the location of the retaining walls and all underground features, including utility location within the area of construction. Ensure surrounding structures are protected from effects of wall excavation, and construction.
- 3.1.b. Coordinate installation of underground utilities and other improvements with wall installation.

3.2. Excavation

- 3.2.a. If a mortared footing is over-excavated, then the dimension stone shall be placed mortared. If a dry stone footing is over excavated, then the dimension stone does not need to be mortared.
- 3.2.b. Fill over-excavated area in front of the wall footing with compacted on site soils before the wall construction exceeds 4 feet in height.
- 3.2.c. In area where the walls are installed in a cut, the required excavation shall extend horizontally to the extent of the width of the retaining wall. The wall may be built to the cut. If the wall is over cut, then soil shall either be compacted or the drainage zone may be widened.

3.3. Wall Construction

- 3.3.a. The wall shall be constructed to the dimensions as shown on these plans. Front leads, back leads, and string lines shall be set for each wall. Care shall be taken to install the mortar zones to the correct thickness, and to place drainage behind the wall as required.
- 3.3.b. Face of wall control joints shall be installed at a maximum of 16'-0" o.c. per these plans.
- 3.3.c. Weep pipes shall be placed at 8'-0" o.c. max.
- 3.3.d. Face rock type shall be coordinated between the architect, owner, and retaining wall contractor.

3.4. Retained Backfill Placement

- 3.4.a. Retained backfill shall be placed per the recommendations of the geotechnical engineer, but should not be less than 93% Standard Proctor Maximum Dry Density (ASTM D698).
- 3.4.b. Fill should be placed in maximum 8" thick compacted lifts.
- 3.4.c. Large compaction equipment (equipment heavier than 7,500 lb) shall remain a minimum of 1.5x the height of the wall away from the back of the wall for a period of 2 weeks from the time of construction.
- 3.4.d. After a period of 2 weeks from the time of construction large compaction equipment may be used behind the wall but shall stay a minimum of 5'-0" away from the back of the wall.
- 3.4.e. Soil placed with in 5'-0" of the back of the wall shall be placed using handheld compaction equipment.
- 3.4.f. If the wall is in a cut situation the wall may be built up to the cut. If the wall is overcut the drainage zone may be widened to the cut or compacted fill may be placed between the drainage zone and the cut.

3.5. Retaining Wall Performance, Maintenance and Other Comments

- 3.5.a. Control joints are provided in the retaining wall to allow for minor movements due to settlement and shrink swell of the soils. Some cracking may occur in the face of the retaining wall. This cracking, if minor (less than 3/8"), may be cosmetically repaired as desired.

- 3.5.b. The retaining walls are designed to allow surface water to flow over the tops of the retaining walls. Care should be taken during and after construction to not allow water to pond behind the retaining walls, as this can have a negative impact on the stability of the retaining walls. Retaining walls are often constructed early in the site development phase. Water maintenance above the top of them is the general contractor's responsibility prior to the site being finished. If necessary temporary swales, replacement of eroded soils, and other water maintenance items may be necessary to protect the retaining walls.
- 3.5.c. If downspouts are located near the back of the retaining wall they should either be plumbed through the retaining wall to drain below the wall or collected and tied into the storm sewer system. Perforated subsurface pipes shall not be used behind the retaining walls.
- 3.5.d. Positive drainage (sheet flow) over the top of the walls shall be maintained throughout the life of the structure. If swales are placed behind the wall they shall remain clean and free draining. If water is found to be ponding in the swale it shall be maintained to allow water to freely drain as soon as possible.
- 3.5.e. Any broken sprinklers behind the retaining wall shall be turned off and repaired as soon as possible.
- 3.5.f. Over time erosion below or above the retaining wall can occur. Eroded soils shall be replaced and maintained to protect and extend the life of the retaining walls.
- 3.5.g. Weep holes shall be maintained to be able to freely drain throughout the life of the retaining wall.
- 3.5.h. Cranes shall not be used above the retaining wall without approval from our office. Cranes apply very large loads to the retaining walls and require special design considerations.
- 3.5.i. Construction equipment used above retaining walls after they are finished can damage the walls. Care shall be taken to protect the walls during site development. Below is a list of some considerations that should be made to protect the walls.
- 3.5.i.a. Examples of construction equipment that have been shown to cause damage include skytraks, telehandlers, concrete trucks, skid steers, excavators, and others.
- 3.5.i.b. Walls shall be a minimum of 2 weeks old prior to equipment use above wall.
- 3.5.i.c. Equipment shall not be used on wet/saturated soils above the wall where rutting occurs. This condition increases the likelihood of damage to the retaining walls.
- 3.5.i.d. Equipment maybe used when it is at least 10'-0" from the front of cap of walls or 150% of the wall height which ever is greater.
- 3.5.i.e. If equipment needs to be used closer than stated in item 3.5.i.d, our office shall be contacted to verify the wall can support the weight of the construction equipment. The construction equipment type and weights will need to be provided. Additionally, mats or plywood will need to be provided to protect the backfill and wall.

3.6. Cold Weather Construction of Retaining Walls

3.6.a. Construction Requirements for ambient air temperatures between 40°F and 32°F:

- 3.6.a.a. Water and aggregates used in mortar shall not be heated above 140°F.
- 3.6.a.b. Mortar sand or mixing water shall be heated to produce mortar temperatures between 40°F and 120°F at the time of mixing.
- 3.6.a.c. Heat grout materials when the temperature of the materials is below 32°F.
- 3.6.a.d. Newly constructed masonry shall be completely covered with weather-resistive membrane for 24 hours after being completed.

3.6.b. Construction Requirements for ambient air temperatures between 32°F and 25°F:

- 3.6.b.a. The guidelines above for construction requirements for temperatures between 40°F and 32°F and the following shall be met.
- 3.6.b.b. The mortar temperature shall be maintained above freezing until used in masonry stone retaining wall.
- 3.6.b.c. Visible ice and snow shall be removed from the top surface of existing foundations and masonry to receive new construction. These surfaces shall be heated to above freezing, using methods that do not result in damage.

3.6.c. Construction Requirements for ambient air temperatures between 25°F and 20°F:

- 3.6.c.a. The guidelines above for construction requirements for temperatures between 40°F and 32°F, the construction guidelines for temperatures between 32°F and 25°F, and the following shall be met.
- 3.6.c.b. Masonry (raw stone) surfaces under construction shall be heated to 40°F.
- 3.6.c.c. Wind breaks or enclosures shall be provided when the wind velocity exceeds 15 miles per hour.
- 3.6.c.d. Newly constructed masonry shall be completely covered with weather-resistive insulating blankets, or equal protection, for 48 hours after being completed.

The above procedures are in compliance with The Masonry Society TMS 602 specifications for cold weather construction of masonry structures.

3.7. Hot Weather Construction of Retaining Walls

3.7.a. Above 100°F or above 90°F with a wind velocity greater than 8 mph:

- 3.7.a.a. Preparation (Hand Mixing or at Batch Plant)
- 3.7.a.a.a. Maintain sand piles in a damp loose condition.
- 3.7.a.a.b. Provide necessary conditions and equipment to produce mortar having a temperature below 120°F.

3.7.ab. Construction

- 3.7.ab.a. Maintain temperature of mortar below 120°F.
- 3.7.ab.b. Maintain mortar consistency by re-tempering with cool water.
- 3.7.ab.c. When hand mixing mortar use mortar within 2 hours of initial mixing.
- 3.7.ab.d. When batch mixing and using retainer, mortar on site that is not in use, shall be covered with plastic sheeting to prevent moisture loss.

3.7.b. Above 115°F or above 105°F with a wind velocity greater than 8 mph:

- 3.7.b.a. Preparation (Hand Mixing or at Batch Plant)
- 3.7.b.a.a. Items noted above under section 3.7.a.a. shall be met in addition to the requirements below.
- 3.7.b.a.b. Shade materials and mixing equipment from direct sunlight.

3.7.bb. Construction

- 3.7.bb.a. Items noted above under section 3.7.a.b. shall be met in addition to the requirements below.
- 3.7.bb.b. When hand mixing mortar cool mixing water shall be used. Ice may be added to the water, but complete melting must take place before mixing with other materials.

4. Construction Observations

4.1. Construction Observations by Falkofske Engineering, Inc.

- 4.1.a. Falkofske Engineering, Inc. will perform construction observation, but only as a means of verification of the contractors quality control performance.
- 4.1.b. Falkofske Engineering, Inc. will act as the Special Inspector for this project. Contractor shall contact Falkofske Engineering to set up inspections, at least 1 day before construction starts.
- 4.1.c. All required materials testing shall be performed by an approved materials testing laboratory.
- 4.1.d. Falkofske Engineering, Inc. is not responsible for means, methods, and material furnished by the retaining wall contractor.

4.2. Construction Observations by Others

- 4.2.a. Construction observations are required by the city shall be coordinated by the contractor.

DATE	BY	DES.	DRN.	CHK.	NO.	DATE	REVISION
02-07-24	EG						
02-07-24	EG						
02-07-24	JA						

Falkofske Engineering, Inc.
 Structural Engineering Consultants
 Texas Registration F-4038
 722 North Fielder Road
 Arlington, Texas 76012
 (817) 261-8300

The use of these plans and specifications shall be restricted to the original site for which they were prepared. Any other reproduction, distribution or use of these plans, drawings and specifications without the written consent of FALCOFSKE ENGINEERING, INC. is prohibited.

MASONRY RETAINING WALLS
 EINSTEIN BROTHERS BAGELS
 RIDGE ROAD & YELLOW JACKET LANE
 ROCKWALL, TEXAS

WALCO RETAINING WALLS, INC.
 4800 S.E. LOOP 820
 FORT WORTH, TEXAS 76140

JOB NO. 1012.23
RW1

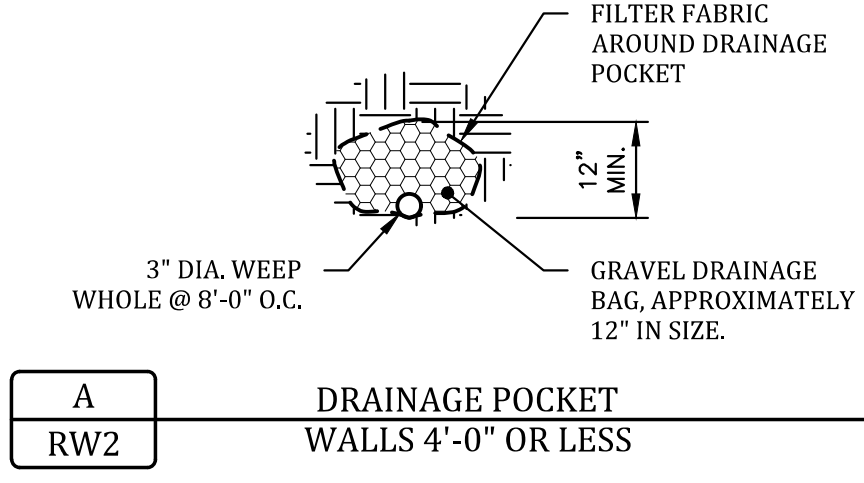
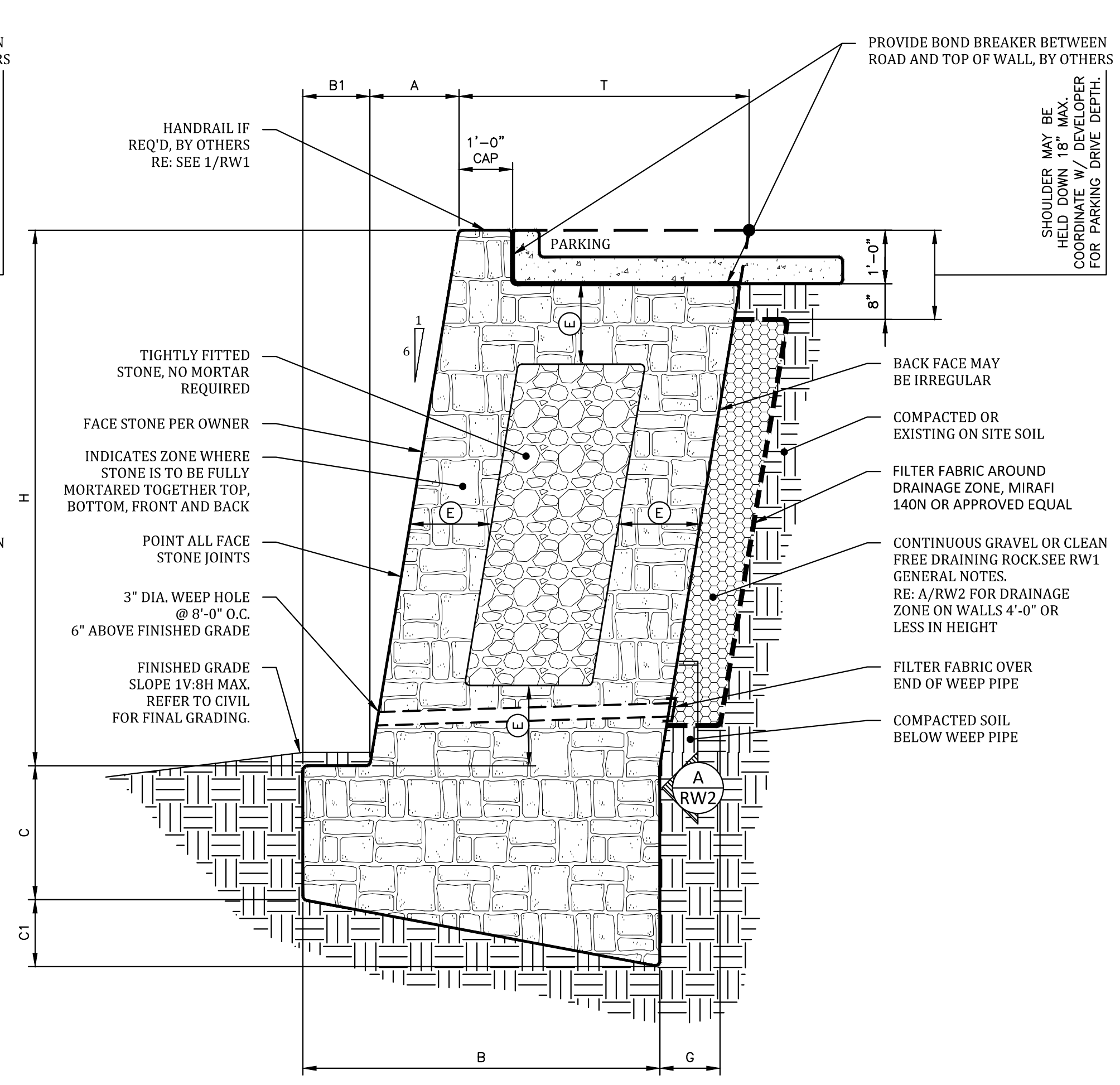
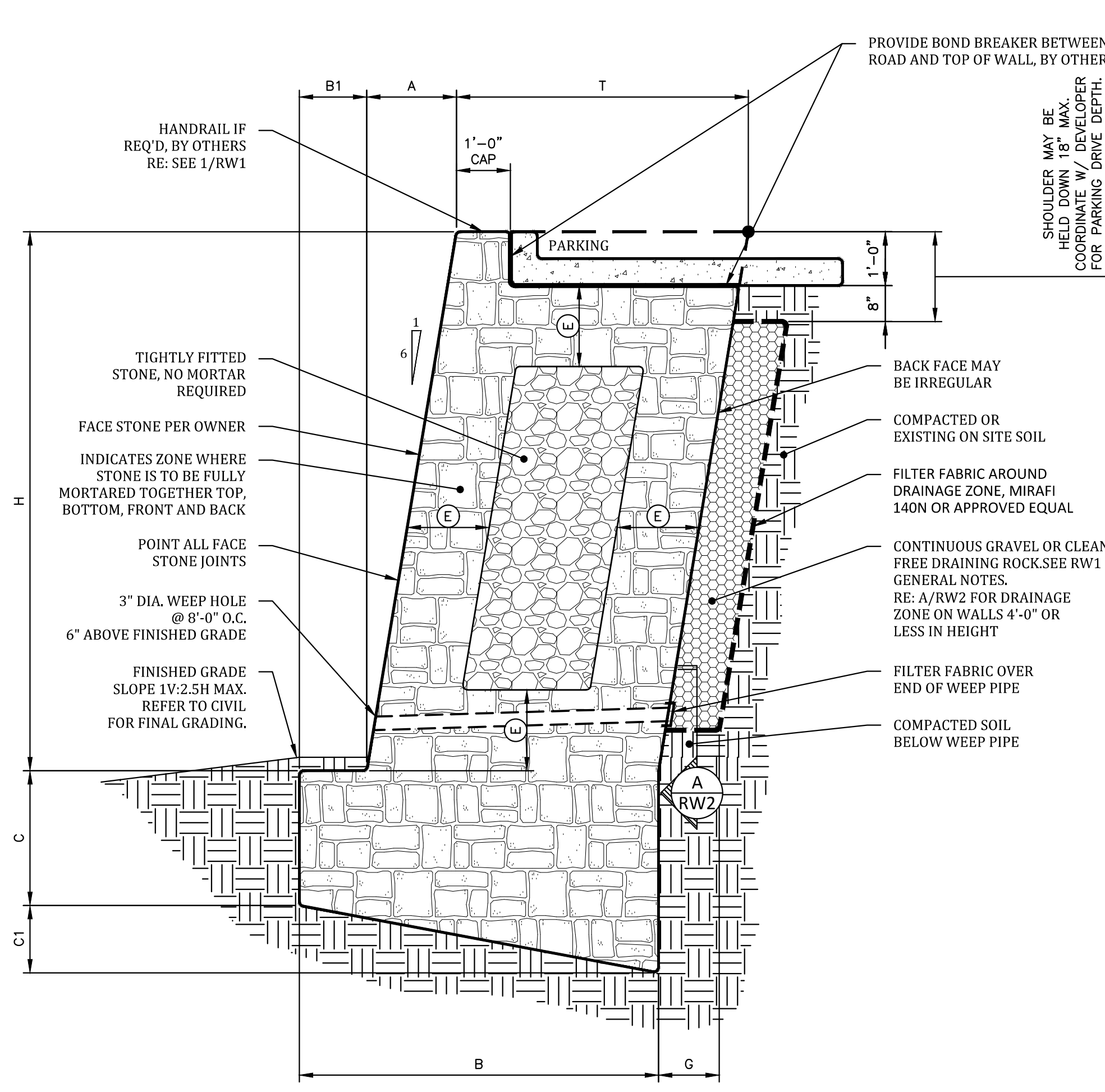
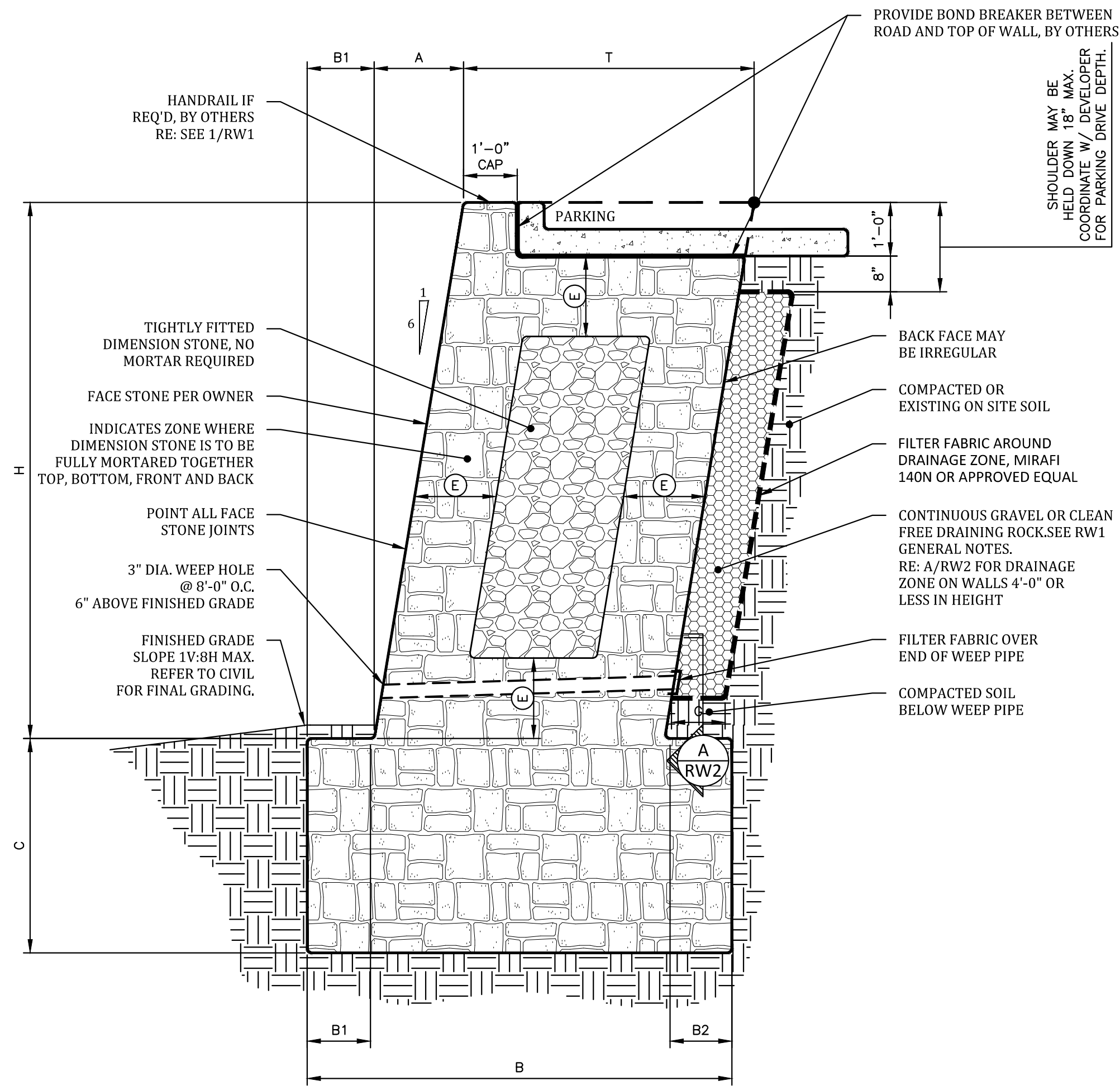

MASONRY WALL SCHEDULE									
2500 PSF - BEARING CAPACITY (REMIEDIATED BASE, SEE GENERAL NOTES SHEET RW1)									
WALL HEIGHT H	BASE WIDTH B	WALL TOE B1	WALL TOE B2	BASE DEPTH (TOE) C	WALL BATTER A	FULLY MORTARED ZONE E	WALL THICKNESS T	DRAINAGE ZONE THICKNESS G	BEARING CAPACITY
3'-0"	5'-5"	1'-0"	2'-11"	9'-0"	0'-6"	FULLY MORTARED	1'-6"	SEE A/RW2	2500 psf
4'-0"	5'-5"	1'-0"	2'-5"	9'-0"	0'-8"	FULLY MORTARED	2'-0"	SEE A/RW2	
5'-0"	5'-5"	1'-0"	2'-2"	9'-0"	0'-10"	FULLY MORTARED	2'-3"	1'-0"	
WALL DESIGN CRITERIA									
BEARING Q_u	TOP SLOPE β	BOTTOM SLOPE β_b	ACTIVE PRESSURE ϕ_a	PASSIVE PRESSURE ϕ_p	BASE FRICTION ANGLE δ	BACK OF WALL SLOPE α	SURCHARGE q		
2500 psf	5.71°	7.13°	26°	26°	28°	99.46°	0 psf		

USE THIS SCHEDULE FOR 3/RW2

MASONRY WALL SCHEDULE									
1500 PSF - BEARING CAPACITY (STIFF NATURAL UNDISTURBED SOILS OR COMPACTED AND TESTED SOILS, SEE GENERAL NOTES SHEET RW1)									
WALL HEIGHT H	BASE WIDTH B	WALL TOE B1	BASE DEPTH (TOE) C	BASE DEPTH (HEEL) C1	WALL BATTER A	FULLY MORTARED ZONE E	WALL THICKNESS T	DRAINAGE ZONE THICKNESS G	BEARING CAPACITY
2'-0"	2'-0"	0'-6"	2'-6"	0'-5"	0'-4"	FULLY MORTARED	1'-6"	SEE A/RW2	1500 psf
3'-0"	2'-5"	0'-8"	2'-6"	0'-6"	0'-6"	FULLY MORTARED	1'-9"	SEE A/RW2	
4'-0"	2'-9"	0'-10"	2'-6"	0'-6"	0'-8"	FULLY MORTARED	1'-11"	SEE A/RW2	
5'-0"	3'-6"	1'-0"	2'-6"	0'-8"	0'-10"	FULLY MORTARED	2'-6"	1'-0"	
WALL DESIGN CRITERIA									
BEARING Q_u	TOP SLOPE β	BOTTOM SLOPE β_b	ACTIVE PRESSURE ϕ_a	PASSIVE PRESSURE ϕ_p	BASE FRICTION ANGLE δ	BACK OF WALL SLOPE α	SURCHARGE q		
1500 psf	5.71°	21.80°	26°	26°	17°	99.46°	0 psf		

USE THIS SCHEDULE FOR 2/RW2

MASONRY WALL SCHEDULE									
1500 PSF - BEARING CAPACITY (STIFF NATURAL UNDISTURBED SOILS OR COMPACTED AND TESTED SOILS, SEE GENERAL NOTES SHEET RW1)									
WALL HEIGHT H	BASE WIDTH B	WALL TOE B1	BASE DEPTH (TOE) C	BASE DEPTH (HEEL) C1	WALL BATTER A	FULLY MORTARED ZONE E	WALL THICKNESS T	DRAINAGE ZONE THICKNESS G	BEARING CAPACITY
1'-0"	1'-2"	0'-2"	0'-6"	0'-3"	0'-2"	FULLY MORTARED	1'-0"	SEE A/RW2	1500 psf
2'-0"	1'-2"	0'-2"	0'-9"	0'-3"	0'-4"	FULLY MORTARED	1'-0"	SEE A/RW2	
3'-0"	1'-7"	0'-3"	0'-9"	0'-4"	0'-6"	FULLY MORTARED	1'-4"	SEE A/RW2	
4'-0"	2'-3"	0'-4"	1'-0"	0'-5"	0'-8"	FULLY MORTARED	1'-11"	SEE A/RW2	
5'-0"	2'-9"	0'-5"	1'-3"	0'-6"	0'-10"	0'-8"	2'-4"	1'-0"	
WALL DESIGN CRITERIA									
BEARING Q_u	TOP SLOPE β	BOTTOM SLOPE β_b	ACTIVE PRESSURE ϕ_a	PASSIVE PRESSURE ϕ_p	BASE FRICTION ANGLE δ	BACK OF WALL SLOPE α	SURCHARGE q		
1500 psf	5.71°	7.13°	26°	26°	17°	99.46°	0 psf		

USE THIS SCHEDULE FOR 1/RW2

3 RW2 TYPICAL WALL SECTION - BEARING IN CLAYEY OR SANDY SOILS 1V:10H MAX SLOPE ABOVE WALL, 1V:8H MAX SLOPE BELOW WALL N.T.S.

2 RW2 TYPICAL WALL SECTION - BEARING IN CLAYEY OR SANDY SOILS 1V:10H MAX SLOPE ABOVE WALL, 1V:2.5H MAX SLOPE BELOW WALL N.T.S.

1 RW2 TYPICAL WALL SECTION - BEARING IN CLAYEY OR SANDY SOILS 1V:10H MAX SLOPE ABOVE WALL, 1V:8H MAX SLOPE BELOW WALL N.T.S.

NO.	DATE	REVISION	BY
1	02-07-24	EG	EG
2	02-07-24	EG	EG
3	02-07-24	CHK	CHK
4	04-02-24	ADD 3/RW2 SCHEDULE & DETAIL	WDM

Falkofske Engineering, Inc.
Structural Engineering Consultants
Texas Registration F-4038
722 North Fielder Road
Arlington, Texas 76012
(817) 261-8300

The use of these plans and specifications shall be restricted to the original site for which they were prepared. Any other reproduction, distribution, or use of these plans and specifications is expressly prohibited. These drawings and specifications contain information that is the property of Falkofske Engineering, Inc. and shall remain confidential.

MASONRY RETAINING WALLS
EINSTEIN BROTHERS BAGELS
RIDGE ROAD & YELLOW JACKET LANE
ROCKWALL, TEXAS

WALICO RETAINING WALLS, INC.
4800 S.E. LOOP 820
FORT WORTH, TEXAS 76140



JOB NO. 1012.23
RW2