

Revision	Date	Description
1	8/2/13	STORM LINE REVISION
4	8/22/13	PAVING & STORM LINE REVISION

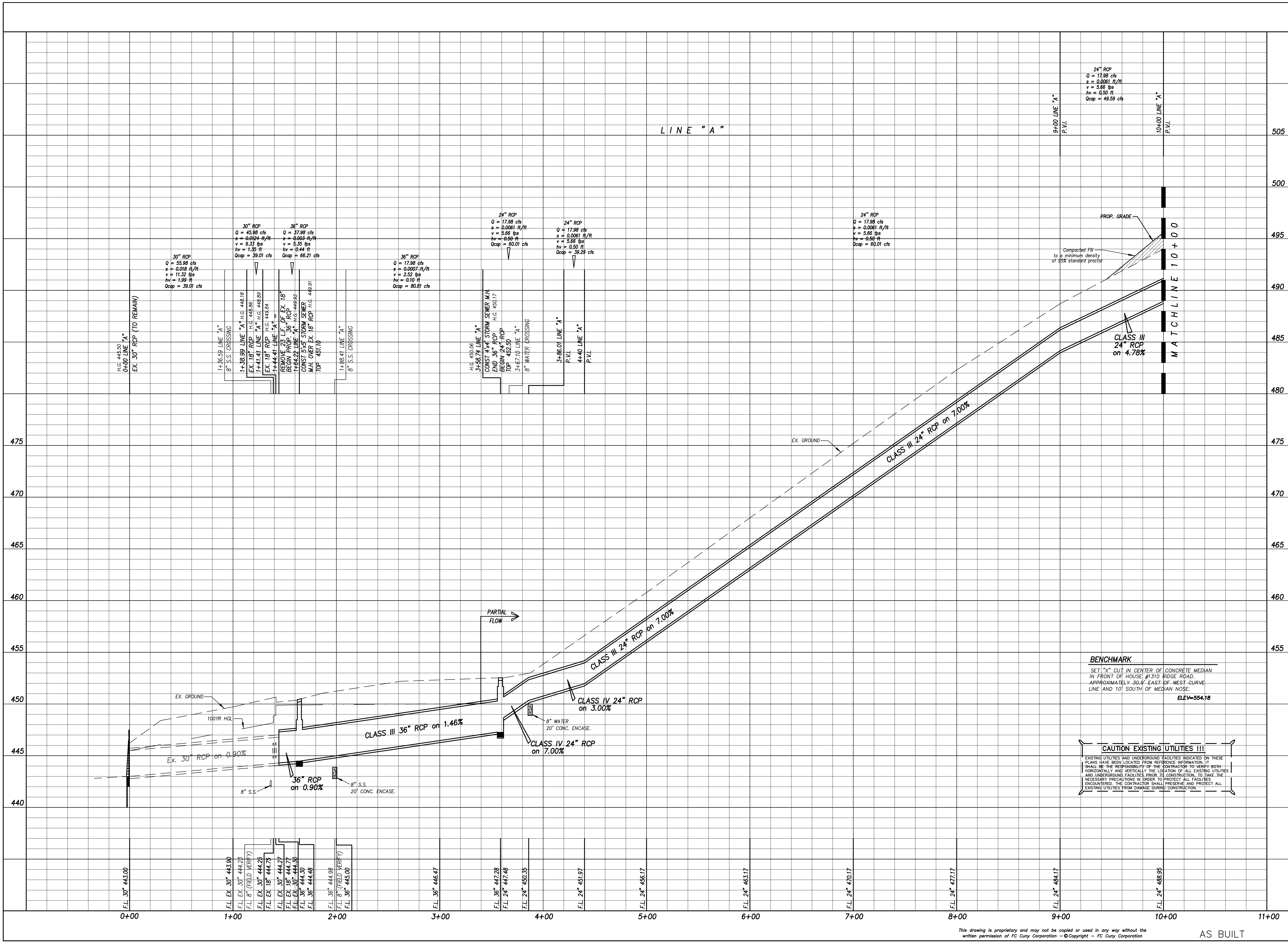

Owner:  
**Dan Bobst**  
5133 F.M. 549 • Rockwall, Texas • 75032  
Phone: 214-553-5505

**Eagle Point Estates**  
Rockwall, Texas

~ Civil Engineer ~  
**F.C. CUNY CORPORATION**  
#2 Horizon Court • Heath, Texas 75032 • (469) 402-7700  
Texas Registered Engineering Firm F-7449

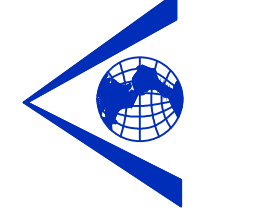

**BENCHMARK**  
SET "X" CUT IN CENTER OF CONCRETE MEDIAN  
IN FRONT OF HOUSE #1310 RIDGE ROAD.  
APPROXIMATELY 30.9' EAST OF WEST CURVE  
LINE AND 10' SOUTH OF MEDIAN NOSE.  
ELEV=554.18

**CAUTION EXISTING UTILITIES !!!**  
EXISTING UTILITIES AND UNDERGROUND FACILITIES INDICATED ON THESE  
PLANS HAVE BEEN LOCATED FROM REFERENCE INFORMATION. IT  
SHALL BE THE RESPONSIBILITY OF THE CONTRACTOR TO VERIFY BOTH  
HORIZONTALLY AND VERTICALLY THE LOCATION OF ALL EXISTING UTILITIES  
AND UNDERGROUND FACILITIES PRIOR TO CONSTRUCTION. TO TAKE THE  
NECESSARY PRECAUTIONS IN ORDER TO PROTECT ALL FACILITIES  
ENCOUNTERED. THE CONTRACTOR SHALL PRESERVE AND PROTECT ALL  
EXISTING UTILITIES FROM DAMAGE DURING CONSTRUCTION.

Drawn By: F.C. CUNY	Checked By: F.C. CUNY
Date: 08/11	Project No.:
Sheet Title: <b>Storm Sewer Profile</b> Sta. 0+00 to 10+00	
Scale:	Sheet No.:
h : 1" = 40'	9 of 12
v : 1" = 4'	

This drawing is proprietary and may not be copied or used in any way without the written permission of F.C. Cuny Corporation - © Copyright - F.C. Cuny Corporation

AS BUILT

Z:\Projects\5-Residential\Dan Bobst\AS BUILT\09 - 10 STORM SEWER PROFILES.dwg