

Revision	Date	Description
1	7/10/13	SANITARY SEWER REVISION
2	7/18/13	SANITARY SEWER REVISION
3	8/16/13	SANITARY SEWER REVISION

Owner: **Dan Bobst**
 5133 F.M. 549 • Rockwall, Texas • 75032
 Phone: 214-553-5505

Eagle Point Estates
 Rockwall, Texas

~ Civil Engineer ~
F.C. CUNY CORPORATION
 #2 Horizon Court • Heath, Texas 75032 • (469) 402-7700
 Texas Registered Engineering Firm F-7449

Drawn By: F.C. CUNY	Checked By: F.C. CUNY
Date: 08/11	Project No.:
Sheet Title: Water and Sanitary Sewer Plan	
Scale:	Sheet No.:
1" = 60'	5 of 12

Fire Water and Sanitary Sewer General Notes:

- Water mains shall be AWWA C-900 PVC Class 200 unless otherwise noted. Minimum cover for waterlines is 48" or as required to clear existing utilities, whichever is greater.
- Marking tape shall be installed over PVC water lines and above sanitary sewer lines and locator discs above the termination of the service connection.
- Fittings for PVC water lines shall be fully body fittings and mega lugs on all MJ ductile iron fittings and be encased in a polyethylene sheath.
- Valves shall be resilient seat gate valves.
- All direct burial valves shall be provided with cast iron valve boxes with PVC stacks. Valve stacks shall be vertical and concentric with the valve stem. Stainless steel valve extensions are required on all valves where the operating nut is greater than 4 feet below finished grade.
- Fire hydrants shall be field painted per City of Rockwall specifications.
- All exposed bolting on any buried equipment or material shall be stainless steel. Included are:
 - Bonnet and stuffing box bolts on valves.
 - Shoe bolts on fire hydrants.
 - Flange bolts.
- Meter boxes shall be as approved by the City of Rockwall.
- Sanitary sewer mains shall be SDR 35 PVC. (SDR 26 if depth is over 10')
- The contractor shall install and maintain water tight plugs in all connections to the City's sanitary sewer system until the project is accepted by the City.
- All sanitary sewer lines and manholes shall be leak tested before the project is accepted. Deflection testing of PVC sewer lines is required.
- All embedment will be in accordance with the City of Rockwall standards.
- All water main & sewer crossings shall be made in accordance with TCEQ regulation Chapter 290 Subchapter D Rule 290.44 (e) 1 through 4.
- Where water main & sewer cross, contractor shall center sanitary sewer pipe joint at the centerline of the proposed waterline, and install 20 linear feet of cement stabilized sand, 10' feet each side of centerline.
- Cement stabilized sand embedment shall have a minimum of 2.5 bags of cement per C.Y. of mixture. Cement stabilized sand shall be a minimum of six inches above and four inches below the wastewater main.
- Minimum radius for 8" water line shall be 300'. Use bends as required if radius can't be maintained.
- Minimum radius for 8" sanitary sewer shall be 200'.
- All Sanitary Services Shall Be 4" SDR 35 PVC.
- All sanitary sewer and water services to be extended to R.O.W. unless otherwise noted.
- Double cleanouts shall be installed by plumber at proposed building when lot is developed.
- Blue EMS disks to be installed on water line at every change in direction, valve, and service.
- Green EMS disks to be installed on sanitary sewer line at every change in direction, manhole, clean out, and service.
- All manholes in paving shall be, PAMTIGHT if in paving or driveway, PAMREX if not in paving or driveway and Raven epoxy coated inside.
- Water is to be constructed 5' behind curb, sanitary sewer is to be constructed 5.5' behind curb.

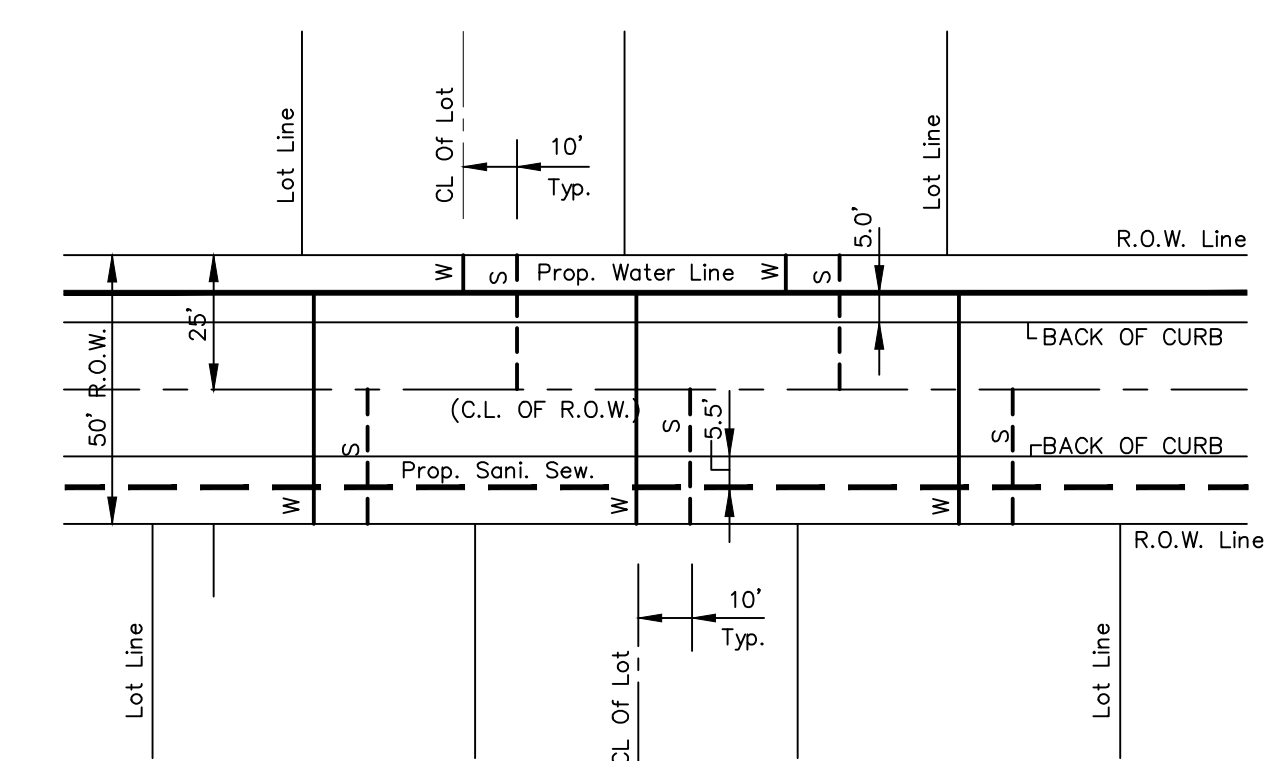

- All water services to be installed in the center of each lot.
- All sanitary sewer laterals will be 4" and installed 10' downstream of each water service.

Typical Water & Sewer Detail
 N.T.S.

BENCHMARK NO 1:
 SET "X" CUT IN CENTER OF CONCRETE MEDIAN IN FRONT OF HOUSE #1310 RIDGE ROAD, APPROXIMATELY 30.9' EAST OF WEST CURVE LINE AND 10' SOUTH OF MEDIAN NOSE.
ELEV=554.18

CAUTION EXISTING UTILITIES !!!
 EXISTING UTILITIES AND UNDERGROUND FACILITIES INDICATED ON THESE PLANS HAVE BEEN LOCATED FROM REFERENCE INFORMATION. IT SHALL BE THE RESPONSIBILITY OF THE CONTRACTOR TO VERIFY BOTH HORIZONTALLY AND VERTICALLY THE LOCATION OF ALL EXISTING UTILITIES AND UNDERGROUND FACILITIES PRIOR TO CONSTRUCTION. TO TAKE THE NECESSARY PRECAUTIONS IN ORDER TO PROTECT ALL FACILITIES ENCOUNTERED, THE CONTRACTOR SHALL PRESERVE AND PROTECT ALL EXISTING UTILITIES FROM DAMAGE DURING CONSTRUCTION.

