

# CONSTRUCTION PLANS FOR DALTON RANCH

DALTON RANCH

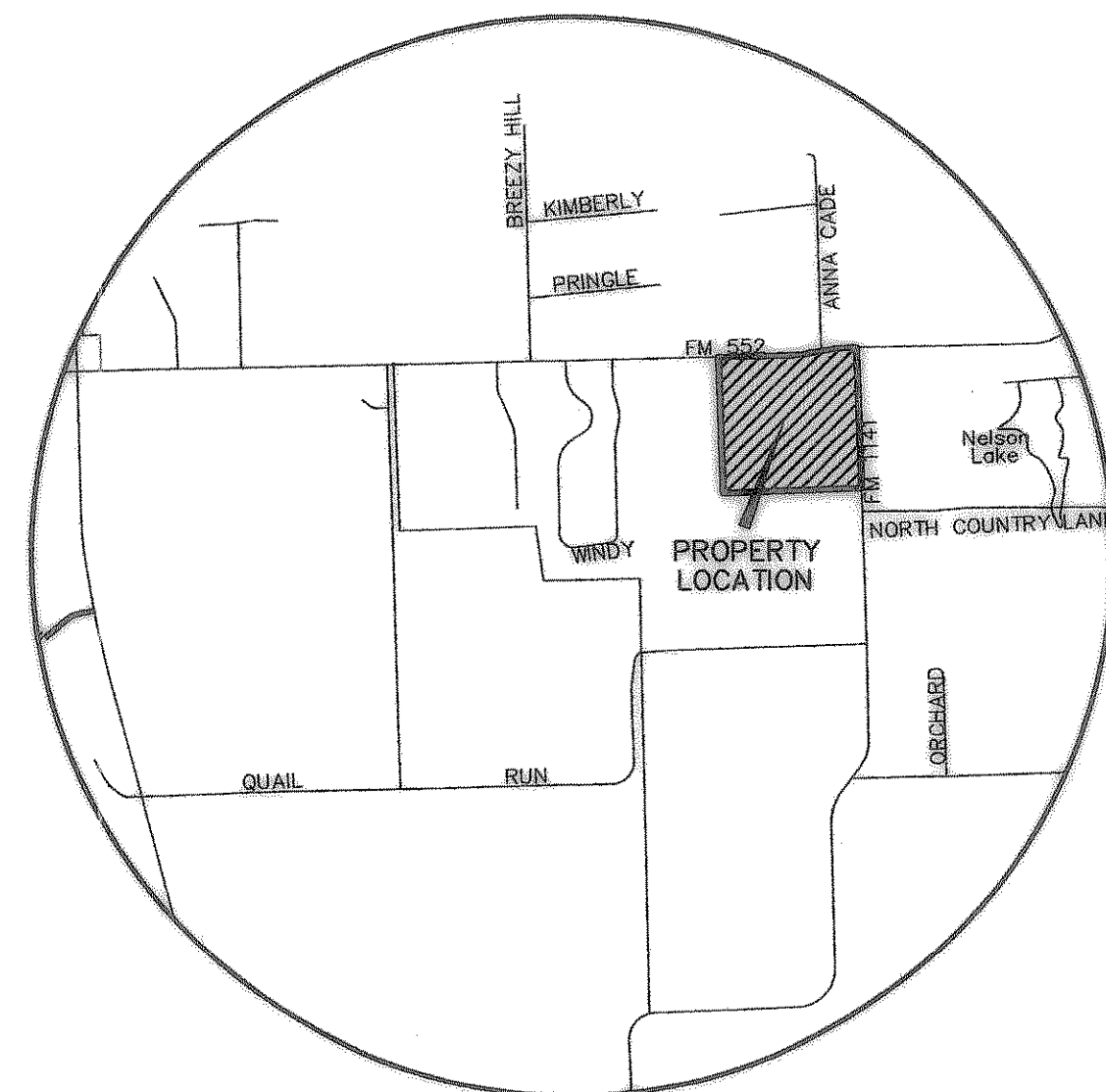

LOCATION MAP  
MAPSCO PAGE 10D-X

AS BUILT  
To the best of our knowledge "Winkelmann and Associates, Inc." hereby states that this plan is "As-Built". The information is based on surveying conducted at the site and modification information provided by "the Contractor".

*M. Naim Uddin Khan* 9/25/07  
WINKELMANN & ASSOCIATES, INC. DATE

ALL CONTRACTORS TO USE STANDARD DETAILS  
PER CITY OF ROCKWALL.

CITY OF ROCKWALL  
ROCKWALL COUNTY, TEXAS

SEPTEMBER 8, 2006

DEVELOPER:

D.R. HORTON  
4306 MILLER ROAD, SUITE-A  
ROWLETT, TEXAS 75088



THESE CONSTRUCTION PLANS WERE PREPARED  
UNDER THE RESPONSIBLE SUPERVISION OF  
MR. NAIM UDDIN KHAN, REGISTERED PROFESSIONAL  
ENGINEER NO. 87776

THE SEAL APPEARING ON THIS  
DOCUMENT WAS AUTHORIZED BY  
MR. NAIM UDDIN KHAN, # 87776

*M. Naim Uddin Khan* 9/11/06

## SHEET INDEX

- COVER SHEET
- FINAL PLAT
- TREESCAPE PLAN
- 1. DRAINAGE AREA MAP
- 2. DRAINAGE CALCULATIONS
- PAVING PLANS & PROFILES
- 3. PANHANDLE DRIVE STA. -0+13.43 TO 10+00
- 4. PANHANDLE DRIVE STA. 10+00 TO 19+38.77
- 5. BARTON SPRINGS STA. 0+00 TO 8+00
- 6. BARTON SPRINGS STA. 8+00 TO 15+04.34
- 7. LONGHORN LANE STA. 0+00 TO 5+87.87
- 8. BROKEN SPOKE STA. 0+00 TO 7+84.50
- 9. TRAIL DRIVE STA. 7+84.50 TO 10+00
- 10. TRAIL DRIVE STA. 10+00 TO 15+15.76
- 11. PAINTED PONY STA. 15+15.76 TO 22+22.77
- 12. CHUCK WAGON STA. 0+00 TO 8+70
- 13. CHUCK WAGON STA. 8+70 TO 14+78.20
- 14. LIMESTONE WAY STA. 0+00 TO 10+00
- 15. LIMESTONE WAY STA. 10+00 TO 19+89.44
- 16. NORTH COUNTRY LANE STA. 10+00 TO 14+54.61
- 17. NORTH COUNTRY LANE STA. 0+00 TO 10+00
- 18. SADDLE HORN CL. STA. 0+00 TO 2+07.81
- 19. TUMBLEWEED CL. STA. 0+00 TO 2+58.00
- 20. PAVING & STRIPING PLAN - FM 1141 & FM 552
- ALLEY PLANS & PROFILES
- 21. ALLEY "1" - STA. 0+00 TO 4+06.04
- 22. ALLEY "2" - STA. 0+00 TO 5+00
- 23. ALLEY "3" - STA. 5+00 TO 7+11.32
- 24. ALLEY "4" - STA. 0+00 TO 5+81.07
- 25. ALLEY "5" - STA. 0+00 TO 5+18.08
- 26. ALLEY "6" - STA. 0+00 TO STA. 5+82.84
- 27. ALLEY "7" - STA. 0+00 TO STA. 7+89.88
- STORM SEWER PLANS
- 28. LINE "1", LINE "5", LINE "6", LINE "7" & LINE "11"
- 29. LINE "1", LINE "2", LINE "3" & LINE "4"
- 30. LINE "3", LINE "8" & LINE "12"
- STORM SEWER PROFILES
- 31. LINE "1" - STA. 1+00.00 TO 14+32.35
- 32. LINE "2" - STA. 1+00.00 TO 6+00.00
- 33. LINE "3" - STA. 6+00.00 TO 8+23.01
- 34. LINE "4" - STA. 1+00.00 TO 6+45.37
- 35. LINE "5" - STA. 15+77.99 TO 28+82.85
- 36. LINE "6" - STA. 1+00.00 TO 6+83.99
- 37. LINE "7" - STA. 1+00.00 TO 9+27.49
- 38. LINE "8" - STA. 1+00.00 TO 5+74.55
- 39. LINE "9" - STA. 1+00.00 TO STA. 2+73.60
- 40. LINE "10" - STA. 1+00.00 TO 6+87.08
- 41. LINE "11" - STA. 1+00.00 TO 2+34.83
- 42. LINE "12" - STA. 1+00.00 TO 9+80.05
- 43. LINE "13" - STA. 1+88.30 TO -9+00.00
- 44. CULVERT PLAN, PROFILE & CALCULATIONS-CULVERT 1
- 45. CULVERT PLAN, PROFILE & CALCULATIONS-CULVERT 2
- 46. CULVERT PLAN, PROFILE & CALCULATIONS-CULVERT 3
- 47. CULVERT PLAN, PROFILE & CALCULATIONS-CULVERT 4
- 48. WATER & SANITARY SEWER PLAN
- 49. WATER & SANITARY SEWER PLAN
- 50. WATER & SANITARY SEWER PLAN
- 51. WATER & SANITARY SEWER PLAN
- 52. 16" WATER PROFILE
- 53. WLINE "A" STA 1+00 TO STA 16+18.81
- 54. 16" WATER PROFILE
- 55. WLINE "B" STA 1+00 TO STA 11+44.75
- SANITARY SEWER PROFILES
- 56. LINE B - STA. 0+00.00 TO 17+11.40
- 57. LINE H - STA. 0+00.00 TO 4+00.00
- 58. LINE "B-1" - STA. 0+00 TO STA. 7+00
- 59. LINE "H" - STA. 0+00 TO STA. 3+70.00
- 60. LINE "M" - STA. 0+00 TO STA. 0+00
- 61. LINE F - STA. 0+00.00 TO 10+00.00
- 62. LINE E - STA. 0+00.00 TO 1+90.00
- 63. LINE K - STA. 0+00.00 TO 6+50.00
- 64. LINE F - STA. 10+00.00 TO 12+40.00
- 65. LINE C - STA. 0+00.00 TO 11+50.00
- 66. LINE D - STA. 0+00.00 TO 2+15.00
- 67. LINE G - STA. 0+00.00 TO 12+35.00
- 68. LINE J - STA. 0+00.00 TO 6+00.00
- 69. LINE J - STA. 6+00.00 TO 11+70.00
- 70. LINE L - STA. 0+00.00 TO 8+15.00
- 71. LINE N - STA. 0+00.00 TO 2+25.00
- 72. LINE I - STA. 0+00.00 TO 2+05.00
- 73. LINE A - STA. 0+00.00 TO 20+48.89
- 74. LOT GRADING PLAN
- 75. LOT GRADING PLAN
- 76. LOT GRADING PLAN
- 77. LOT GRADING PLAN
- 78. STORM WATER POLLUTION PREVENTION PLAN
- 79. STORM WATER POLLUTION PREVENTION PLAN -DETAILS
- SCREENING / LANDSCAPE PLAN
- SHEET L1 TO L10

**Winkelmann & Associates, Inc.**

CONSULTING CIVIL ENGINEERS ■ SURVEYORS  
6750 HILLCREST PLAZA DRIVE, SUITE 100 (972) 490-7090  
DALLAS, TEXAS 75230 (972) 490-7099 FAX