

RECORD DRAWINGS:
 THE INTENT OF THE OWNER AND ENGINEER WAS TO CONSTRUCT THESE FACILITIES ACCORDING TO THESE PLANS AS APPROVED BY THE CITY OF Rockwall. THE LINES AND GRADES WERE SET ON THE GROUND FOR CONSTRUCTION ACCORDING TO SAID PLANS. THE CITY OF Rockwall INSPECTED THE CONSTRUCTION. THE OWNER NOR ENGINEER DID NOT VERIFY LINES OR GRADES AFTER CONSTRUCTION. WE ARE NOT AWARE OF ANY CHANGES OR REVISIONS TO THESE PLANS DURING CONSTRUCTION EXCEPT AS NOTED

HIGH POINT ELEV = 518.39
 HIGH POINT STA = 9+22.42
 PVI STA = 9+50
 PVI ELEV = 519.00
 A.D. = -3.47
 K = 46.11

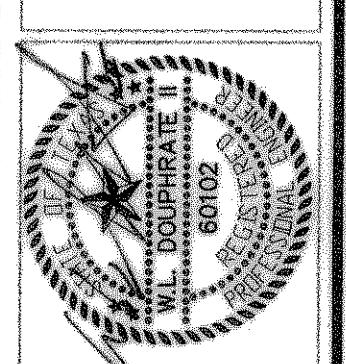
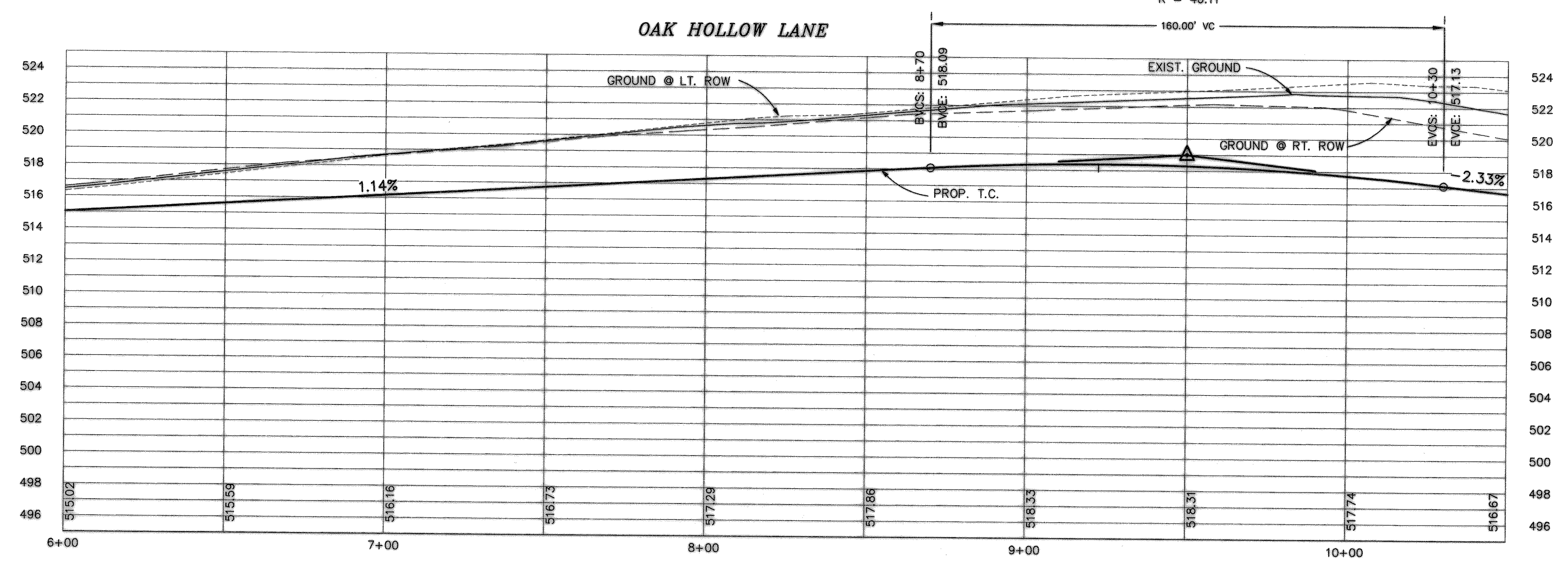

THE SEAL APPEARS ON THIS DOCUMENT WAS AUTHORIZED BY W.L. DOUPHRATE IN TEXAS P.E. NO. 80102 ON 6/12/00

DOUPHRATE & ASSOCIATES, INC.
 ENGINEERING • PROJECT MANAGEMENT • SURVEYING
 2231 RIDGE RD., # 200 ROCKWALL, TEXAS 75087
 PHONE: (972)771-9004 FAX: (972)771-9005

PAVING PLAN & PROFILE
OAK HOLLOW LANE
 CREEKSIDE VILLAGE, PHASE II
 CITY OF ROCKWALL, ROCKWALL COUNTY, TEXAS

REVISION
W.L.D. CHECKED
K.E.B. DRAWN
3/20/00 DATE
9960 PV2 PROJECT