

SANITARY SEWER LINE "C"

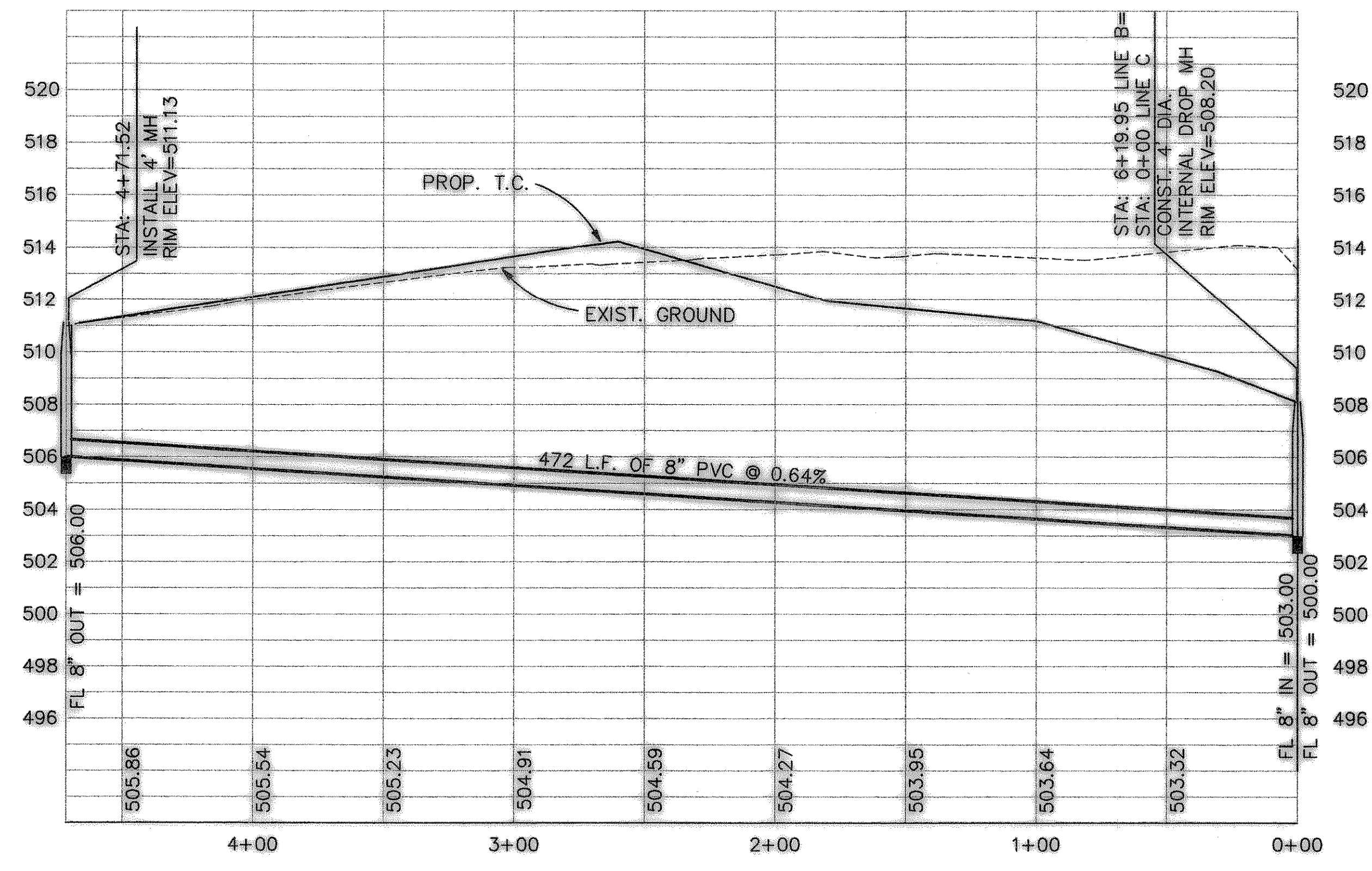

SANITARY SEWER LINE "D"

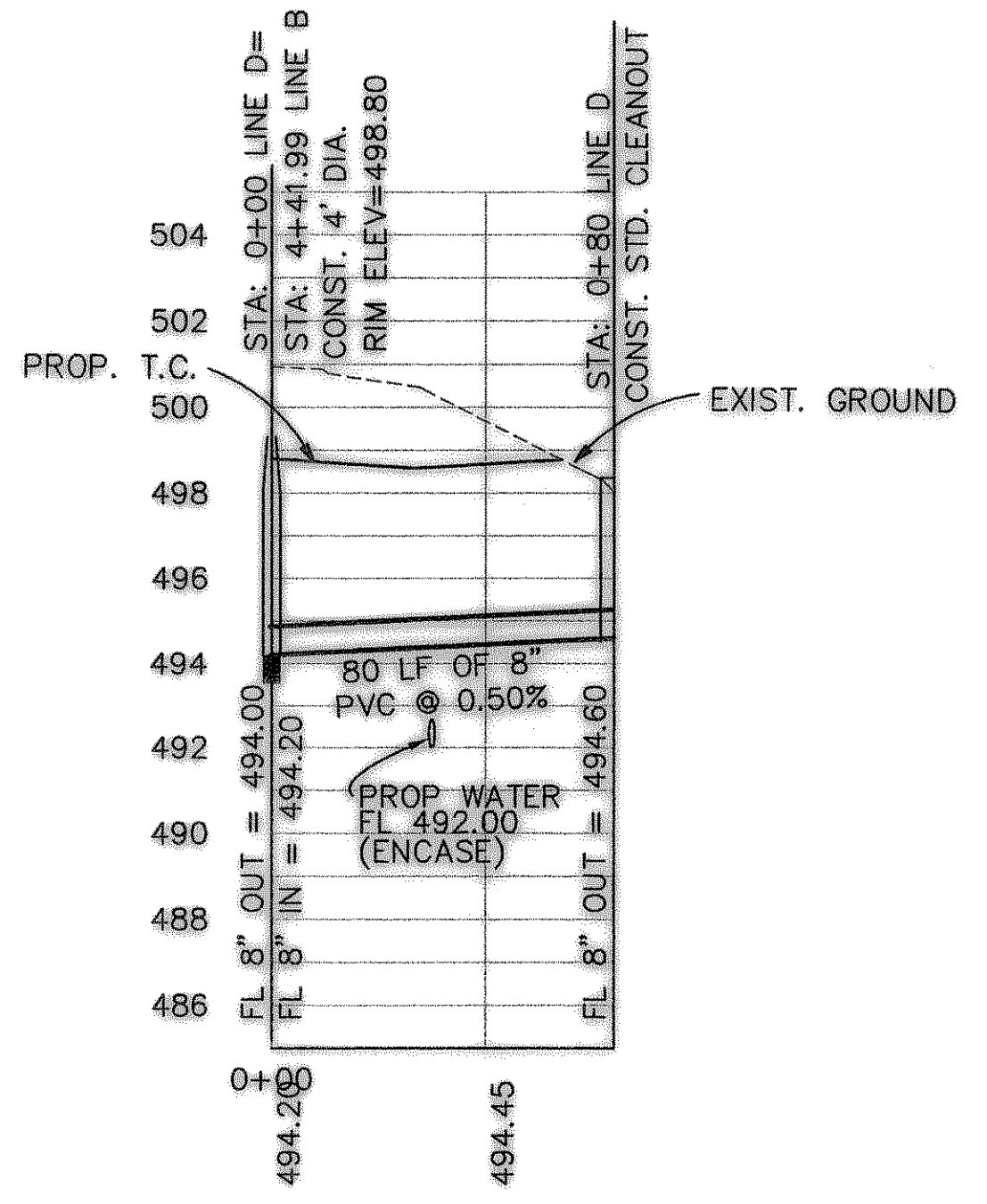

RECORD DRAWINGS:
 THE INTENT OF THE OWNER AND ENGINEER WAS TO CONSTRUCT THESE FACILITIES ACCORDING TO THESE PLANS AS APPROVED BY THE CITY OF _____, THE LINES AND GRADES WERE SET ON THE GROUND FOR CONSTRUCTION ACCORDING TO SAID PLANS. THE CITY OF _____ INSPECTED THE CONSTRUCTION. THE OWNER NOR ENGINEER DID NOT VERIFY LINES OR GRADES AFTER CONSTRUCTION. WE ARE NOT AWARE OF ANY CHANGES OR REVISIONS TO THESE PLANS DURING CONSTRUCTION EXCEPT AS NOTED

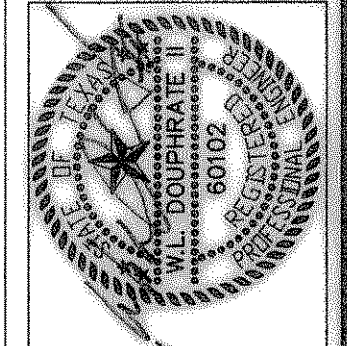

THE SEAL APPEARING ON THIS DOCUMENT WAS AUTHORIZED BY W.L. DOUPHRATE II TEXAS P.E. NO. 80102 ON 03/21/00

DOUPHRATE & ASSOCIATES, INC.
 ENGINEERING • PROJECT MANAGEMENT • SURVEYING
 2251 RIDGE RD., # 200 ROCKWALL, TEXAS 75087
 PHONE: (972)771-9004 FAX: (972)771-9005

**SANITARY SEWER PROFILE
 LINE "C"
 CREEKSIDE VILLAGE, PHASE II
 CITY OF ROCKWALL, ROCKWALL COUNTY, TEXAS**

REVISION
W.L.D.
CHECKED
K.E.B.
DRAWN
3/21/00
DATE
9960 SSF3
PROJECT