

Inlet Report Page 1

Line No.	Inlet ID	Q = C/A (cfs)	Q carry (cfs)	Q capt. (cfs)	Q Byp. (cfs)	Juno Type	Curb Inlet		Grate Inlet		Gutter						Inlet	Byp. Line No.				
							Ht. (ft)	L. (ft)	Area (sqft)	L. (ft)	W. (ft)	So. (ft/ft)	W. (ft)	Sw. (ft/ft)	Sx. (ft/ft)	n			Depth (ft)	Spread (ft)	Depth (ft)	Spread (ft)
1	A3	7.40	0.00	3.17	4.23	Curb	12.0	12.00	0.00	0.00	0.00	0.026	2.00	0.050	0.020	0.013	0.30	11.84	0.25	9.55	0.0	Off
2	RJ1	1.77	0.00	0.00	1.77	MH	0.0	0.00	0.00	0.00	0.00	Sag	0.00	0.000	0.000	0.000	0.00	0.00	0.00	0.00	0.0	Off
3	RCI2	1.85	0.00	1.30	0.00	Curb	0.0	0.00	0.00	0.00	0.00	Sag	2.00	0.050	0.020	0.000	0.23	3.32	0.29	3.32	0.0	Off
4	RCI3	2.13	0.00	2.13	0.00	Curb	0.0	0.00	0.00	0.00	0.00	Sag	2.00	0.050	0.020	0.000	0.29	11.51	0.29	11.51	0.0	Off
5	RCI4	1.01	0.00	1.01	0.00	Curb	0.0	0.00	0.00	0.00	0.00	Sag	2.00	0.050	0.020	0.000	0.20	6.87	0.20	6.87	0.0	Off

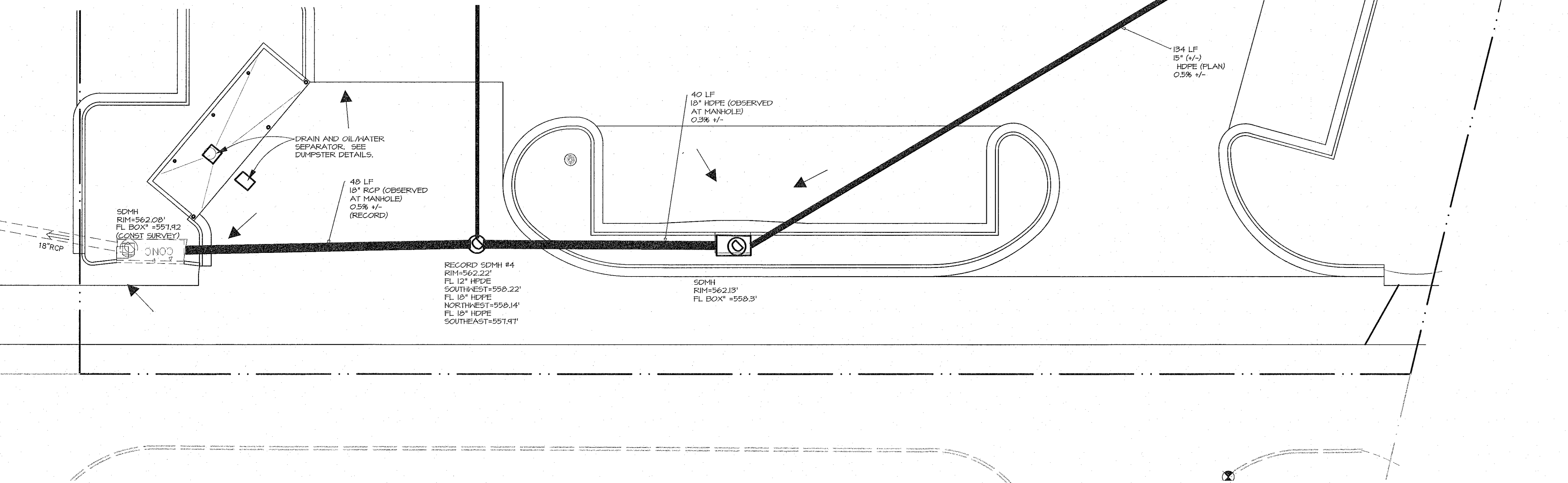

LEGEND

EXISTING	PROPOSED
—	CONTOUR
—	SPOT EL.*
—	STORM SEWER
—	SANITARY SEWER
⊙	MANHOLE
⊙	CLEAN OUT
—	WATER LINE
—	OVERHEAD ELEC.
—	UNDERGROUND ELEC.
—	UNDERGROUND GAS
□	CATCH BASIN
⊗	GATE VALVE
⊗	FIRE HYDRANT
⊙	UTILITY POLE
⊙	LIGHT POLE
—	PARKING COUNT

* SPOT ELEVATION ABBREVIATIONS:
TC - TOP OF CURB
FL - FLOW LINE
TR - TOP OF RAMP
BR - BOTTOM OF RAMP
TLIP - TOP OF CONCRETE LIP
BLIP - BOTTOM OF CONCRETE LIP

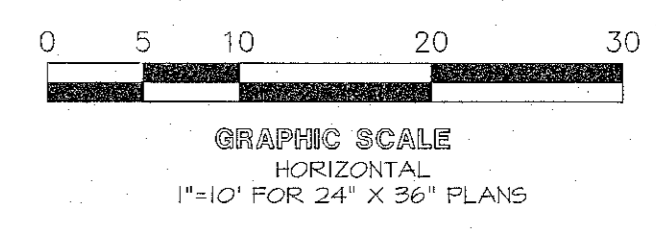

FLOOD INFORMATION:
THIS PROPERTY IS LOCATED IN FLOOD ZONE "X"
PER NFIP FIRM COMMUNITY PANEL NO. 483970040L EFFECTIVE DATE: SEPTEMBER 26, 2008

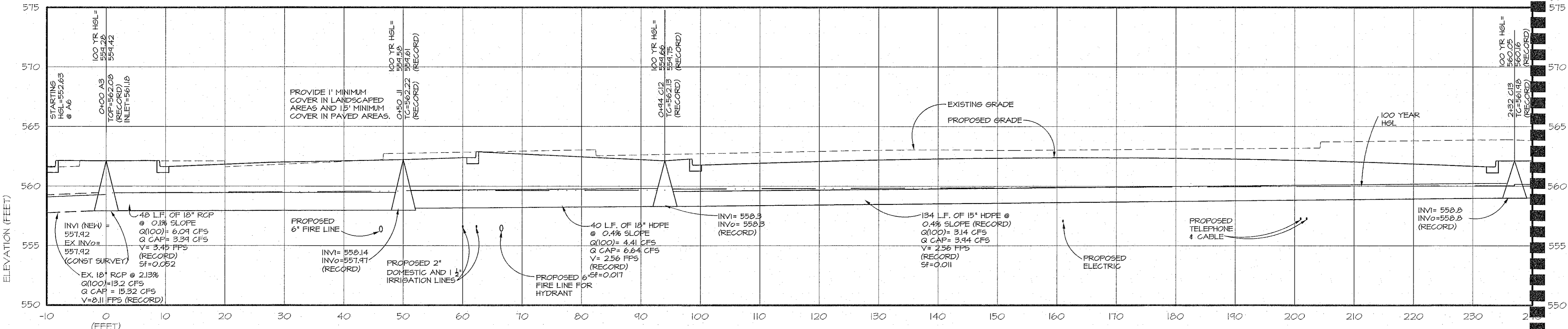

CAUTION

THE UTILITIES SHOWN ARE SHOWN FOR THE CONTRACTOR'S CONVENIENCE ONLY. THERE MAY BE OTHER UTILITIES NOT SHOWN ON THESE PLANS. THE ENGINEER ASSUMES NO RESPONSIBILITY FOR THE LOCATIONS SHOWN, AND IT SHALL BE THE CONTRACTOR'S RESPONSIBILITY TO VERIFY THE LOCATIONS OF ALL UTILITIES WITHIN THE LIMITS OF THE WORK. ALL DAMAGE MADE TO EXISTING UTILITIES BY THE CONTRACTOR SHALL BE THE SOLE RESPONSIBILITY OF THE CONTRACTOR.

ALL RESPONSIBILITY FOR ADEQUACY OF DESIGN REMAINS WITH THE DESIGN ENGINEER, THE CITY OF ROCKWALL, IN REVIEWING AND RELEASING PLANS FOR CONSTRUCTION, ASSURES NO RESPONSIBILITY FOR ADEQUACY OR ACCURACY OF DESIGN.

PROPERTY OWNER: KOHL'S ILLINOIS, INC. 1645 WESTGATE CIRCLE BRENTWOOD, TENNESSEE 37027

OWNER: CB005 TEXAS LIMITED PARTNERSHIP P.O. BOX 181 LEBANON, TENNESSEE 37088-0181

PLANS PREPARED BY: JAMES A. CRAIG, P.E. DESIGN AND ENGINEERING, INC. 1645 WESTGATE CIRCLE BRENTWOOD, TENNESSEE 37027

CRACKER BARREL
OLD COUNTRY STORE, INC.
845 E. INTERSTATE 30 FRONTAGE RD.
ROCKWALL, TEXAS 75087
BLOCK A, LOT 1
CASE NUMBER: SP2018-028

CRACKER BARREL PROJECT NUMBER: CB 164 ROCKWALL, TX -03

CRACKER BARREL
OLD COUNTRY STORE, INC.
845 E. INTERSTATE 30
ROCKWALL, TEXAS 75087

These construction documents are the exclusive property of Cracker Barrel Old Country Store, Inc. The information shown may not be used or the drawings reproduced without written permission of Cracker Barrel Old Country Store, Inc.

Cracker Barrel

P.O. Box 787
Hartmann Drive, Lebanon, TN 37087

DESIGN AND ENGINEERING, INC.
TEXAS COA #F-4114

1645 Westgate Circle
Brentwood, TN 37027
615-370-1779
615-370-1779
www.dandecinc.us

DESIGN and ENGINEERING
STRUCTURAL AND CIVIL ENGINEERS

DATE: 12-10-11
PROJECT NO.: 11-1645

REVISIONS

Cracker Barrel
Old Country Store

RECORD STORM DRAINAGE PLAN (1)

RC-2B

PROTO 116-11F