

GRAPHIC SCALE  
VERTICAL AND HORIZONTAL  
1"=20' FOR 24" X 36" PLANS

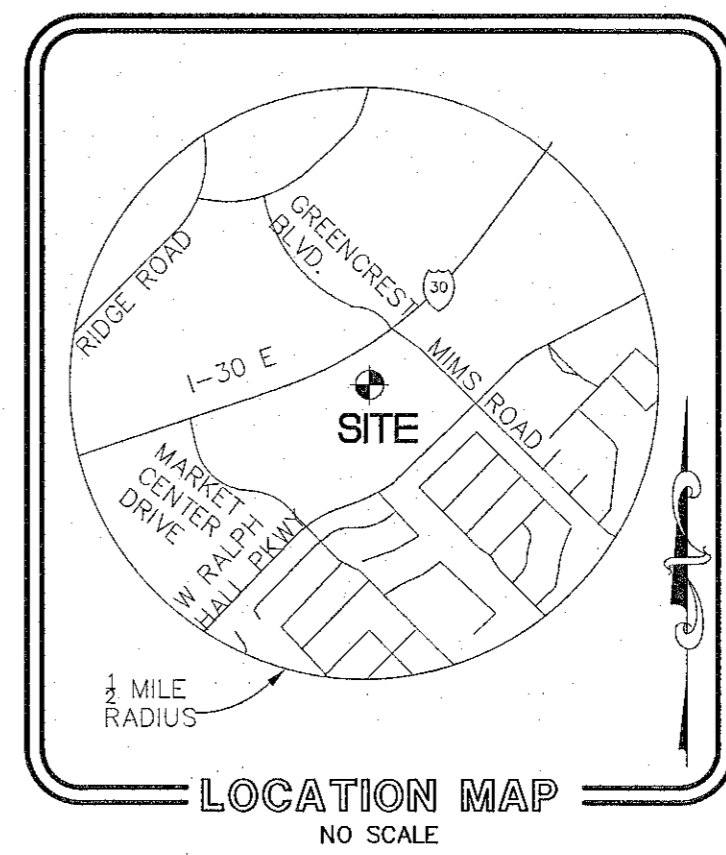

LOCATION MAP  
NO SCALE

| EXISTING        | CONTOUR           | PROPOSED        |
|-----------------|-------------------|-----------------|
| SPOT EL.        | CONTOUR           | SPOT EL.        |
| SANITARY SEWER  | STORM SEWER       | SANITARY SEWER  |
| MANHOLE         | CLEAN OUT         | MANHOLE         |
| WATER LINE      | OVERHEAD ELEC.    | WATER LINE      |
| UNDERGROUND GAS | UNDERGROUND ELEC. | UNDERGROUND GAS |
| CATCH BASIN     | GATE VALVE        | CATCH BASIN     |
| FIRE HYDRANT    | UTILITY POLE      | FIRE HYDRANT    |
| LIGHT POLE      | PARKING COUNT     | LIGHT POLE      |

**CONCRETE PAVEMENT LEGEND**

- REVISED PAVEMENT HATCHES ADDED.
- 4" CONCRETE SIDEWALK. SEE DETAIL 12/S-3.
  - 5" CONCRETE PAVEMENT FOR PARKING BAY AREAS. SEE DETAIL 0/S-3.
  - 6" CONCRETE PAVEMENT FOR DRIVE AISLES. SEE DETAIL 7/S-3.
  - 7" HEAVY DUTY CONCRETE PAVEMENT. SEE DETAIL 10/S-4.

**RECORD NOTES**

- RECORD INFORMATION TAKEN FROM TOPOGRAPHIC SURVEY REFERENCED ON C-0. ADDITIONAL BASE INFORMATION COMPILED FROM DESIGN PLANS PREPARED BY PEPPER AND ENGINEERING, INC., LATEST DATE OF 06-25-14.
- TOTAL AREA OF SITE: 1.63
- PARKING SUMMARY:  
89 PARKING SPACES FOR CARS  
6 ACCESSIBLE PARKING SPACES  
94 TOTAL PARKING SPACES
- PERSONS USING THIS DRAWING SHOULD CONTACT LOCAL UTILITY COMPANIES FOR EXACT LOCATIONS OF UNDERGROUND UTILITIES.
- ALL DIMENSIONS ARE TO FACE OF CURB AND FACE OF STUD, UNLESS OTHERWISE NOTED.
- UNLESS NOTED OTHERWISE, CURB RADII 3.0' AND ANGLES ARE 90°.
- DO NOT SCALE THIS DRAWING AS IT IS A REPRODUCTION AND SUBJECT TO DISTORTION.
- THE GEOTECHNICAL REPORT, PREPARED BY TIL, INC., DATED APRIL 11, 2016, IS INCORPORATED BY REFERENCE AND MADE A PART OF THE CONTRACT DOCUMENTS. IT IS INTENDED THAT THE RECOMMENDATIONS IN THE GEOTECHNICAL REPORT BE FOLLOWED. IN THE EVENT OF CONFLICT BETWEEN THE DRAWINGS AND THE GEOTECHNICAL REPORT, MAKE NO ASSUMPTIONS. THE ENGINEER SHALL BE IMMEDIATELY NOTIFIED FOR CLARIFICATION BEFORE ANY WORK IS BEGUN.

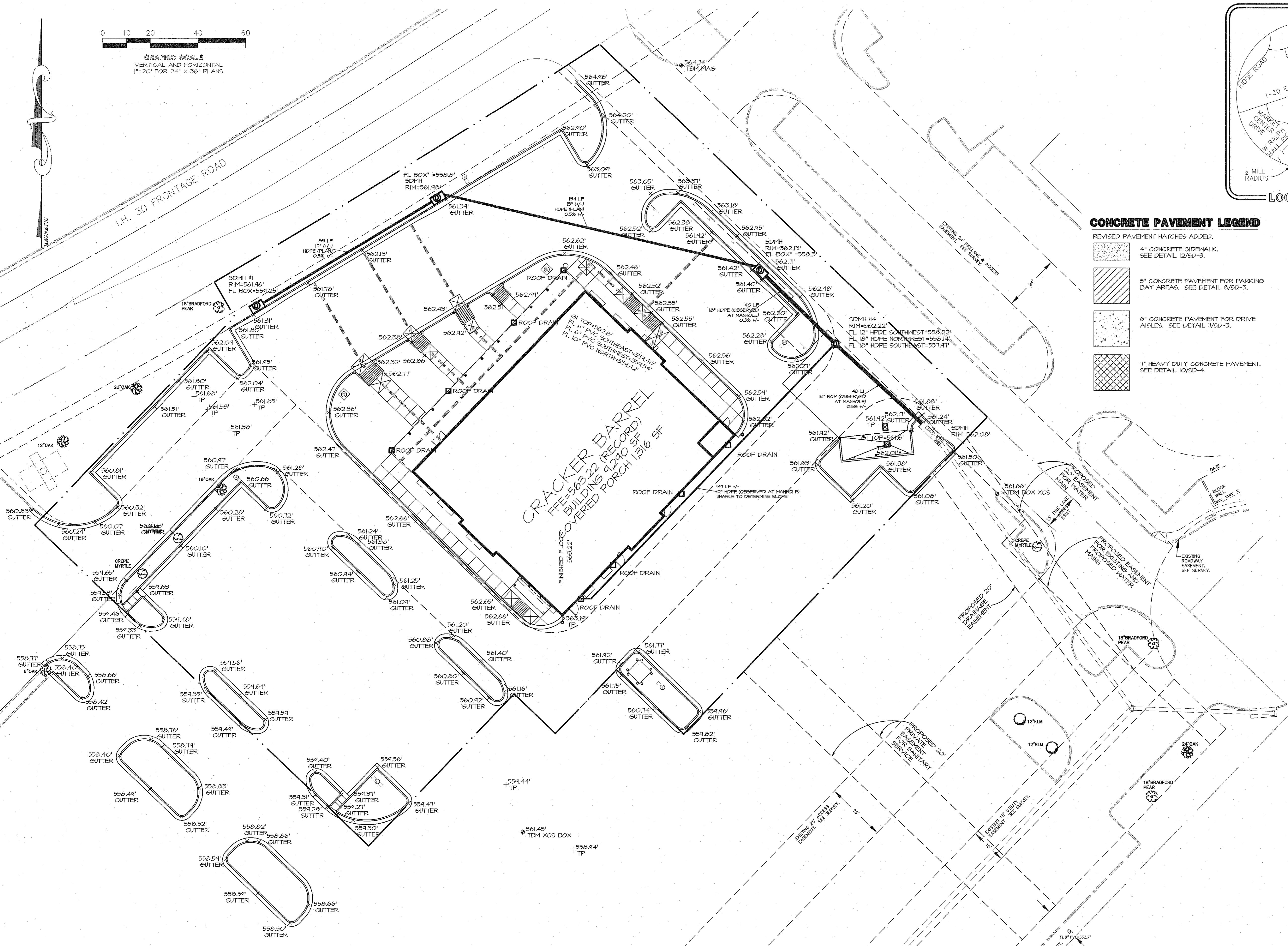

**CATCH BASIN SCHEDULE**

| STRUCTURE | MANUFACTURER'S #   | MANUFACTURER | SIZE           |
|-----------|--------------------|--------------|----------------|
| J1        | R-1070-ASL (SOLID) | NEENAH       | 22" X 22"      |
| C12       | SEE DETAIL 1/S-7   | SEE DETAIL   | 30" DIA. FRAME |
| C13       | SEE DETAIL 1/S-7   | SEE DETAIL   | 30" DIA. FRAME |
| C14       | SEE DETAIL 1/S-7   | SEE DETAIL   | 30" DIA. FRAME |

HDPE - HIGH DENSITY POLYETHYLENE PIPE.  
HI-Q - HANCOR COMPANY, 1-800-841-6500  
N-12 - ADVANCED DRAINAGE SYSTEMS, 1-800-733-4964  
NEENAH CONSTRUCTION CASTINGS, 1-800-550-5075

**CAUTION**  
THE UTILITIES SHOWN ARE SHOWN FOR THE CONTRACTOR'S CONVENIENCE ONLY. THERE MAY BE OTHER UTILITIES NOT SHOWN ON THESE PLANS. THE ENGINEER ASSUMES NO RESPONSIBILITY FOR THE LOCATIONS SHOWN, AND IT SHALL BE THE CONTRACTOR'S RESPONSIBILITY TO VERIFY THE LOCATIONS OF ALL UTILITIES WITHIN THE LIMITS OF THE WORK. ALL DAMAGE MADE TO EXISTING UTILITIES BY THE CONTRACTOR SHALL BE THE SOLE RESPONSIBILITY OF THE CONTRACTOR.

ALL RESPONSIBILITY FOR ADEQUACY OF DESIGN REMAINS WITH THE DESIGN ENGINEER. THE CITY OF ROCKWALL, IN REVIEWING AND RELEASING PLANS FOR CONSTRUCTION, ASSUMES NO RESPONSIBILITY FOR ADEQUACY OR ACCURACY OF DESIGN.

PROPERTY OWNER: KOHL'S ILLINOIS, INC. 1567000 RIDGEWOOD DRIVE MEMPHIS FALLS, WISCONSIN 53051 ERIC BORKENHAGEN (262) 703-7000

OWNER: CBOCS TEXAS LIMITED PARTNERSHIP P.O. BOX 787 LEBANON, TENNESSEE 37088-0787 TELEPHONE: (615) 444-9533

PLANS PREPARED BY: JAMES A. CRAIG, P.E. DESIGN AND ENGINEERING, INC. 1645 WESTGATE CIRCLE BRENTWOOD, TENNESSEE 37027 (615) 370-1174

**CRACKER BARREL  
OLD COUNTRY STORE, INC.  
845 E. INTERSTATE 30 FRONTAGE RD.  
ROCKWALL, TEXAS 75087  
BLOCK A, LOT 1  
CASE NUMBER: SP2018-028**

CRACKER BARREL PROJECT NUMBER: CB 164 ROCKWALL, TX -03  
**CRACKER BARREL  
OLD COUNTRY STORE, INC.  
845 EAST INTERSTATE 30  
ROCKWALL, TEXAS 75087**  
These construction documents are the exclusive property of Cracker Barrel Old Country Store, Inc. The information shown may not be used or the drawings reproduced without written permission of Cracker Barrel Old Country Store, Inc.

**Cracker Barrel**  
P.O. Box 787  
Hartmann Drive, Lebanon, TN 37087

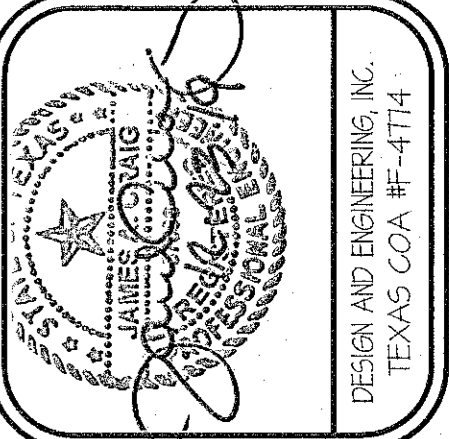

DESIGN and ENGINEERING  
1645 Westgate Circle  
Brentwood, TN 37027  
615-370-1177  
615-370-9108  
www.dandeng.com

STRUCTURAL AND CIVIL ENGINEERS

DATE: 12-16-14  
PROJECT NO.: 11-16-15

| REVISIONS |
|-----------|
|           |
|           |
|           |
|           |
|           |

**Cracker Barrel**  
Old Country Store

**RECORD SITE  
GRADING PLAN**

**RC-2**  
PROTO 176-14F