

DISTURBED AREA = 1.7 ACRES

NOTES:
1. NO ADJACENT SURFACE WATERS.
2. NO ADJACENT WETLANDS.
3. CONTRACTOR SHALL DETERMINE LOCATION OF STABILIZED ENTRANCE TO BEST FACILITATE CONSTRUCTION ACTIVITIES.

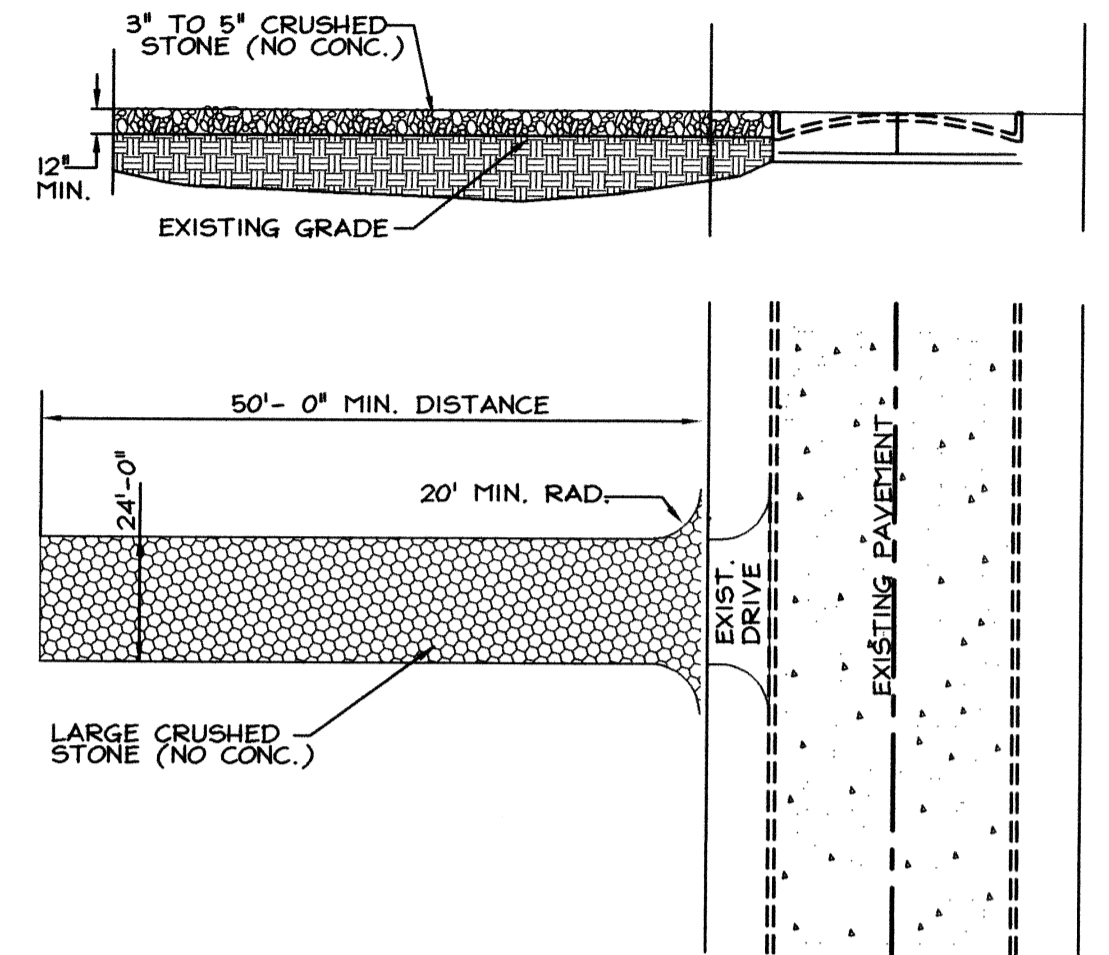

STABILIZED CONSTRUCTION ENTRANCE
N.T.S.

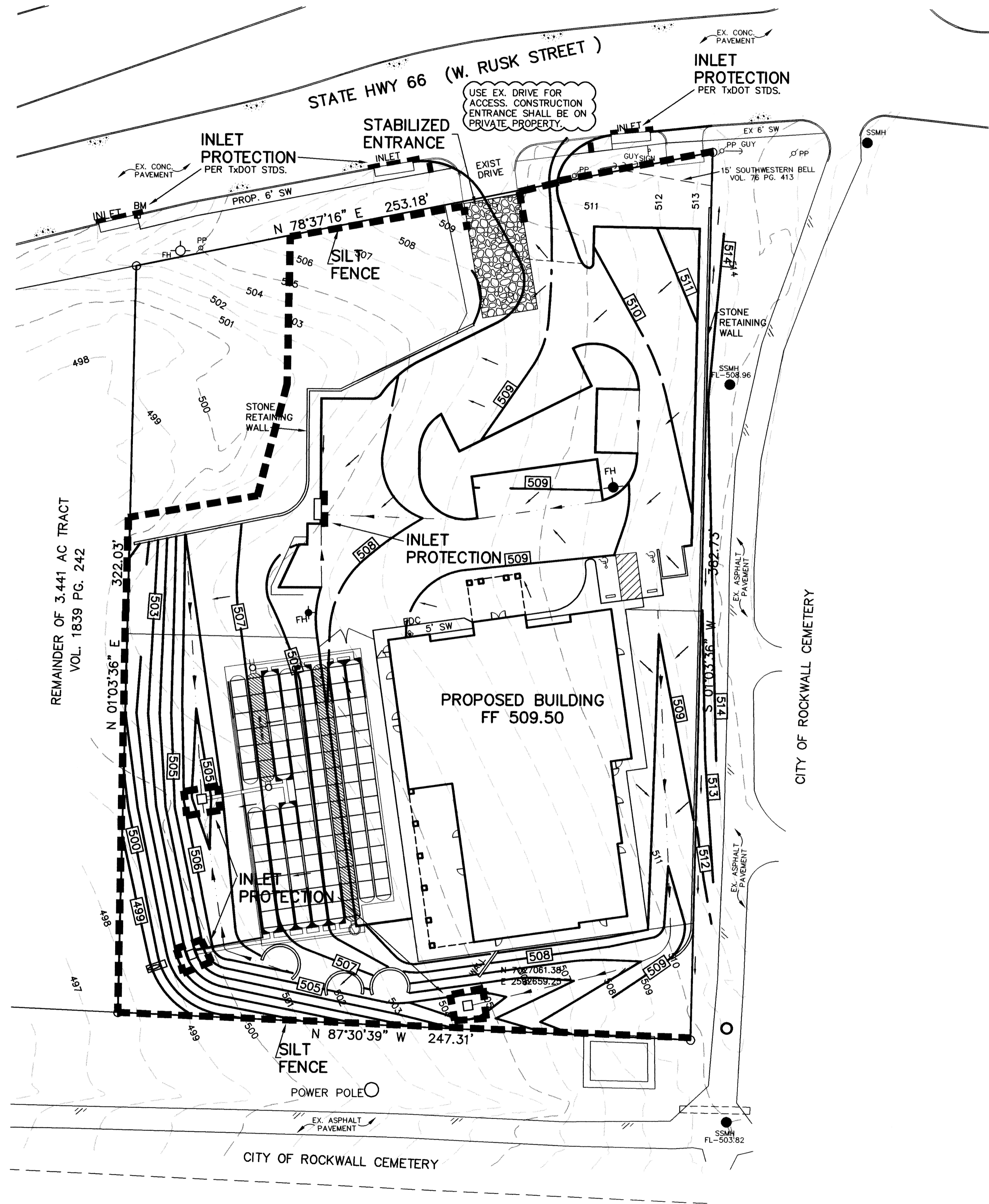
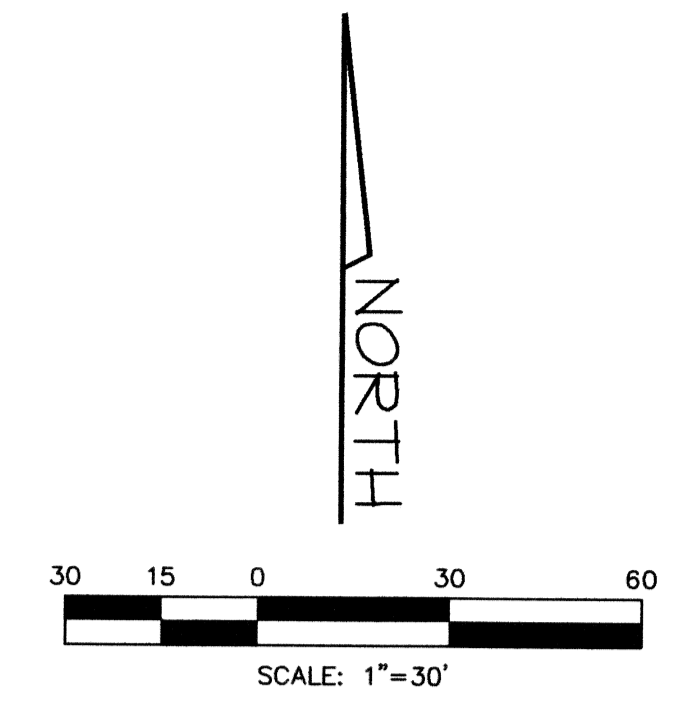
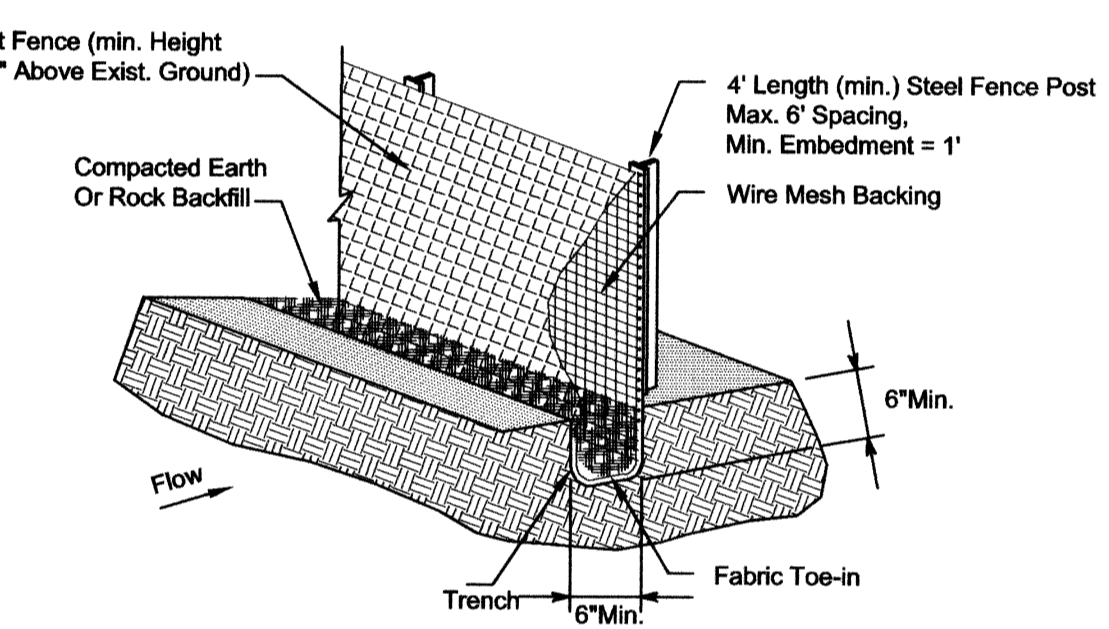

SILT FENCE
N.T.S.

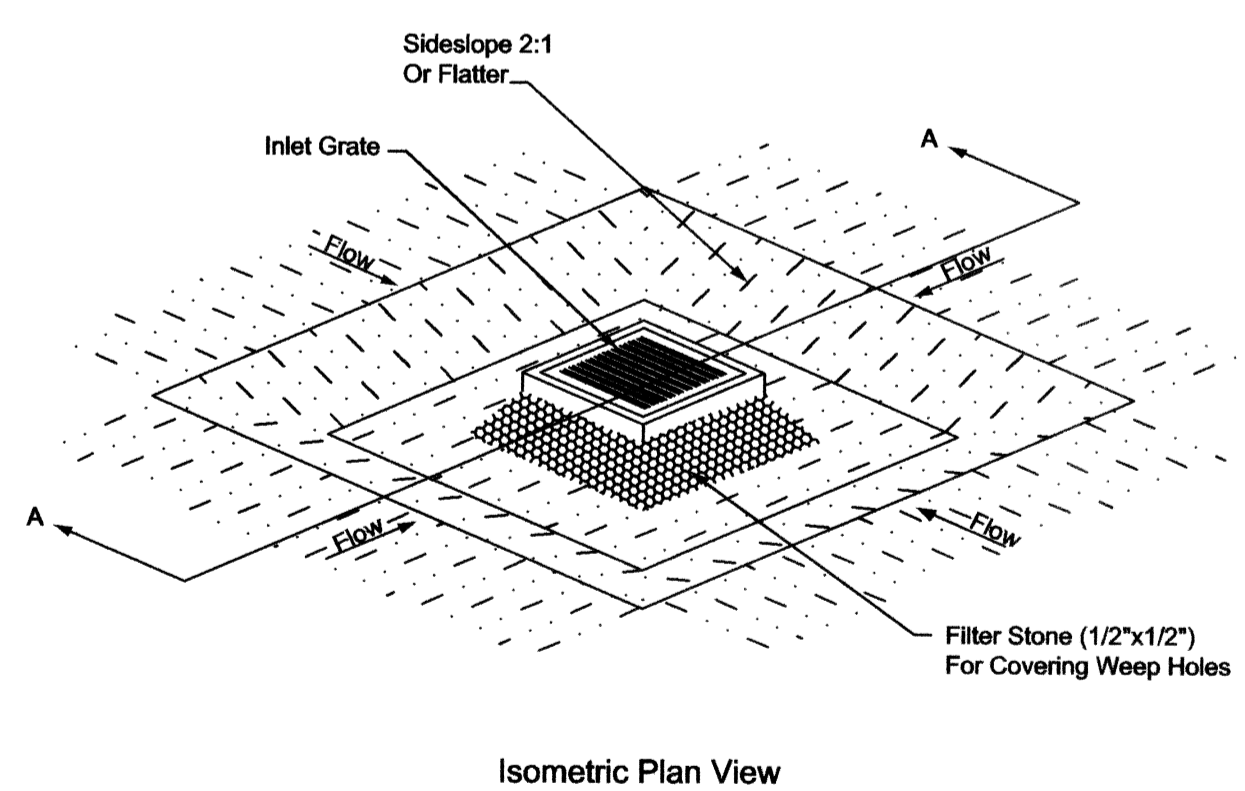

Isometric Plan View

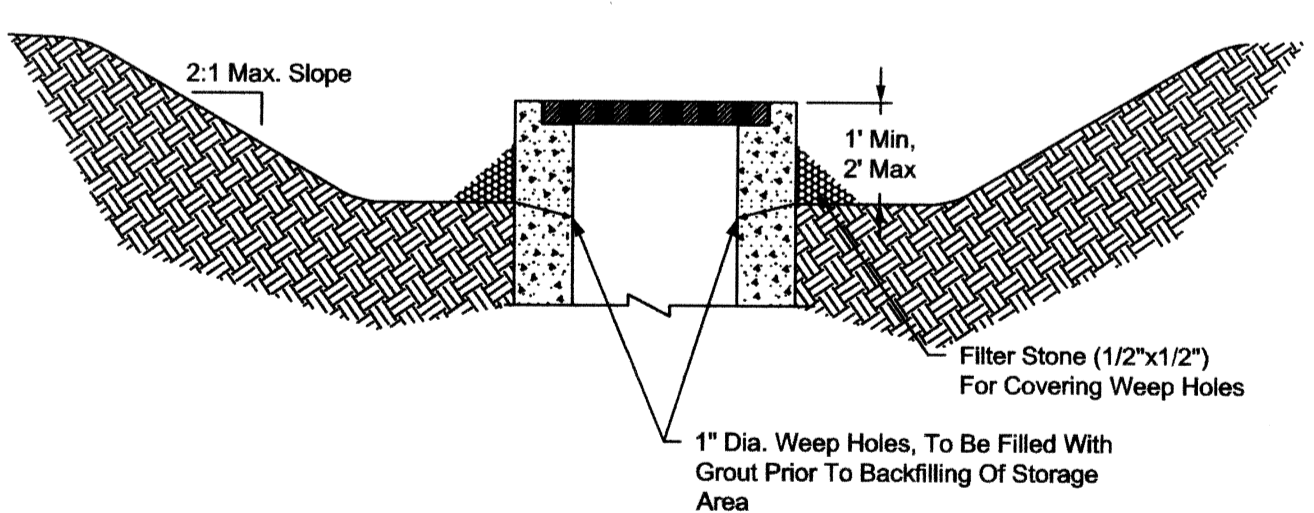

DROP INLET PROTECTION

BENCHMARK: NORTHWEST CORNER OF CURB INLET SOUTH SIDE OF W RUSK ST. INLET LOCATED NORTH OF THE NORTHWEST PROPERTY CORNER.
ELEV. 501.54

RECORD DRAWING
IMPROVEMENTS INDICATED ON THESE PLANS WHERE REVISED IN ACCORDANCE WITH THE ASBLUT SURVEY PERFORMED BY JAMES ANDERSON AND PROVIDED TO BENTLEY ENGINEERING, INC. ON 02/14/14.
DATE: FEBRUARY 19, 2014

X:\projects\2012\2012109\rosesite.dwg Mod Feb 19 10:42:48 2014