

DEVELOPMENT PLANS

FOR

CHANDLERS LANDING PHASE 15

CITY OF ROCKWALL, TEXAS

GENERAL NOTES

1. All street and alleys intersections and connections shall be built by the developer.
2. Excavation from streets to be deposited in low areas to allow proper drainage.
3. All existing ditches, except as noted on drainage plans, are to be filled to conform to surrounding terrain.
4. It will be the responsibility of the developer and/ or the contractor to protect and maintain to proper line and grade all public utilities, manholes, cleanouts, valve boxes, fire hydrants, etc. during the construction of this project, prior to and after placing permanent pavement.
5. All materials and workmanship shall conform to the City Standards and Specifications.

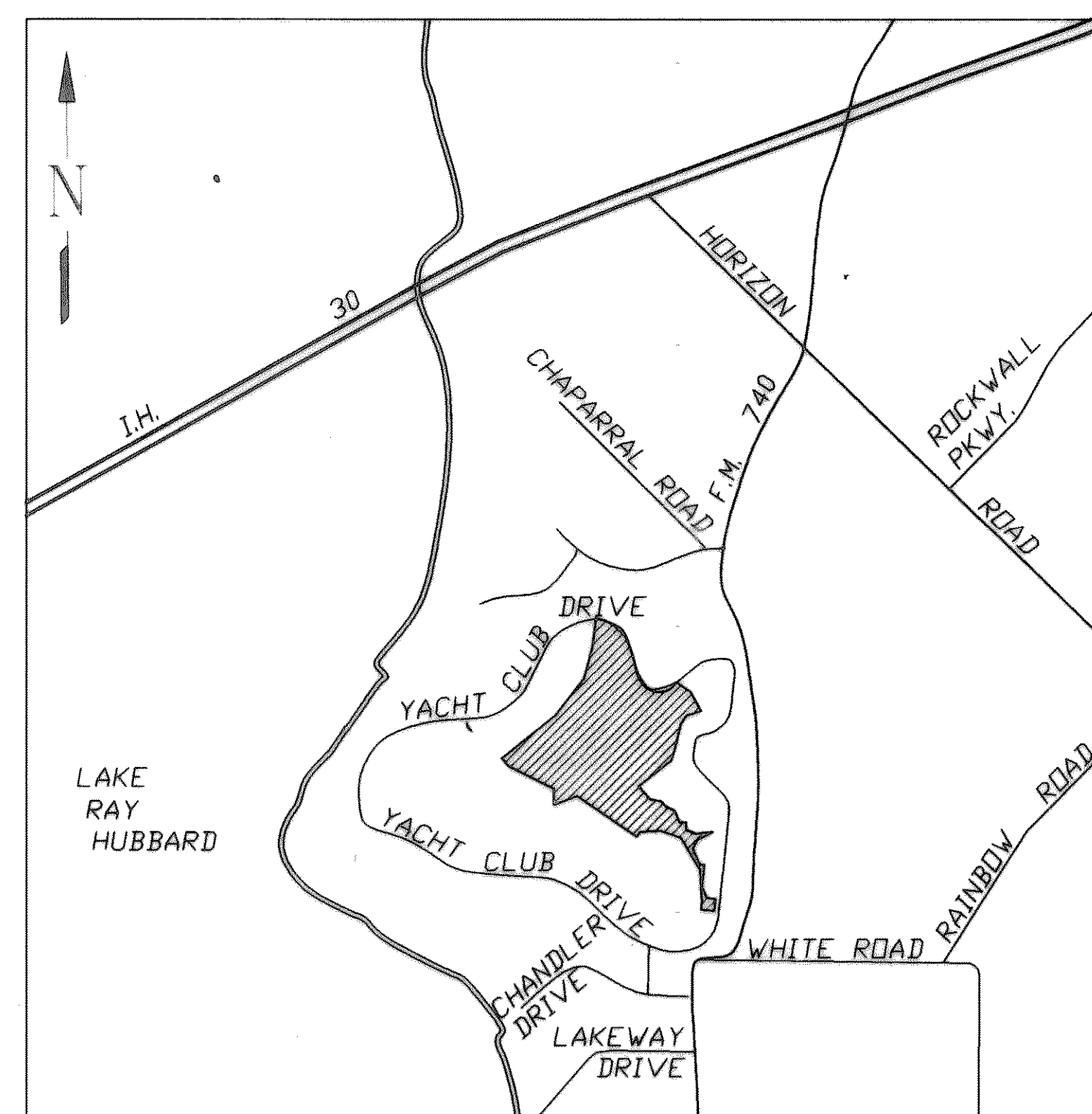

LOCATION MAP
NOT TO SCALE

INDEX

Sheet No.	Description
1-4	Final Plat
5-8	Paving Plans
9	Drainage Map
10-11	Storm Sewer
12	Water & Sewer Plan
13	Sanitary Sewer Profiles
14	Offsite Water Line
15	Erosion Control Plan
16-17	Lot Grading Plans

PREPARED FOR

WPC ACQUISITION, INC.

3960 Broadway Drive ~ Suite 125 ~ Garland, Texas 75043

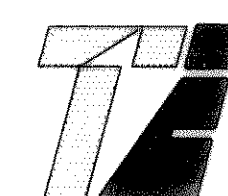

TIPTON ENGINEERING, INC.

6330 Belt Line Road ~ Suite C ~ Garland, Texas 75043 (214) 226-2967

AS BUILT PLANS

11/15/95

The alignment and grade were set on the ground for construction per the plans. The engineer did not verify alignment or grades after construction. We are not aware of any changes or revisions to these plans during construction except as noted.