

CONSTRUCTION PLANS

CHAMPIONS DRIVE

LIFT STATION IMPROVEMENTS

CITY OF ROCKWALL
 ROCKWALL COUNTY, TEXAS

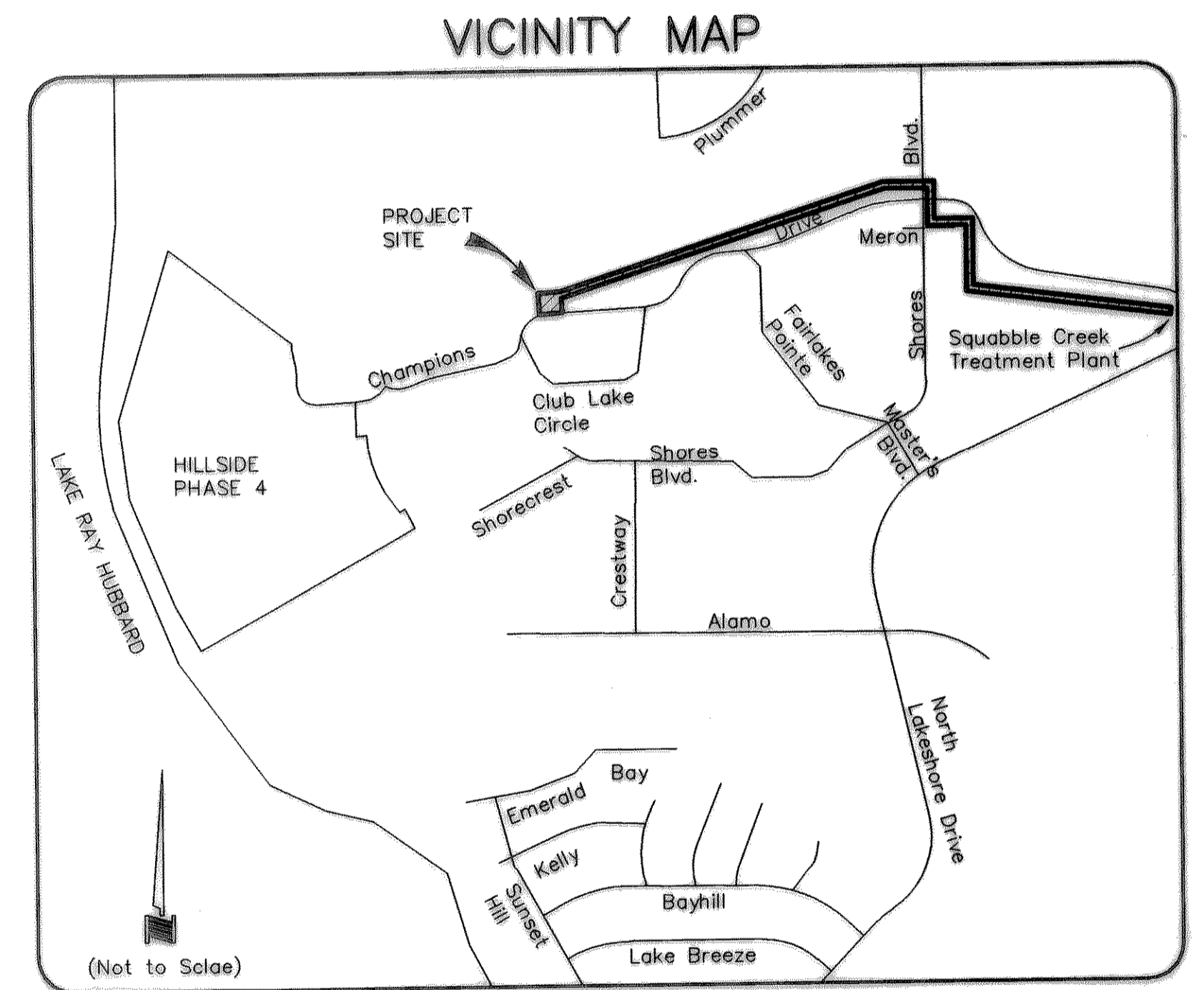

OWNER-DEVELOPER

DREES-STANDARD PACIFIC No. II, L.C.

5525 MACARTHUR BOULEVARD SUITE 580
 (972) 550-0426 IRVING, TEXAS 75038

INDEX	
PLATE	DESCRIPTION
	COVER SHEET
2-4	B" FORCE MAIN PLAN AND PROFILE
5	TECHNICAL SPECIFICATIONS
6	LIFT STATION PLAN
7	GRADING/ SITE PLAN

99-015

ENGINEER

DOWDEY, ANDERSON & ASSOCIATES, INC.

5225 VILLAGE CREEK DRIVE SUITE 200
 (972) 931-0694 PLANO, TEXAS 75093

CHAMPION ROAD-LIFT STATION 05-23-02
 RECORD DRAWINGS
 NOTE: THE INTENT OF THE OWNER AND ENGINEER WAS TO CONSTRUCT THE IMPROVEMENTS ACCORDING TO THESE PLANS AS APPROVED BY THE CITY OF ROCKWALL. THE LINES AND GRADES WERE SET ON THE GROUND FOR CONSTRUCTION ACCORDING TO SAID PLANS. WE ARE NOT AWARE OF ANY CHANGES OR REVISIONS TO THESE PLANS DURING CONSTRUCTION EXCEPT AS NOTED ON THE PLANS.

These construction plans were prepared under the responsible supervision of David J. Reid, Registered Professional Engineer No. 79858

David J. Reid
 5/21/01

