

- T = PAVEMENT THICKNESS
- NOTES:
- NO. 6 SMOOTH DOWEL BAR MAY BE USED IN 5 INCH AND 6 INCH PAVEMENT THICKNESS.
 - LONGITUDINAL BUTT CONSTRUCTION MAY BE UTILIZED IN PLACE OF LONGITUDINAL HINGED KEYWAY JOINT AT CONTRACTOR'S OPTION.
 - DOWEL BARS SHALL BE DRILLED INTO PAVEMENT HORIZONTALLY BY USE OF A MECHANICAL DRILL.
- DRILLING BY HAND IS NOT ACCEPTABLE, PUSHING DOWEL BARS INTO GREEN CONCRETE NOT ACCEPTABLE.
- LONGITUDINAL BUTT JOINT**

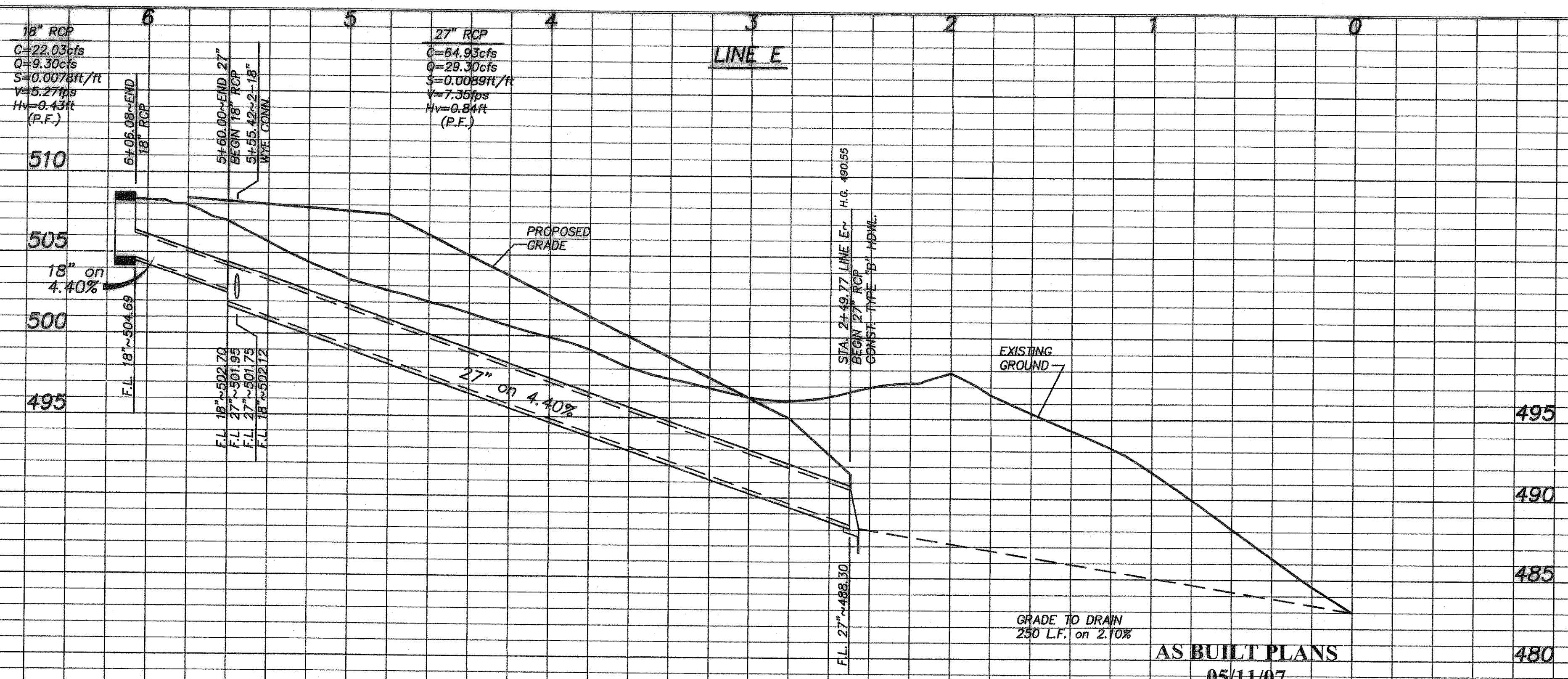

B.M. ~ "X" CUT ON EAST TOP OF CURBAT THE END OF HOLDEN DRIVE BEING 13.75' A DISTANCE OF 27' FROM THE CENTERLINE INTERSECTION OF HOLDEN DRIVE AND HUNT LANE. ELEVATION 508.49

B.M. ~ "X" CUT IN THE NORTH SIDE OF ALLEY IN THE MIDDLE OF LOT 17 OF HARLAN PARK PHASE 1. ELEVATION 513.23

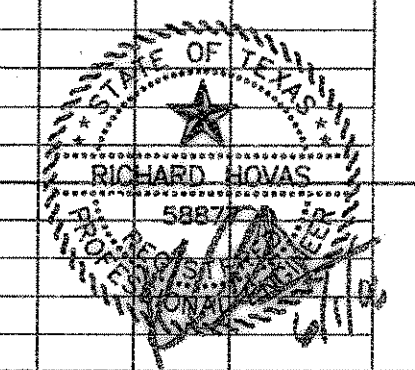

STORM SEWER PLAN
CASTLE RIDGE ESTATES PHASE 1
CITY OF ROCKWALL, TEXAS

TIPTON ENGINEERING, INC.
 ENGINEERING • SURVEYING • PLANNING
 6330 Broadway Blvd. • Suite C • Garland, Texas 75043 • (972) 226-2967

DESIGN	DRAWN	DATE	SCALE	NOTES	FILE	NO.
TE, Inc.	TE, Inc.	10-13-05	1"=40' H. 1"=5' V.	TE, Inc.	4802	13

ALL STORM SEWER TO BE R.C.P.

AS BUILT PLANS
 05/11/07
 The alignment and grade were set on the ground for construction per the plans. The engineer did not verify alignment or grades after construction. We are not aware of any changes or revisions to these plans during construction except as noted.