

**LEGEND**

- 617 Existing Contour Interval
- Proposed Silt Fence
- Proposed Drainage Flow Direction
- Proposed Inlet Protection
- Proposed Storm Pipe
- Proposed Curlex

**GENERAL NOTES FOR THE EROSION CONTROL PLAN**

1. All operators and/or contractors shall conform to the terms and conditions of the National Pollution Discharge Elimination Systems (NPDES) General Permit as published in the Federal Register, Vol. 63, No. 128, July 6, 1998, by the Environmental Protection Agency (EPA).
2. The Notice of Intent (NOI), as required by the General Permit, must be properly displayed on site at all times by each operator.
3. All releases of reportable quantities of hazardous substances shall be reported immediately to the facility operator and EPA.
4. The Contractor shall inspect the site at least once every fourteen days and within 24 hours of a 1/2-inch or greater rainfall event. The Contractor shall document the results. Copies of the inspection reports shall accompany the Contractor's monthly pay request. The Contractor shall not be paid until said reports are presented to the Owner/Owner's Representative. The Earthwork Contractor shall be responsible for inspection until the Utility Contractor begins his work. The Utility Contractor shall be responsible for inspections until the Paving Contractor begins his work. The Paving Contractor shall be responsible for inspections until the Earthwork Contractor begins lot benching operations. The Earthwork Contractor shall make remaining inspections until project is accepted by the City.
5. Modifications to the Storm Water Pollution Prevention Plan shall be implemented and be in-place within a seven calendar day period.
6. If any contractor sees a violation by an operator or another contractor, he shall notify the operator and contractor in violation.
7. Erosion control shall be installed prior to any grading.
8. Accumulated silt deposits shall be removed from silt fences and hay bale dikes when silt depth reaches six inches. Removal of silt deposits by the contractor shall be incidental to the performance of the contract and a separate bid item shall not be included.
9. The contractor shall add or delete erosion protection at the request and direction of the Operator or the City.
10. After installation of pavement, final lot benching and general cleanup, the grass groundcover shall be established in all street parkways, lots and all other disturbed areas. Materials shall be as specified in Item 2.15 and seeding shall be in accordance with Item 3.10 of the NCTCOG Standard Specifications.
11. It shall be the contractor's responsibility to control and limit silt and sediment leaving the site. Specifically, the contractor shall protect all public streets, alleys, streams, and storm drainage.
12. If any erosion control is removed for construction and/or access purposes, the contractor shall replace it at the end of the work day.
13. Prior to acceptance silt fence will be installed at back of curb and edge of alley on all lots.
14. 75%-80% of all disturbed area to have a minimum of 1" tall stand of grass prior to engineering acceptance.

**SITE AREA** 9.30 ACRES

**DISTURBED AREA** 8.35 ACRES

**NOTE:**  
ANCHORED SILT FENCE IS REQUIRED FOR FINAL ACCEPTANCE

ALL RESPONSIBILITY FOR ADEQUACY OF DESIGN REMAINS WITH THE DESIGN ENGINEER. THE CITY OF ROCKWALL, IN REVIEWING AND RELEASING PLANS FOR CONSTRUCTION, ASSUMES NO RESPONSIBILITY FOR ADEQUACY OR ACCURACY OF DESIGN.

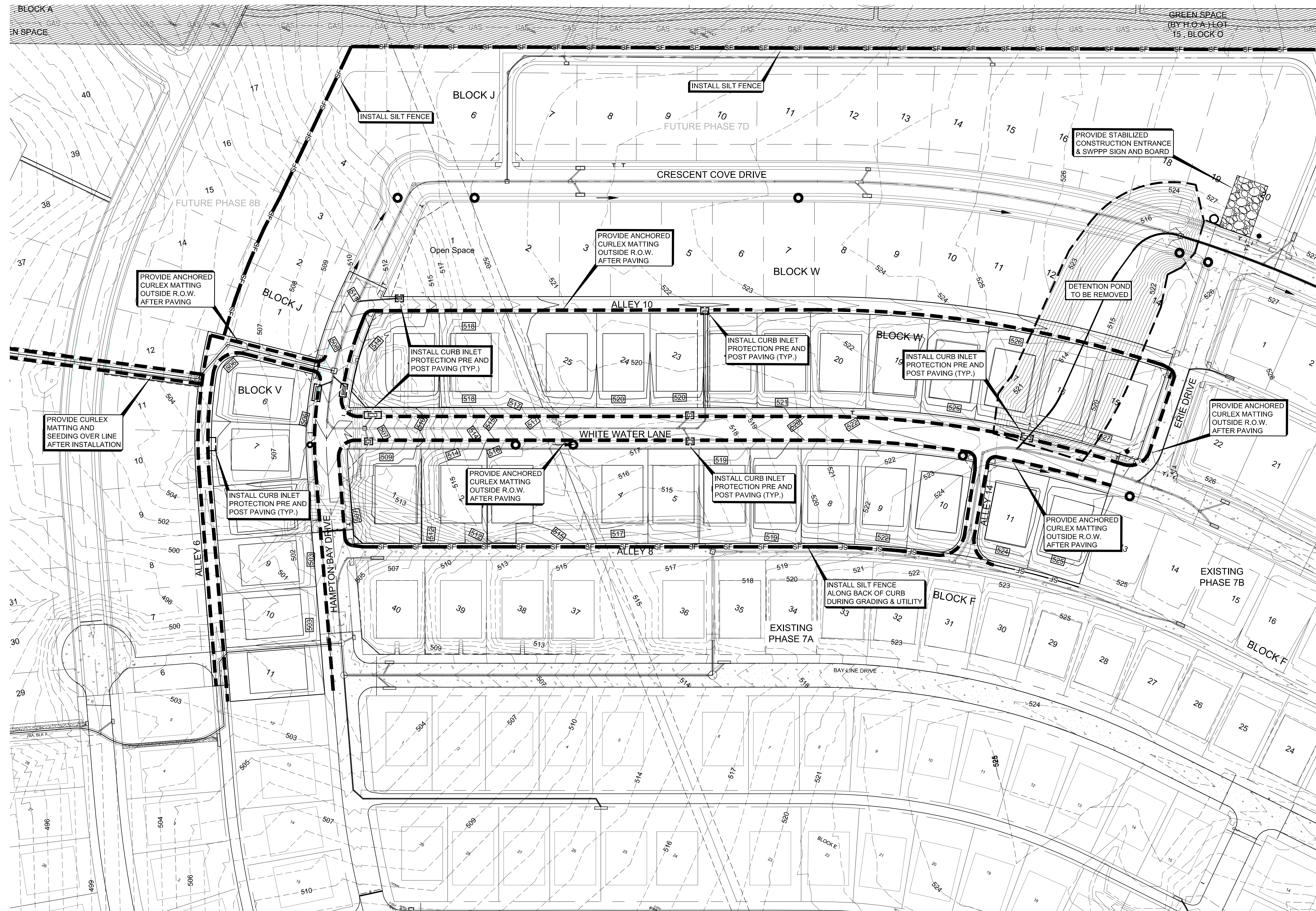

**BENCHMARKS**

1. X-chiseled in CL of Alley East of Morningstar Drive within the third lot north of Midnight Pass. Elevation = 513.26
2. PK Nail in CL of Caruth Lane & Alley intersection 150 feet +/- east of Morningstar Drive. Elevation = 491.68

NO.	REVISIONS DURING CONSTRUCTION	BY	DATE

**AS-BUILT DRAWING**  
TO THE BEST OF JBI PARTNERS, INC. KNOWLEDGE HEREBY STATES THIS PLAN IS AS-BUILT. THE INFORMATION PROVIDED IS BASED ON CONSTRUCTION STAKING AND PAD VERIFICATION AT THE SITE AND INFORMATION PROVIDED BY THE CONTRACTOR.

*[Signature]*  
NAME  
DATE 04-13-2015

The seal appearing on this document was authorized by DANIEL DEWEY, P.E. 93961. Alteration of a sealed document without proper notification to the responsible engineer is an offense under the Texas Engineering Practice Act.

*[Signature]*  
DATE 05-17-2013

**JBI PARTNERS**  
Texas Registered Engineering Firm F-438

16301 Quorum Drive  
Suite 200 B  
Addison, Texas 75001  
Main 972.248.7676  
Fax 972.248.1414  
www.jbipartners.com

<b>EROSION CONTROL PLAN</b>		PROJECT NO.
Caruth Lakes Phase 7C City of Rockwall, Texas		HOE132C
		SHEET NO.
		19

Drawing: H:\Projects\HOE132C.dwg\AS-BUILT\SHOEHOE132C-EC-PHYC-COPY.dwg Saved By: ychoi Save Time: 4/15/2015 11:31 AM Plotted By: ychoi Plot Date: 4/15/2015 11:38 AM