

- NOTE:
- PAVEMENT FOR STREETS SHALL CONSIST OF 6" 3600 P.S.I. REINFORCED CONCRETE AND 6" LIME-STABILIZED SUBGRADE WITH 6" PARABOLIC CROWN. PAVEMENT FOR ALLEYS SHALL CONSIST OF 4000 P.S.I. REINFORCED CONCRETE AND 6" LIME-STABILIZED SUBGRADE WITH 5" INVERT. TYPICAL ALLEY SECTION WILL BE 7'-5"-7".
  - CONTRACTOR TO RUN LIME SERIES BEFORE CONSTRUCTION.

NTMWD NOTE-1  
FRANCHISED UTILITIES ARE NOT PERMITTED IN  
NTMWD EASEMENT EXCEPT FOR CROSSINGS.

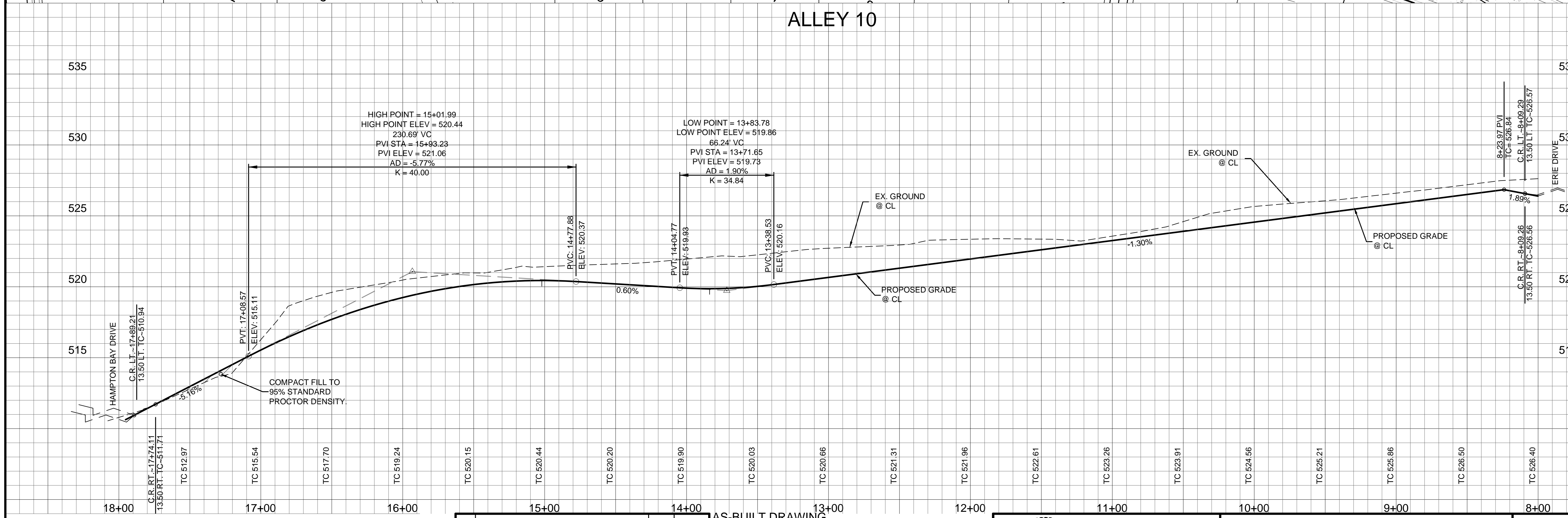

- BENCHMARKS**
- X-chiseled in CL of Alley East of Morningstar Drive within the third lot north of Midnight Pass. Elevation = 513.26
  - PK Nail in CL of Caruth Lane & Alley intersection 150 feet +/- east of Morningstar Drive. Elevation = 491.68

NO.	REVISIONS DURING CONSTRUCTION	BY	DATE

**AS-BUILT DRAWING**  
TO THE BEST OF JBI PARTNERS, INC. KNOWLEDGE HEREBY STATES THIS PLAN IS AS-BUILT. THE INFORMATION PROVIDED IS BASED ON CONSTRUCTION STAKING AND PAD VERIFICATION AT THE SITE AND INFORMATION PROVIDED BY THE CONTRACTOR.

*[Signature]*  
DATE: 04-13-2015

The seal appearing on this document was authorized by DANIEL DEWEY, P.E. 93961. Alteration of a sealed document without proper notification to the responsible engineer is an offense under the Texas Engineering Practice Act.

*[Signature]* 05-17-2013

**JBI PARTNERS**  
Texas Registered Engineering Firm F-438  
16301 Quorum Drive Suite 200 B Addison, Texas 75001 Main 972.248.7676 Fax 972.248.1414 www.jbipartners.com

**PAVING PLAN & PROFILE**  
**ALLEY 10**  
Caruth Lakes Phase 7C  
City of Rockwall, Texas

PROJECT NO.	HOE132C
SHEET NO.	6