

CONSTRUCTION PLANS FOR CARUTH LAKES PHASE 8A - 63 LOTS

LOTS 1-13 BLOCK Q, LOTS 1-15 BLOCK R, LOTS 1-15 BLOCK S, LOTS 1-11 BLOCK T, & LOTS 1-9 BLOCK U, CITY OF ROCKWALL ROCKWALL COUNTY, TEXAS

A. NORTH TEXAS MUNICIPAL WATER DISTRICT (NTMWD) 30-INCH WATER TRANSMISSION PIPELINE IS LOCATED WITHIN LIMITS OF CONSTRUCTION.

B. OPERATION OF HEAVY EARTHMOVING EQUIPMENT, COMPACTION EQUIPMENT OR HEAVY CONSTRUCTION EQUIPMENT, SUCH AS CONCRETE TRUCKS, SHALL BE RESTRICTED TO SPECIFIC CROSSING POINTS ACROSS NTMWD EASEMENTS, AS APPROVED BY THE NTMWD. THE CROSSINGS SHALL BE DESIGNATED AND VERIFIED TO PROVIDE A MINIMUM OF FIVE-FEET OF COVER.

C. TO ASSURE THAT PLACING OF SIGNIFICANT LOADS OVER THE NTMWD PIPELINE DOES NOT DAMAGE THE EXISTING PIPELINE, NO MATERIALS SHALL BE STOCKPILED ON THE NTMWD EASEMENT, WITHOUT AUTHORIZATION FROM THE NTMWD. IF THE CONTRACTOR DESIRES TO USE THE NTMWD'S EASEMENT FOR STOCKPILE OF MATERIALS, CONTACT NTMWD ENGINEERING AT (972) 442-5405 SO YOUR PLANS FOR USE OF NTMWD'S EASEMENT CAN BE REVIEWED.

D. A MINIMUM OF THREE FEET SEPARATION BETWEEN THE BOTTOM OF THE PAVEMENT AND TOP OF NTMWD PIPELINE IS REQUIRED. IN ADDITION, IF SEPARATION BETWEEN THE BOTTOM OF THE PAVEMENT AND THE TOP OF THE PIPELINE IS LESS THAN 3.5 FEET, A THICKENED PAVEMENT SECTION IS REQUIRED.

E. CROSSING OF THE NTMWD EASEMENT WITH OTHER UTILITIES, SUCH AS TV CABLE, PHONE, GAS AND ELECTRIC, SHALL BE COORDINATED WITH THE NTMWD TO AVOID DAMAGE TO THE NTMWD FACILITIES.

F. OUTDOOR LIGHTING, LANDSCAPING, SCREENING WALLS OR OTHER FACILITIES SHALL NOT BE INSTALLED IN NTMWD EASEMENTS WITHOUT WRITTEN APPROVAL OF THE NTMWD.

G. UNLESS OTHERWISE SHOWN OR REQUIRED A MINIMUM OF ONE-FOOT CLEARANCE SHALL BE PROVIDED FOR ALL UTILITIES CROSSING THE NTMWD PIPELINES.

H. "THE CONTRACTOR SHALL CONTACT NTMWD ENGINEERING AT (972) 442-5405 AT LEAST 48 HOURS PRIOR TO PERFORMING ANY WORK IN THE VICINITY OF THE NTMWD FACILITIES."

ALL CONTRACTORS TO USE STANDARD DETAILS PER CITY OF ROCKWALL AND NCTCOG THIRD EDITION.

Note:
To Contractor(s) The contractor(s) is (are) to provide "red lined" mark-ups of these plans to the engineer for any field changes made during construction after the project is complete. These mark-ups will be used to prepare "Construction Record Drawings".

OWNER \ DEVELOPER
D.R. HORTON - TEXAS, LTD.
4306 MILLER ROAD, SUITE A
ROWLETT, TEXAS 75088
(214) 607-4244

ENGINEER - SURVEYOR - LANDSCAPE ARCHITECT



16301 Quorum Drive
Suite 200 B
Addison, Texas 75240
Main 972.248.7676
Fax 972.248.1414
www.jbipartners.com
TEXAS REGISTERED ENGINEERING FIRM F-438

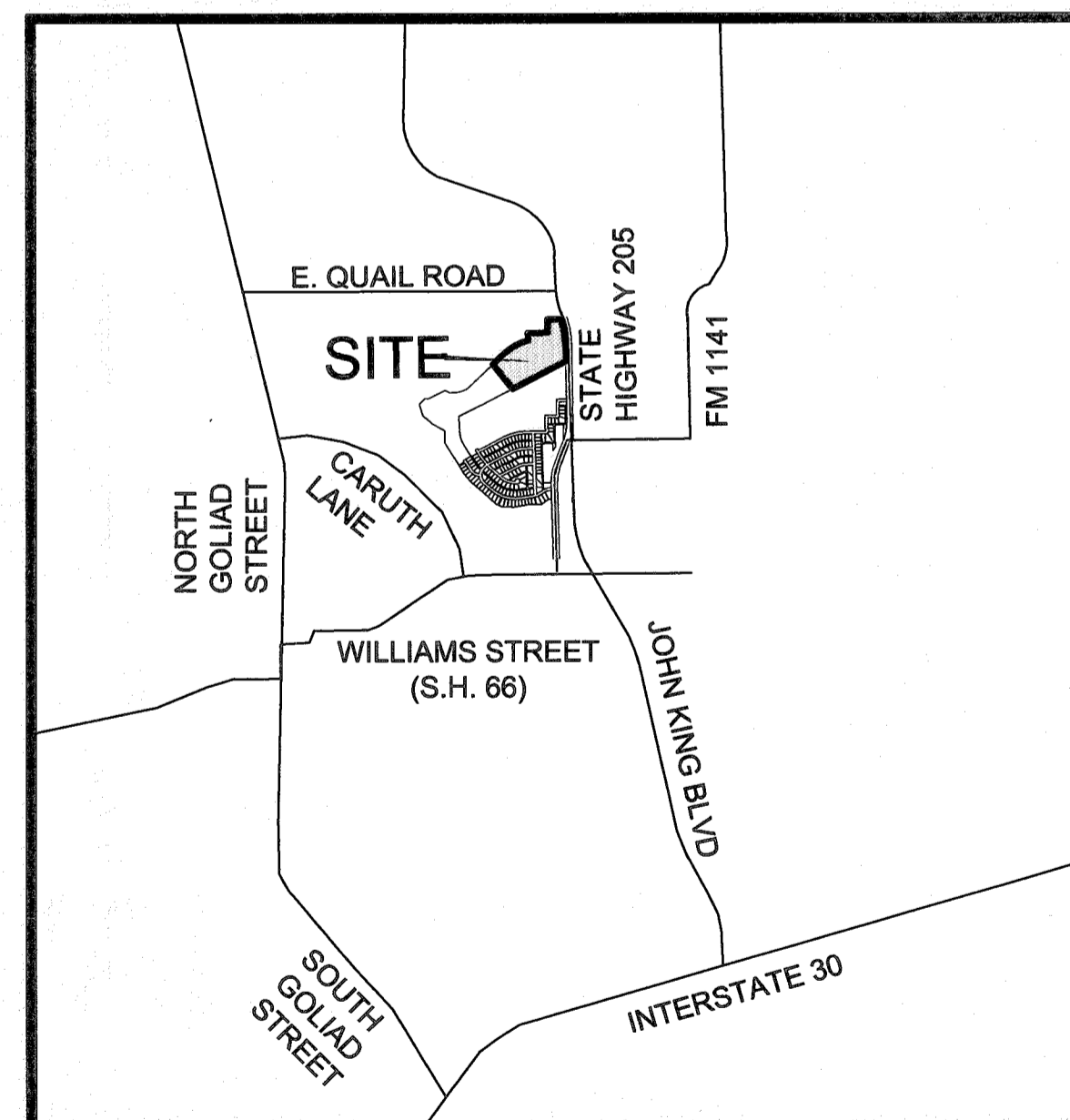

LOCATION MAP
MAPSCO PAGE 20C-D
ROCKWALL, TEXAS
N.T.S

INDEX

SHEET NO.	DESCRIPTION
1	COVER
2-3	FINAL PLAT
4	PAVING PLAN PHELPS LAKE DRIVE (1+00 - 12+00)
5	PAVING PLAN PHELPS LAKE DRIVE (12+00 - END)
6	PAVING PLAN CHESAPEKE DRIVE
7	PAVING PLAN DHAKA DRIVE
8	PAVING PLAN CALLING CIRCLE
9	PAVING PLAN LOCHNESS COURT
10	PAVING PLAN GREAT LAKES COURT
11	PAVING PLAN ALLEY 1
12	PAVING PLAN ALLEY 2
13	PAVING PLAN ALLEY 3 & ALLEY 4
14	GRADING PLAN
15	GRADING PLAN
15A	GRADING PLAN
16	DRAINAGE AREA MAP
17	DRAINAGE CALCULATIONS
18	STORM PLAN
19	STORM PROFILES - STM-A - STM-A5
20	STORM PROFILES - STM-A6, STM-A7, & STM-A8
21	WATER AND SANITARY SEWER PLAN
22	SANITARY SEWER PLAN LINE SS-1A (11+00 - 27+00)
23	SANITARY SEWER PLAN LINE SS-1A (1+00 - 11+00)
24	SANITARY SEWER PROFILES LINE SS-1A (1+00 - 23+50)
25	SANITARY SEWER PROFILES LINE SS-1A (23+50 - 38+69.92)
26	SANITARY SEWER PROFILES LINE SS-2A
27	SANITARY SEWER PROFILES LINES SS-3A & SS-4A
28	SIGNAGE AND LIGHTING PLAN
29	EROSION CONTROL PLAN
30	EROSION CONTROL DETAILS
CARUTH LAKES PHASE 8B GRADING PLANS	
12	GRADING PLAN
13	GRADING PLAN
14	GRADING PLAN
24	EROSION CONTROL PLAN

ALL RESPONSIBILITY FOR ADEQUACY OF DESIGN REMAINS WITH THE DESIGN ENGINEER. THE CITY OF ROCKWALL, IN REVIEWING AND RELEASING PLANS FOR CONSTRUCTION, ASSUMES NO RESPONSIBILITY FOR ADEQUACY OR ACCURACY OF DESIGN.

AS-BUILT DRAWINGS:

TO THE BEST OF JBI PARTNERS, INC.'S KNOWLEDGE, JBI HEREBY STATES THAT THIS PLAN IS AS-BUILT. THE INFORMATION PROVIDED IS BASED ON CONSTRUCTION STAKING AND PAD VERIFICATION AT THE SITE AND INFORMATION PROVIDED BY THE CONTRACTOR.

Daniel Dewey 4/11/2014
Name Date

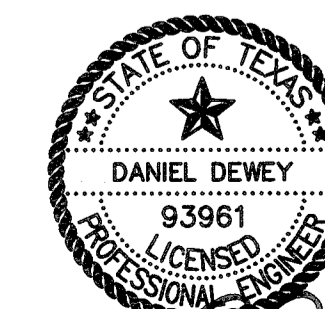

The seal appearing on this document was authorized by DANIEL DEWEY, P.E. 93961. Alteration of a sealed document without proper notification to the responsible engineer is an offense under the Texas Engineering Practice Act.

Signature 5-17-13