

BENCHMARK:
 3/4" CHISELED IN ϕ OF ALLEY EAST OF MORNINGSTAR DRIVE WITHIN 3RD LOT NORTH OF MIDNIGHT PASS. ELEV. 513.26

BENCHMARK:
 PK NAIL IN ϕ OF CARUTH LANE & ALLEY INTERSECTION 150'± EAST OF MORNINGSTAR DRIVE. ELEV. 491.68

2" TYPE "D" FINE GRADED SURFACE ITEM 334 PER TxDOT 1993 SPECIFICATIONS

4" TYPE "A" COURSE GRADED BASE COURSE ITEM 334 PER TxDOT 1993 SPECIFICATIONS

6" LIME STABILIZED SUBGRADE TO BE EXTENDED 2 FT. BEYOND EDGE OF PVMT.

ASPHALT PAVEMENT SECTION

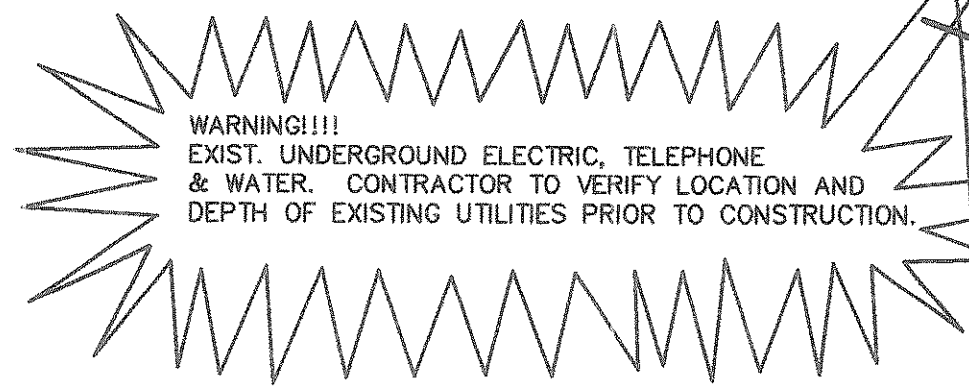

- LEGEND
- TPL TELEPHONE PEDESTAL
 - PP POWER POLE
 - TC TOP OF CURB
 - TP TOP OF PAVEMENT
 - CR CURB RETURN
 - FL FLOW LINE
 - 2 STREET STATION
 - 1 HANDICAP RAMP @ STREET & STREET INTERSECTION
 - 1 HANDICAP RAMP @ STREET & ALLEY INTERSECTION
 - OH OVERHEAD ELECTRIC LINE
 - FLOW ARROWS
 - 570 EXIST. CONTOURS
 - 570 PROP. CONTOURS

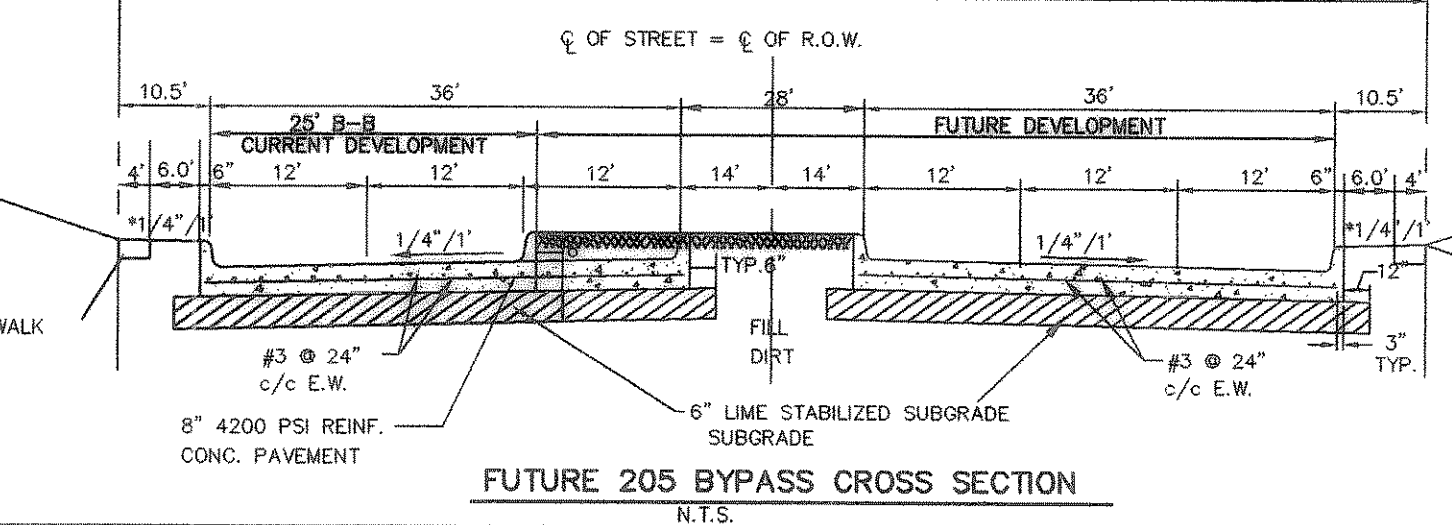

FUTURE 205 BYPASS CROSS SECTION

CAUTION !!!
UNDERGROUND UTILITIES

EXISTING UTILITIES AND UNDERGROUND FACILITIES INDICATED ON THESE PLANS HAVE BEEN LOCATED FROM REFERENCE INFORMATION SUPPLIED BY VARIOUS OWNERS OF THE FACILITIES. THE ENGINEER DOES NOT ACCEPT THE RESPONSIBILITY FOR THE UTILITY LOCATIONS SHOWN. IT SHALL BE THE RESPONSIBILITY OF THE CONTRACTOR TO VERIFY BOTH HORIZONTALLY AND VERTICALLY THE LOCATION OF ALL EXISTING UTILITIES AND UNDERGROUND FACILITIES PRIOR TO CONSTRUCTION. TO TAKE NECESSARY PRECAUTIONS IN ORDER TO PROTECT ALL FACILITIES ENCOUNTERED, AND TO NOTIFY THE ENGINEER PROMPTLY OF ALL CONFLICTS OF THE WORK WITH EXISTING FACILITIES. THE CONTRACTOR SHALL PRESERVE AND PROTECT ALL EXISTING UTILITIES FROM DAMAGE DURING CONSTRUCTION. ANY DAMAGE TO EXISTING UTILITIES SHALL BE REPAIRED BY THE CONTRACTOR AT HIS EXPENSE. CONTACT ALL POSSIBLE UTILITY AND UNDERGROUND FACILITY OWNERS.

NOTE:
 INSTALL PAVEMENT MARKERS TYPE II-A-A. AS PER DETAIL SHOWN ON SHEET NO. 16 ON THE STRIPES & ON THE CENTER OF 205 BYPASS

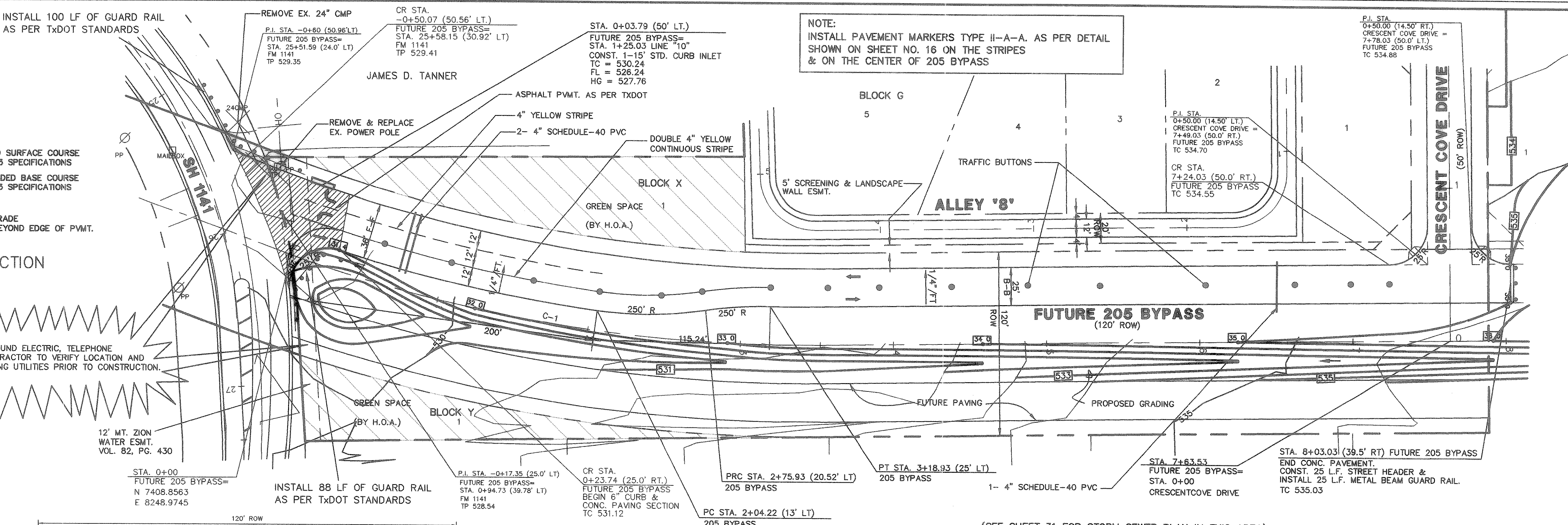

(SEE SHEET 31 FOR STORM SEWER PLAN IN THIS AREA)

CURVE REPORT

CURVE	RADIUS	DELTA	TANGENT	LENGTH	CHORD	BEARING
C-1	995.00'	201°7'04"	177.99'	352.25'	350.42'	S09°18'11"W

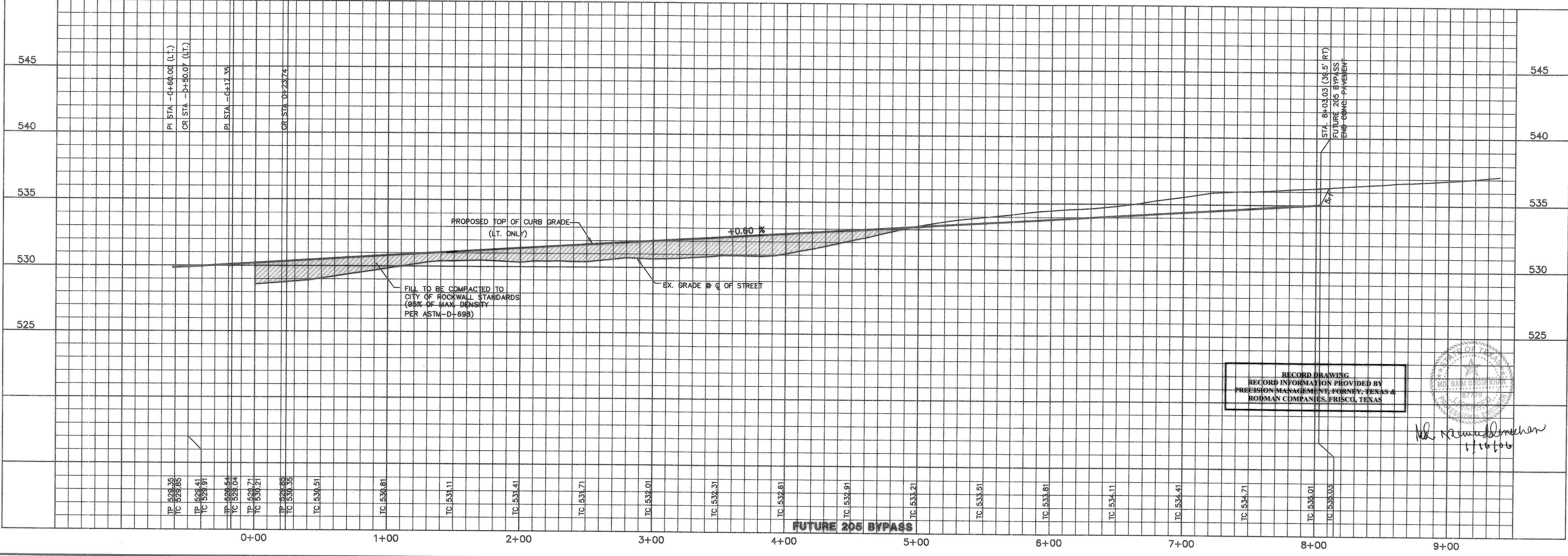
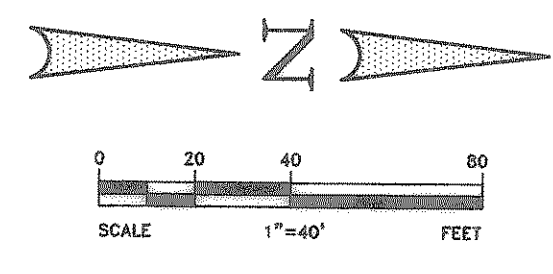

RECORD DRAWING
 RECORD INFORMATION PROVIDED BY
 PRECISION ENGINEERING FOR TEXAS &
 ROBBAN COMPANIES, FRISCO, TEXAS

Handwritten signature and date: 1/16/06

THESE CONSTRUCTION PLANS WERE PREPARED UNDER THE RESPONSIBLE SUPERVISION OF M.D. NAIM UDDIN KHAN, REGISTERED PROFESSIONAL ENGINEER NO. 87776

Winkelman & Associates, Inc.
 CONSULTING CIVIL ENGINEERS & SURVEYORS
 6025 WILLOW PARK DRIVE, SUITE 100
 DALLAS, TEXAS 75248
 (972) 486-2099 FAX (972) 486-2098

THE SEAL APPEARING ON THIS DOCUMENT WAS AUTHORIZED BY M.D. NAIM UDDIN KHAN, # 87776

M.B. JONES SURVEY, ABSTRACT NO. 122
 CITY OF ROCKWALL
 ROCKWALL COUNTY, TEXAS
 LUMBERMEN'S INVESTMENT CORPORATION
 5495 BELTLINE ROAD #225
 DALLAS, TEXAS 75240

PHASE 0A
 Scale: H: 1"=40' Date: 4/12/04
 Designed By: MS
 Drawn By: MS
 Checked By: NK
 File: 1465416ANP2.dwg View:
 Project No.: 14654.01

RECORD DRAWING
 SHEET
 15
 OF
 57