

LEGEND

TC	TOP OF CURB
TP	TOP OF PAVEMENT
CR	CURB RETURN
FL	FLOW LINE
2	STREET STATION
1	HANDICAP RAMP @ STREET & STREET INTERSECTION
1	HANDICAP RAMP @ STREET & ALLEY INTERSECTION
→	FLOW ARROWS

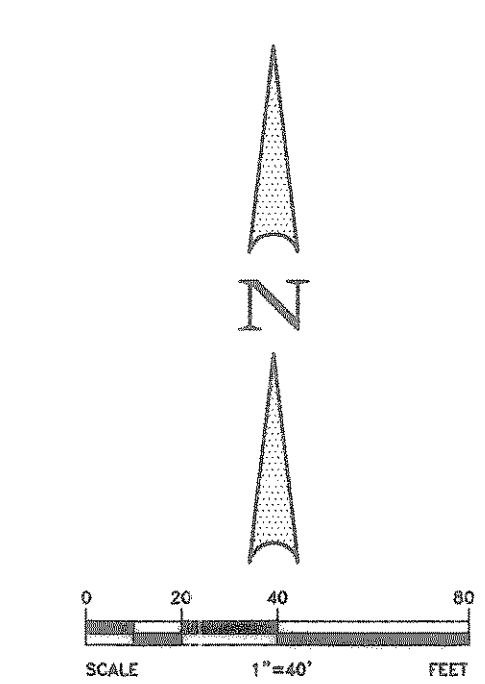

- NOTE:**
- PAVEMENT FOR STREETS SHALL CONSIST OF 6" 3600 P.S.I. REINFORCED CONCRETE AND 6" LIME-STABILIZED SUBGRADE WITH 6" PARABOLIC CROWN.
 - PAVEMENT FOR ALLEYS SHALL CONSIST OF 4000 P.S.I. REINFORCED CONCRETE AND 6" LIME-STABILIZED SUBGRADE WITH 5" INVERT. TYPICAL ALLEY SECTION WILL BE 7'-5"-7".
 - CONTRACTOR TO RUN LINE SERIES BEFORE CONSTRUCTION.

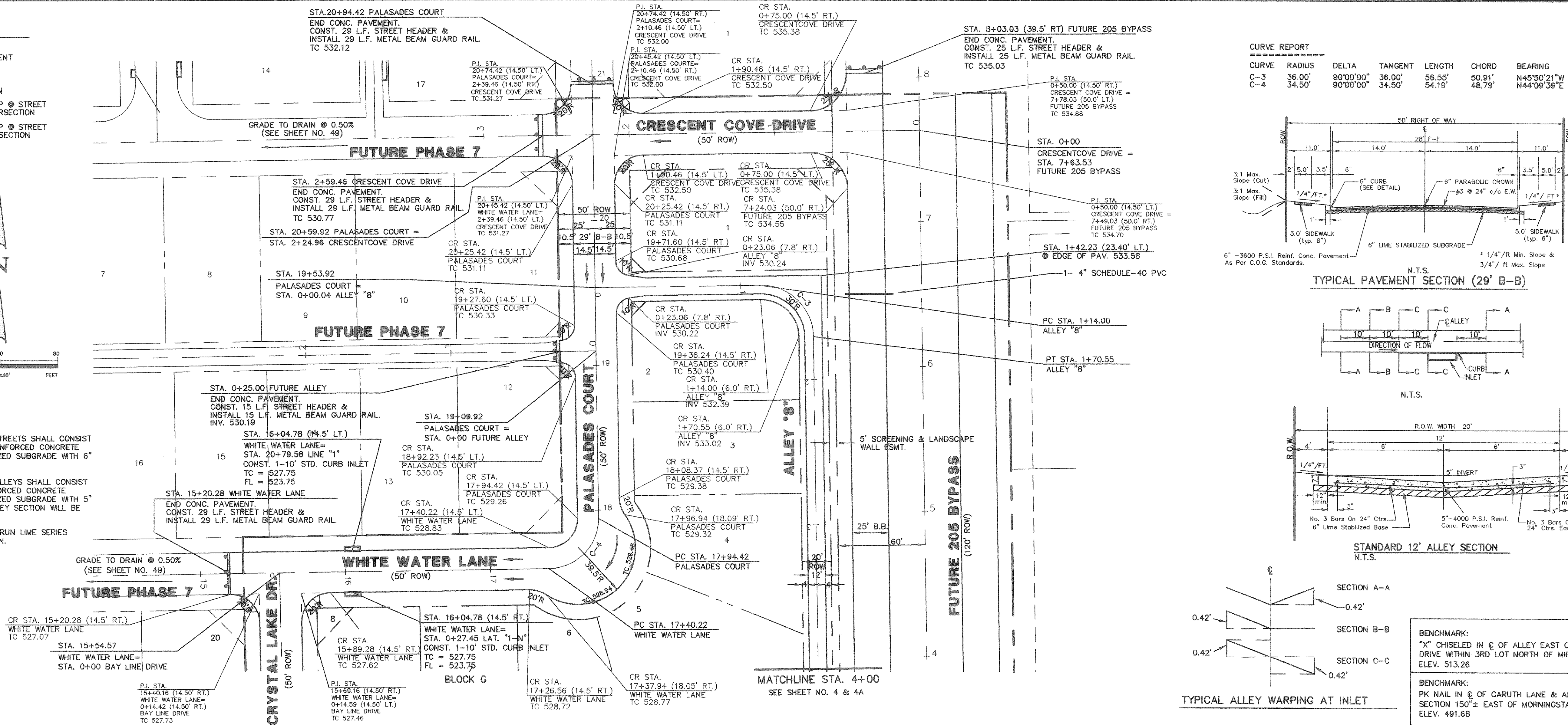

CURVE REPORT

CURVE	RADIUS	DELTA	TANGENT	LENGTH	CHORD	BEARING
C-3	36.00'	90°00'00"	36.00'	56.55'	50.91'	N45°50'21"W
C-4	34.50'	90°00'00"	34.50'	54.19'	48.79'	N44°09'39"E

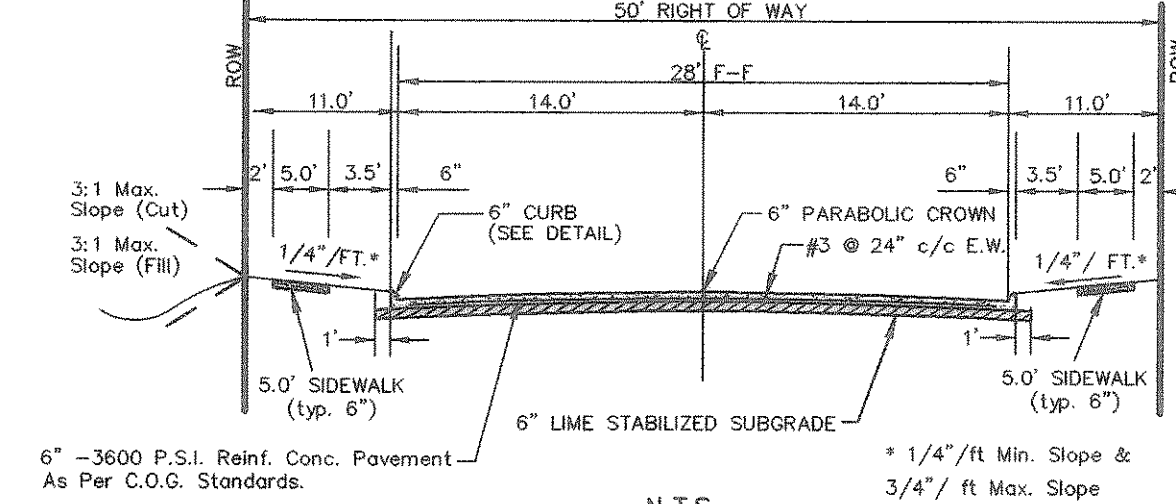

TYPICAL PAVEMENT SECTION (29' B-B)

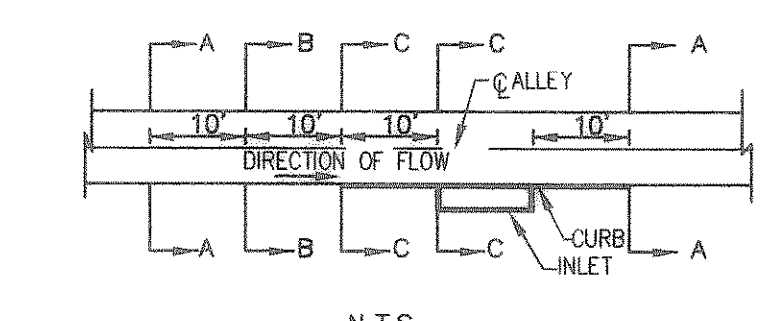

TYPICAL ALLEY SECTION (29' B-B)

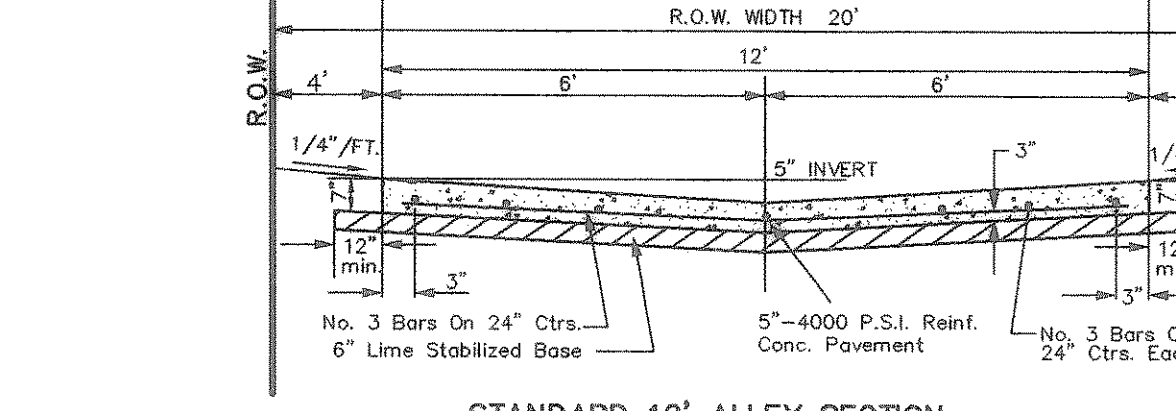

STANDARD 12' ALLEY SECTION

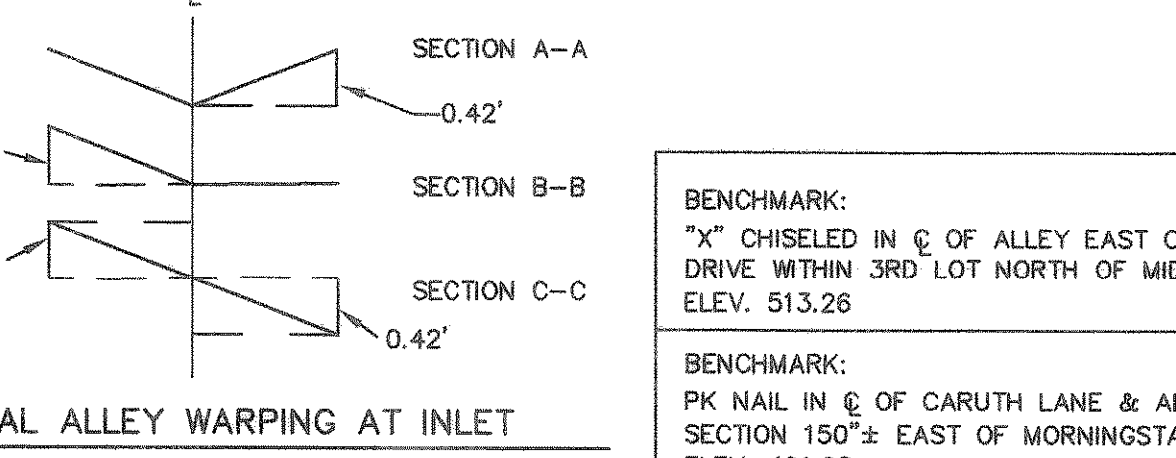

TYPICAL ALLEY WARPING AT INLET

BENCHMARK:
"X" CHISELED IN C OF ALLEY EAST OF MORNINGSTAR DRIVE WITHIN 3RD LOT NORTH OF MIDNIGHT PASS. ELEV. 513.26

BENCHMARK:
PK NAIL IN C OF CARUTH LANE & ALLEY INTERSECTION 150'± EAST OF MORNINGSTAR DRIVE. ELEV. 491.68

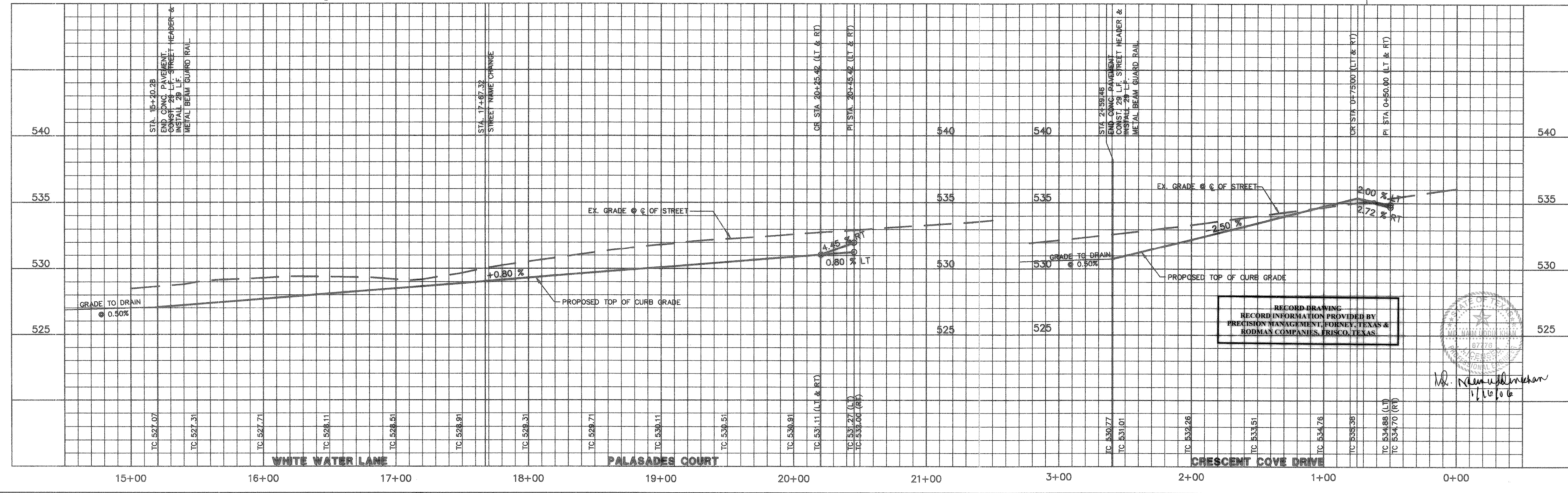

RECORD DRAWING
RECORD INFORMATION PROVIDED BY
PRECISION MANAGEMENT, FORTNEY, TEXAS &
RODMAN COMPANIES, BRISCO, TEXAS

M. B. Jones
1/16/06

NO.	DATE	REVISION	APPROVAL

THESE CONSTRUCTION PLANS WERE PREPARED UNDER THE RESPONSIBLE SUPERVISION OF M.D. NAIM UDDIN KHAN, REGISTERED PROFESSIONAL ENGINEER NO. 87776

M. B. Jones 1/12/04

THE SEAL APPEARING ON THIS DOCUMENT WAS AUTHORIZED BY M.D. NAIM UDDIN KHAN, # 87776

PHASE 6A

Scale: 1" = 40' Date: 12/2/03
 Designed By: RB
 Drawn By: MS
 Checked By: NK
 File: 146546A(10).dwg View:
 Project No.: 14654.01

Winkelman & Associates, Inc.
 CONSULTING CIVIL ENGINEERS & SURVEYORS
 6710 INDEPEND MAZE DRIVE, SUITE 100
 DALLAS, TEXAS 75248
 (972) 480-7288
 (972) 480-7289 FAX

M.B. JONES SURVEY, ABSTRACT NO. 122
 CITY OF ROCKWALL, TEXAS
 ROCKWALL COUNTY, TEXAS
 LUMBERMEN'S INVESTMENT CORPORATION
 5495 BELTLINE ROAD #225
 DALLAS, TEXAS 75240

PAVING PLAN & PROFILE (PHASE 6A)
WHITE WATER LANE STA 15+20.26 TO 17+67.32
PALSADES COURT STA 17+67.32 TO 20+94.42
CRESCENT COVE DRIVE STA 0+00 TO 2+59.46
PAV. PLAN ALLEY '8' STA. 0+00 TO 4+00

SHEET 14 OF 57