

BENCHMARK:
PK NAIL IN E OF CARUTH LANE & ALLEY INTER-
SECTION 150'± EAST OF MORNINGSTAR DRIVE.
ELEV. 491.68

BENCHMARK:
"X" CHISELED IN E OF ALLEY EAST OF MORNINGSTAR
DRIVE WITHIN 3RD LOT NORTH OF MIDNIGHT PASS.
ELEV. 513.26

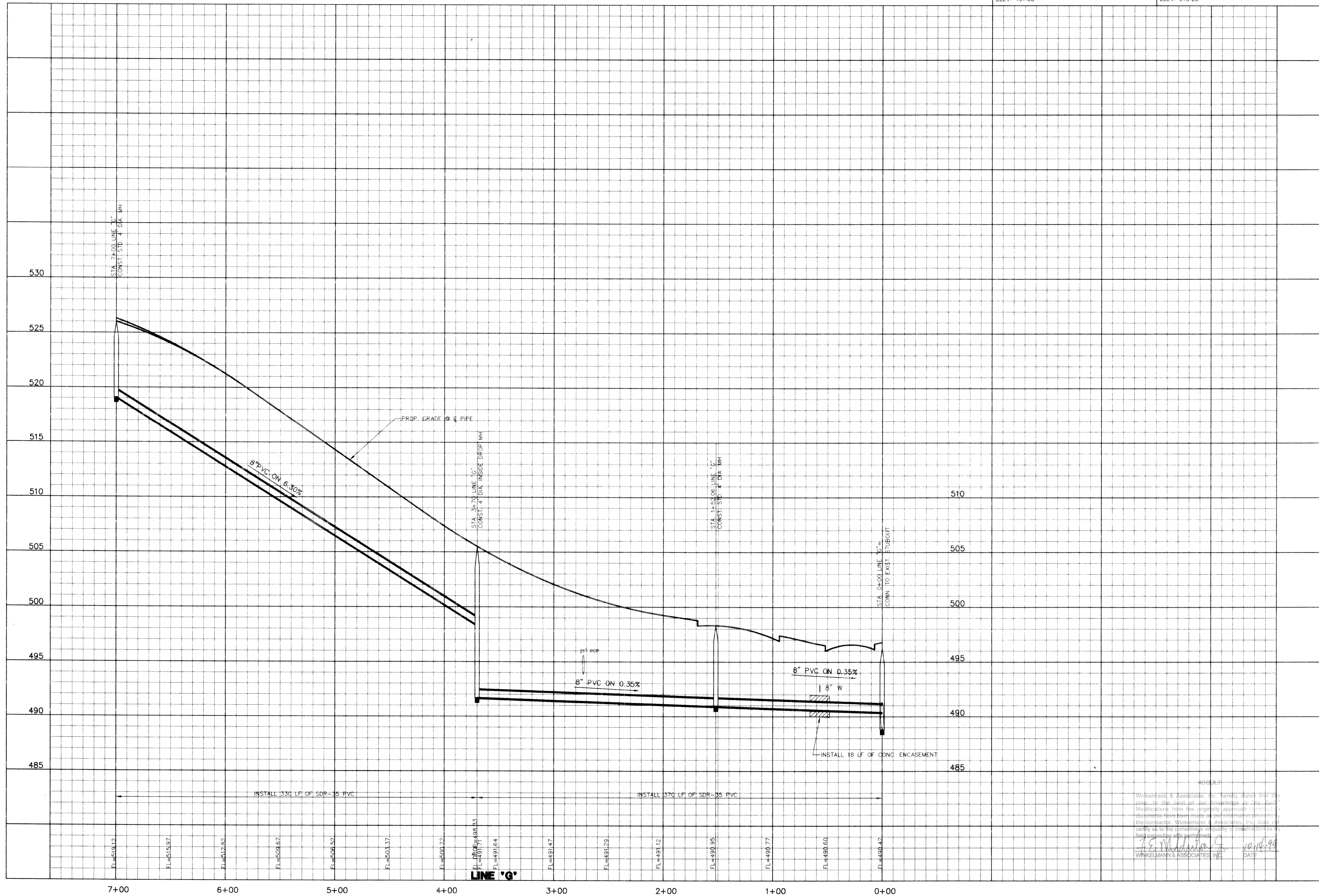

CARUTH LAKE PHASE FIVE
S.S. MCCURRY SURVEY, ABSTRACT NO. 146
M.B. JONES, CITY OF ROCKWALL,
ROCKWALL COUNTY, TEXAS
LUBBERMANS INVESTMENT CORPORATION
5409 BELT LINE ROAD, SUITE 225
DALLAS, TEXAS 75240

**SANITARY SEWER PROFILES
LINE 'G'**

Scale : 1" = 20' Date : 5/28/98
Designed By : R.B./N.K.
Drawn By : N.K.
Checked By : K.G.
File : 14633550.DWG
Project No. : 14633.01

ASB:BT
Winkelmann & Associates, Inc. hereby states that the
plan to the best of our knowledge is the final
Modification from the originally approved contract.
No changes have been made as per information provided
by the contractor. Winkelmann & Associates, Inc. does not
certify as to the correctness or quality of construction or
field inspection work performed.
R.B. Winkelmann 10/16/98
WINKELMANN & ASSOCIATES, INC. DATE