

ASBUILT

Winkelmann & Associates, Inc. hereby states that this plan, to the best of our knowledge is "As Built". Modifications from the originally approved construction documents have been made as per information provided by the contractor. Winkelmann & Associates, Inc. does not certify as to the condition or quality of construction as no field inspection was performed.

J. E. Winkelmann
WINKELMANN & ASSOCIATES, INC.

7.30.18
DATE

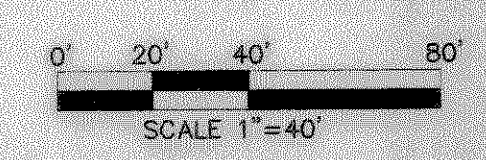

BENCHMARK: PK NAIL IN C OF CARUTH LANE & ALLEY INTERSECTION 150'± EAST OF MORNINGSTAR DRIVE. ELEV. 491.68

BENCHMARK: "X" CHISELED IN C OF ALLEY EAST OF MORNINGSTAR DRIVE WITHIN 3RD LOT NORTH OF MIDNIGHT PASS. ELEV. 513.26

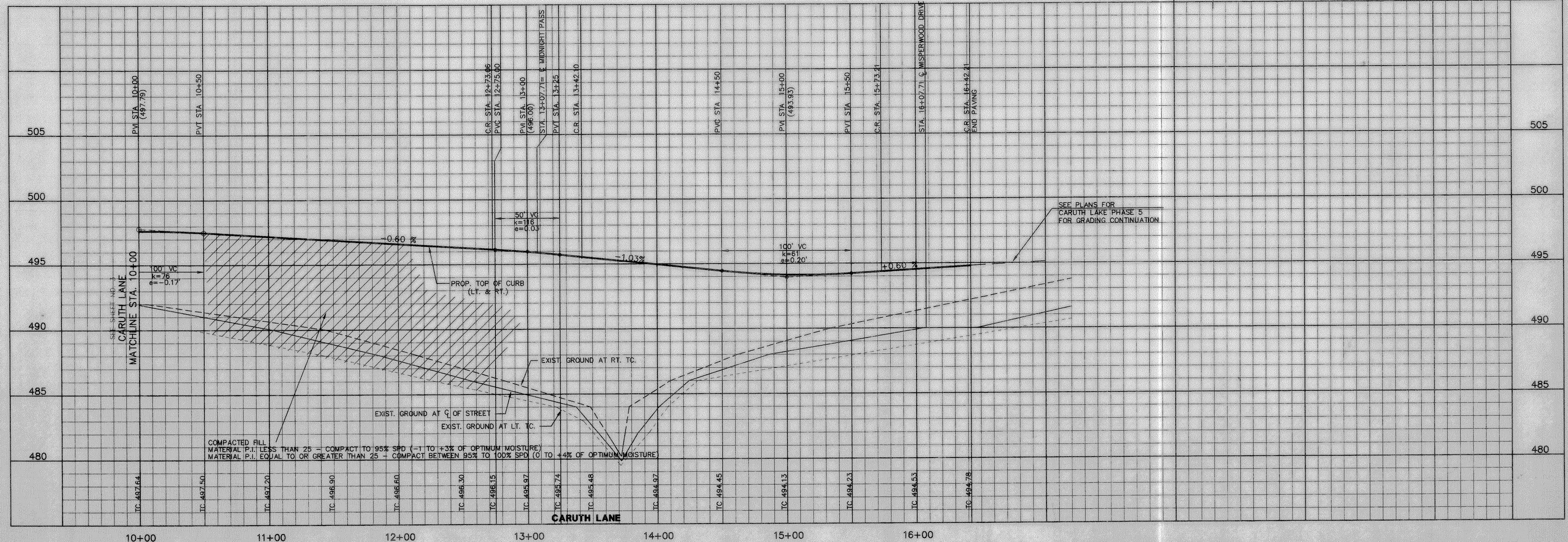

Winkelmann & Associates, Inc.
CONSULTING CIVIL ENGINEERS & SURVEYORS
12700 Morningstar Road, Suite 200
Dallas, Texas 75230
(214) 442-7099 FAX



CARUTH LAKE PHASE FOUR
S.S. MCCURRY SURVEY, ABSTRACT NO. 146
M.B. JONES CIVIL ENGINEER, CONTRACT NO. 122
ROCKWALL COUNTY, TEXAS

LUMBERMEN'S INVESTMENT CORPORATION
5495 BELL LANE, SUITE 225
DALLAS, TEXAS 75240

PAVING PLAN & PROFILE

CARUTH LANE STA. 10+00 TO STA. 16+42.21

Scale: H: 1"=40' Date: 5-9-97
Designed By: RB
Drawn By: MK
Checked By: J.E.M.
File: 14693F42.DWG
Project No.: 14693.01(90)

SHEET
4
OF
29