

± CURVE DATA

CURVE	RADIUS	DELTA	TANGENT	LENGTH	CHORD	BEARING
C-1	200.00'	22°01'19"	38.92'	76.87'	76.40'	S35°10'48"E
C-2	300.00'	25°22'58"	67.56'	132.90'	131.82'	N74°17'31"E

Winkelmann & Associates, Inc. hereby states that this plan, to the best of our knowledge is "As Built." Modifications from the originally approved construction documents have been made as per information provided by the contractor. Winkelmann & Associates, Inc. does not certify as to the correctness or quality of construction as no field inspection was performed.

*J. M. Winkelmann*  
 WINKELMANN & ASSOCIATES, INC.  
 DATE: 1-2-88  
 SCALE 1"=40'

BENCHMARK:  
 PK NAIL IN E OF CARUTH LANE & ALLEY INTERSECTION 150' ± EAST OF MORNINGSTAR DRIVE. ELEV. 491.68

BENCHMARK:  
 "X" CHISELED IN E OF ALLEY EAST OF MORNINGSTAR DRIVE WITHIN 3RD LOT NORTH OF MIDNIGHT PASS. ELEV. 513.26

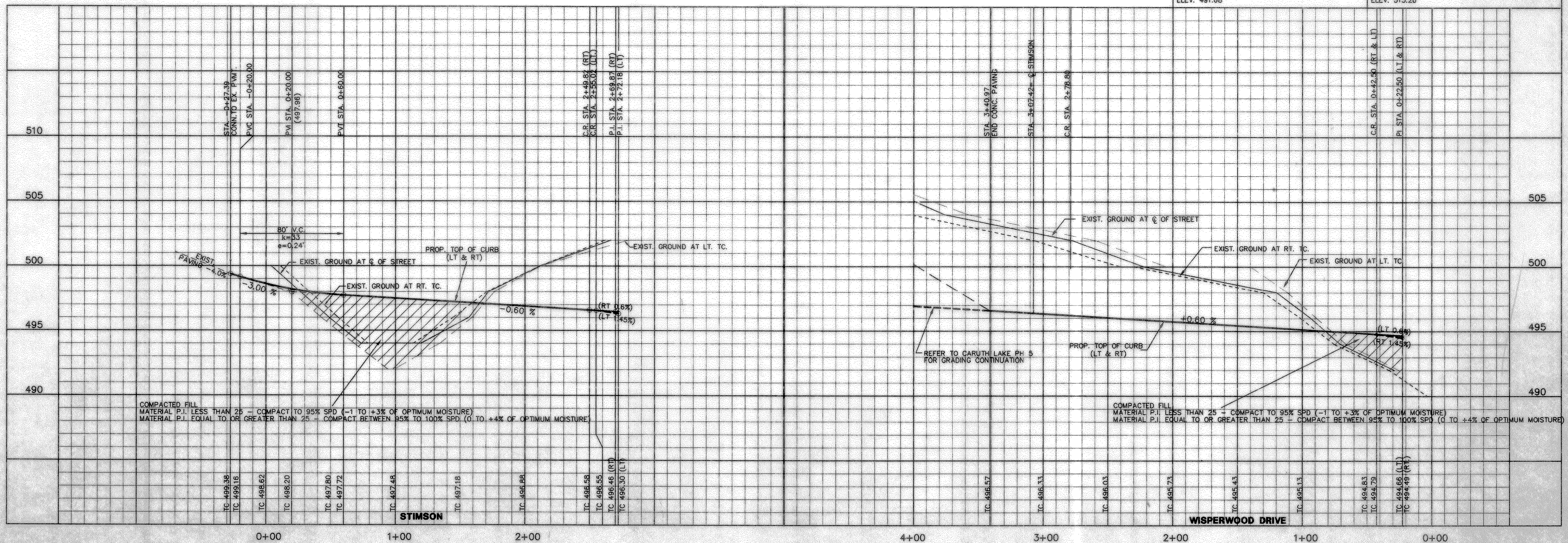

NO.	DATE	REVISION	APPROV.

**Winkelmann & Associates, Inc.**  
 CONSULTING CIVIL ENGINEERS & SURVEYORS  
 13800 Wilshire Road, Suite 200  
 Dallas, Texas 75230  
 (214) 462-2099 FAX

CARUTH LAKE PHASE FOUR, NO. 148  
 S.S. MCGONIGLES SURVEY, ABSTRACT NO. 122  
 ROCKWALL COUNTY, TEXAS  
 LUMBERMEYERS INVESTMENT CORPORATION  
 5465 BELLEME ROAD, SUITE 220  
 DALLAS, TEXAS 75240

**PAVING PLAN & PROFILE**  
**STIMSON STA. 0+00 TO STA. 2+85.23**  
**WISPERWOOD DRIVE STA. 0+00 TO STA. 3+45.27**

Scale: 1"=40'  
 Date: 5-9-97  
 Designed By: RB  
 Drawn By: MK  
 Checked By: F.E.M.  
 File: 14633P48.DWG  
 Project No.: 14633.01(20)

**SHEET**  
**11**  
**29**