

I:\PROJECTS\962287010\962287010.dwg - 10/10/96 - 10/10/96 - 10/10/96 - 10/10/96 - 10/10/96 - 10/10/96 - 10/10/96 - 10/10/96 - 10/10/96 - 10/10/96
 USER: JDR - 10/10/96 - 10/10/96 - 10/10/96 - 10/10/96 - 10/10/96 - 10/10/96 - 10/10/96 - 10/10/96 - 10/10/96 - 10/10/96
 TEL: 972.968.1111 FAX: 972.968.1111

MATCH LINE B

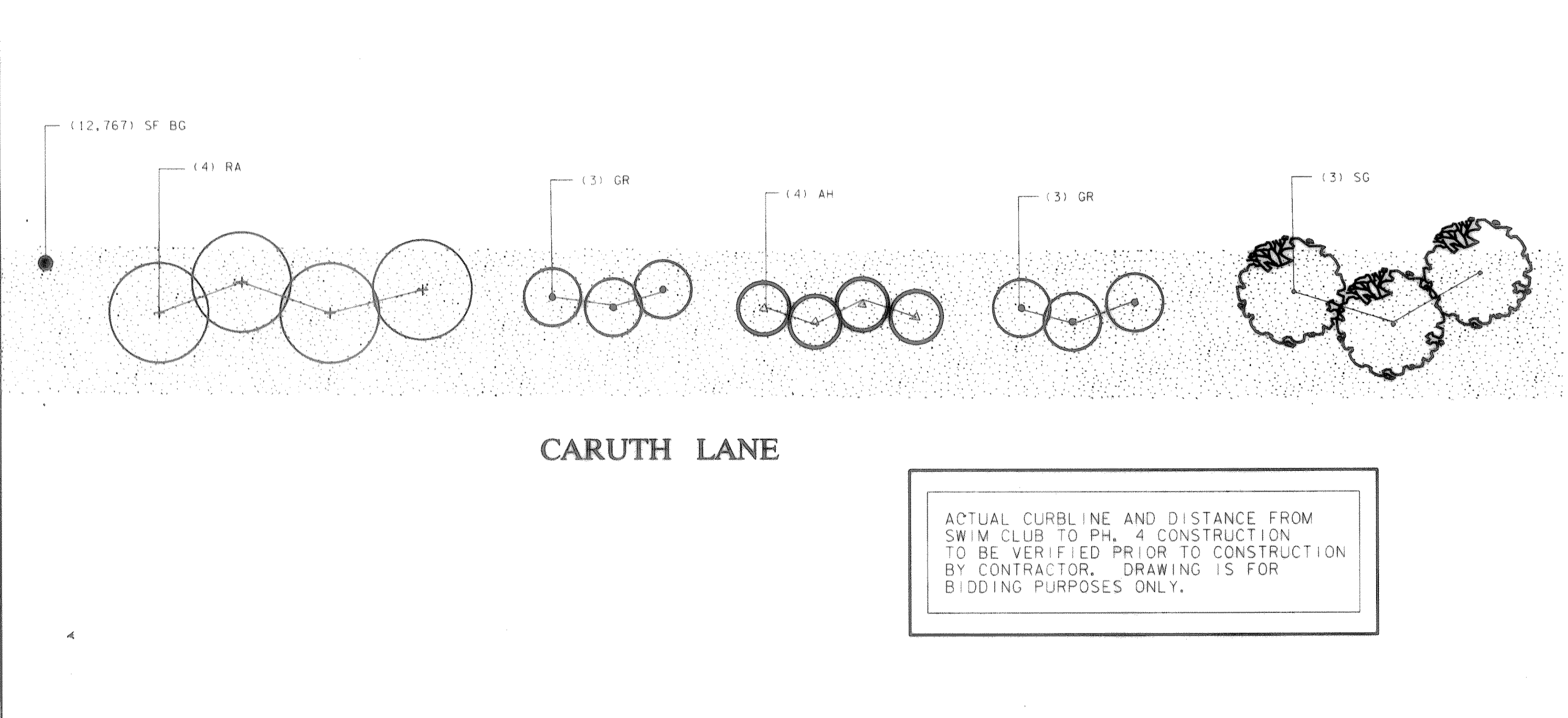

CARUTH LANE

ACTUAL CURBLINE AND DISTANCE FROM SWIM CLUB TO PH. 4 CONSTRUCTION TO BE VERIFIED PRIOR TO CONSTRUCTION BY CONTRACTOR. DRAWING IS FOR BIDDING PURPOSES ONLY.

MATCH LINE C

PLANTING LEGEND

- RA - RAYWOOD ASH
- SG - SWEETGUM
- AH - AMERICAN HOLLY
- GR - GOLDEN RAIN TREE

HARDSCAPE LEGEND

- 2' SHORT SITE COLUMN

PLANT LIST - THIS SHEET ONLY						
SYMBOL	QUANT.	COMMON NAME	BOTANICAL NAME	SIZE	COND.	REMARKS
LARGE TREES						
CE	0	CEDAR ELM	ULMUS CRASSIFOLIA	VARIES	SPADE	FIELD HARVESTED
SG	3	SWEETGUM	LIQUIDAMBAR STRACIFLUA	3" CALIPER	B & B	SPECIMEN QUALITY
LO	0	LIVE OAK	QUERCUS VIRGINIANA	3" CALIPER	B & B	SPECIMEN QUALITY
RA	4	RAYWOOD ASH	FRAXINUS OXYCARPA 'RAYWOOD'	3" CALIPER	B & B	SPECIMEN QUALITY
SMALL TREES						
BP	0	BRADFORD PEAR	PYRUS CALLERYANA 'BRADFORD'	2.5" - 3" CALIPER	B & B	SPECIMEN QUALITY
AH	4	AMERICAN HOLLY	ILLEX OPACA	10' - 12' HEIGHT	B & B	SPECIMEN QUALITY
GR	6	GOLDEN RAIN TREE	KOELREUTERIA PANICULATA	2.5" - 3" CALIPER	B & B	SPECIMEN QUALITY
SHRUBS						
PH	0	PHOTINIA	PHOTINIA X FRASERI	3' HEIGHT	B & B CONT.	3' MIN. HT. @ 3'-0" O.C.
TURF						
BG	12,767 SF	COMMON BERMUDA	CYNODON DACTYLON			HYDROSEED

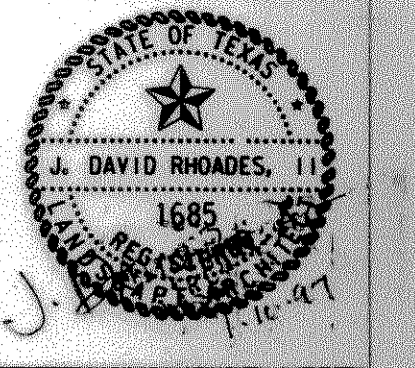
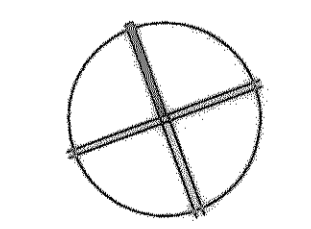

CARUTH LAKES - ROCKWALL, TEXAS
 LUMBERMEN'S INVESTMENT, INC.
 5495 BELTLINE RD., SUITE 225
 DALLAS, TX 75240

Carter Burgess
 DALLAS/FORT WORTH/ARLINGTON/HOUSTON, TEXAS
 FORT MYERS, FLORIDA
 790 EMBROOK DRIVE SUITE 250 DALLAS, TEXAS 75247-4951
 (214) 638-0045 FAX (214) 638-0447

REVISIONS	
JOB NUMBER	962287010
DESIGNED	JDR
DRAWN	JDR
CHECKED	JDR
ISSUE DATE	January 10, 1997
SHEET NUMBER	C-2

CARUTH LANE HARDSCAPE & PLANTING