

ASBUILT

Winkelmann & Associates, Inc. hereby states that this plan, to the best of our knowledge is "As Built." Modifications from the originally approved construction documents have been made as per information provided by the contractor. Winkelmann & Associates, Inc. does not certify as to the correctness or quality of construction as no field inspection was performed.

[Signature]
 WINKELMANN & ASSOCIATES, INC. DATE: 9-20-09

BENCHMARK: PK NAIL IN E. OF CARUTH LANE & ALLEY INTERSECTION 150'± EAST OF MORNINGSTAR DRIVE. ELEV. 491.68

BENCHMARK: "X" CHISELED IN E. OF ALLEY EAST OF MORNINGSTAR DRIVE WITHIN 3RD LOT NORTH OF MIDNIGHT PASS. ELEV. 513.26

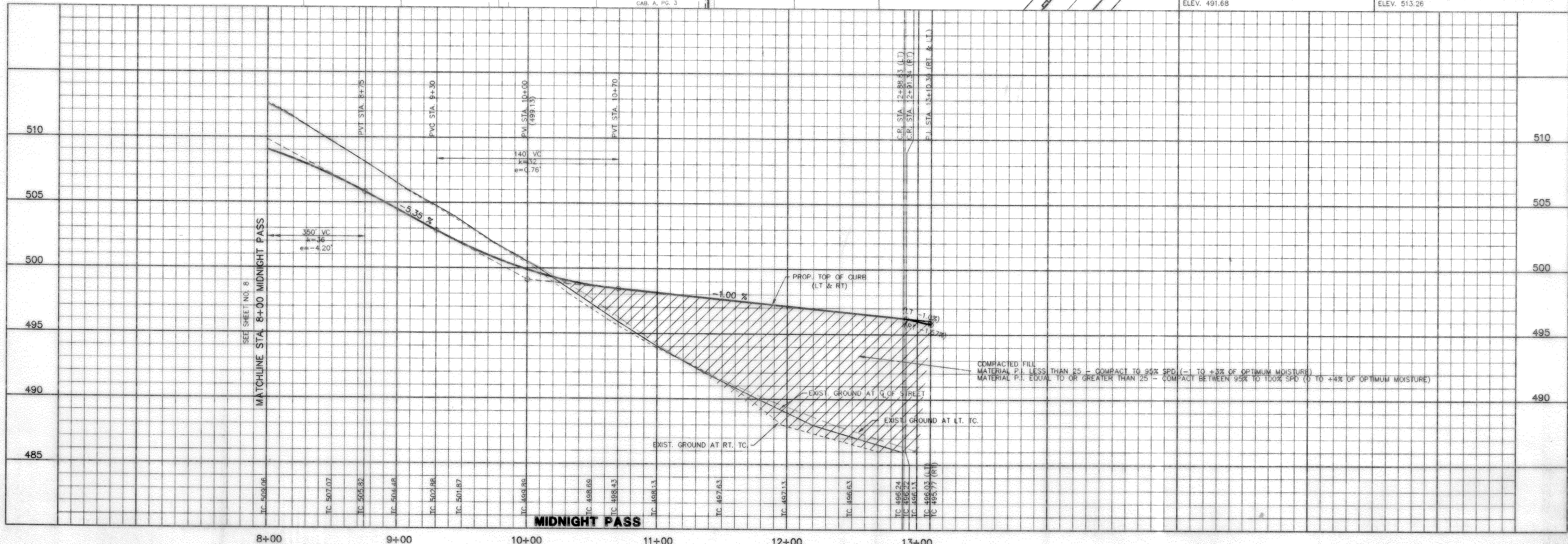

NO.	DATE	REVISION	APPROV.

Winkelmann & Associates, Inc.
 CONSULTING CIVIL ENGINEERS & SURVEYORS
 3400 Meadow Vista, Suite 200
 Dallas, Texas 75245
 (214) 463-0120

CARUTH LAKE PHASE FOUR
 S.S. McCUREY SURVEY, ABSTRACT NO. 146
 M.B. JONES CITY OF ROCKWALL ACT NO. 122
 ROCKWALL COUNTY, TEXAS
 LUMBERMEN'S INVESTMENT CORPORATION
 5495 DALLAS, TEXAS 75240

PAVING PLAN & PROFILE
MIDNIGHT PASS STA. 8+00 TO STA. 13+32.80
ALLEY # 3' STA. 9+00 TO STA. 13+34.58

Scale: 1"=40' Date: 9-9-09
 Designed By: RB
 Drawn By: MK
 Checked By: P.E.M.
 File: 14033P-16.DWG
 Project No.: 14633.01(20)