

CARUTH LAKE NO. 3

CITY OF ROCKWALL, ROCKWALL COUNTY, TEXAS

| INDEX | |
|------------------|-------|
| ITEM | SHEET |
| PLAT..... | 1-2 |
| PAVING..... | 3-5 |
| UTILITIES..... | 6 |
| DRAINAGE..... | 6-7 |
| LOT GRADING..... | 9 |

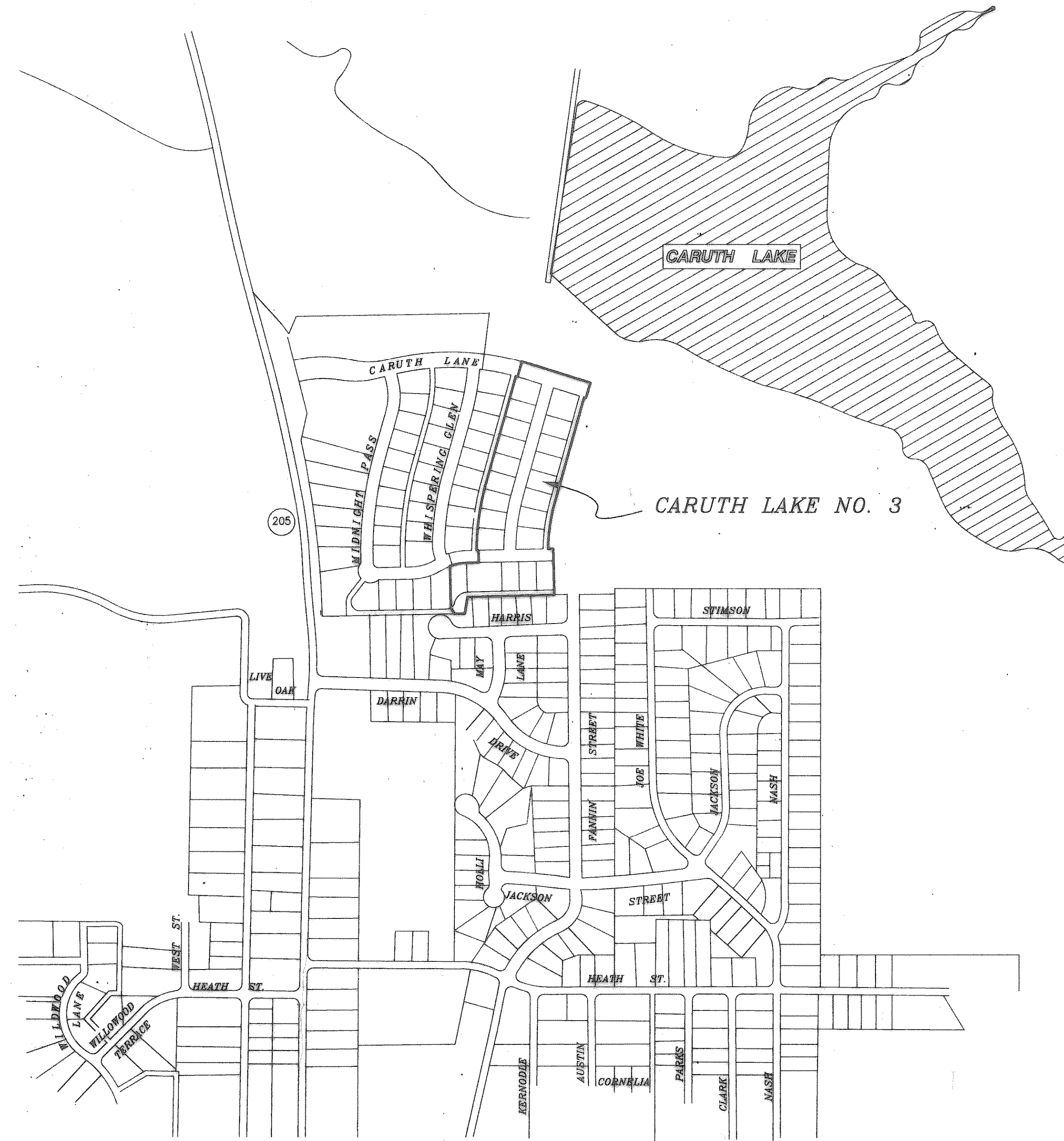

GENERAL NOTES

- EXCAVATED MATERIAL SHALL BE PLACED AS DIRECTED BY THE OWNER.
- ALL FILL AREAS IN STREET RIGHT - OF - WAYS TO BE DENSITY CONTROLLED AND COMPACTED TO 95% DENSITY AT OPTIMUM MOISTURE CONTENT.
- NO TREES SHALL BE CUT EXCEPT ON THE SPECIFIC AUTHORITY OF THE ENGINEER.
- CONSTRUCTION SHALL MEET THE REQUIREMENTS OF THE LATEST REVISION OF THE "STANDARD SPECIFICATIONS FOR CONSTRUCTION", CITY OF ROCKWALL.
- PAVEMENT THICKNESS SHALL BE AS FOLLOWS:

| | |
|------------------------------------|----------------------------------|
| RESIDENTIAL STREETS | = 6" THICK, 3500 P.S.I. CONCRETE |
| MINOR COLLECTOR STREET | = 6" THICK, 3500 P.S.I. CONCRETE |
| MAJOR COLLECTOR & ARTERIAL STREETS | = 8" THICK, 3500 P.S.I. CONCRETE |
- IT SHALL BE THE RESPONSIBILITY OF THE CONTRACTOR TO LOCATE AND VERIFY ALL EXISTING UTILITIES PRIOR TO THE BEGINNING OF CONSTRUCTION TO INSURE NO CONFLICT BETWEEN ALL UTILITY LINES.
- WHERE WATER PIPELINES EITHER CROSS OR OTHERWISE COME WITHIN 9 FEET OF A SANITARY SEWER PIPELINE THE SEWER PIPELINE SHALL BE EITHER CAST IRON OR PVC PIPE WITH A MINIMUM WORKING PRESSURE CLASS OF 150 PSI.
- ALL WATER SERVICES TO BE 1" INSTALLED TO THR CENTER OF EACH LOT WITH SEWER LATERALS 10' DOWNSTREAM. WATER SERVICES SHALL BE PE 200 PSI SDR 9 WITH METAL INSERTS.
- CONDUITS FOR S. W. BELL AND BETA CABLE T.V. SHALL HAVE 30" OF COVER AND SHALL EXTEND 2 FEET BEYOND FUTURE PAVING.
- ALL FITTINGS SHALL BE BRASS COMPRESSION.
- RESILIENT SEATED GATE VALVES ONLY WILL BE ALLOWED.
- BLUE MARKER E. M. S. #1252 SHALL BE PLACED UNDER EACH CORPORATION STOP
- GREEN MARKER E. M. S. #1253 SHALL BE PLACED UNDER EACH SEWER SERVICE AND AT EACH MANHOLE AT A DEPTH NOT TO EXCEED 5 FEET.

T.U. ELECTRIC COMPANY GENERAL NOTES

- CONTRACTOR TO INSTALL ALL CONDUIT AS SHOWN ON PRINT.
- T.U. ELECTRIC COMPANY TO FURNISH CONDUIT AND CABLE MARKERS.
- DEVELOPER TO INSTALL 1 (ONE) CABLE MARKER AT EACH END OF CONDUIT.
- EACH CONDUIT MUST BE BURIED A MINIMUM OF 40" DEEP (AFTER LAND IS BROUGHT TO FINAL GRADE AND EXTEND 2 FEET BEYOND FUTURE PAVING) .
- EACH CONDUIT MUST BE INSPECTED BY THE DISTRIBUTION DEPARTMENT BEFORE BACKFILLING IN TRENCH. ROBERT GAYLOR 487-2351.
- EACH CONDUIT MUST HAVE A PULL WIRE INSTALLED AND BE CAPPED AT BOTH ENDS.



OWNER :
CARUTH LAKE DEVELOPMENT CORPORATION

P.O. BOX 369
 ROCKWALL, TEXAS 75087
 (214) 771-5238

HAROLD L. EVANS, CONSULTING ENGINEER

P.O. BOX 28355
 DALLAS, TEXAS 75228
 (214) 328-8133