

PLOTTED BY: JVALDEZ  
 PLOT DATE: 11/16/2017 10:41 AM  
 LOCATION: C:\EGNITTE\SHARED\PROJECTS\2016-029 CRESTVIEW ROCKWALL\CADD\SHEETS\C-2 EROSION CONTROL PLAN.DWG  
 LAST SAVED: 11/16/2017 10:34 AM

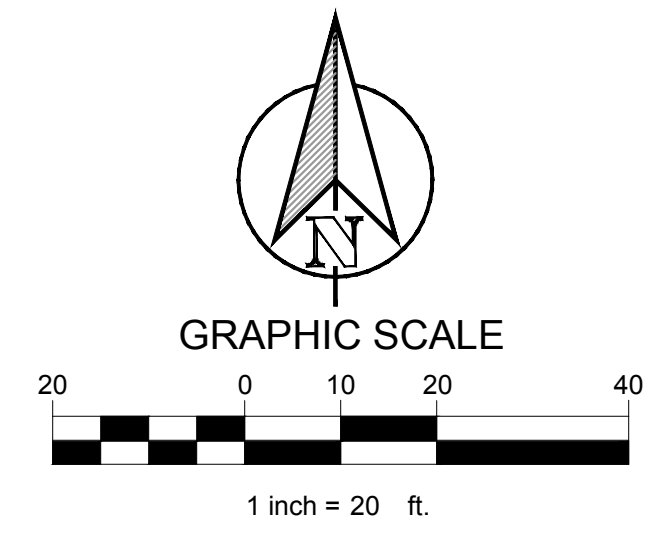
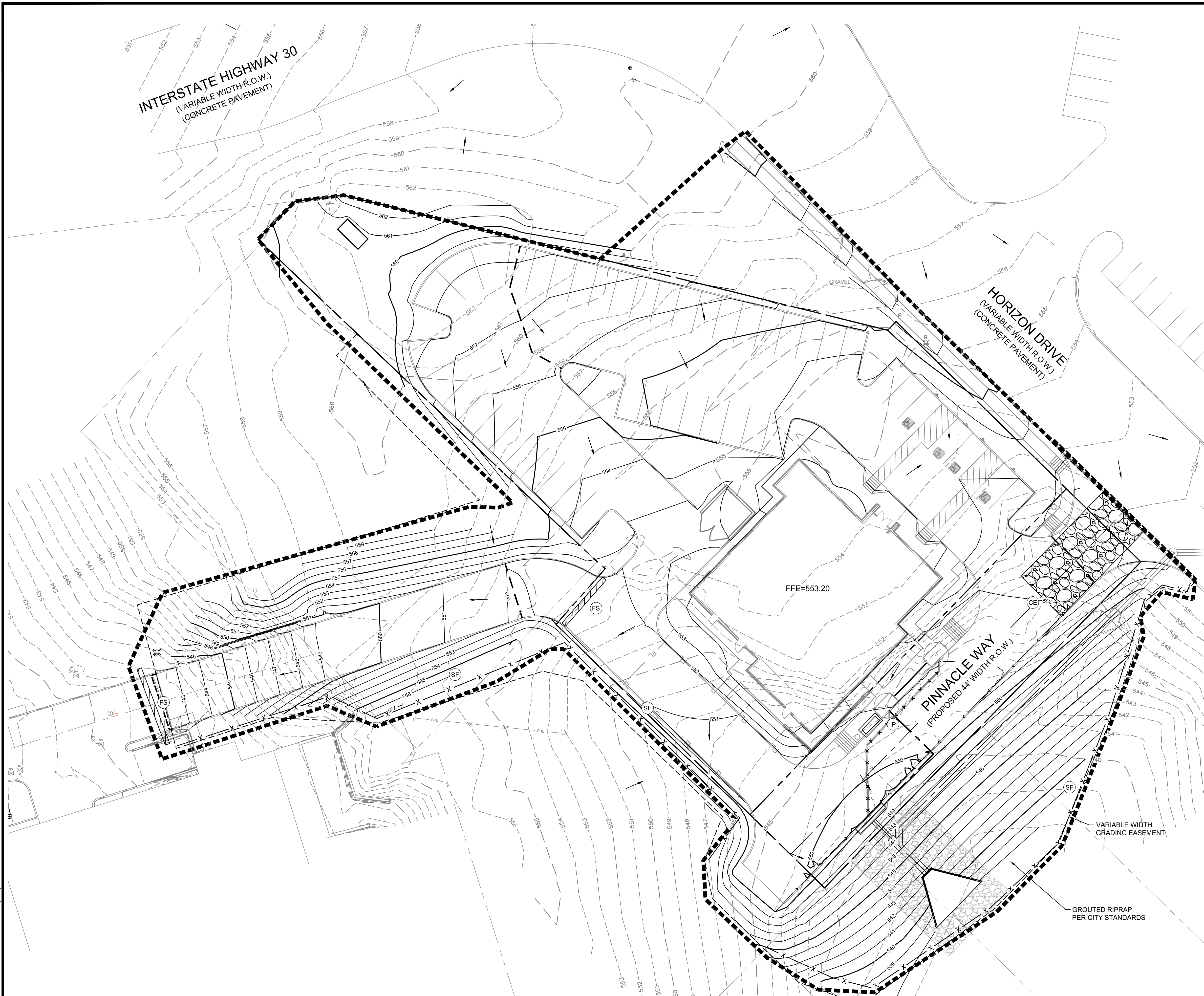

LEGEND	
	DIRECTION OF FLOW
	EXISTING CONTOUR
	PROPOSED CONTOUR
	LIMITS OF CONSTRUCTION
	SILT FENCE
	CONSTRUCTION ENTRANCE
	FILTER SOCK
	INLET PROTECTION

ACREAGE SUMMARY	
ON-SITE DISTURBED AREA	1.11 AC
OFF-SITE DISTURBED AREA	0.63 AC
TOTAL DISTURBED AREA	1.74

This drawing has been revised to show those changes during the construction process reported by the contractor to ClayMoore Engineering, Inc. and considered to be significant. This drawing is not guaranteed to be "As Built" but is based on the information made available.  
 By: *Matt Hill* Date: 11/16/2017

**BENCH MARKS**  
 BENCH MARK NO. 6-1  
 CONCRETE MONUMENT WITH BRASS CAP AT THE  
 SOUTHWEST CORNER OF MARINA AND VILLAGE ROAD  
 ELEV: 506.05  
 BENCH MARK NO. RESET 1  
 AT THE WEST END OF SUMMER LEE AND WEST OF FM 740.  
 ELEV: 567.70



CARENOW  
 LOT 1 & 2, BLOCK A  
 BRISCOE/HILCREST ADDITION  
 ROCKWALL, TX

NO.	DATE	REVISION	BY

EROSION CONTROL PLAN  
 SHEET  
**C-2**

DESIGN: JEV  
 DRAWN: JEV  
 CHECKED: CLC  
 DATE: 04/03/2017