

PLOTTED BY: JVALDFZ
 PLOT DATE: 11/16/2017 2:04 PM
 LOCATION: C:\EGNITE\SHARED\PROJECTS\2016-029 CRESTVIEW ROCKWALL\CADD\SHEETS\C-11 SANITARY SEWER PROFILES.DWG
 LAST SAVED: 11/16/2017 2:03 PM

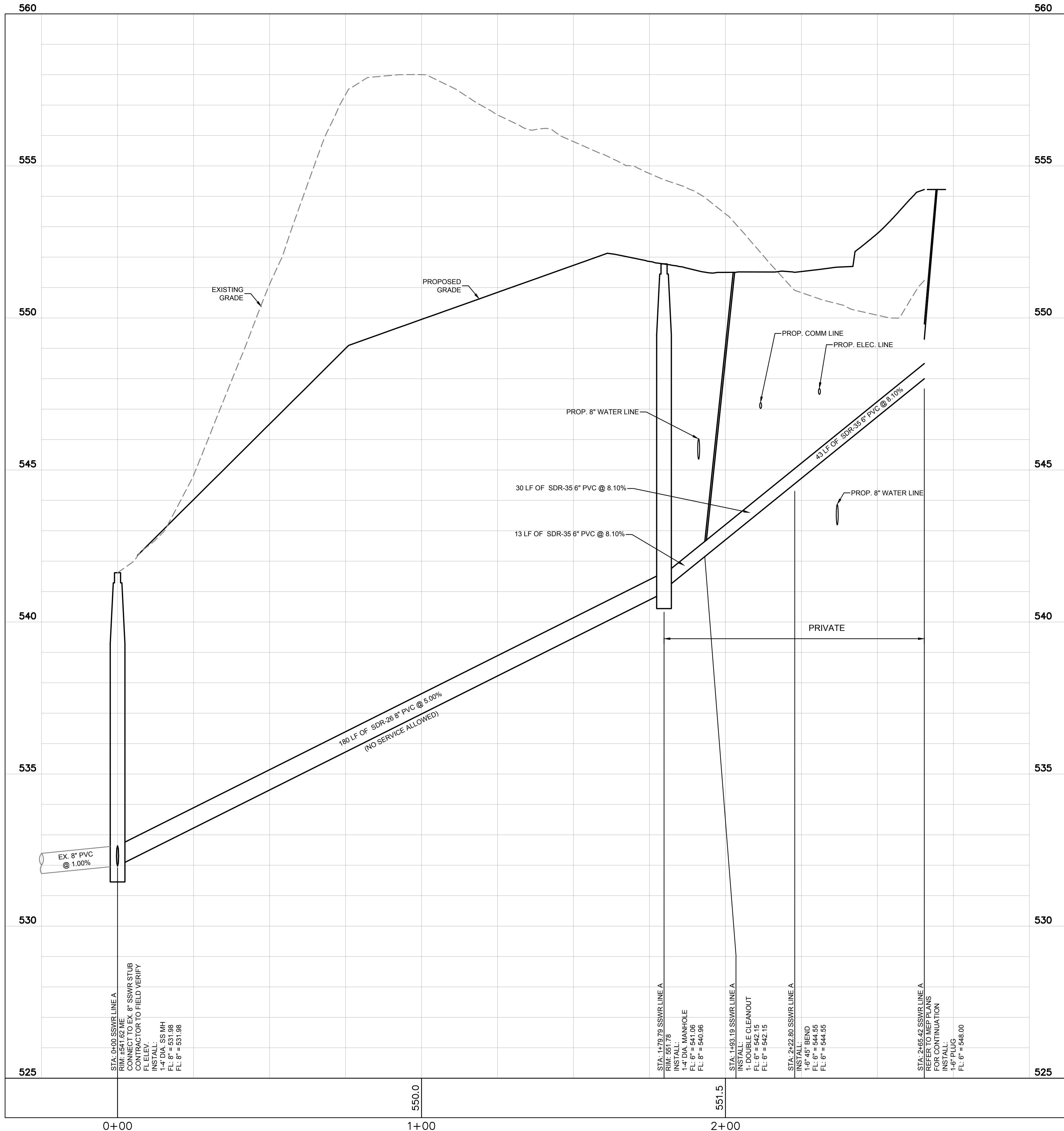

SEWER LINE A
 HORIZ. SCALE: 1"=20'
 VERT. SCALE: 1"=2'

This drawing has been revised to show those changes during the construction process reported by the contractor to ClayMoore Engineering, Inc. and considered to be significant. This drawing is not guaranteed to be "As Built" but is based on the information made available.
 By: *Matt* Date: 11/16/2017

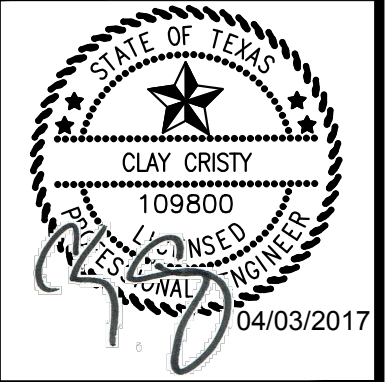

CARENOW
 LOT 1 & 2, BLOCK A
 BRISCOE/HILCREST ADDITION
 ROCKWALL, TX

No.	DATE	REVISION	BY
1	3/2/2017	PIPE LINE RELOCATION	JV
2	3/22/2017	REF - FIN	JV
3	4/3/2017	REF - FINISHED FLOOR	JV

SANITARY SEWER PROFILES

DESIGN: JEV
 DRAWN: JEV
 CHECKED: CLC
 DATE: 04/03/2017