

GENERAL NOTES:

- REINFORCED CONCRETE PAVEMENT.
 - ALL CURBS SHALL BE PLACED INTEGRAL WITH PAVEMENT UNLESS OTHERWISE APPROVED BY THE OWNER.
 - CURBS SHALL MEET THE SAME COMPRESSIVE STRENGTH AS SPECIFIED FOR THE PAVEMENT.
 - BAR LAPS SHALL BE 30 DIAMETERS.
 - REINFORCING BARS SHALL BE SUPPORTED BY CHAIRS OR OTHER DEVICES APPROVED BY THE OWNER.
- SUBGRADE: (UNLESS OTHERWISE SPECIFIED BY OWNER)
 - SUBGRADE UNDER ALL PAVEMENTS SHALL BE STABILIZED TO A MINIMUM DEPTH OF SIX (6") INCHES WITH HYDRATED LIME CEMENT. LABORATORY TESTS WILL BE PERFORMED TO DETERMINE THE AMOUNT OF LIME OR CEMENT TO USE.

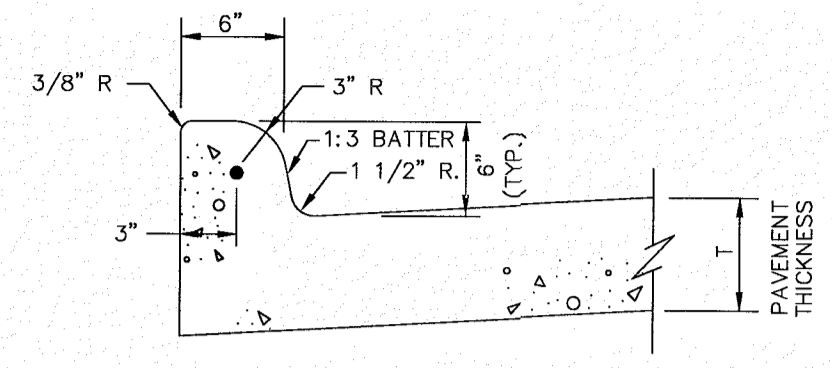

INTEGRAL CURB & GUTTER
N.T.S.

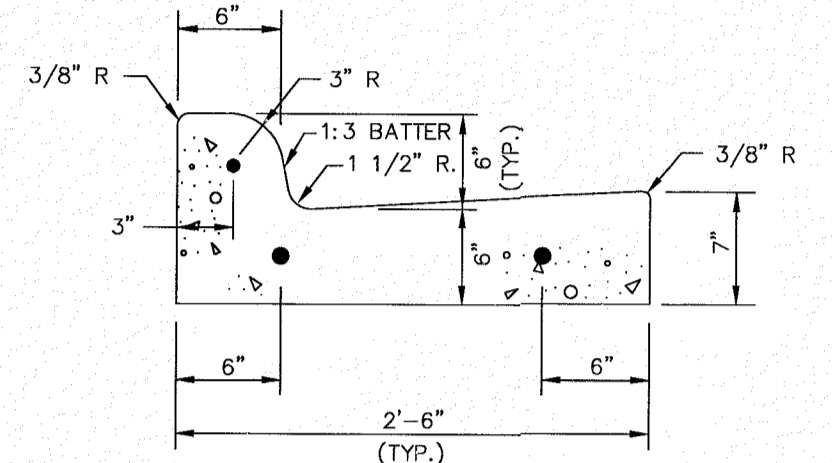

SEPARATE CURB & GUTTER
N.T.S.

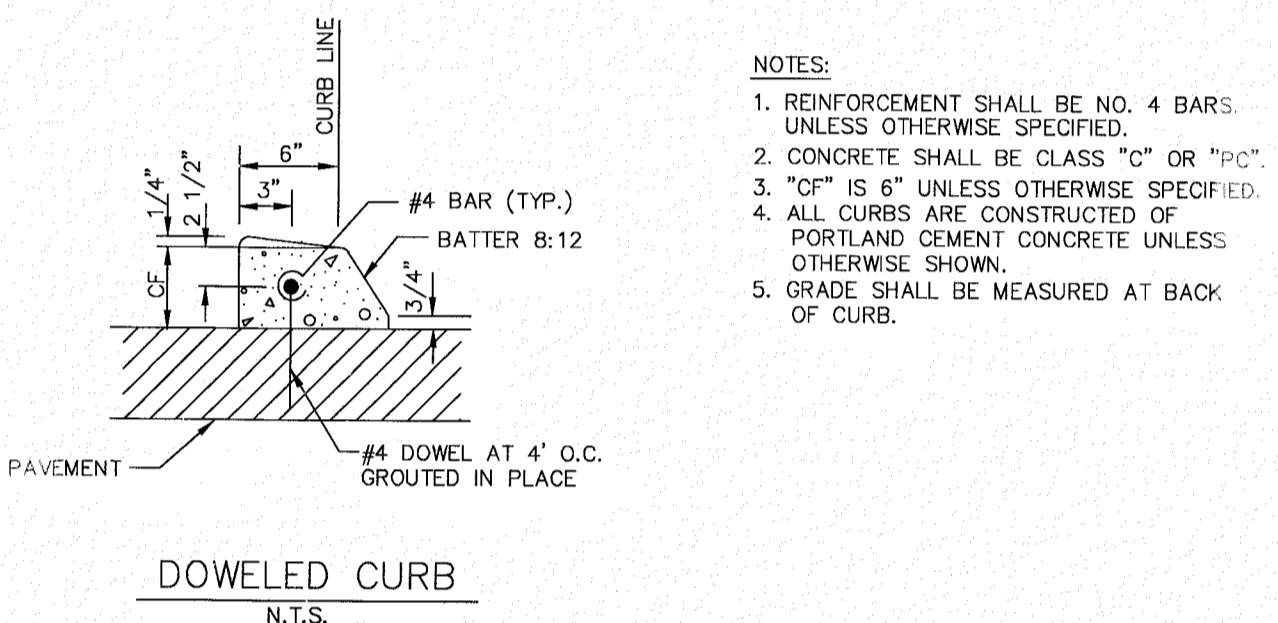

DOWELED CURB
N.T.S.

- NOTES:**
- REINFORCEMENT SHALL BE NO. 4 BARS UNLESS OTHERWISE SPECIFIED.
 - CONCRETE SHALL BE CLASS "C" OR "PC".
 - "C" IS 6" UNLESS OTHERWISE SPECIFIED.
 - ALL CURBS ARE CONSTRUCTED OF PORTLAND CEMENT CONCRETE UNLESS OTHERWISE SHOWN.
 - GRADE SHALL BE MEASURED AT BACK OF CURB.

PAVEMENT SYSTEMS GENERAL NOTES	CITY OF ROCKWALL	STANDARD SPECIFICATION REFERENCE 302.303
		DATE: Mar. 2018 DRAWING NO.: R-2190

CONCRETE CURB & GUTTER INTEGRAL, SEPARATE, & DOWELED	North Central Texas Council of Governments	STANDARD SPECIFICATION REFERENCE 305.1
		DATE: OCT. '04 DRAWING NO.: 2120

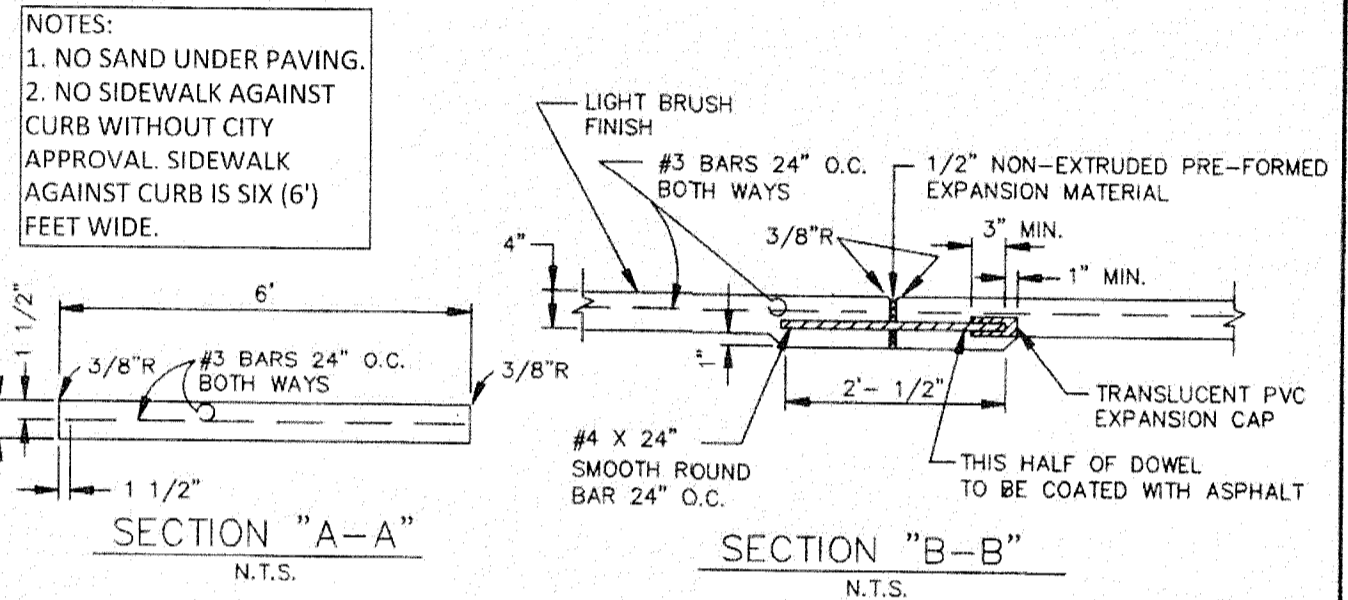
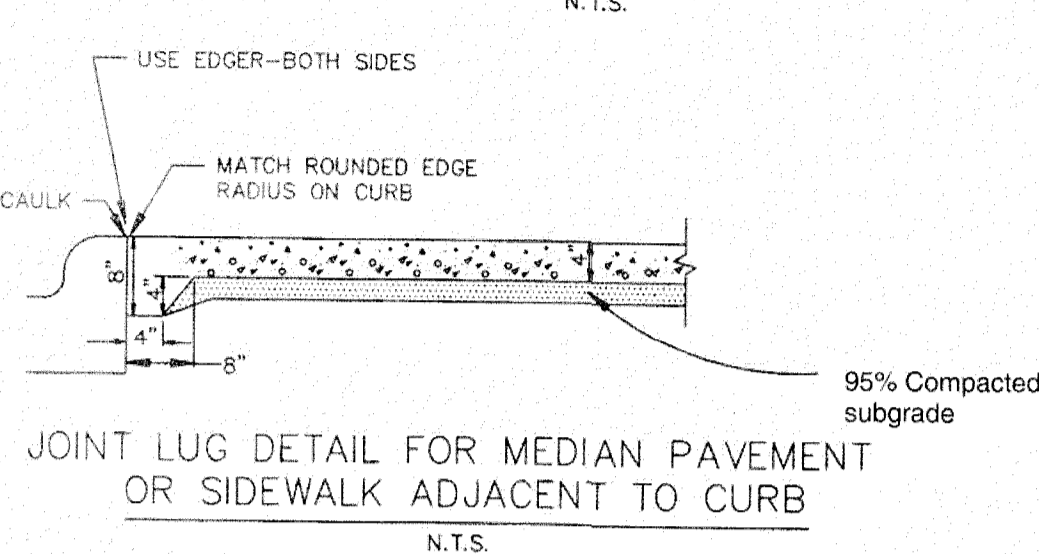
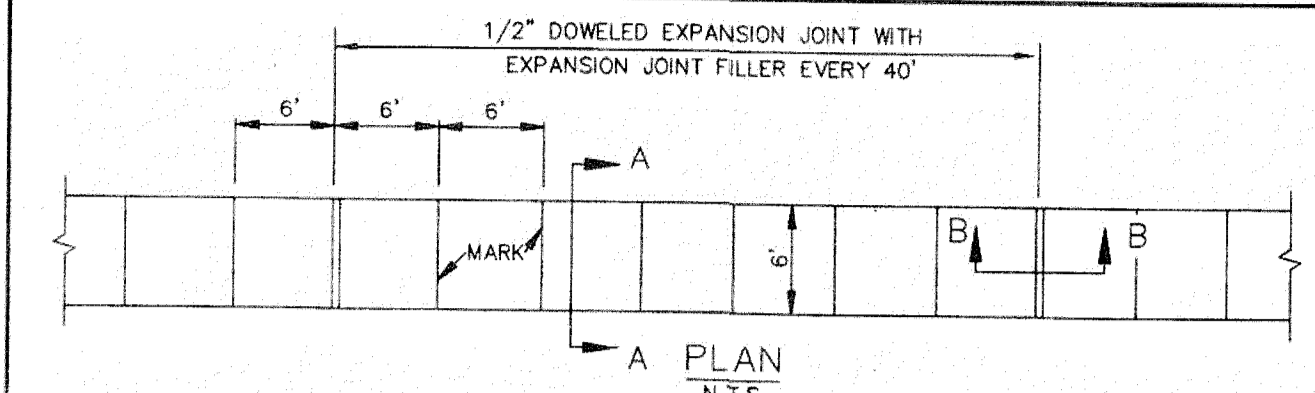

- NOTES:**
- NO SAND UNDER PAVING.
 - NO SIDEWALK AGAINST CURB WITHOUT CITY APPROVAL. SIDEWALK AGAINST CURB IS SIX (6') FEET WIDE.
- NOTE:**
- REFER TO STANDARD SPECIFICATION ITEM 305.2 FOR ALTERNATE REINFORCEMENT.
 - CROSS SLOPE OF SIDEWALK SHALL BE $\pm 1/4"$ PER FT. MIN. TO $\pm 3/8"$ PER FT. MAX.
 - OTHER THAN 6'-0" SIDEWALK WIDTH MAY BE SPECIFIED BY OWNER.
 - SIDEWALK SHALL BE 3,000 PSI (5.5 SACK MIX MIN) CONCRETE UNLESS OTHERWISE SPECIFIED BY OWNER.*
 - ALL HONEYCOMB IN BACK OF CURB TO BE TROWEL-PLASTERED BEFORE POURING SIDEWALK.
 - LUG MAY BE FORMED BY SHAPING SUBGRADE TO APPROXIMATE DIMENSIONS SHOWN.

REINFORCED CONCRETE SIDEWALKS JOINTS AND SPACING	CITY OF ROCKWALL	STANDARD SPECIFICATION REFERENCE 305.2
		DATE: Mar. 2018 DRAWING NO.: R-2170

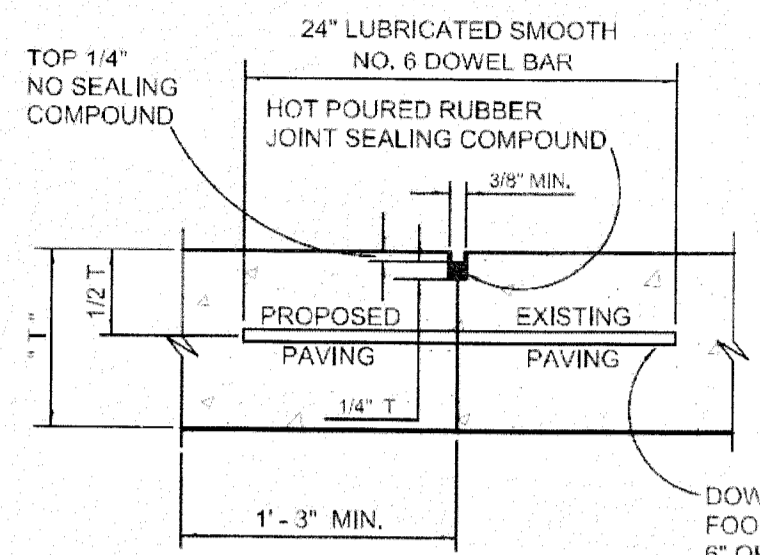

- NOTES:** T = PAVEMENT
- LONGITUDINAL BUTT CONSTRUCTION MAY BE UTILIZED IN PLACE OF LONGITUDINAL HINGED (KEYWAY) JOINT AT CONTRACTOR'S OPTION.
 - DOWEL BARS SHALL BE DRILLED INTO PAVEMENT HORIZONTALLY BY USE OF A MECHANICAL RIG.
- DRILLING BY HAND IS NOT ACCEPTABLE. PUSHING DOWEL BARS INTO GREEN CONCRETE NOT ACCEPTABLE.

REINFORCED CONCRETE PAVEMENT LONGITUDINAL BUTT JOINT	CITY OF ROCKWALL	DATE: AUG. '15 DRAWING NO.: R-2051

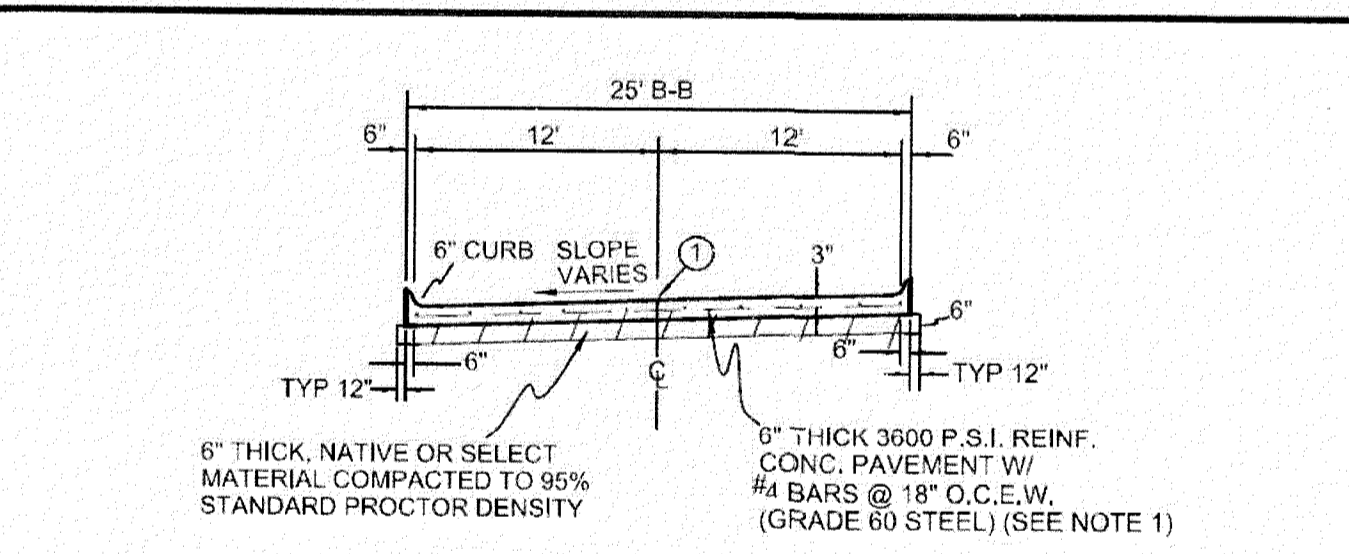

24' Wide Fire Lane with Curbs
(Not to Scale)

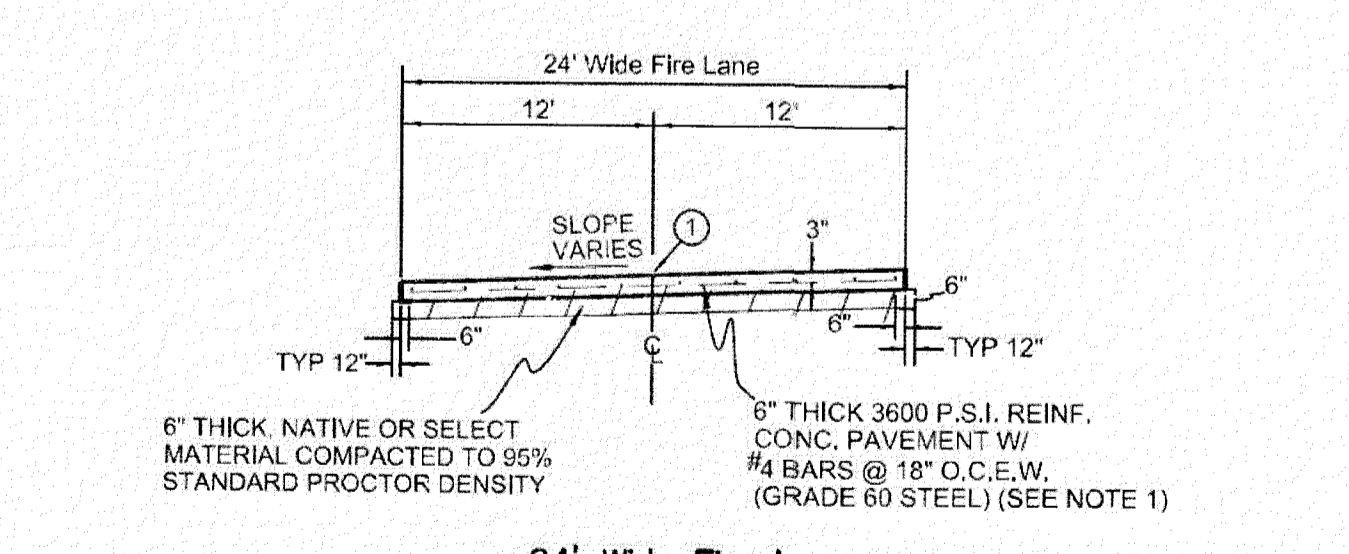

24' Wide Fire Lane
(Not to Scale)

- NOTES:**
- Street pavement cement content to be no less than 6 sacks per cubic yard for machine placed and not less than 6.5 sacks per cubic yard for hand placed.
 - Sidewalk Cement content of not less than 5.5 sack per cubic yard.
 - No sand allowed under pavement or sidewalks.

REINFORCED CONCRETE PAVEMENT FIRE LANE	CITY OF ROCKWALL	DATE: AUG. '15 DRAWING NO.: R-2041

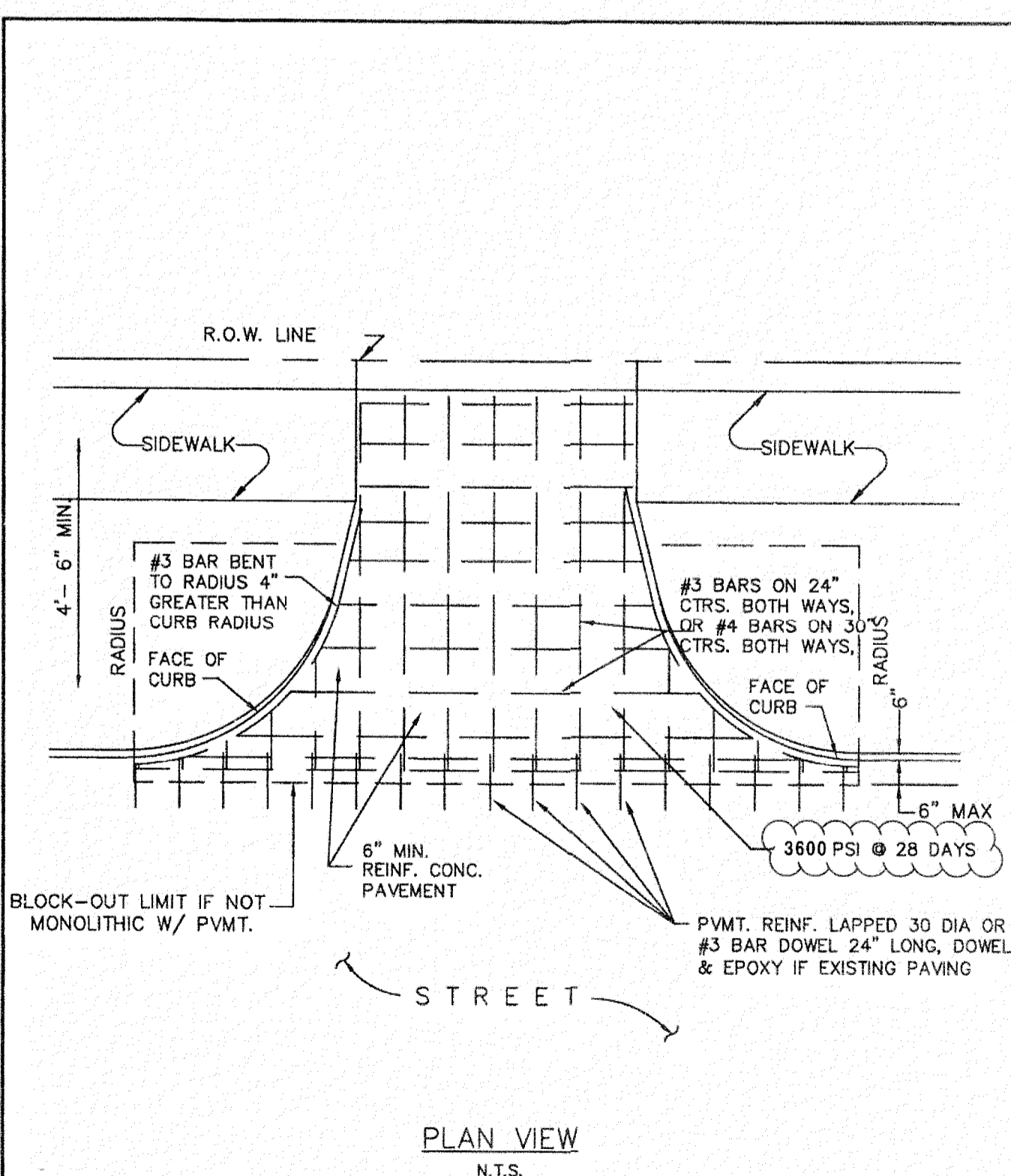

DRIVEWAY APPROACH RADIUS RETURN TYPE	North Central Texas Council of Governments	STANDARD SPECIFICATION REFERENCE 305.1
		DATE: OCT. '04 DRAWING NO.: 2155

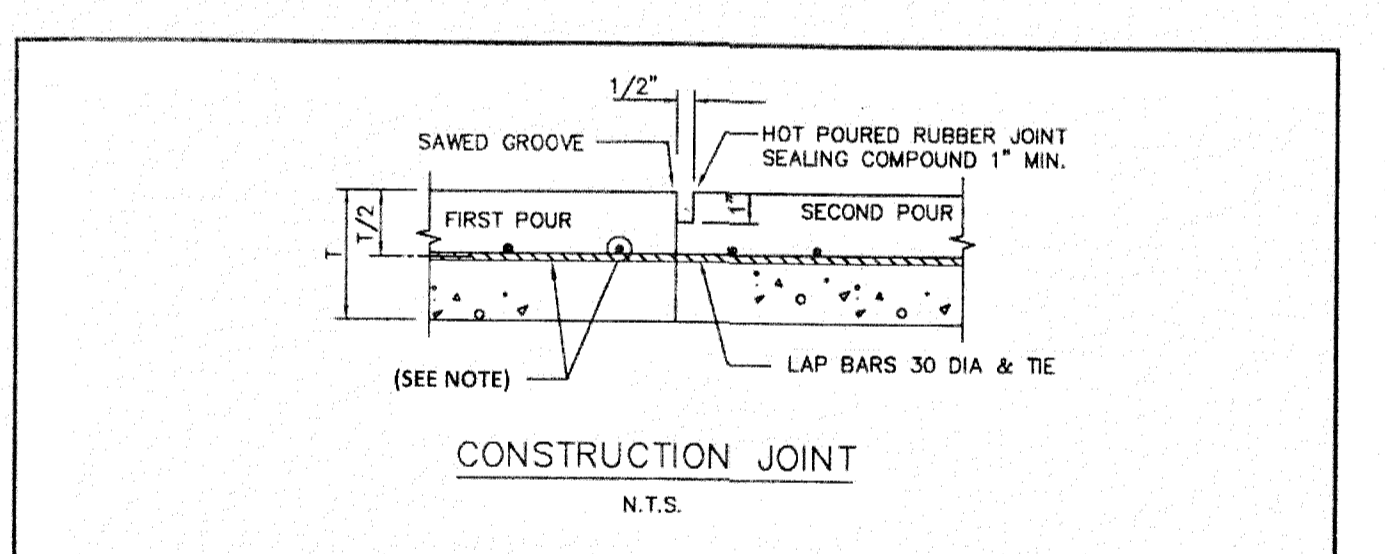

CONSTRUCTION JOINT
N.T.S.

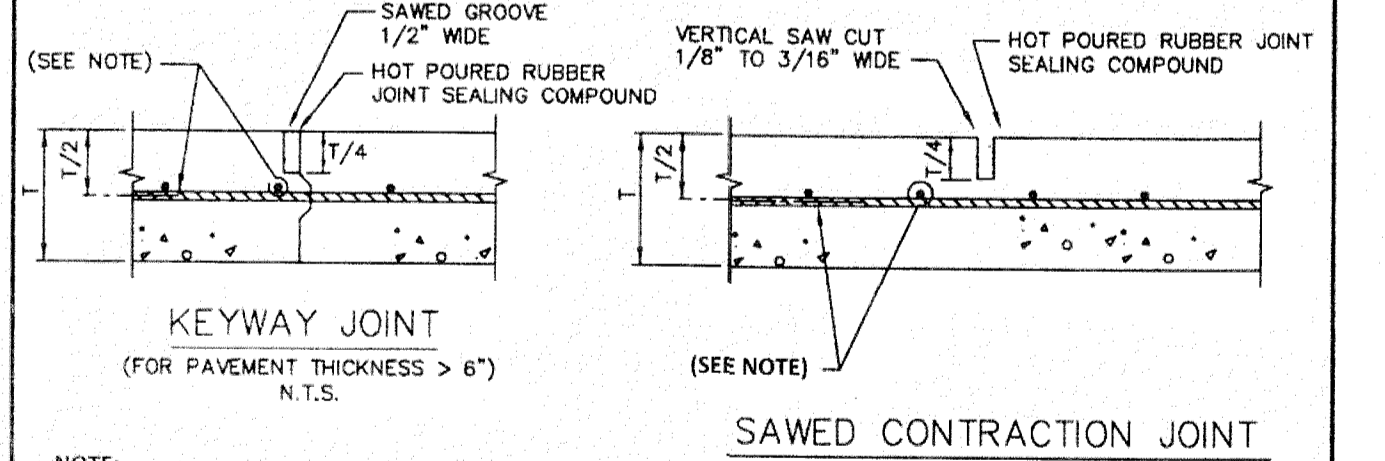

KEYWAY JOINT
(FOR PAVEMENT THICKNESS > 6")
N.T.S.

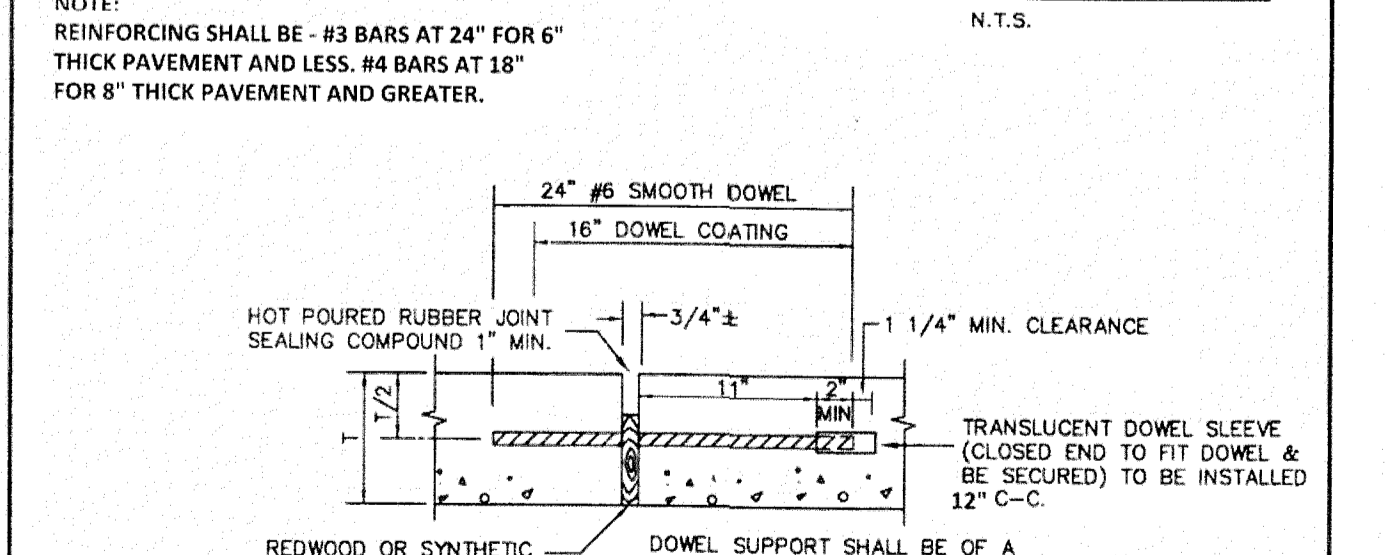

SAWED CONTRACTION JOINT
N.T.S.

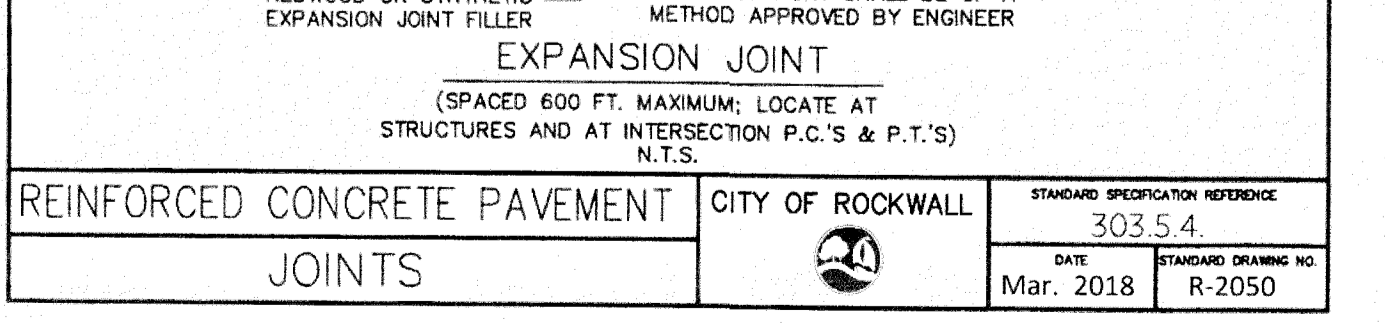

EXPANSION JOINT
(SPACED 600 FT. MAXIMUM; LOCATE AT STRUCTURES AND AT INTERSECTION P.C.'S & P.T.'S)
N.T.S.

REINFORCED CONCRETE PAVEMENT JOINTS	CITY OF ROCKWALL	STANDARD SPECIFICATION REFERENCE 303.5.4
		DATE: Mar. 2018 DRAWING NO.: R-2050

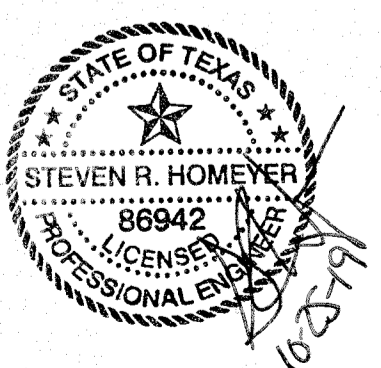

HOMEYER ENGINEERING, INC.
 ENGINEERING, INC.
 TBPE FIRM REGISTRATION NO. F-8440
 P.O. BOX 2944527 • LEWISVILLE, TEXAS • 75029
 PHONE # 972-906-9987 FAX # 972-906-9988
 WWW.HETI.US.COM

CANINE AND CO. RESORT
 1.21 ACRES
 CITY OF ROCKWALL
 ROCKWALL COUNTY, TEXAS

PAVING DETAILS

DRAWN: JAN
 DATE: 09/28/2018
 HEI #: 18-140

SHEET NO:
 C12

CASE NO. SP2019-017