

### GRADING LEGEND

I.R.F.	IRON ROD FOUND	SSMH	SANITARY SEWER MANHOLE
I.R.S.	IRON ROD SET	⊕	FIRE HYDRANT
"X"	CUT X IN CONCRETE	⊗	WATER METER
F.C.P.	FENCE CORNER POST	T.C.	TOP OF CURB
///	ASPHALT	G	GUTTER
⊙	TELEPHONE MANHOLE	T.P.	TOP OF PAVEMENT
⊕	POWER POLE	N.G.	NATURAL GROUND
⊙	LIGHT POLE	---	EXISTING CONTOURS
⊗	WATER VALVE	---	PROPOSED CONTOURS

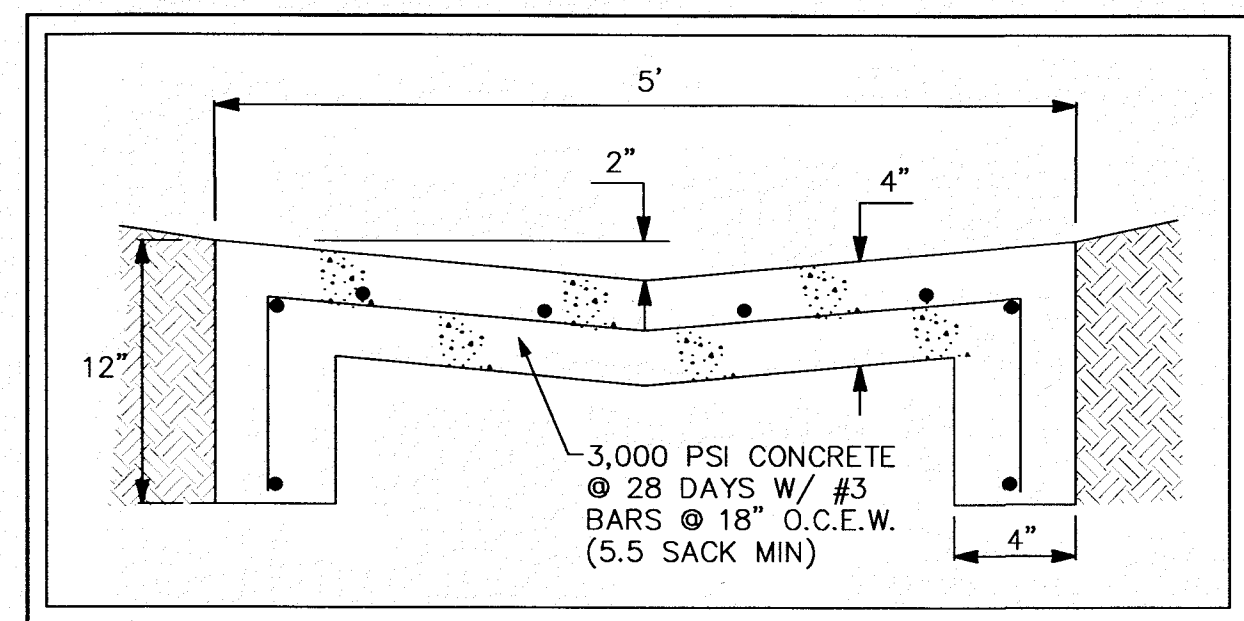

**CONCRETE FLUME DETAIL 1**  
NOT TO SCALE

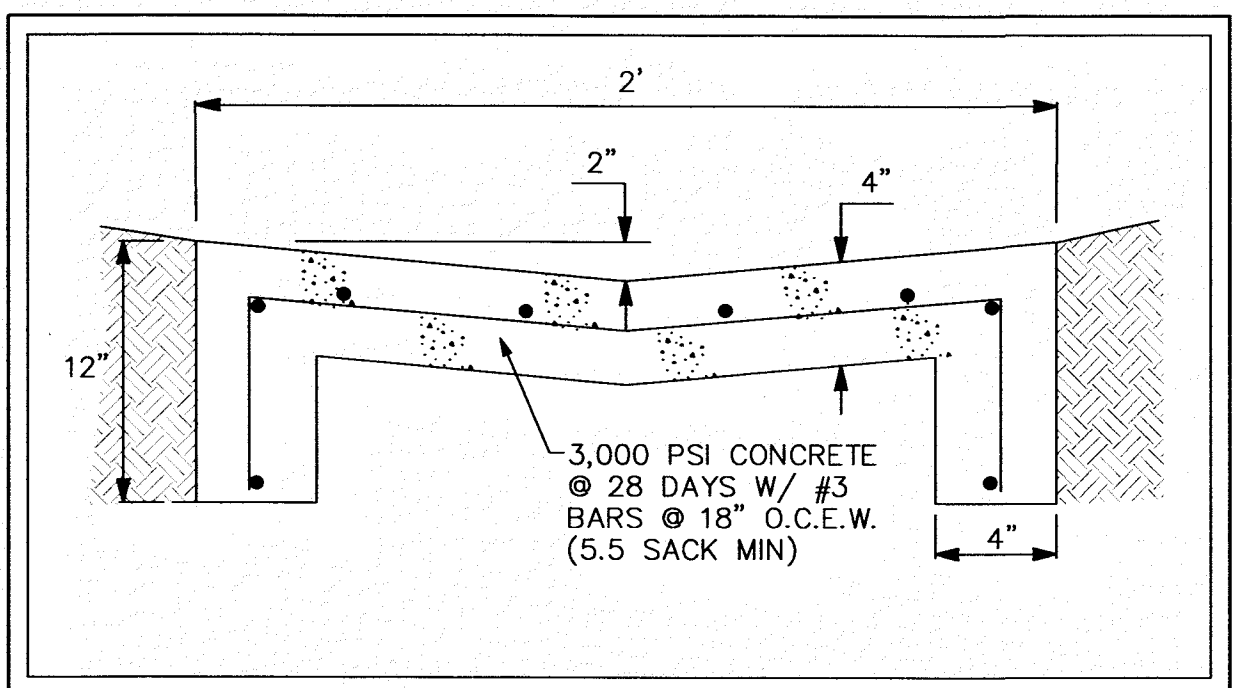

**CONCRETE FLUME DETAIL 2**  
NOT TO SCALE

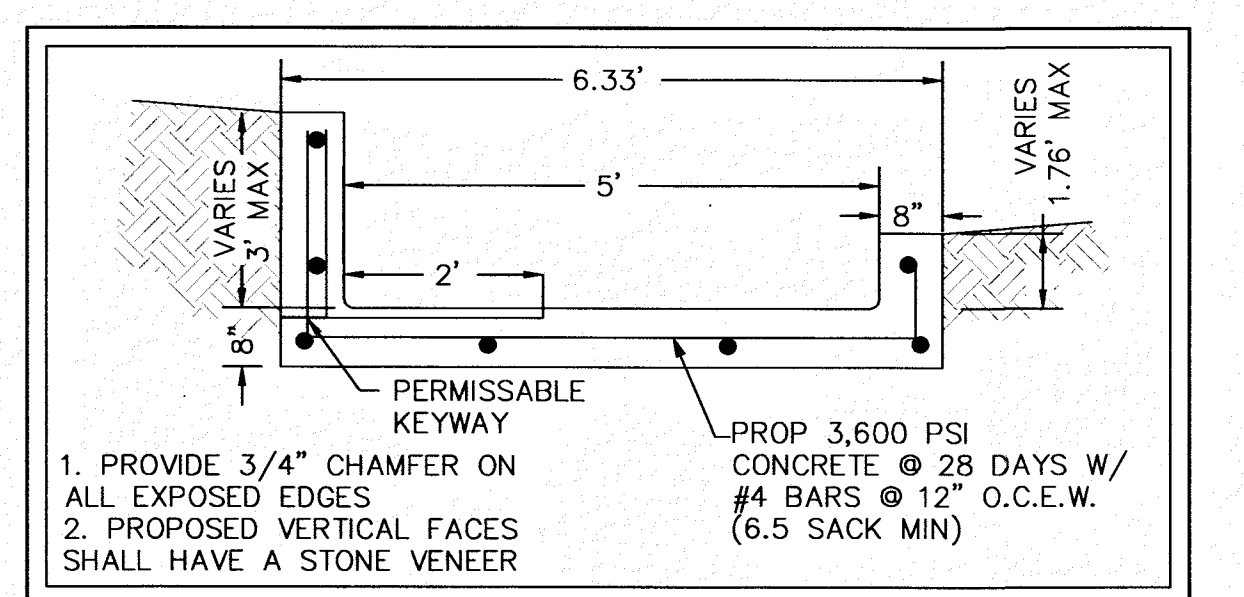

**CONCRETE FLUME DETAIL 3**  
NOT TO SCALE

#### BENCHMARK INFORMATION

TBM #1: ELEV. = 552.63  
"X" CUT LOCATED APPROXIMATELY 10 FEET EAST AND 37 FEET NORTH OF THE SOUTHEAST PROPERTY CORNER OF THE SUBJECT PROPERTY

TBM #2: ELEV. = 558.79  
"X" CUT LOCATED APPROXIMATELY 16 FEET EAST AND 56 FEET SOUTH OF THE SOUTHWEST PROPERTY CORNER OF THE SUBJECT PROPERTY

THE CONTRACTOR SHALL CONTACT  
DIG-TESS AT 1-800-344-8377 AND  
CITY SERVICE CENTER AT  
972-772-7730 FOR LINE LOCATES A  
MINIMUM OF 48 HOURS PRIOR TO THE  
COMMENCEMENT OF ANY  
CONSTRUCTION ACTIVITIES

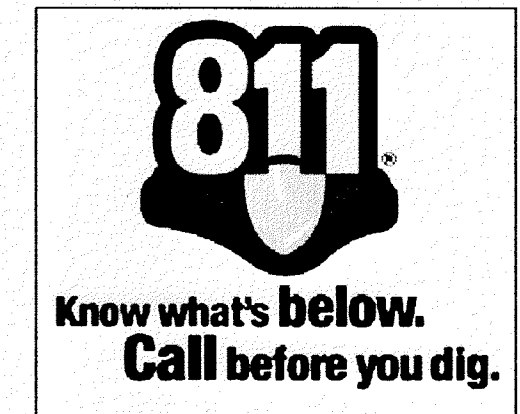

#### RECORD DRAWING

The record drawing herein reflects to the best of the design engineer's knowledge, the approximate location of the constructed improvements using information based on surveying at the site and information provided by the contractor.

Steven R. Homeyer, P.E. #86942  
Date: 7-20-20

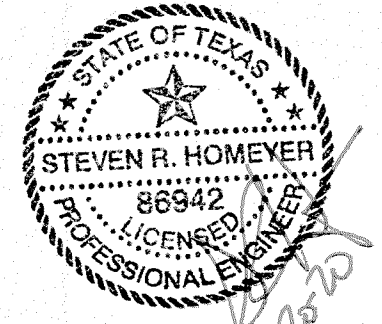

# HOMeyer

ENGINEERING, INC.  
T.B.E. FIRM REGISTRATION NO. F-84440  
P.O. BOX 294527 • LEWISVILLE, TEXAS • 75029  
972-906-9985 • PHONE • 972-906-9987 • FAX  
WWW.HEI.US.COM

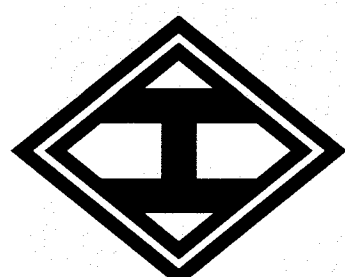

CANINE AND CO. RESORT  
1.21 ACRES  
CITY OF ROCKWALL  
ROCKWALL COUNTY, TEXAS

GRADING PLAN

REVISIONS  
07-20-20  
1. REVISED NORTHEAST BLDG ENTRY SIDEWALK & ELEVATIONS  
2. REVISED DETENTION POND ELEVATIONS  
3. REVISED 5' CONCRETE FLUME ELEVATIONS

DRAWN: JAN  
DATE: 09/28/2018  
HEI #: 18-140

SHEET NO:  
C4

CASE NO. SP2019-017