

C:\land Projects\3\268-06\dwg\01C0651PR.dwg 11/18/2003 3:20:55 PM CST

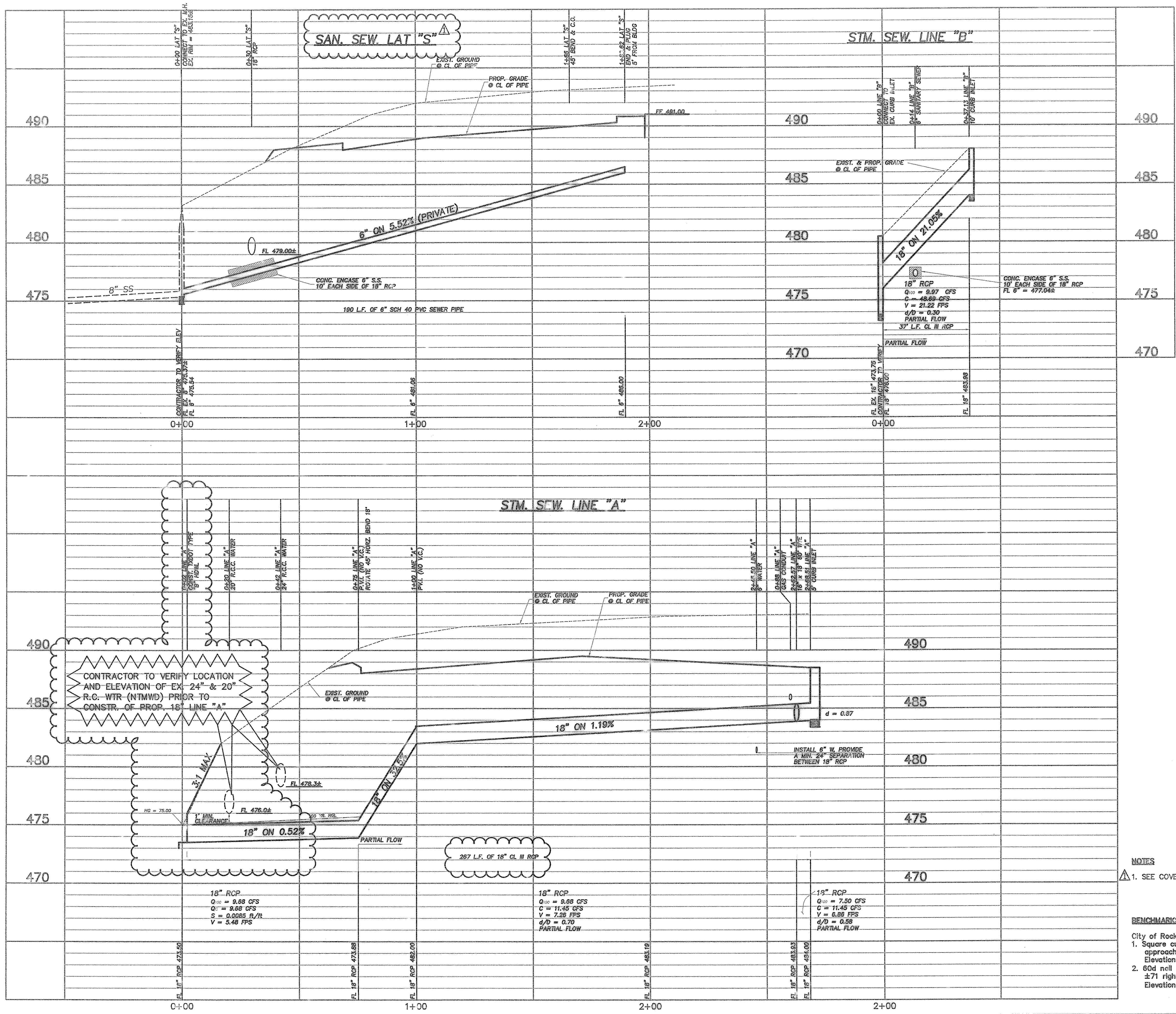

CONSTRUCTION RECORDS
 DATE: 6/2/04 BY: J.J.V.
 THIS DRAWING INDICATES THE WORK COMPLETED PER INFORMATION SUPPLIED BY THE CONTRACTOR. ACTUAL ON THE GROUND SURVEY VERIFICATION WAS NOT PERFORMED EXCEPT AS SPECIFICALLY NOTED.

NOTES
 1. SEE COVER SHEET FOR NTMWD GENERAL NOTES.

BENCHMARKS
 City of Rockwell Bm
 1. Square cut found at base of concrete wall at S.W. corner of south approach to bridge over Squabble Creek on Hwy. 205
 Elevation= 472.41
 2. 60d nail in 36-inch pecan tree, tag no. 2302 ±800' east of S.H. 205 ±71 right of centerline Memorial Drive
 Elevation= 466.79'

11/18/03 CONSTRUCTION SET J.J.V. App.
 No. Date Revisions

TOMDEN ENGINEERING
 12665 N. CENTRAL EXPY. SUITE 1016
 DALLAS, TX 75243
 972 336-6446 FAX 972 386-6409
 tomden@aolmail.net

ECKERD - ROCKWALL, TEXAS

ARCHITECT:
 GENESIS DESIGN GROUP, INC.
 2080 N. HIGHWAY 900, STE. 200
 GRAND PRAIRIE, TX. 75050

OWNER:
 MAYS & COMPANY
 5949 SHERRY LANE, # 1570
 DALLAS, TX. 75225

UTILITY PROFILES

Scale: 1" = 20' H. 1" = 4' V.
 Designed by: J.J.V.
 Drawn by: R.V.A./ J.C.A.
 Checked by: T.P.J.
 /dwg/268-06/01C0651PR.dwg
 Date: 05/27/04 10:29

SHEET
06
 OF
08