

NOTE:
EXISTING UTILITIES SHOWN ARE A GRAPHICAL REPRESENTATION OF THE LOCATION BASED ON AS-BUILT DRAWINGS. ACTUAL LOCATION AND ELEVATION MAY BE DIFFERENT. CONTRACTOR MUST VERIFY ALL EXISTING UTILITIES FOR LOCATION AND ELEVATION PRIOR TO CONSTRUCTION.

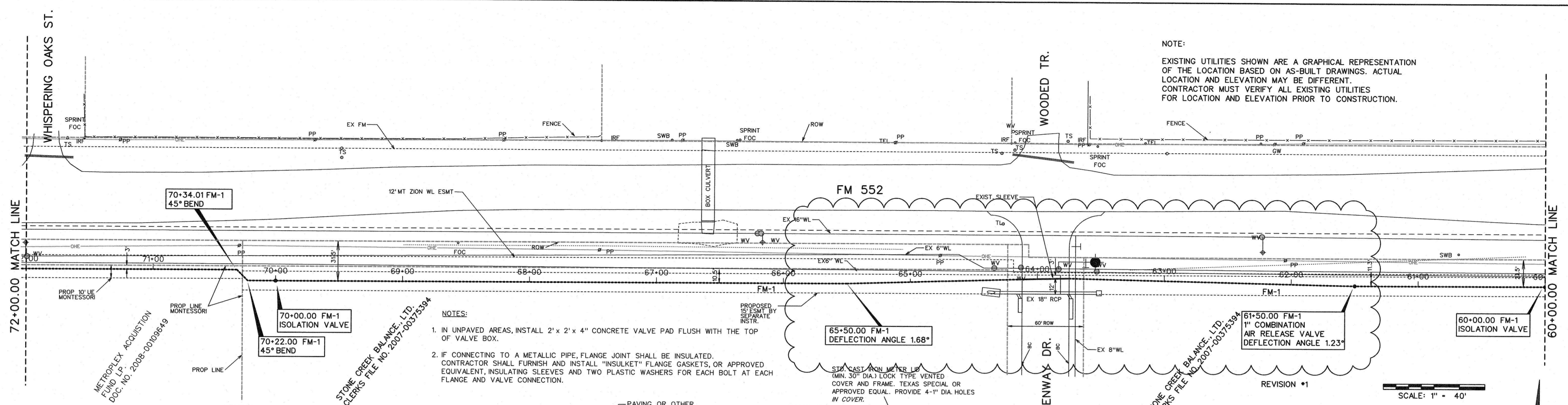

- NOTES:
- CONTRACTOR TO ADJUST LOCATION OF FORCE MAIN TO AVOID EXISTING PUBLIC AND PRIVATE UTILITIES AS NECESSARY.
 - CONTRACTOR TO REPLACE ANY PAVEMENT, SIGNS, FENCES ETC. DAMAGED IN CONSTRUCTION AT OWN EXPENSE.
 - CONTRACTOR TO USE MANUFACTURED BENDS AND PULL PIPE TO REQUIRED ALIGNMENT (NOT TO EXCEED MANUFACTURERS RECOMMENDATION). SEE TCEQ 217.67(j)
 - CONTRACTOR IS RESPONSIBLE FOR TRAFFIC CONTROL AND SIGNAGE DURING ALL PHASES OF CONSTRUCTION.

- LEGEND
- FM- FORCE MAIN
 - TS- TRAFFIC SIGN
 - FOC- FIBER OPTIC CABLE MARKER
 - ICV- IRRIGATION CONTROL VALVE
 - LP- LIGHT POLE
 - WV- WATER VALVE
 - PP- POWER POLE
 - GW- GUY WIRE
 - ELEC- ELECTRIC MARKER
 - TEL- TELEPHONE MARKER
 - ATT- ATT MARKER OR BOX
 - SWB- TELEPHONE MARKER
 - WL- WATER LINE
 - RCP- REINFORCED CONCRETE PIPE
 - RCB- REINFORCED CONCRETE BOX
 - BC- BACK OF CURB

- NOTES:
- IN UNPAVED AREAS, INSTALL 2' x 2' x 4" CONCRETE VALVE PAD FLUSH WITH THE TOP OF VALVE BOX.
 - IF CONNECTING TO A METALLIC PIPE, FLANGE JOINT SHALL BE INSULATED. CONTRACTOR SHALL FURNISH AND INSTALL "INSULKET" FLANGE GASKETS, OR APPROVED EQUIVALENT, INSULATING SLEEVES AND TWO PLASTIC WASHERS FOR EACH BOLT AT EACH FLANGE AND VALVE CONNECTION.

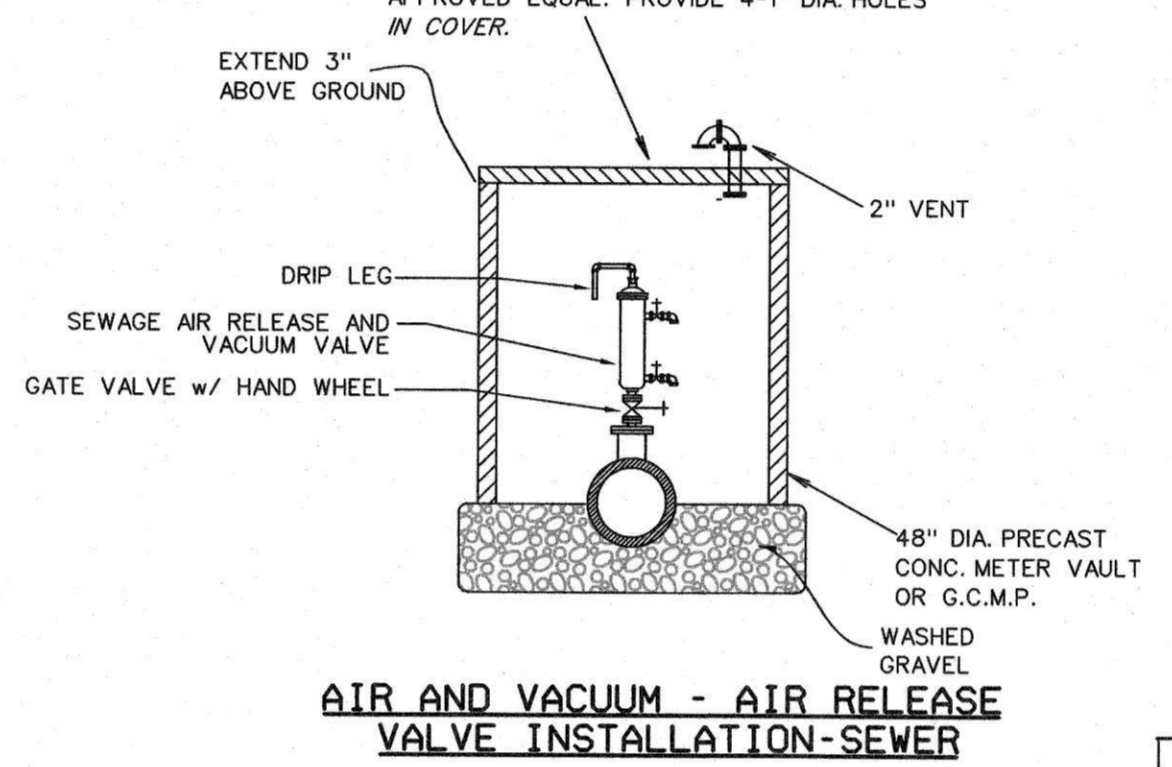
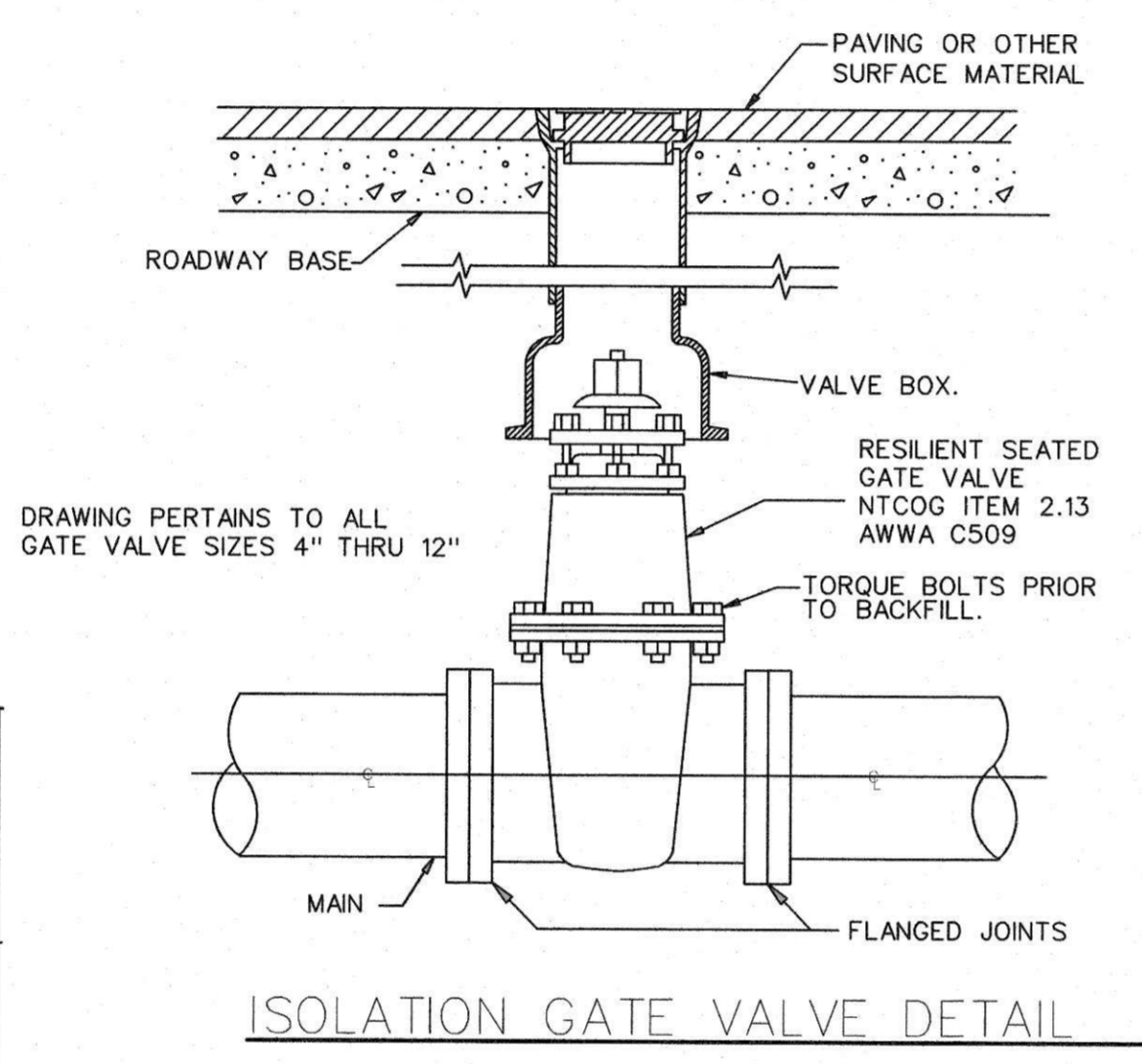

REVISION #1
SCALE: 1" = 40'

NOTE:
ALL FORCE MAIN TO BE AWWA C-900 PIPE DR14, COLORED GREEN.
INSTALL GREEN SANITARY SEWER MARKER POSTS APPROX. EVERY 250 FEET ABOVE FORCE MAIN.
CAUTION: LIGHT POLE CONDUIT IN MEDIAN OF JOHN KING BLVD. ANY DAMAGE SHALL BE REPAIRED AT THE CONTRACTOR'S EXPENSE TO THE SATISFACTION OF THE CITY OF ROCKWALL.
DETECTOR TAPE SHALL BE REQUIRED ALONG FORCE MAIN. SEE TCEQ 217.66

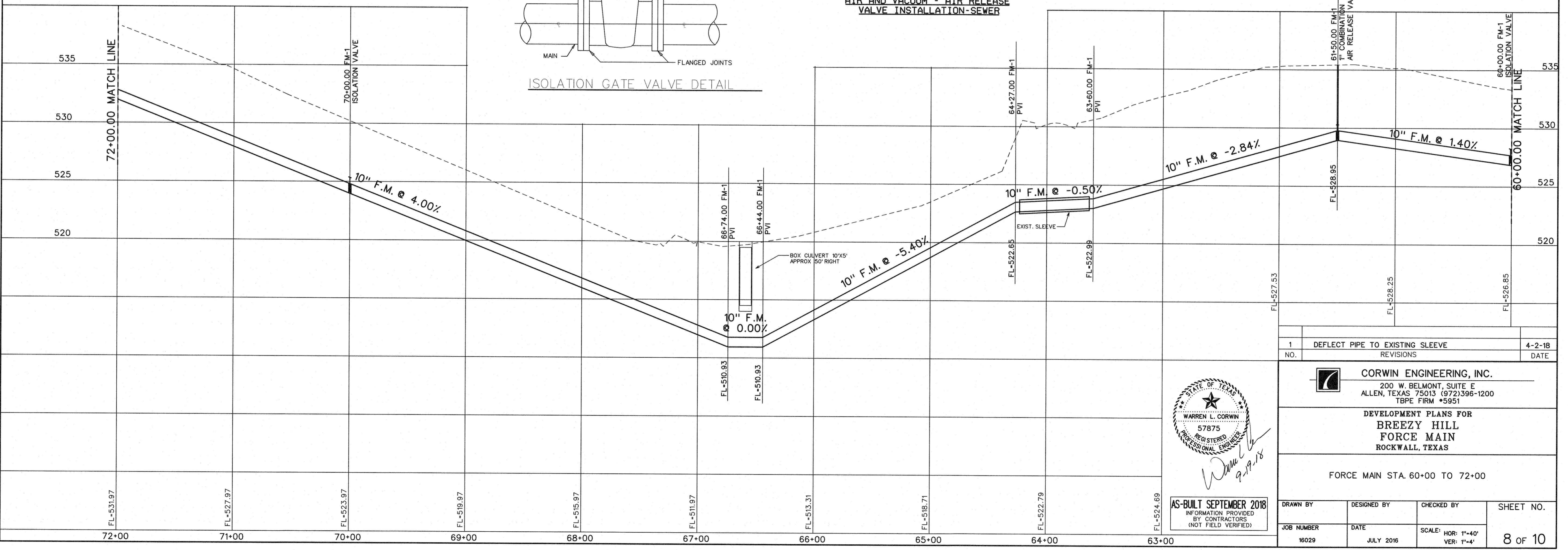

NO.	REVISIONS	DATE
1	DEFLECT PIPE TO EXISTING SLEEVE	4-2-18

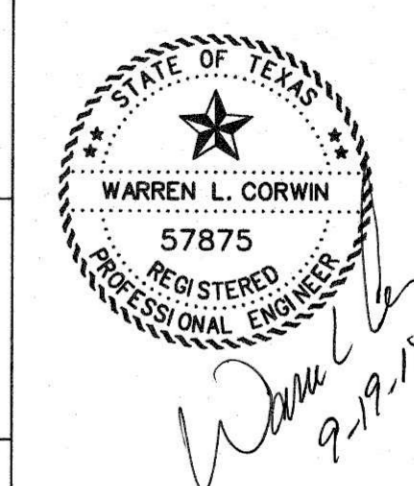

AS-BUILT SEPTEMBER 2018
INFORMATION PROVIDED BY CONTRACTORS (NOT FIELD VERIFIED)

CORWIN ENGINEERING, INC.
200 W. BELMONT, SUITE E
ALLEN, TEXAS 75013 (972)396-1200
TBPE FIRM #5951

DEVELOPMENT PLANS FOR
BREEZY HILL FORCE MAIN
ROCKWALL, TEXAS

FORCE MAIN STA. 60+00 TO 72+00

DRAWN BY	DESIGNED BY	CHECKED BY	SHEET NO.
JOB NUMBER	DATE	SCALE: HOR: 1"=40' VER: 1"=4'	8 OF 10