

SCALE: 1" = 40'

Upstream Station	Downstream Station	Distance (ft)	AREA NO.	Total Area (Acres)	Picked Up (Acres)	C	CA	Accumulated CA	To (Mn)	Design Storm (Years)	I (in/hr)	Q (CFS)	S (ft/ft)	Pipe Size (in)	Partial Flow?	Velocity (fps)	Flow Time (Min)	Velocity Head (ft)	Junction Type	K	Time at DS (Min)	Mnor Losses (ft)	Hydraulic Grade Upstream	Hydraulic Grade Downstream
2+45.00	2+00.00	45.00	3	2.94	2.94	0.50	1.47	1.47	10.00	100	9.80	14.4	0.0041	24	Y	4.6	0.16	0.33		1.25	10.16	0.41	477.19	476.79
2+00.00	1+00.00	100.00	0	0.00	0.50	0.00	1.47	10.16	100	9.78	14.4	0.0040	24	Y	4.6	0.36	0.32		1.00	10.53	0.00	476.60	476.60	
1+00.00	0+65.00	35.00	0	0.00	0.50	0.00	1.47	10.53	100	9.72	14.3	0.0040	24	Y	4.5	0.19	0.32		1.00	10.66	0.00	476.20	476.20	
0+65.00																							476.06	

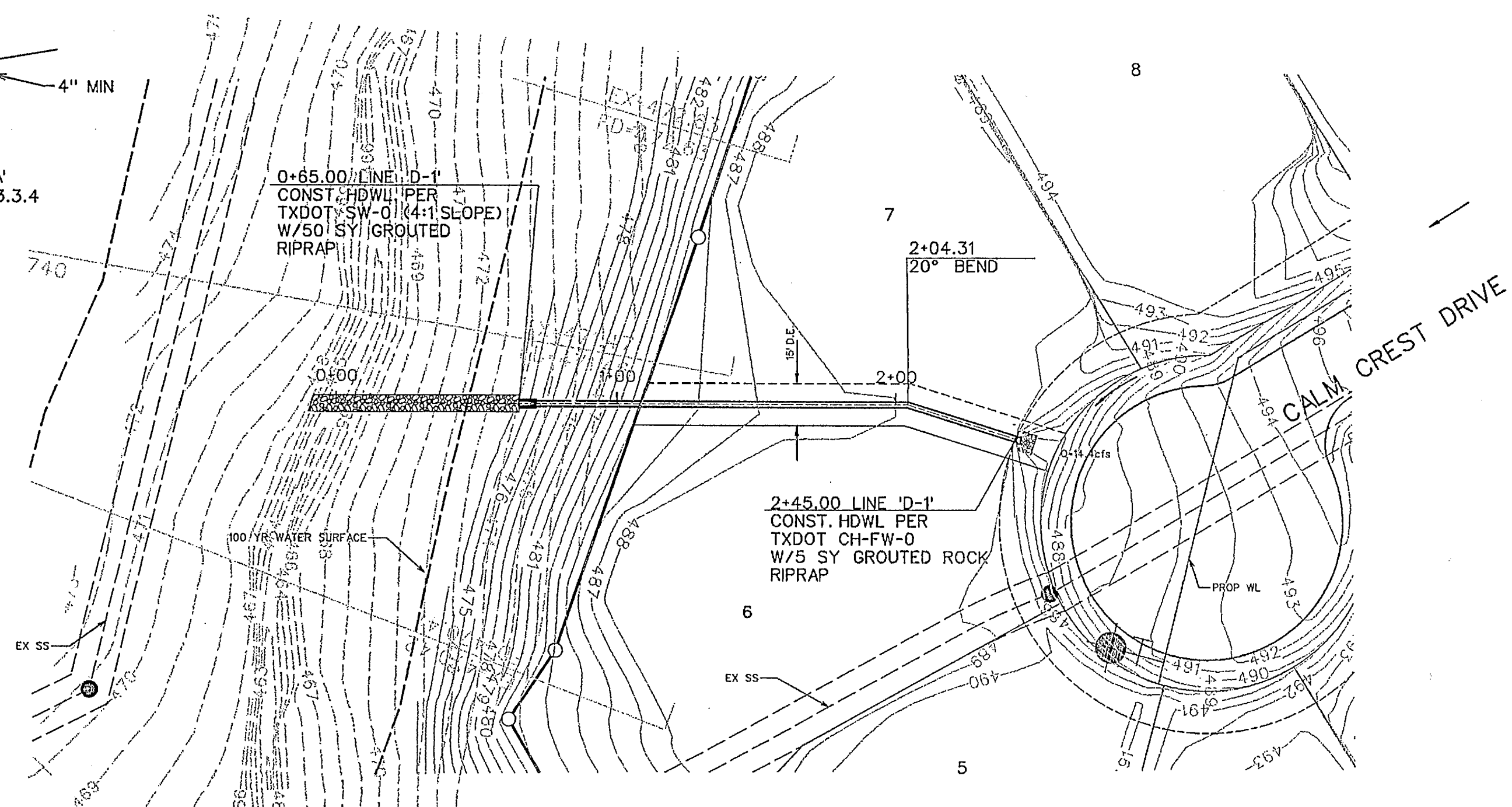

BENCHMARK:

" X " Cut on top of curb on east side of John King Blvd. approx. 48' north of the centerline of Pleasant View Dr.

ELEVATION = 505.61

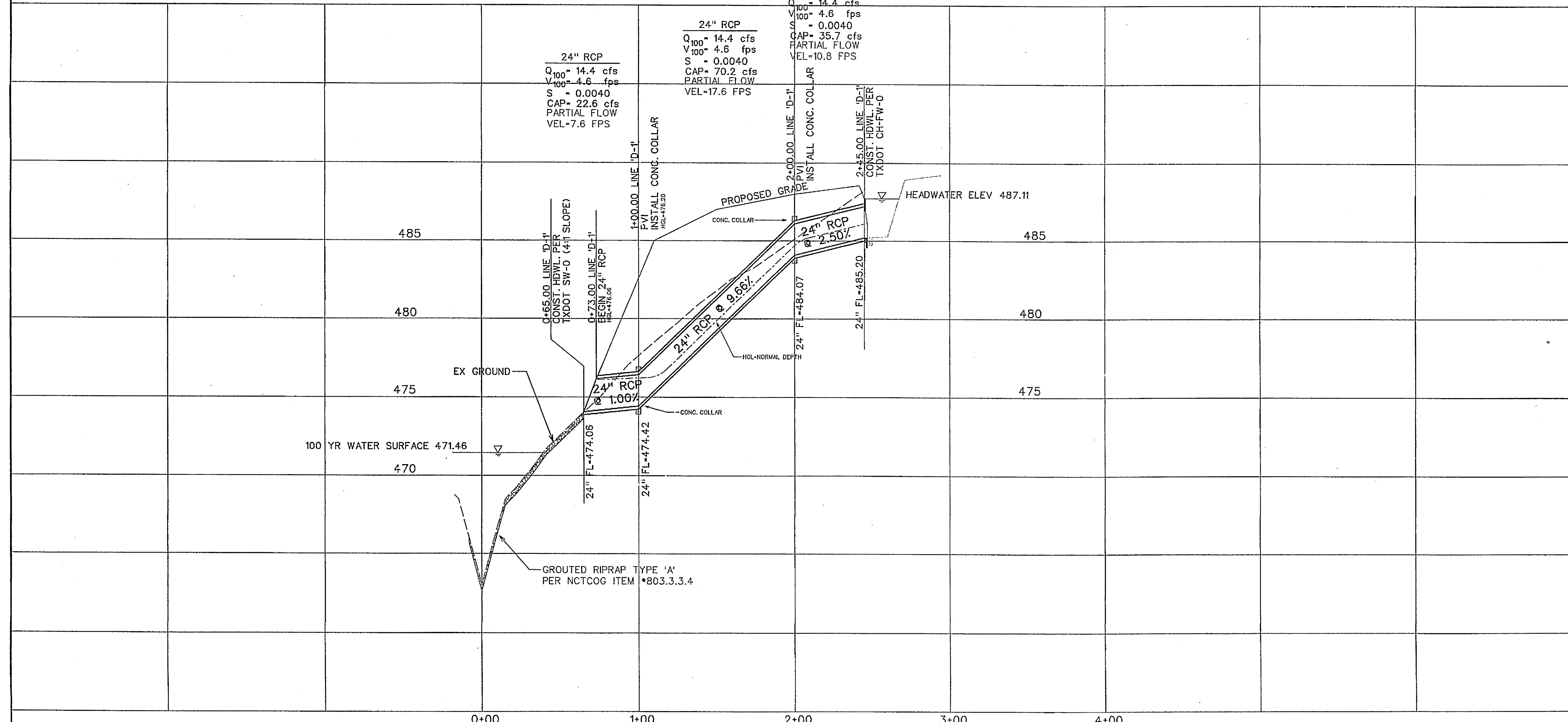

AS-BUILT JUNE 2017
INFORMATION PROVIDED BY
CONTRACTORS
(NOT FIELD VERIFIED)

RELEASED FOR CONSTRUCTION
ALL RESPONSIBILITY FOR ADEQUACY OF DESIGN
REMAINS WITH THE DESIGN ENGINEER. THE CITY
OF ROCKWALL, IN REVIEWING AND RELEASING
PLANS FOR CONSTRUCTION, ASSUMES NO
RESPONSIBILITY FOR ADEQUACY OR ACCURACY
OF DESIGN.

CITY _____ DATE _____

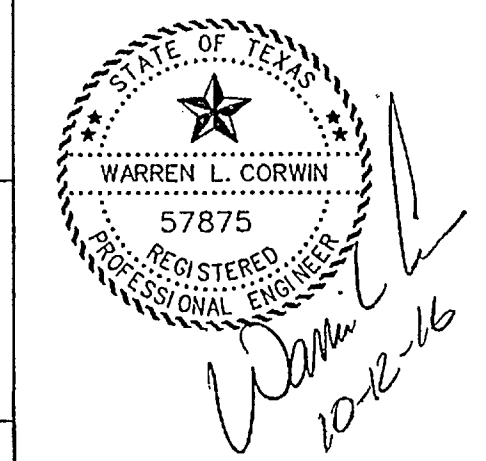

CORWIN ENGINEERING, INC.
200 W. BELMONT, SUITE E
ALLEN, TEXAS 75013 (972)396-1200
TBPE FIRM #5951

DEVELOPMENT PLANS FOR
BREEZY HILL
PHASE VII
ROCKWALL, TEXAS

STORM SEWER PLAN AND PROFILE
LINE "D-1"

DRAWN BY	DESIGNED BY	CHECKED BY	SHEET NO.
JOB NUMBER	DATE	SCALE: HOR: 1"=40' VER: 1"=4'	7 of 10
16006	JUNE 2016		