

◇ - STREET NAME CHANGE

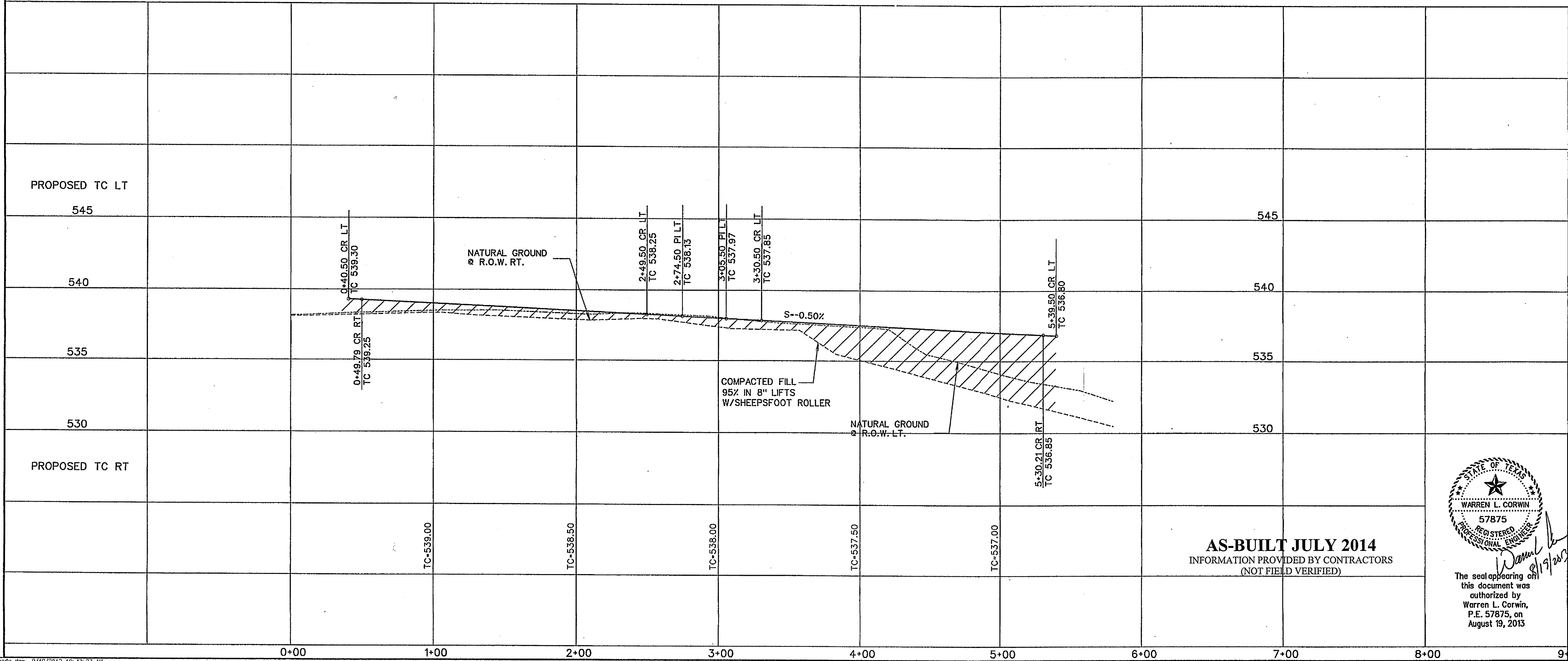

RELEASED FOR CONSTRUCTION.
ALL RESPONSIBILITY FOR ADEQUACY OF DESIGN
REMAINS WITH THE DESIGN ENGINEER. THE CITY
OF ROCKWALL, IN REVIEWING AND RELEASING
PLANS FOR CONSTRUCTION, ASSUMES NO
RESPONSIBILITY FOR ADEQUACY OR ACCURACY
OF DESIGN.
CITY _____ DATE _____

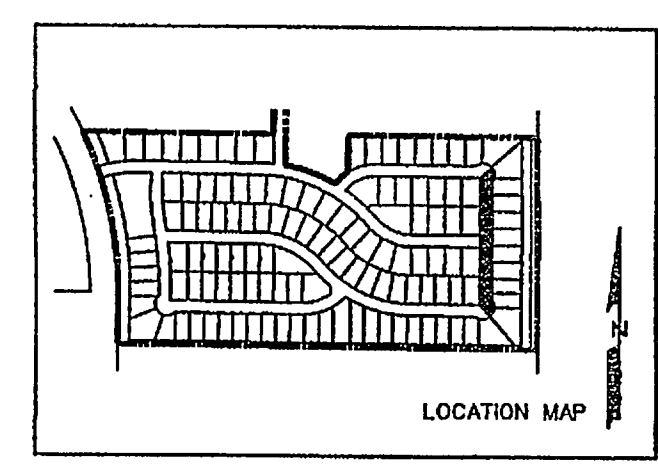
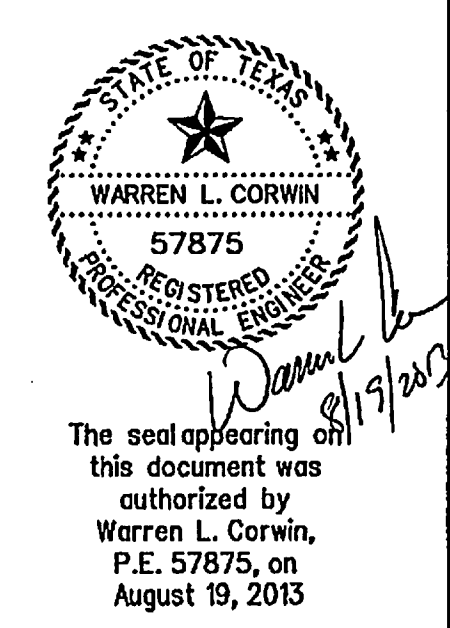

CORWIN ENGINEERING, INC.
200 W. BELMONT, SUITE E
ALLEN, TEXAS 75013 (972)396-1200
TBE FIRM #5951

**DEVELOPMENT PLANS FOR
BREEZY HILL
PHASE 2
ROCKWALL, TEXAS**

SHADY BRANCH DRIVE

DRAWN BY	DESIGNED BY	CHECKED BY	SHEET NO.
JOB NUMBER	DATE	SCALE: HOR: 1"=40' VER: 1"=4'	13 OF 25

AS-BUILT JULY 2014
INFORMATION PROVIDED BY CONTRACTORS
(NOT FIELD VERIFIED)