

PROFILE

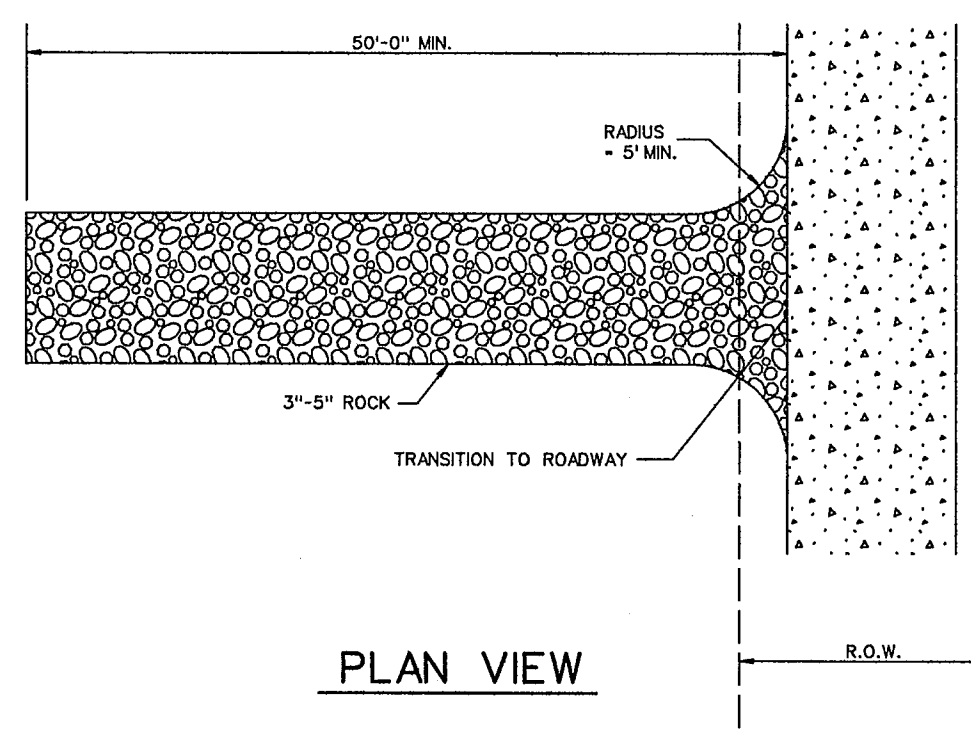

PLAN VIEW

STABILIZED ENTRANCE DETAIL

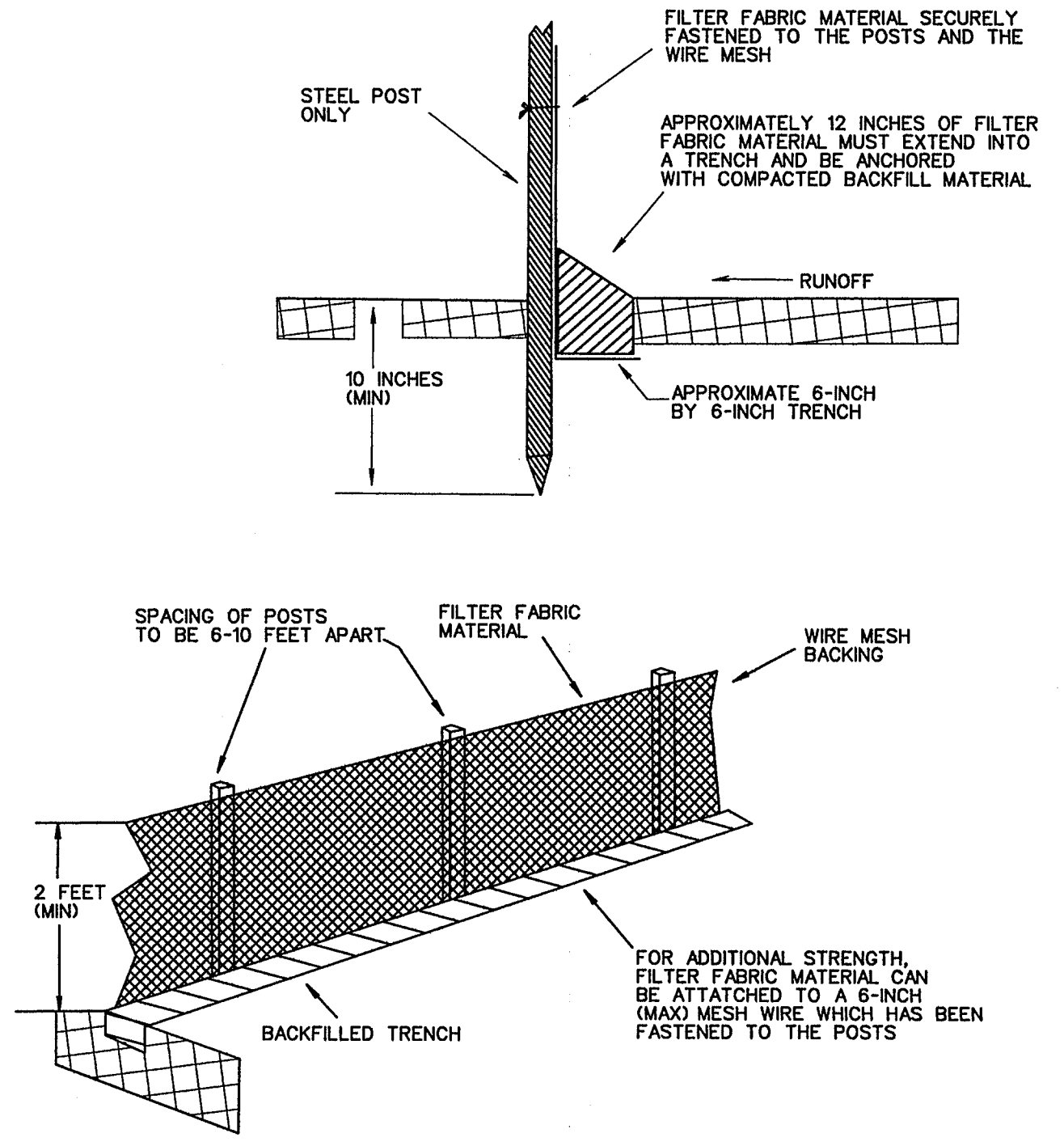
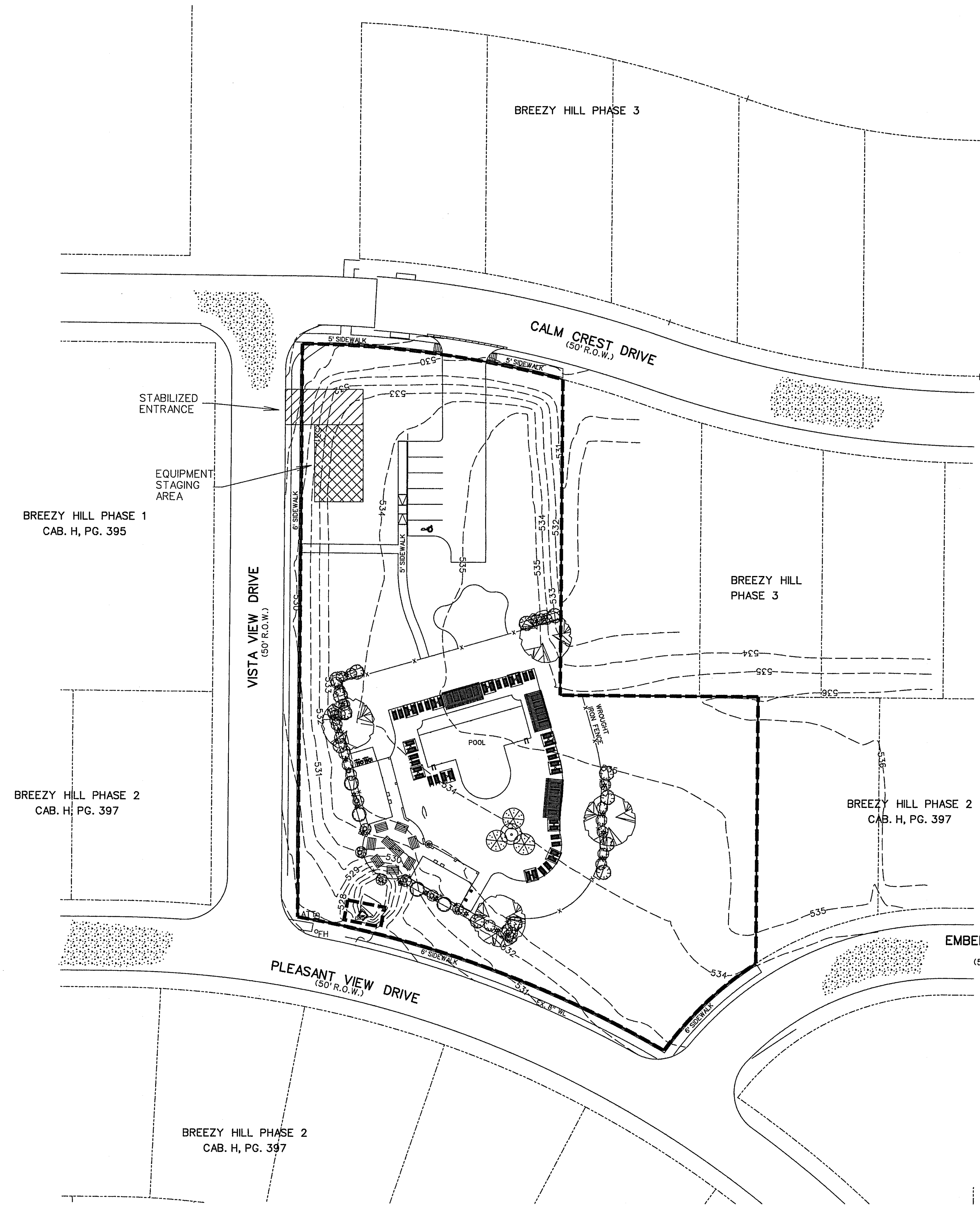

FILTER FABRIC FENCE DETAIL

**CONSTRUCTION SEQUENCE**

1. GRADING CONTRACTOR TO INSTALL TEMPORARY STABILIZED ENTRANCE.
2. INSTALL SILT FENCE AS SHOWN, (TS-600 POLY FELT) PER C.O.G. SPECIFICATIONS.
3. PERFORM GRADING AND UTILITY CONSTRUCTION.
4. AFTER THE INLET BOTTOMS ARE CONSTRUCTED, THE INLETS SHALL BE FILLED WITH STONE AND COVERED WITH A FILTER FABRIC (TS-600 POLY FELT OR EQUIVALENT) BY UTILITY CONTRACTOR.
5. PRIOR TO CITY RELEASING PAVING, SOD OR SEEDED CURLEX SHALL BE INSTALLED ON SIDES AND BOTTOM OF ALL DETENTION PONDS.
6. AFTER PAVING AND COMPLETION OF INLETS, INLET FILTERS SHALL BE INSTALLED IN ALL INLETS AND MAINTAINED UNTIL RE-VEGETATION HAS BEEN COMPLETED BY PAVING CONTRACTOR.
7. SILT FENCE SHALL REMAIN IN PLACE UNTIL RE-VEGETATION HAS BEEN COMPLETED.
8. PAVING CONTRACTOR SHALL REMOVE TEMPORARY STABILIZED ENTRANCE.
9. PRIOR TO CITY ACCEPTANCE THE PAVING CONTRACTOR SHALL BE RESPONSIBLE FOR REMOVING ANY MUD OR SILT WHICH COLLECTS ON THE EXISTING AND NEW PAVEMENT.
10. PRIOR TO CITY ACCEPTANCE 75-80% OF ALL DISTURBED AREA SHALL HAVE A MIN. 1" TALL GRASS ESTABLISHED

**LEGEND**

SILT FENCE ———

AS-BUILT NOVEMBER 2016  
INFORMATION PROVIDED  
BY CONTRACTORS  
(NOT FIELD VERIFIED)

CASE NO. SP2014-032

<p><b>CORWIN ENGINEERING, INC.</b> 200 W. BELMONT, SUITE E ALLEN, TEXAS 75013 (972)396-1200 TBPE FIRM #5951</p>			
<p>DEVELOPMENT PLANS FOR <b>BREEZY HILL AMENITY CENTER</b> ROCKWALL, TEXAS</p>			
<p>EROSION CONTROL PLAN</p>			
DRAWN BY	DESIGNED BY	CHECKED BY	SHEET NO.
JOB NUMBER 15008	DATE FEBRUARY 2015	SCALE:	7 OF 7

TOTAL ACRES 1.648